

INSTRUCTION MANUAL

Smart Power Meter Clamp

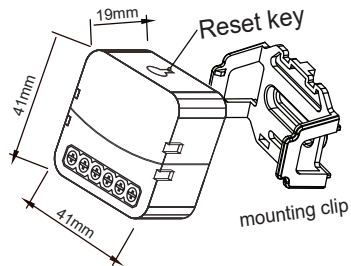

RoHS



TECHNICAL SPECIFICATIONS

Product type	Smart Power Meter Clamp
Voltage	AC100-240V 50/60Hz
Max. load	1CH : 0.2-80A 2CH : 2x(0.2-80A)
Operation frequency	2.412GHz-2.462GHz
Operation temp.	-10 °C + 40 °C
Protocol	WIFI IEEE 802.11b/g/n
Operation range	<100m
Dims (WxDxH)	41*41*23.4 mm
IP rating	IP20
Warranty	1years
Certificates	CE ROHS

Global international operation Whenever & Wherever You are,All-in-one Mobile App

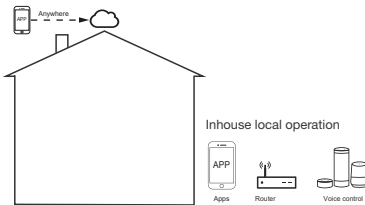

INSTALLATION

▲ FCC Warning Statement:
Changes or modifications not expressly approved by the party responsible for compliance could void the user's authority to operate the equipment. This equipment has been tested and found to comply with the limits for a Class B digital device, pursuant to Part 15 of the FCC Rules. These limits are designed to provide reasonable protection against harmful interference in

residential installation. This equipment generates uses and can radiate radio frequency energy and, if not installed and used in accordance with the instructions, may cause harmful interference to radio communications. However, there is no guarantee that interference will not occur in a particular installation. If this equipment does cause harmful interference to radio or television reception, which can be determined by turning the equipment off and on, the user is encouraged to try to correct the interference by one or more of the following measures:

- > Reorient or relocate the receiving antenna.
 - > Increase the separation between the equipment and receiver.
 - > Connect the equipment into an outlet on a circuit different from that to which the receiver is connected.
 - > Consult the dealer or an experienced radio/TV technician for help.
- This device complies with part 15 of the FCC Rules. Operation is subject to the following two conditions: (1) This device may not cause harmful interference, and (2) this device must accept any interference received, including interference that may cause undesired operation.
- RF Exposure Statement**
To maintain compliance with FCC's RF Exposure guidelines, This equipment should be installed and operated with minimum distance of 20cm the radiator your body. This device and its antenna(s) must not be co-located or operation in conjunction with any other antenna or transmitter.

Wiring Instructions and Diagrams

1. Turn off the power supply before carrying out any electrical installation work.
2. Connect wires according to the wiring diagram.
3. Turn on the power supply and follow switch module configuration instructions.

Notes: Take your smartphone close to the switch module when you're configuring, and make sure you have min. 50% Wi-Fi signal.

with mounting clip

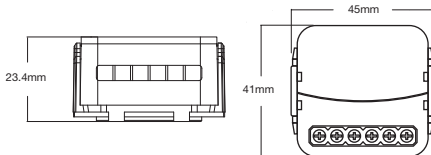

1CH Smart Power Meter Clamp

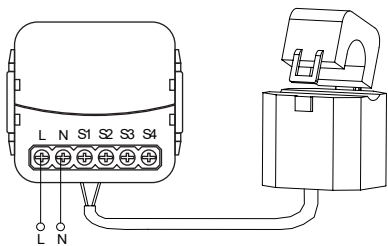

2CH Smart Power Meter Clamp

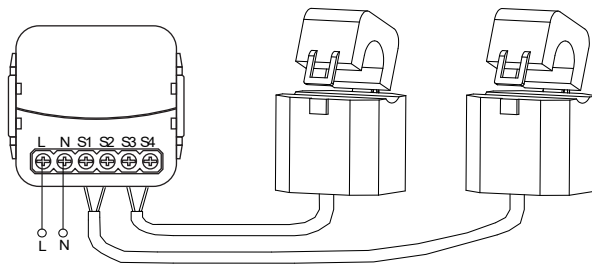

FAQ

- Q1: What should I do if I can't configure the switch module?
- a. Please check whether device is powered on.
 - b. Make sure your mobile and switch module are under the same 2.4 Ghz WIFI network.
 - c. Whether it's in good internet conditions.
 - d. Make sure the password entered in App is correct.
 - e. Make sure the wiring is correct.
- Q2: What device can be connected to this WIFI Single Phase Clamp?
- main switch,solar power generation,large machinery.
- Q3: What happens if the WIFI goes off?
- You can still control the device connected the switch module with your traditional switch and once WIFI is active again the device connected to module will connect automatically to your WIFI network.
- Q4: What should I do if I change the WIFI network or change the password?
- You have to re-connect our Wi-Fi switch module to the new Wi-Fi network accordingly as per the App User Manual.
- Q5: How do I reset the device?
- press the reset key for about 10 seconds until the indicator light flash.

APP USER MANUAL



IOS APP / Android APP

1

Scan the QR code to download Tuya Smart App, or you can also search keyword "Tuya Smart" at App Store or Googleplay to download App.



2

Log in or register your account with your mobile number or e-mail address. Type in the verification code sent to your mobile or mail box, then set your login password. Click "Create Family" to enter into the APP.

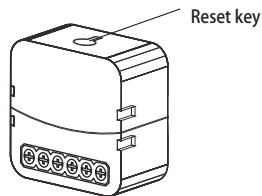

3

After the wiring of switch module is done, Open the terminal box cover, press the reset key for about 10 seconds until the indicator light inside the module is flashing quickly for pairing.

4

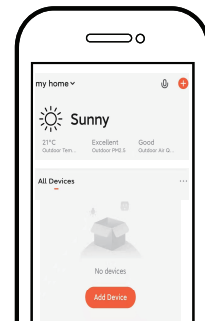

1, Support multi-protocol matching : WIFI/Bluetooth.
2, Turn on Bluetooth, Click "+", follow the on-screen instruction for pairing.

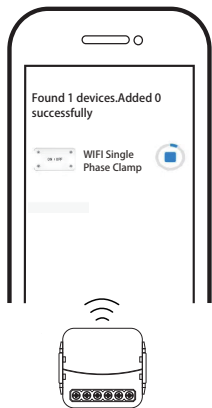

5

The connecting will take about 10-120 seconds to complete depending on your network condition.

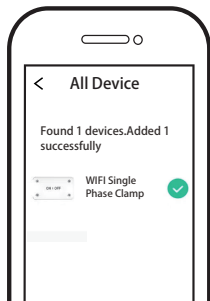

6

Finally, you can control the device via your mobile phone.

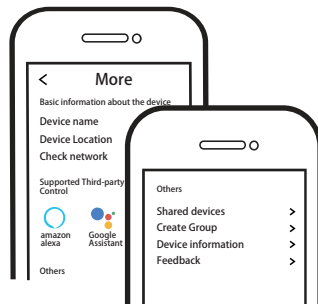

7

Connect to amazon alexa or Google Assistant for voice control, or share the devices with your families or friends.

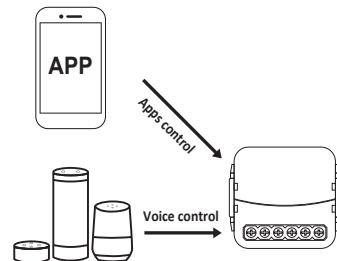

8

Enjoy your smart life of home automation for lighting control by using our All-in-one mobile app wherever you are in the world or simply by voice control when you are sitting at home comfortably.