

# USER MANUAL

## Karaoke Machine Portable Wireless Microphone & Speaker

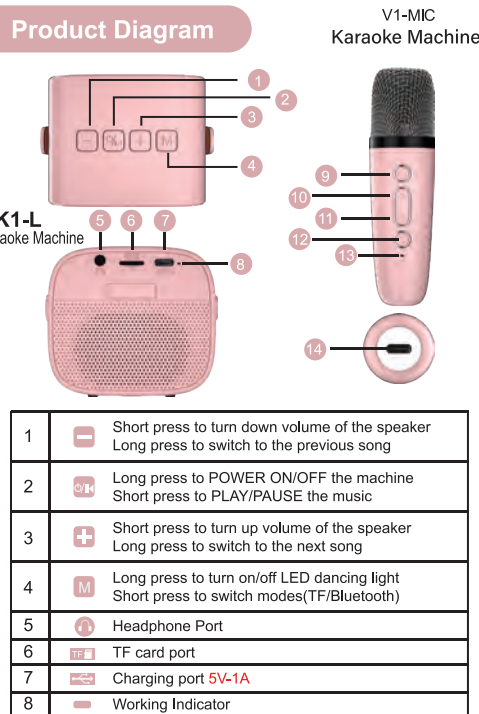

1		Short press to turn down volume of the speaker Long press to switch to the previous song
2		Long press to POWER ON/OFF the machine Short press to PLAY/PAUSE the music
3		Short press to turn up volume of the speaker Long press to switch to the next song
4		Long press to turn on/off LED dancing light Short press to switch modes(TF/Bluetooth)
5		Headphone Port
6		TF card port
7		Charging port 5V-1A
8		Working Indicator

9		Press and hold for 2-3s to turn ON/OFF the microphone. Short press to PAUSE/PLAY music remotely.
10		Short press to turn up microphone volume, there are 5 levels of mic volume. Long Press 2-3s to turn up <b>echo volume</b> , there are 5 levels of echo volume. (The default echo is 0)
11		Short press to turn down microphone volume, total 5 levels of mic vol. Long Press 2-3s to turn down <b>echo volume</b> , total 5 levels of echo vol.(The default echo is 0)
12		Short press to switch between 4 kinds of magic voices Long press 2-3s to remove/restore music vocals (Part of IOS music not supported)
13		Working Indicator
14		Charging port for microphone 5V-1A

## How to use the speaker?

**1.Power ON/OFF:** Press and hold for 2-3s to turn ON/OFF the speaker.And short press + - button to adjust volume of the speaker.

**2.Bluetooth Connection:** Turn on the speaker, and press **M** button to switch to Bluetooth mode,there is a voice" Bluetooth", and search the Bluetooth name" **K1** ", click and paired.

**3.Previous/Next Song:** Long press + - and hold for 2-3s to switch to next/previous song.

**4.Play music via TF card:** Prepare a micro SD card loaded with MP3 songs, plug the card into TF card slot of the speaker, it will auto play.

## How to use the microphone?

### 1.Power ON/OFF

Press and hold for 2-3s to turn ON/OFF the microphone. The mic and speaker will auto connect with each other when both power on.

### 2.How to adjust microphone volume?

Short press + - to turn up/down microphone volume, there are 5 levels of mic volume. When reach to the highest or the lowest volume, there will be a prompt voice" du du".

### 3.How to adjust echo volume?

Long Press + for 2-3s to turn up echo volume, long press once to turn up 1 level, total 5 levels of echo vol.  
Long Press - for 2-3s to turn down echo volume, long press once to turn down 1 level, total 5 levels of echo vol.

**Note:** The default echo is 0, pls long press + to turn up echo volume to suitable level for better singing/karaoke effect.

### 4.Magic Sound Effect

Short press to switch between 4 kinds of magic voices.  
Long press 2-3s to remove/restore music vocals (Part of music for IOS not supported).

## How to Charge

- 1.Take out the type-C charging cable included in the package.
- 2.Plug type-C end of the cable into the machine or microphone, another USB end into normal USB charging adaptor/PC Port (5V-1A). Do not use high-power chargers.
- 3.When the speaker/mic is being charged, the indicator light turns red. Once it is fully charged, the indicator light will turns off.

## Troubleshooting

### 1.Mic won't connect to speaker/no sound

- ◆Indicator light flashing: it means the mic has not successfully connected to the speaker. Restart speaker/mic. Turn on speaker first, then mic.
- ◆Indicator light on, no sound: it means the connection is successful but there is no sound output. Press "+" on the mic to turn up volume.
- ◆Still not working: Fully charge and restart speaker/mic.

### 2.Speaker not working/no sound

- ◆Fully charge the speaker.
- ◆Power on:  
If color light is on but no startup tone, speaker may be broken. Contact after-sales service.  
If color light is on with startup tone, check Bluetooth connection or TF card insertion. Turn up volume on both Bluetooth device and speaker.

### 3.Bluetooth can't be paired

- ◆Press M button to switch to Bluetooth mode first.
- ◆Distant Bluetooth connection, try to adjust the distance between the karaoke machine and the phone.
- ◆The karaoke machine already paired with other phone. First turn off Bluetooth of other phones and restart the machine, try to pair with phone again.

### 4.Mic/speaker charging issues

- ◆Only 5V-1A charging plug and charging cables are supported. Do not use high-power chargers. It will lead to charging failure.

### 5.One mic cannot control multiple mic volumes

- ◆Each mic has independent volume control.  
This design allows for precise adjustments to meet the needs of different users and scenarios.

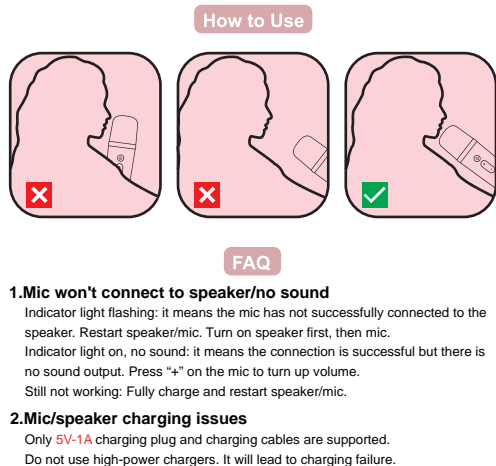

**No worry about this purchasing!**  
30 days no reason money back guarantee, 1 year Warranty and 24 hours warm customer service!  
If you encounter any issues with the machine, refer to the user man or contact us for assistance.

**How to Contact Us?**  
Click "My Orders"→select your order→click "Order Questions"→write dow your questions and send it to us.

## FCC compliance statement

This device complies with Part 15 of the FCC Rules. Operation is subject to the following two conditions: (1) this device may not cause harmful interference, and (2) this device must accept any interference received, including interference that may cause undesired operation.

changes or modifications not expressly approved by the party responsible for compliance could void the user's authority to operate the equipment.

This equipment has been tested and found to comply with the limits for a Class B digital device, pursuant to Part 15 of the FCC Rules. These limits are designed to provide reasonable protection against harmful interference in a residential installation. This equipment generates, uses and can radiate radio frequency energy and, if not installed and used in accordance with the instructions, may cause harmful interference to radio communications. However, there is no guarantee that interference will not occur in a particular installation.

If this equipment does cause harmful interference to radio or television reception, which can be determined by turning the equipment off and on, the user is encouraged to try to correct the interference by one or more of the following measures:  
-- Reorient or relocate the receiving antenna.  
-- Increase the separation between the equipment and receiver.  
-- Connect the equipment into an outlet on a circuit different from that to which the receiver is connected.  
-- Consult the dealer or an experienced radio/TV technician for help.

## FCC Radiation Exposure statement

This equipment complies with FCC radiation exposure limits set forth for an uncontrolled environment. Tthis transmitter must not be co-located or operating in conjunction with any other antenna or transmitter.

## ISED compliance statement

This device contains licence-exempt transmitter(s)/receiver(s) that comply with Innovation, Science and Economic Development Canada's licence-exempt RSS(s). Operation is subject to the following two conditions:  
(1) This device may not cause interference.  
(2) This device must accept any interference, including interference that may cause undesired operation of the device.  
L'émetteur/récepteur exempt de licence contenu dans le présent appareil est conforme aux CNR d'Innovation, Sciences et Développement économique Canada applicables aux appareils radio exempts de licence. L'exploitation est autorisée aux deux conditions suivantes :  
(1) L'appareil ne doit pas produire de brouillage;  
(2) L'appareil doit accepter tout brouillage radioélectrique subi, même si le brouillage est susceptible d'en compromettre le fonctionnement.

## IC Radiation Exposure statement

This equipment complies with IC RSS-102 radiation exposure limits set forth for an uncontrolled environment. This transmitter must not be co-located or operating in conjunction with any other antenna or transmitter.  
Cet équipement est conforme aux limites d'exposition aux radiations IC CNR-102 établies pour un environnement non contrôlé. Cet émetteur ne doit pas être colocalisé ou fonctionner en conjonction avec une autre antenne ou un autre émetteur.

Product Name: Karaoke Machine  
Model: K1-L / V1-MIC  
FCC ID: 2BKSF-K1LN / 2BKSF-V1MN  
IC: 33006-K1LN / 33006-V1MN  
HVIN: KMK1LN / KMV1MN  
Manufacturer: Dongguan MeiYin keji Co., LTD.  
Address: Room 1004, No.3, Lane 6, Minchang Road, Nanzha, Humen Town, Dongguan City, Guangdong Province, China