

# ROCKLER® Dust RIGHT®

## Compact Ceiling Air Filtration Unit Instructions

Effective July 2024



Review full instructions prior to use for important safety information.  
Always check Rockler.com to confirm that you are using the most recent version of instructions for your product.

## GENERAL SAFETY WARNINGS

This product is designed only for specific applications as defined in the instructions and should not be modified or used for any manner not described in these instructions. Use only recommended accessories. Before using the Compact Ceiling Air Filtration Unit: **READ, UNDERSTAND** and **FOLLOW ALL INSTRUCTIONS AND SAFETY WARNINGS. KEEP THESE INSTRUCTIONS READILY AVAILABLE FOR FUTURE REFERENCE.**

- > Always confirm that you are using the most recent version of the instructions and safety warnings for your product (see the instructions link on the product page at Rockler.com).
- > Before using another tool with this product, always read, understand and follow the instructions and safety warnings in the owner's manual for that tool. If you do not have the owner's manual, obtain one from the tool's manufacturer before using it with this product.
- > Before using any chemical with this product, always read, understand and follow all safety warnings and guidelines in the manufacturer's Safety Data Sheet (SDS; formerly called "MSDS"), especially regarding:
  - How to safely use the chemical, including potential hazards and recommended first aid measures;
  - Personal safety equipment required to safely use the chemical (e.g. gloves, eye protection, mask/respirator, etc.);
  - Proper and safe handling, storage and disposal of the chemical.
- > Before using this product, review and verify that all tools to be used with it have safety equipment installed and are in proper working order as defined by the tool's owner's manual.
- > Do not use this product until you have read and are confident you understand:
  - Product Specific Safety Warnings (p. 3);
  - Parts List (p. 4);
  - Choosing a Mounting Location (p. 4);
  - Mounting: Between Joists (pp. 5 - 8);
  - Mounting: Hanging (p. 9);
  - Electrical Connections and Grounding (p. 9);
  - Operation (p. 10);
  - Maintenance (p. 11);
  - Specifications (p. 12).
- > The user assumes all risk and responsibility for the proper and safe use of this product and for ensuring product suitability for the intended application.
- > It is the sole responsibility of the purchaser of this product to ensure that anyone you allow to use this product reads and complies with all instructions and safety precautions outlined in this manual prior to use.
- > Follow all standard shop safety practices, including:
  - Keep children and bystanders away from the tool operating area;
  - Do **NOT** use power tools in explosive environments, or in the presence of flammable liquids, fumes or dust;
  - **TURN OFF AND UNPLUG** all power tools **BEFORE** making any adjustments or changing accessories;
  - Remain alert and use good judgment. Do not use this product if you are in any way impaired by medications, alcohol, drugs or fatigue;
  - Keep your work area well lit and clean;
  - Dress appropriately. Secure loose clothing, remove all jewelry and tie up long hair before using this product;
  - **ALWAYS** wear safety glasses, hearing protection and respiratory protection that complies with NIOSH/OSHA/ANSI safety standards;
  - Use dust collection tools and dust face masks to reduce exposure to dust;
  - Use safety equipment such as featherboards, push sticks and push blocks, etc., when appropriate;
  - Maintain proper footing at all times and do not overreach;
  - Do **NOT** force woodworking tools.
- > These warnings and instructions do **NOT** represent the total of all information available regarding tool safety, use and technique. Always seek out opportunities to learn more and improve your skills and knowledge.

**⚠ WARNING:** Drilling, sawing, sanding or machining wood products can expose you to wood dust, a substance known to the State of California to cause cancer. Avoid inhaling wood dust or use a dust mask or other safeguards for personal protection. For more information go to [www.P65Warnings.ca.gov/wood](http://www.P65Warnings.ca.gov/wood).

- |                  |  |
|------------------|--|
| <b>⚠ DANGER</b>  | Danger indicates a hazardous situation that, if not avoided, will result in death or serious injury.                     |
| <b>⚠ WARNING</b> | Warning indicates a hazardous situation that, if not avoided, could result in death or serious injury.                   |
| <b>⚠ CAUTION</b> | Caution indicates a hazardous situation that, if not avoided, may result in minor or moderate injury or property damage. |
| <b>NOTICE</b>    | Notice indicates important or helpful information and/or user tips.  |

## PRODUCT SPECIFIC SAFETY WARNINGS

### WARNING

#### Electrical/Grounding

- > Connect to a properly grounded outlet only. See Grounding Instructions (p. 8).
- > To reduce the risk of electric shock, do **NOT** use outdoors or on wet surfaces.
- > Improper connection of the equipment-grounding conductor can result in a risk of electrical shock. Check with a qualified electrician or service person if you are in doubt as to whether the outlet is properly grounded.
- > Do **NOT** modify the plug provided with the appliance – if it will not fit the outlet, have a proper outlet installed by a qualified electrician.
- > **FOLLOW** all electrical and safety codes, including the National Electric Code (NEC) and the Occupational Safety and Health Administration regulations (OSHA). All electrical connections and wiring should be made by qualified personnel only.
- > Do **NOT** use with a damaged cord or plug. If the supply cord is damaged, it must be replaced by a qualified person in order to avoid a hazard.
- > Do **NOT** pull or carry this appliance by the cord, use the cord as a handle, close a door on the cord, or pull the cord around sharp edges or corners. Do not run the appliance over the cord. Keep cord away from heated surfaces.
- > Do **NOT** unplug by pulling on the cord. To unplug, grasp the plug, not the cord.
- > Do **NOT** handle the plug or appliance with wet hands.
- > Make sure the main power switch is in the OFF position before connecting or disconnecting the machine to the power source.
- > If connected to a circuit protected by fuses, use time-delay fuses, marked Type D, with this dust collector.
- > The use of extension cords is discouraged; try to position the machine near the power source. If an extension cord is necessary, use only three-wire extension cords that have three-prong grounding plugs and three-pole receptacles that accept the tool's plug.
- > Extension cords in poor condition or that are too small can pose fire and shock hazards. When using an extension cord, be sure it is in good condition and properly rated.

#### Safe Use

- > Keep hands and fingers away from moving parts.
- > Do **NOT** leave appliance when plugged in. Unplug from outlet when not in use and before servicing.

- > **NEVER** leave tool running and unattended.
- > Do **NOT** put any object into openings. Do **NOT** use with any opening blocked by debris; keep free of dust, lint, hair, and anything that may reduce airflow.
- > Remove all jewelry, secure loose clothing, and tie up long hair before using this machine. To avoid serious injury, keep hair, loose clothing, fingers, and all parts of body away from openings and moving parts
- > Close attention is necessary when used by or near children.
- > Use only as described in this manual.
- > Do **NOT** hang from the machine or allow anyone else to do so.
- > Do **NOT** hang anything from the unit.
- > For household use only.
- > Make sure that all filters have been correctly installed before starting the machine.
- > Switch the machine off when not in use. For prolonged periods of inactivity, disconnect the general power supply.

#### Installation

- > Do **NOT** attempt to lift more than you are physically able. Get help from another adult if necessary. Use proper lifting techniques.
- > The Compact Ceiling Air Filtration Unit **MUST** be mounted to structurally sound solid wood ceiling joists capable of supporting a minimum of 100 lbs. The joists must be at least 1½" thick. Do **NOT** use with timber I-joists or steel joists.
- > **NEVER** mount the unit to a dropped or false ceiling grid. Do **NOT** use wall anchors or drywall anchors to mount the unit.
- > Make sure the unit will be situated at least 6'10" above heating or air vents.

#### Maintenance

- > **TURN OFF AND DISCONNECT POWER BEFORE** cleaning, making any adjustments or changing accessories.
- > Check the Inner Pocket Filter, the Foam Pre-Filter and Pleated Filter periodically. Replace the filters every 3-6 months, depending on usage. Replacement Inner Pocket Filters (78773, sold separately) and Pre-Filter/Pleated Filter combos (78999, sold separately) are available from Rockler.



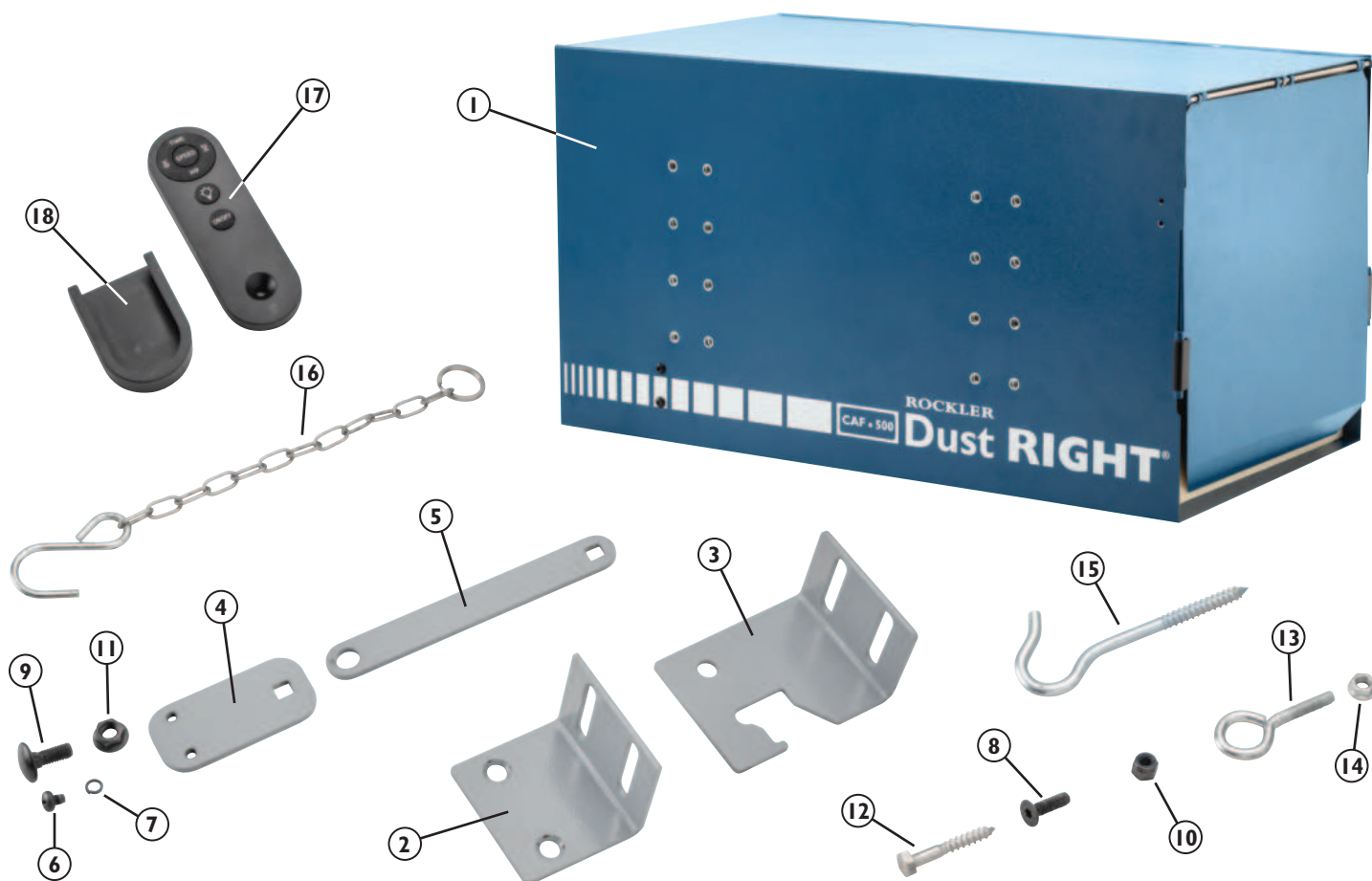

## PARTS LIST

	Quantity		Quantity
1 Compact Ceiling Air Filtration Unit	1	12 1/4" x 1 1/2" Lag Screw	8
2 Side Bracket	4	13 Eyebolt Hanger	4
3 Joist Bracket	4	14 Eyebolt Hanger Nut	4
4 Baffle Bracket	1	15 Screw Hook	4
5 Baffle Arm	1	16 Chain	4
6 M4 x 0.7 x 5mm Round-Head Screw	2	17 Remote Control	1
7 M4 Lock Washer	2	18 Remote Control Dock	1
8 M6 x 1.0 x 20mm Flat-Head Screw	8	19 Foam Pre-Filter (Installed)	1
9 M6 x 1.0 x 16mm Carriage Bolt	10	20 Pleated Filter (Installed)	1
10 M6 Nylon Locknut	8	21 Inner Pocket Filter (Installed)	1
11 M6 Washer Nut	2		

## Choosing a Mounting Location

### NOTICE

Do **NOT** mount the unit close to or directly under a light source. Doing so may result in poor operation or reduced range of the included infrared remote control.

Before installing the air filtration unit in a ceiling location, test run the unit to make sure that it functions properly.

The ideal location for an air filtration unit is centered in the shop ceiling, mounted approximately 6'10" to 7'10" in the air, away from corners, tall cabinets or heating/cooling vents that would

restrict airflow. Another good location is above an area where a lot of sanding is done. Example: if you do lathe work and have a sanding center nearby, hang the air filtration unit between both areas. Depending on your shop size, you might need more than one air filtration unit or might need to choose a larger unit, such as the Full-Size Air Filtration Unit (77121, sold separately).

The Compact Ceiling Air Filtration Unit is designed to be installed between ceiling joists spaced approximately 16" on center, but it also can be hung directly from solid ceiling joists.

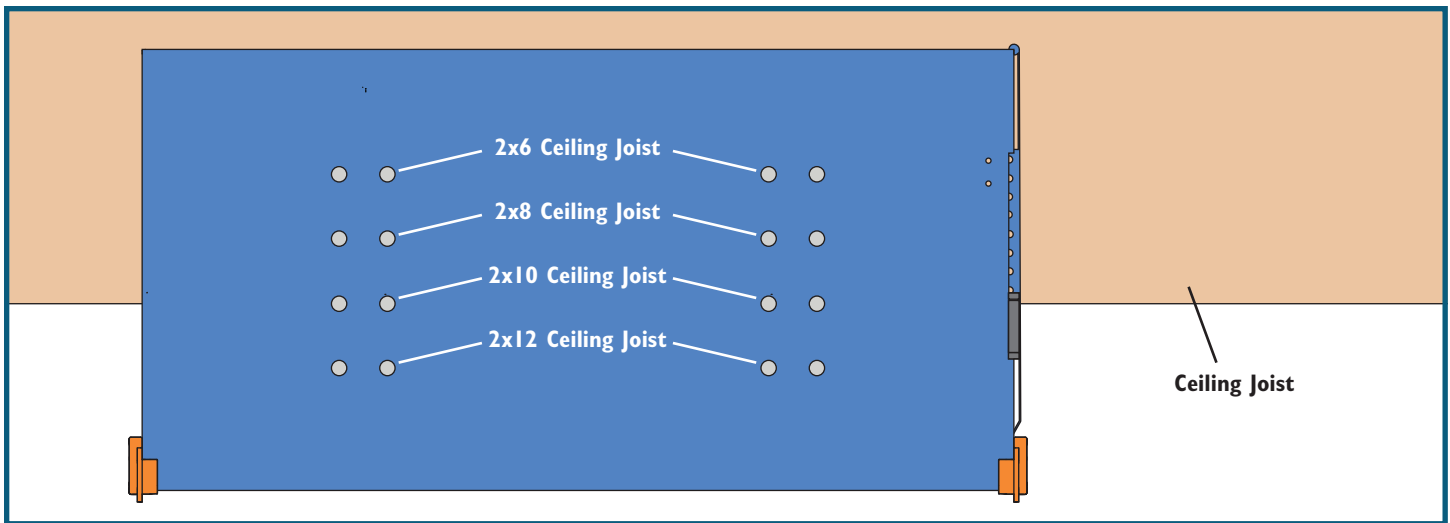

Fig. 1

## Mounting: Between Joists

### ⚠ WARNING

- > The Compact Ceiling Air Filtration Unit **MUST** be mounted to structurally sound solid wood ceiling joists capable of supporting a minimum of 100 lbs. The joists must be at least 1½" thick. Do **NOT** use with timber I-joists or steel joists.
- > **NEVER** mount the unit to a dropped or false ceiling grid. Do **NOT** use wall anchors or drywall anchors to mount the unit.
- > The unit must be mounted with two 1/4" x 1½" Lag Screws (12) in each Joist Bracket (3) – one used to initially hang the unit and a second Lag Screw driven through the mounting hole in the bracket to fully secure it. **DO NOT USE ONLY THE LAG SCREWS INSTALLED TO INITIALLY HANG THE UNIT.**
- > Do **NOT** attempt to lift more than you are physically able. Get help from another adult if necessary. Use proper lifting techniques.
- > Make sure the unit will be situated at least 6'10" above heating or air vents.

### Attaching the Brackets to the Unit

1. Determine the mounting location for your Compact Ceiling Air Filtration Unit. Make sure that the joists are spaced 15¼" to 16¼" apart, center to center. If their spacing is not within this range, you'll need to find another mounting location or employ another mounting method.
2. The brackets for mounting the unit between the joists are made up of two parts that get bolted together – one that mounts to the unit and another that attaches to the joist. We will refer to these as the Side Bracket (2) and the Joist Bracket (3). You'll attach the Side Brackets to the unit first and then attach the Joist Brackets to the Side Brackets.
3. Note whether your ceiling joists are made from 2x6s, 2x8s, 2x10s or 2x12s, as this will help determine which of the four sets of mounting holes on the sides of the unit you will use

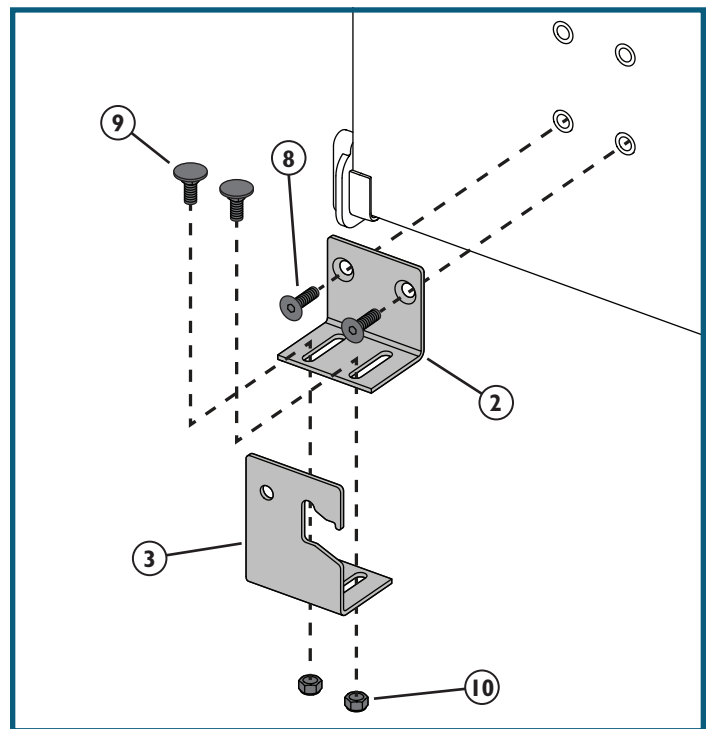

Fig. 2

when attaching the Side Brackets. For 2x6 joists, we recommend using the top set of holes. For 2x8 joists, use the second set of holes down. For 2x10 joists, use the third set of holes from the top. For 2x12 joists, use the bottom set of holes. **Fig. 1.** Attach the Side Brackets (2) to the Compact Ceiling Air Filtration Unit (1) with M6 x 1.0 x 20mm Flat-Head Screws (8). **Fig. 2.** Note that you can mount the unit to be less recessed into the joists if desired by mounting the Side Brackets in a lower set of holes but that you **CANNOT** use a higher mounting position.

4. Attach the Joist Brackets (3) to the Side Brackets (2). **Position the horizontal flange of the Joist Bracket under the horizontal flange of the Side Bracket and align the slots.** From the top, place an M6 x 1.0 x 16mm Carriage Bolt (9) in each of the slots and thread on an M6 Nylon Locknut (10) from below. **Fig. 2.**

- Adjust the Joist Brackets (3) so that they will just fit outside the joists between which you will be mounting the Compact Ceiling Air Filtration Unit (1). At the mounting location, measure the distance from the outside of one joist to the outside of the other joist. Subtract the width of the air filtration unit – 14" – from the distance you just measured. Then divide that number by two to determine how far the inside edge of the Joist Bracket needs to be from the unit.

**Example:** We have standard 1½" thick joists spaced at the standard 16" on center. The outside measurement from joist to joist is 17½". Subtracting the unit's width – 14" – from 17½" gives us 3½". Divide that by 2, and the result is 1¾". So the inside of each Joist Bracket needs to be 1¾" from the side of the unit, and the unit will be centered in the joist opening.

- Once you have adjusted the Joist Brackets (3), use a wrench to tighten the M6 Nylon Locknuts (10).

- With the help of another adult, lift the unit up to the mounting location to make sure the brackets are spaced correctly and fit around the joists (but do **NOT** hang the unit at this point). If the brackets don't fit, return the unit to your work surface and make any necessary adjustments to the Joist Brackets. Make sure the M6 Nylon Locknuts (10) are fully tightened.

### Setting the Baffle Angle

#### NOTICE

The Baffle angle must be set before mounting the unit because the hardware will not be accessible once the unit is installed in between ceiling joists.

- Attach the Baffle Bracket (4) to the side of the Compact Ceiling Air Filtration Unit (1). Place the bracket on the outside of the unit, aligning the mounting holes in the bracket with the mounting holes on the side of the unit.

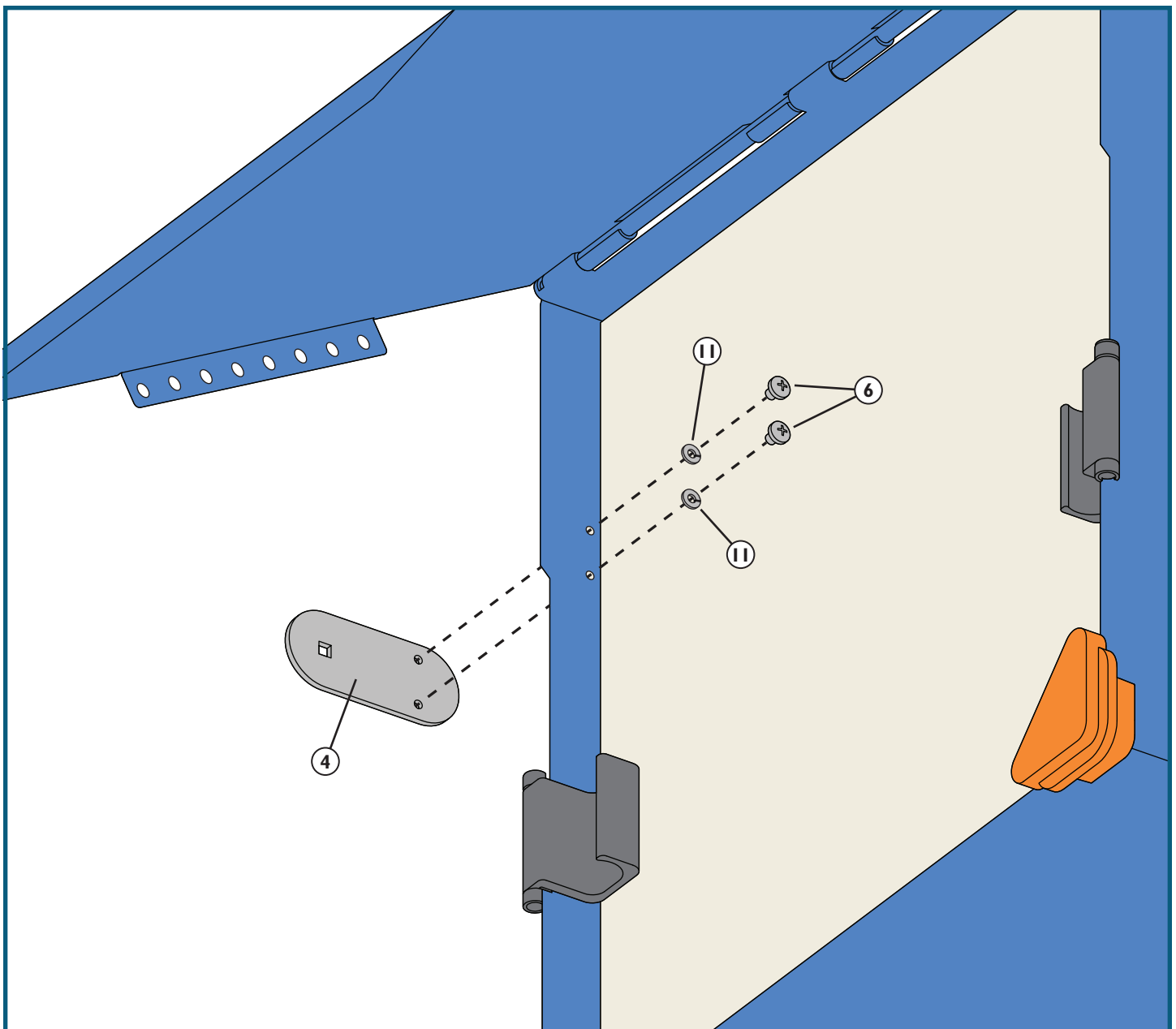

Fig. 3

Attach the Baffle Bracket with two M4 x 0.7 x 5mm Round-Head Screws (6) and two M4 Lock Washers (7) driven from inside the lip of the unit; the Baffle Brackets have tapped holes to accept the screws. **Fig. 3.**

2. Position the Baffle Arm (5) so one end is against the inside face of the Baffle Bracket (4). Align the holes and connect the two pieces by inserting an M6 x 1.0 x 16mm Carriage Bolt (9) from the outside face of the Baffle Bracket and threading on an M6 Washer Nut (11).
3. Select the appropriate hole in the flange of the Baffle to which to connect the other end of the Baffle Arm (5). If you're mounting the unit by using the Side Brackets (2) and Joist Brackets (3), you want to choose a hole that will angle the Baffle so that its bottom edge is roughly even with the bottom of the combined bracket. If you're hanging the unit by using the Eyebolt Hangers (13), choose the hole that will hold the Baffle all the way up. Position the end of the Baffle Arm outside the flange of the Baffle and align it with the appropriate hole in the flange. Then attach the Baffle Arm to the Baffle with an M6 x 1.0 x 16mm Carriage Bolt (9) inserted from the outside face of the Baffle Arm and an M6 Washer Nut (11). **Fig. 4.**

#### Installing Lag Screws and Securing Unit to Joists

1. At the mounting location, identify where you want to position the unit. On one of the two joists, measure up from the bottom 1½" and make a mark.

2. Using a combination square, try square or saddle square, draw a line vertically down to the bottom of the joist.
3. Again using a square, extend the line across the bottom edge of the joist.
4. Switching to a T-square or framing square, transfer the line from the bottom of the first joist to the bottom of the second joist. Make sure to hold the square tight against the joist to transfer the mark accurately.
5. At the second joist, use a combination square, try square or saddle square to extend the line vertically up from the bottom of the joist. Measure 1½" up on that line and make a mark.
6. Back at the first joist, measure horizontally along the joist and make a mark 12¼" from your initial line.
7. Use a combination square, try square or saddle square to draw a vertical line extending up from the bottom of the joist. Measure 1½" up on that line and make a mark.
8. Repeat Steps 3-5 to extend these lines to the second joist. You should have four marks 1½" from the bottom of the joists spaced 12¼" apart.
9. At each of the marks, drill a 3/16" diameter stopped pilot hole.

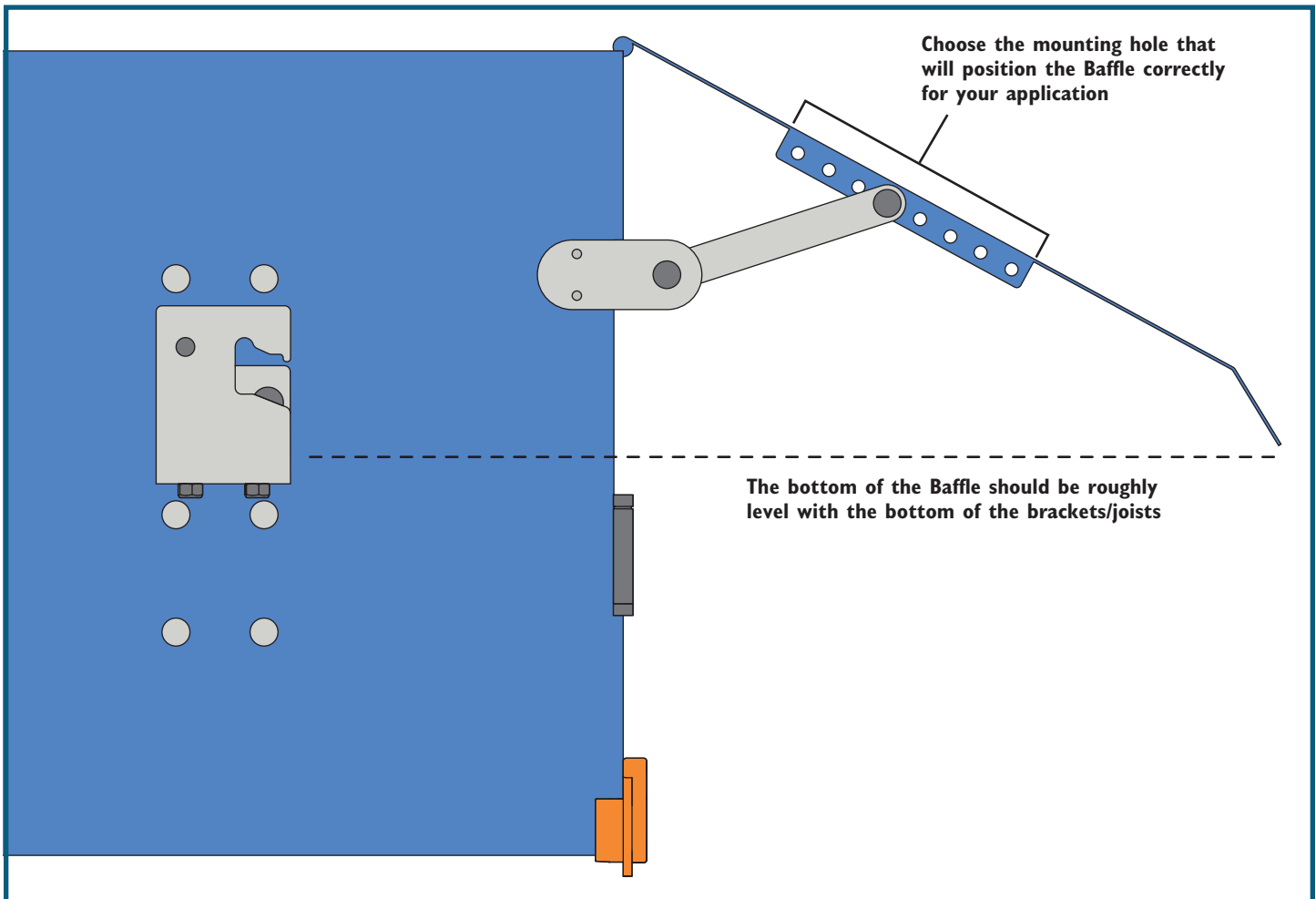

Fig. 4



Fig. 5



Fig. 6

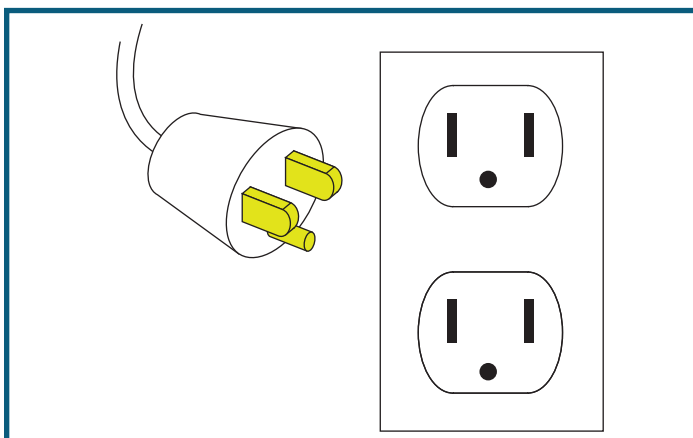

Fig. 7

10. In each of the pilot holes, drive a 1/4" x 1 1/2" Lag Screw (12) partway into the joist so that the threaded section of the screw is buried in the joist but the unthreaded section is exposed. These screws will provide a support onto which you can temporarily hook the Joist Brackets (3) when hanging the unit.

**⚠ WARNING**

The unit must be mounted with two 1/4" x 1 1/2" Lag Screws (12) in each Joist Bracket (3) – one used to initially hang the unit and a second Lag Screw driven through the mounting hole in the bracket to fully secure it. **DO NOT USE ONLY THE LAG SCREWS INSTALLED TO INITIALLY HANG THE UNIT.**

11. With help from another adult, lift the Compact Ceiling Air Filtration Unit between the joists, hooking the Joist Brackets (3) onto the 1/4" x 1 1/2" Lag Screws (12).
12. Make sure the unit is hanging as desired. Then, using the single holes in the Joist Brackets (3) as a guide, drill a 3/16" diameter stopped pilot hole at each bracket location. Take care not to drill all the way through the joist into the side of the unit.
13. Fully drive a 1/4" x 1 1/2" Lag Screw (12) into each of the pilot holes you just drilled to secure the unit to the joist. Then go back and fully drive the Lag Screws you used to initially hang the unit. The final installation should look like Fig. 5.



## Mounting: Hanging

### **⚠WARNING**

- > The Compact Ceiling Air Filtration Unit **MUST** be mounted to structurally sound solid wood ceiling joists capable of supporting a minimum of 100 lbs. The joists must be at least 1½" thick. Do **NOT** use with timber I-joists or steel joists.
- > **NEVER** mount the unit to a dropped or false ceiling grid. Do **NOT** use wall anchors or drywall anchors to mount the unit.
- > Do **NOT** attempt to lift more than you are physically able. Get help from another adult if necessary. Use proper lifting techniques.
- > Make sure the unit will be situated at least 6'10" above heating or air vents.

1. Install the Baffle Bracket (4) and Baffle Arm (5) as described in Setting the Baffle Angle on Page 6. Then position the end of the Baffle Arm outside the flange of the Baffle and align it with the nearest hole in the flange. Attach the Baffle Arm to the Baffle with an M6 x 1.0 x 16mm Carriage Bolt (9) inserted from the outside face of the Baffle Arm and an M6 Washer Nut (11).
2. Thread an Eyebolt Hanger Nut (14) onto each of the four included Eyebolt Hangers (13), almost all the way up.
3. Thread an Eyebolt Hanger (13) into each of the four mounting holes in the top of the unit. Try to thread all Eyebolt Hangers into the unit an equal amount. Make sure the threads are fully engaged.
4. Tighten each Eyebolt Hanger Nut (14) against the top of the unit to lock the Eyebolt Hangers (13) in place. Hold the hangers while tightening the nuts so that the hangers do not spin.
5. At the desired mounting location, drill 7/32" diameter pilot holes into structurally sound wooden ceiling joists and install the included Screw Hooks (15). Space the Screw Hooks roughly the same as the Eyebolt Hangers (13).
6. Adjust the length of the included Chains (16), if necessary, by moving the split rings attached to the chains from the end to a link toward the middle of the chain.
7. Install a Chain (16) on each Screw Hook (15) by fitting the Chain's split ring onto the Screw Hook.
8. With the help of another adult, lift the unit and suspend it by fitting the S-hook at the end of each Chain (16) into an Eyebolt Hanger (13) on the unit. The final installation should look like **Fig. 6**.

## Electrical Connections and Grounding

### **⚠WARNING**

- > To reduce the risk of electric shock, do **NOT** use outdoors or on wet surfaces.
- > Do **NOT** use with a damaged cord or plug. If the supply cord is damaged, it must be replaced by a qualified person in order to avoid a hazard.
- > Do **NOT** pull or carry this appliance by the cord, use the cord as a handle, close a door on the cord, or pull the cord around sharp edges or corners. Do **NOT** run the appliance over the cord. Keep cord away from heated surfaces.
- > Do **NOT** unplug by pulling on the cord. To unplug, grasp the plug, not the cord.
- > Do **NOT** handle the plug or appliance with wet hands.
- > Make sure the main power switch is in the **OFF** position before connecting or disconnecting the machine to the power source.
- > If connected to a circuit protected by fuses, use time-delay fuses, marked Type D, with this air filtration unit.
- > The use of extension cords is discouraged; try to position the machine near the power source. If an extension cord is necessary, use only three-wire extension cords that have three-prong grounding plugs and three-pole receptacles that accept the tool's plug.
- > Extension cords in poor condition or that are too small can pose fire and shock hazards. When using an extension cord, be sure it is in good condition and properly rated.

### Grounding Instructions

This air filtration unit must be grounded. If it should malfunction or break down, grounding provides a path of least resistance for electric current to reduce the risk of electric shock. This air filtration unit is equipped with a cord having an equipment-grounding conductor and grounding plug. The plug must be inserted into an appropriate outlet that is properly installed and grounded in accordance with all local codes and ordinances.

This air filtration unit is for use on a nominal 120V circuit and has a grounding attachment plug that looks like the plug illustrated in **Fig 7**. Make sure that the unit is connected to an outlet having the same configuration as the plug. No adapter should be used with this air filtration unit.

### **⚠WARNING**

The unit must be mounted with two 1/4" x 1½" Lag Screws (12) in each Joist Bracket (3) – one used to initially hang the unit and a second Lag Screw driven through the mounting hole in the bracket to fully secure it. **DO NOT USE ONLY THE LAG SCREWS INSTALLED TO INITIALLY HANG THE UNIT.**

## Operation

The Dust Right Compact Ceiling Air Filtration unit can be operated by using the control panel on the unit or the included remote control. For the remote control to work properly, there can be no obstructions between the control panel, which houses the receiver, and the remote control. **Fig. 8.**

### Turning the Unit On and Off and Setting the Speed

#### NOTICE

The Remote Control Dock (18) has adhesive mounting tape on the back so you can store the Remote Control (17) wherever is most convenient.

1. Plug the power cord into an appropriate power source.
2. Press the **ON/SPEED** button on the control panel or the **ON/OFF** button on the Remote Control (17) to turn on the unit. At this point, the unit will be running at low speed, and the “**LOW**” LED light on the unit’s control panel will be illuminated.
3. To change the speed, press the **ON/SPEED** button on the control panel again or press the **SPEED** button on the Remote Control (17). The LED lights on the control panel will indicate the selected speed – low, medium or high.
4. To turn off the unit, press the **OFF** button on the unit’s control panel or the **ON/OFF** button on the Remote Control (17).

### Setting the Timer

#### NOTICE

The timer function of this air filtration unit can be set **ONLY** with the Remote Control (17). This air filtration unit can be set to run for 2, 4 or 8 hours before automatically turning itself off.

1. Select the desired running time by pressing 2H, 4H or 8H on the ring surrounding the **SPEED** button on the Remote Control (17). You also can press **TIME** to cycle through the speeds. Confirm the time setting by making sure the corresponding LED light is illuminated on the unit’s control panel.
2. If you want to cancel the timer but keep the unit running, press **TIME** on the Remote Control (17). If you want to cancel the timer and turn the unit off, hit the **ON/OFF** button on the Remote Control or the **OFF** button on the unit’s control panel.

### Operating the LED Work Lights

While many other ceiling-mount air filtration units run the risk of blocking lights, the Dust Right Compact Ceiling Air Filtration Unit has two LED lights built into the bottom of the unit that provide bright light to your work area.

To turn the LED lights on, press the button with the light bulb icon on the control panel or on the Remote Control (17). Both lights activate when the button is pushed; it is not possible to turn on only one. To turn off the lights, press the button with the light bulb icon again.

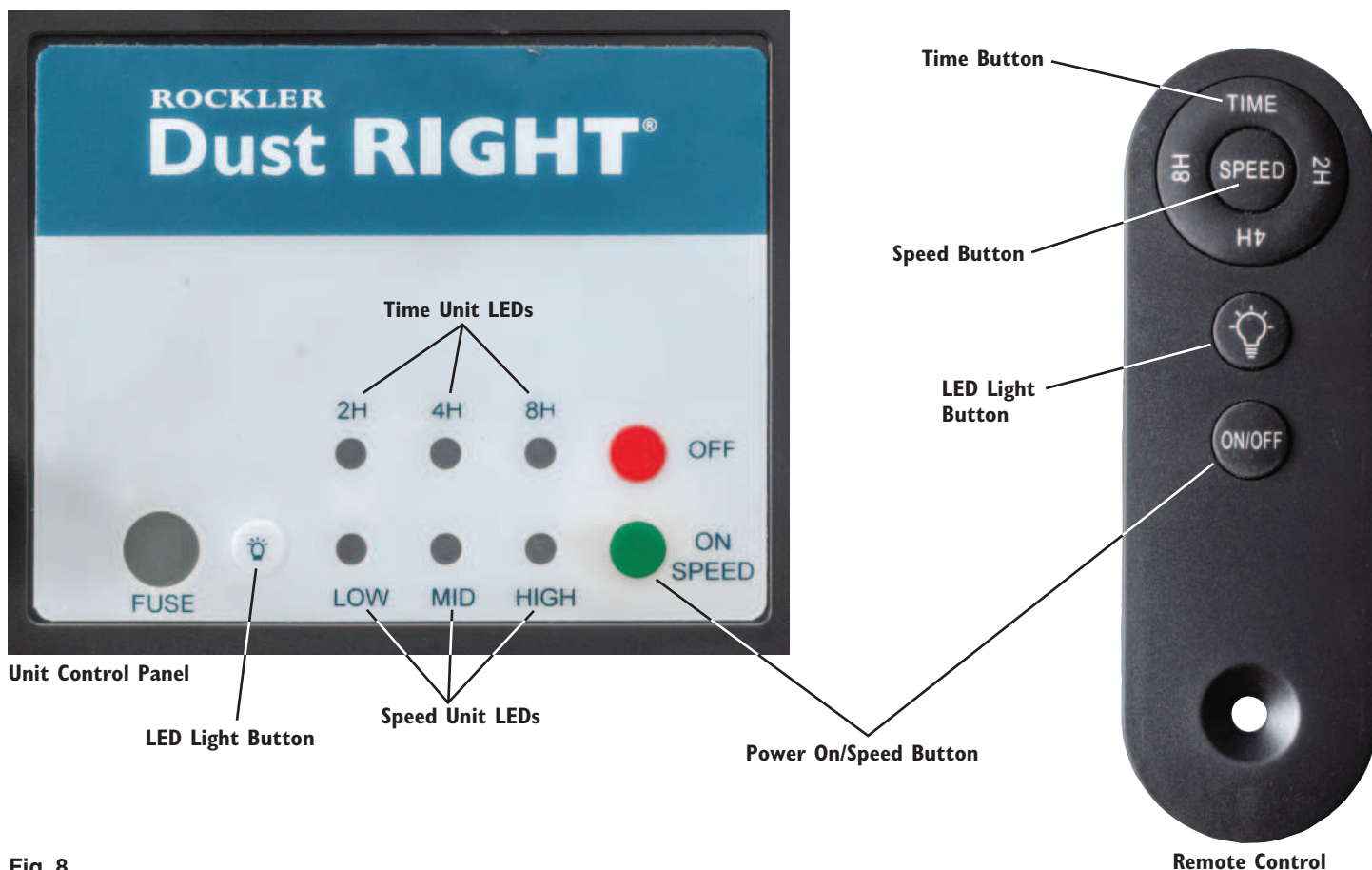

Fig. 8

## Maintenance

### ⚠ WARNING

- > Check the Inner Pocket Filter, the Foam Pre-Filter and Pleated Filter periodically. Replace the filters every 3-6 months, depending on usage.

### ⚠ CAUTION

- > Exercise care when handling dirty filters, as certain fine dusts can be harmful. Always wear appropriate respiratory protection.

### NOTICE

Replacement filters are available from Rockler: Replacement Pre-Filter and Pleated Filter (78999, sold separately) and Replacement Inner Pocket Filter (78773, sold separately)

Once removed from the unit, the Inner Pocket Filter can be rinsed with water to extend its life. Make sure that the filter is completely dry before reinstalling it in the unit.

1. Turn off and disconnect power to the unit.
2. Remove the corner guards from the bottom of the Baffle end of the unit to provide better access. **Fig. 9.**
3. Remove the Pre-Filter and the Pleated Filter.
4. If you're replacing the Inner Pocket Filter, remove it, as well, by pulling it out and down.
5. Install the new filters – first, the Inner Pocket Filter and then the Pleated Filter and the Pre-Filter, in that order. **Fig. 10.**
6. Flip closed the magnetized filter clips on both sides of the unit to secure the filters in place.
7. Reinstall the corner guards you removed in Step 2.

### Checking and Changing the Fuse

1. Turn off and disconnect power to the unit.
2. Using a Phillips-head screwdriver, loosen and remove the fuse cover from the unit's control panel. Carefully pull out the fuse.
3. Insert a new 5Amp/250V fuse (not included) in the fuse cover and reinstall the fuse cover on the control panel.

### Replacing the Remote Control's Battery

1. Using a flat-head screwdriver or a coin in the slot of the battery cover on the back of the Remote Control (17), turn the battery cover counterclockwise to remove it.
2. Remove the old battery.
3. Install a new CR2025 battery, with the positive side (+) up.
4. Reinstall and secure the battery cover by turning it clockwise.

Check Rockler.com for updates. If you have further questions, please contact our Technical Support Department at 1-800-260-9663 or support@rockler.com



Fig. 9



Fig. 10

IDENTIFICATION OF ASSEMBLED PRODUCT  
COMPACT CEILING AIR FILTRATION UNIT  
INSTRUCTIONS (62300/CAF-500) WITH  
REMOTE CONTROL (2BKIF-NS10K433)

IDENTIFICATION OF MODULAR COMPONENTS USED  
REMOTE CONTROL FCC ID 2BKIF-NS10K433

**⚠ CAUTION**

Changes or modifications to this unit not expressly approved by the party responsible for compliance could void the user's authority to operate the equipment.

APPLICABLE COMPLIANCE STATEMENTS

NOTE:

This equipment has been tested and found to comply with the limits for a Class B digital device, pursuant to part 15 of the FCC Rules. These limits are designed to provide reasonable protection against harmful interference in a residential installation. This equipment generates, uses and can radiate radio frequency energy and, if not installed and used in accordance with the instructions, may cause harmful interference to radio communications. However, there is no guarantee that interference will not occur in a particular installation. If this equipment does cause harmful interference to radio or television reception, which can be determined by turning the equipment off and on, the user is encouraged to try to correct the interference by one or more of the following measures:

- Reorient or relocate the receiving antenna.
- Increase the separation between the equipment and receiver.
- Connect the equipment into an outlet on a circuit different from that to which the receiver is connected.
- Consult the dealer or an experienced radio/TV technician for help

RESPONSIBLE PARTY / MANUFACTURER  
ROCKLER COMPANIES

ADDRESS 4365 WILLOW DRIVE, MEDINA, MN 55340

TELEPHONE 1-800-279-4441

WWW.ROCKLER.COM

Airflow	250/350/500 CFM
Motor	110V, 60Hz
Motor Phase	Single Phase
Motor Amps	0.7A
Full Load Amps	0.8A
Motor Power	90W
Timer Settings (hours)	2/4/8
Pre-Filter Dimensions	343mm x 343mm x 25.4mm
Pleated Filter Dimensions	343mm x 343mm x 25.4mm
Inner Pocket Filter Dimensions	340mm x 340mm x 190mm
Sound Ratings (L/M/H @300mm)	64/66/70dB
Overall Dimensions (L x W x H)	635mm x 345mm x 347mm
Gross Weight	30.6kg (estimate)
Net Weight	28 kg
Replacement Fuse Type	5Amp/250V
Remote Control Battery Type	CR2025