

P/N: 6000060051

SIZE:210x142mm

封面/内页 128G铜板纸, 彩印,

(此页不印刷)

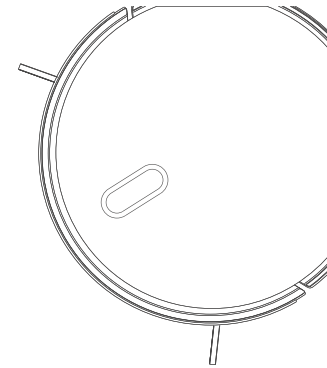

# Robot Vacuum Cleaner

## User Manual

**E3**

Read this user manual carefully before using this product and save it properly for further reference.

## Important Safety Instructions

WARNING: TO REDUCE THE RISK OF INJURY OR DAMAGE, READ THE FOLLOWING SAFETY PRECAUTIONS WHEN SETTING UP, USING AND MAINTAINING YOUR ROBOT.

### Cautions

- This product is designed for indoor floor cleaning only, do not use it outdoors (such as on an open-ended terrace), on any surface other than the ground (such as a sofa ), or in any commercial or industrial environment.
- Do not use this product on elevated surfaces without barriers such as the floor of a loft, an open-ended terrace, or on top of furniture.
- Do not use the product when the ambient temperature is higher than 104°F (40°C) , lower than 39°F (4°C), or if there are liquids or tacky substances on the floor.
- Before using the product, move wires off the ground or place them to the side to prevent them being pulled on by the cleaner.
- To prevent blocking the product and to avoid damage to valuables, remove light-weight items (such as plastic bags) and fragile objects (such as vases) from the floor before cleaning.
- Children should be supervised to ensure that they do not play with the appliance.
- This product is not intended for use by persons (including children) with reduced physical, sensory or mental capabilities, or lack of experience and knowledge, unless they have been given supervision or instruction concerning use of the product by a person responsible for their safety .
- This product can be used by children aged from 8 years and above and persons with reduced physical, sensory or mental capabilities or lack of experience and knowledge if they have been given supervision or instruction concerning use of the product in a safe way and understand the hazards involved. Children shall not play with the product. Cleaning and user maintenance shall not be made by children without supervision (EU).

## Important Safety Instructions

---

### Cautions

- Keep the main brush cleaning tools out of reach of children.
- Do not place any object (including children and pets) on the product , whether it is in operation or not.
- Keep hair, loose clothing , fingers, and all parts of the body away from openings and moving parts.
- Do not use the product on burning objects (such as cigarette butts).
- Do not use the product on high pile carpets ( product effectiveness may also be reduced on dark carpets).
- Do not use the product to clean hard or sharp objects (such as decoration wastes, glass and nails).
- Do not carry the product by using the main unit cover, or collision buffer.
- The product must be switched off and the plug must be removed from socket-outlet before cleaning or maintaining the product.
- Do not use wet cloth or liquids for cleaning the product.
- Do not use the mopping module on carpets.
- Use the product according to the manual, Any loss or damage caused from improper use will be borne by the user.
- This product contains batteries that are only replaceable by skilled persons.

## Important Safety Instructions

---

### Battery and Charging

- Do not charge non-rechargeable batteries.
- For the purposes of recharging the battery, only use the detachable supply unit robot provided with this product.
- Do not dismantle, repair or modify the battery or charging dock.
- Keep the charging dock away from heat (such as heating vents).
- The battery must be removed from the appliance before it is scrapped.
- The product must be disconnected from the power supply when removing the battery.
- The battery must be disposed of safely. Do not discard waste batteries, leave them with a professional recycling organization.
- Do not wipe or clean the charger prongs with wet cloth or wet hands.
- If the power cord is damaged, stop using it immediately. It must be replaced by the manufacturer, service agent, or similarly qualified persons to avoid a hazard.

## Product Introduction

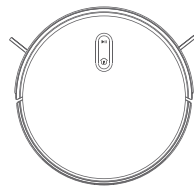

Robot vacuum cleaner

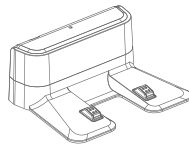

Charging dock

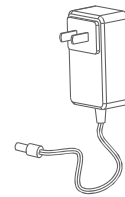

Adapter

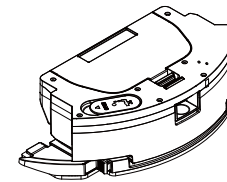

Electrical water tank



HEPA filter

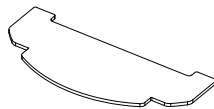

Mop cloth

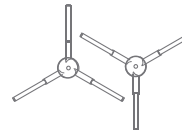

Side brushes



Cleaning tool

## Product Introduction

Top view

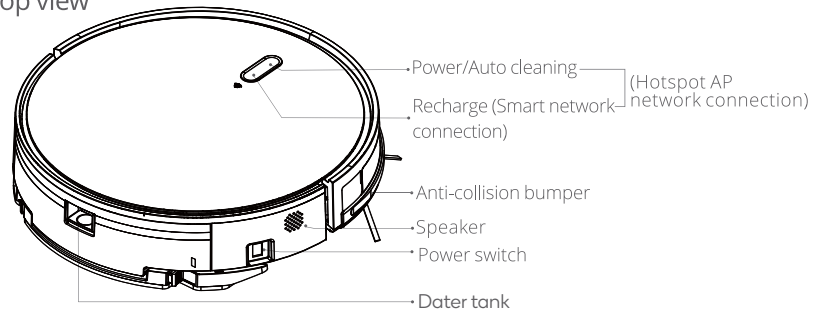

Docking station

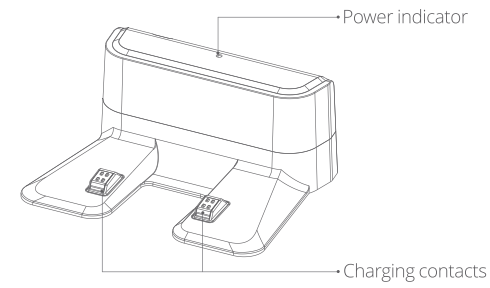

Bottom view

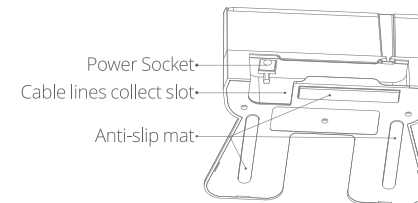
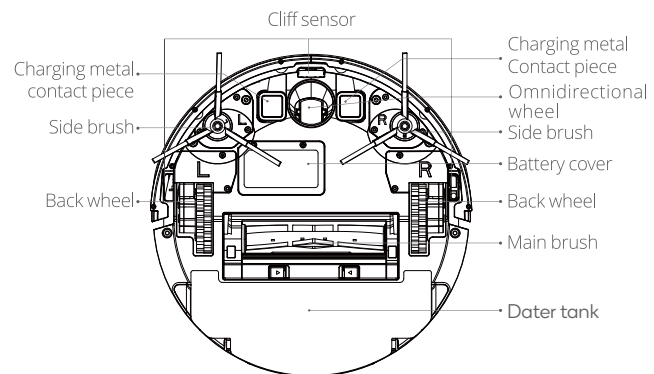

## Product Introduction

### Water tank

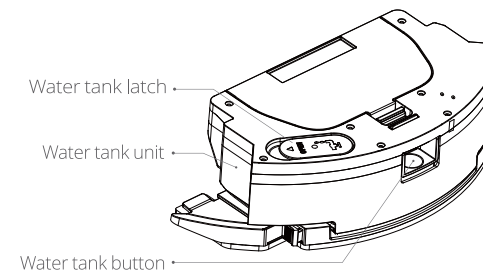
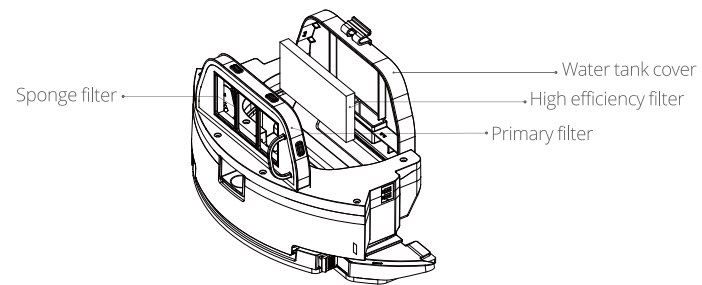



## Installation Using the robot

1. Remove the EVA foam on each side.

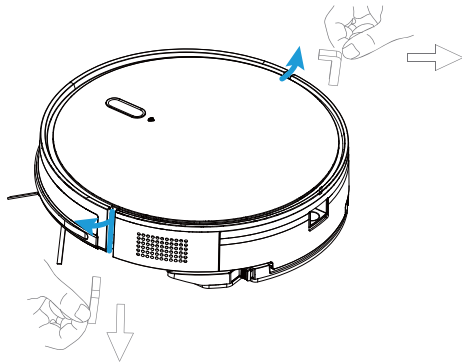

2. Place the charging dock against the wall on a flat surface and plug it into the power socket .

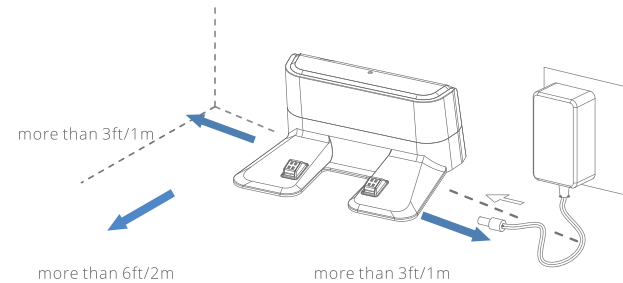

Note:

- The charging dock should have more than 1.0m(3.0ft) of clearance on each side , and more than 2.0m (6.0ft) in the front.
- If the power cable is vertical to the ground, it may be caught by the robot, causing the charging dock to be disconnected.
- The charging dock indicator is on when the charging dock is electrified, and off when the robot is charging.

## Installation Using the robot

3. Turn the robot over to install the side brushes.

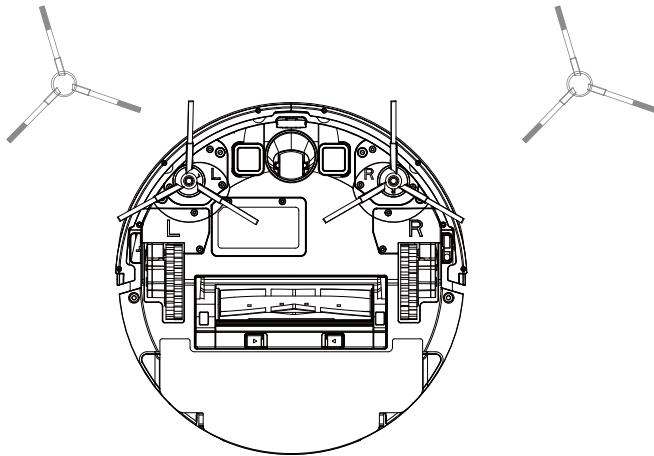

### Install the side brushes

Install the side brushes on both sides of the roller at the bottom of the main unit. Pick up the side brushes with your hands and aim at the hole of the side brush installed on the base (note that the square column and the square hole correspond to each other), press it down to hear a "click" sound, indicating that the side brush is installed in place.

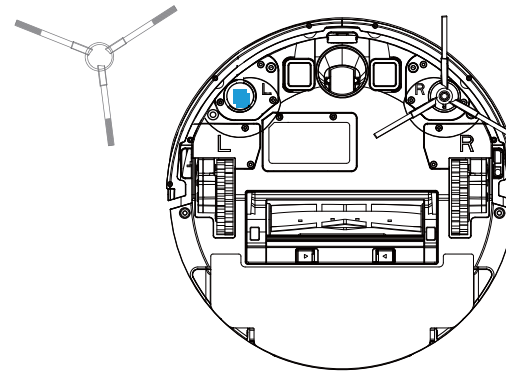

## Installation Using the robot

### 4. Power and charge

1. Auto: After cleaning, the robot will automatically return to the charging dock to charge.
2. Manual: In Pause mode, press the button to send the robot back to the charging dock.
3. Recharge by remote control.

Note:



1. The battery is fully charged to prolong the battery life. 5 hours charging time for the first time.
2. Please keep charging dock power on, or the robot can not find the charging dock.

Recharge Button "⬆️" Indication in Charging	
Charging Status	Indicator of Recharge Button "⬆️"
Low power/Back to charge	Flashing blue
Charging	Blue light
Charging completed	Blue light off

### 5. Power on/off/Pause

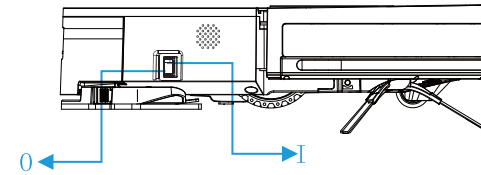
1. Turn on the main power switch "I" is turned on, "O" is turned off.



2. Press to  start cleaning  
(Start up the default "zig-zag" auto cleaning mode)
3. Press the  button again to stop cleaning  
(The robot is in standby mode)
4. The robot is not working if leaving dock station  
The robot will be in standby mode.  
If the robot does not work for a long time, please disconnect the power.

## Installation Using the robot

### 6. Water tank

1. Install the mop cloth.

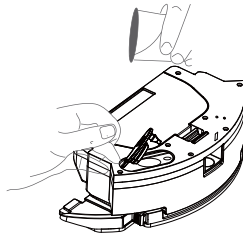
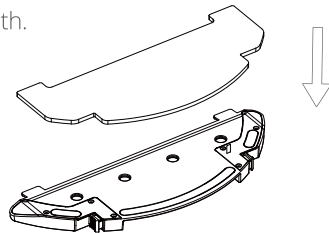

2. Open the water tank, fill it with water, and close it tightly

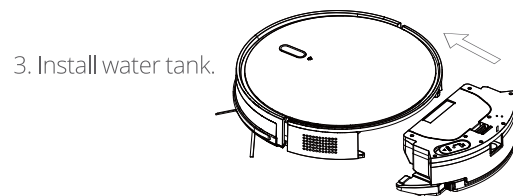

3. Install water tank.

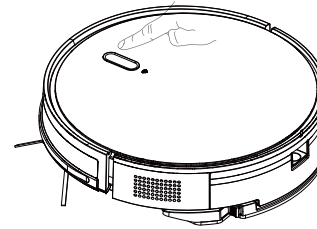

4. Start mopping.

Note:  
After finishing mopping  
Please empty the water tank. Take off the mop and clean it.

- Note:
- It is recommended that all floors are vacuumed at least three times before the first mopping session to reduce excessive dirt buildup on the mop.
  - To prevent corrosion or damage, do not use cleaning fluid or disinfection in the water tank.
  - Remove the mopping module after mopping, empty residual water and clean the mop cloth to prevent mildew or unpleasant odors.
  - Remove the mopping module if not mopping.

## Instructions for use

### Auto Cleaning

The robot defaults auto cleaning mode after power on.  
Zig-zag cleaning

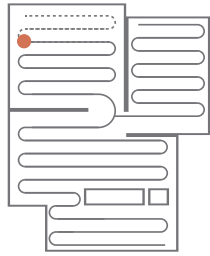

### Spot Cleaning

Applicable for garbage concentrated area.  
The robot cleans in a spiral shaped in designated area.  
After cleanup, the robot will return to the center of square.

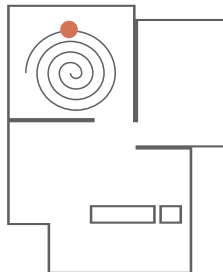

### Edge Cleaning

The robot cleans around the wall edge.

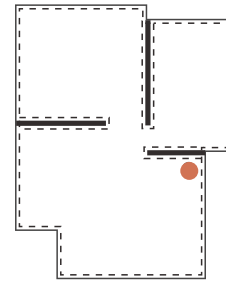

### Schedule Cleaning

Use the app to set start times for scheduled cleanups.  
The default cleaning mode is auto cleaning.

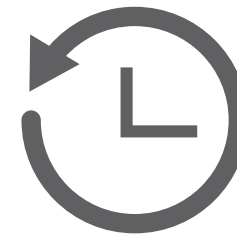

## Product Use/installation and network connection

**1、Download APP:** Download Smart Life APP, register and log in



## 2、Preparation

- Tap “+” on upper-right corner to add the device, and choose vacuum robot(Wi-Fi) under Small Home Appliance
- Pls make sure that the Wi-Fi is 2.4GHz and input correct Wi-Fi password.
- Long press the recharge button 3s', robot will prompt “Wi-Fi reset” and Wi-Fi indicator starts flash.

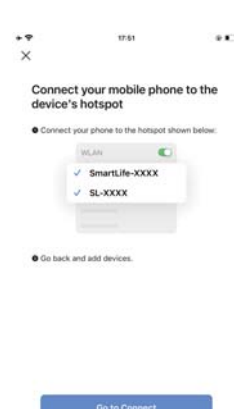
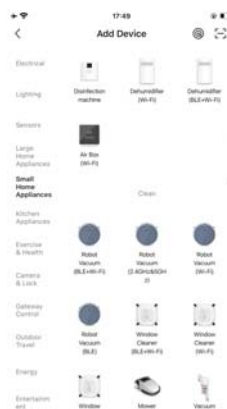
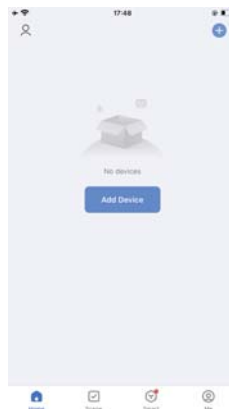

### 3、 Network connection

- Tick "Confirm indicator slowly blink" and then click" Next"
- Choose "AP Mode" from the pop-up window
- Find the password-less hotspot named SmartLife-XXXX from the mobile Wi-Fi list and connect it
- Return to Smart Life APP after successfully connect to hotspot Wi-Fi, click the bottom to confirm that the connection is correct, and continue to the next step
- Wait for the prompt of connection finished, then you can start operate the robot

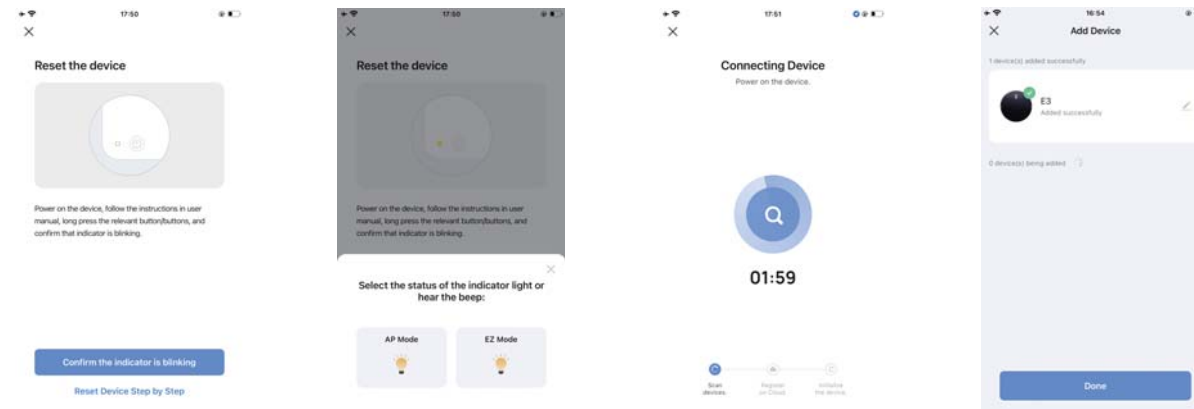

## App Instruction

### App interface

1. Three cleaning modes "Auto cleaning", "Edge cleaning", and "Spot cleaning".

Note: Change the cleaning mode, the current cleaning mode must be ended first.

2. Recharging: when the robot is in standby mode or auto cleaning mode, if you press the recharging button, and the robot will look for the charging dock for recharging.

3. Manual control: control the direction button / pause button / start cleaning.

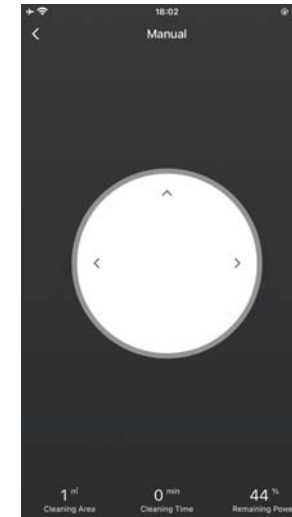
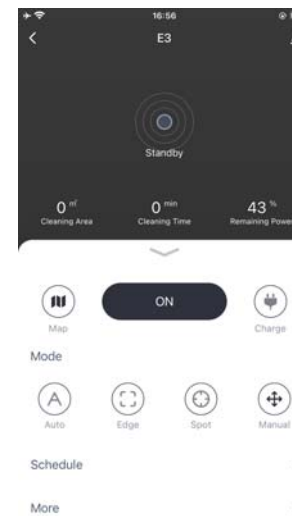
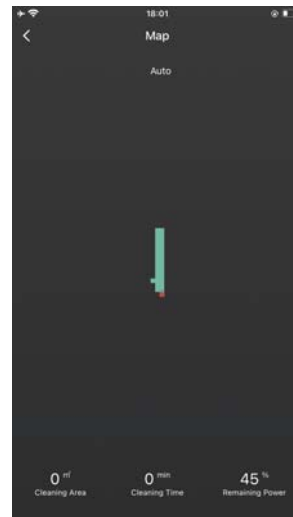
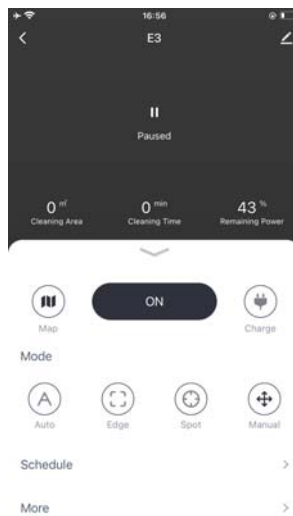



## App Instruction

4. Use the app to set start times for scheduled cleanups.  
Select scheduled cleaning and save the scheduled cleaning time



More :

1. Click "More" on the home page to enter more pages.  
and click to enter the corresponding function.
2. Click "seek robot ": the robot will voice prompt.
3. Consumables: side brush, main brush and filter life situations.

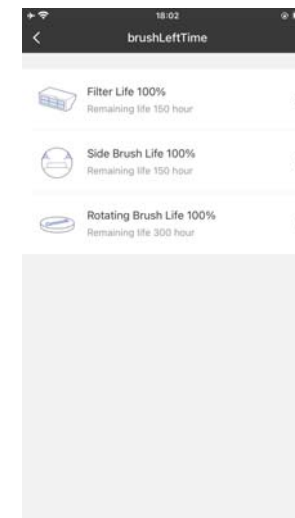
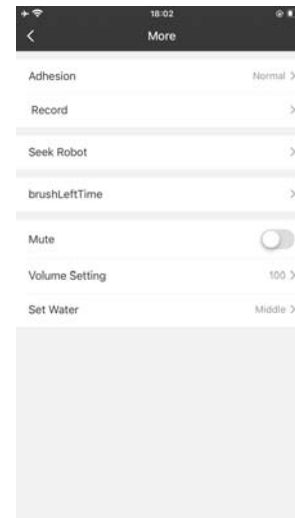

## App Instruction

4. Water quantity:Low,Middle,High.

5. Suction power: Quiet, Normal, Strong.

6. Mute switch: No voice prompt  
(except for the voice of finding the robot).

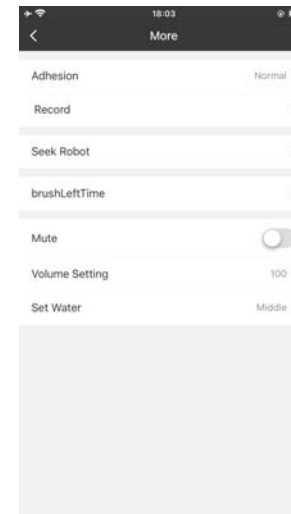
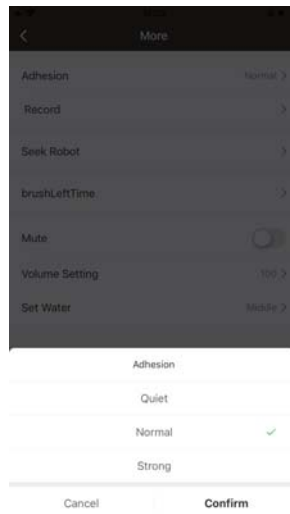
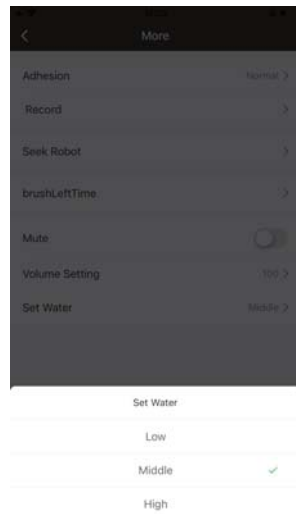

## App Instruction

### Setting

1. Click the upper right corner on the main control page to enter the robot settings page. And click to enter the corresponding function.

2. Adding share: Enter the robot account to be shared.  
3. Remove device: Click "Remove device" to remove the bound device from this account.

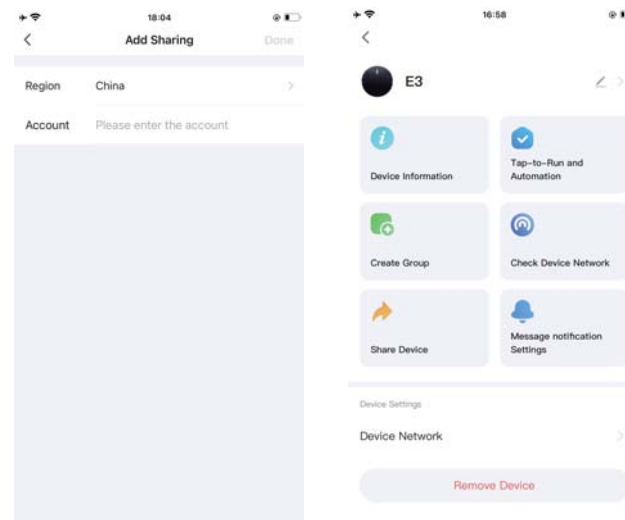
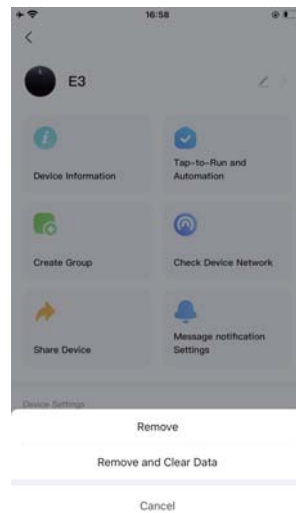

## App Instruction

### Use Your Robot with Amazon Alexa

Amazon Alexa is a smart voice control device that enables you to control Robot with your voice.

#### Before you start, make sure that:

- Robot is attached to the Charging Base to ensure there is enough power.
- Robot is connected with the Tuya app.
- You have an Alexa-enabled device.
- The Amazon Alexa app is already installed on your smart device, and you have created an account.

#### To control Robot with Amazon Alexa

- 1 Open the Amazon Alexa app and select "Skills" from the  menu.
- 2 On the Skills screen, search for "Amazon Echo".
- 3 Once you have found the "Amazon Echo" skill, tap Enable.
- 4 Login with your account so that Alexa can control your Robot
- 5 Say simple commands to Alexa.

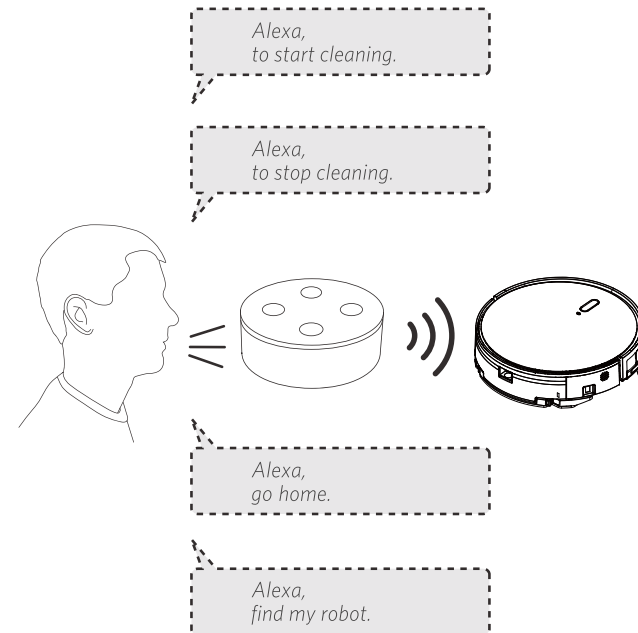

## Maintenance

### Main brush assembling and cleaning

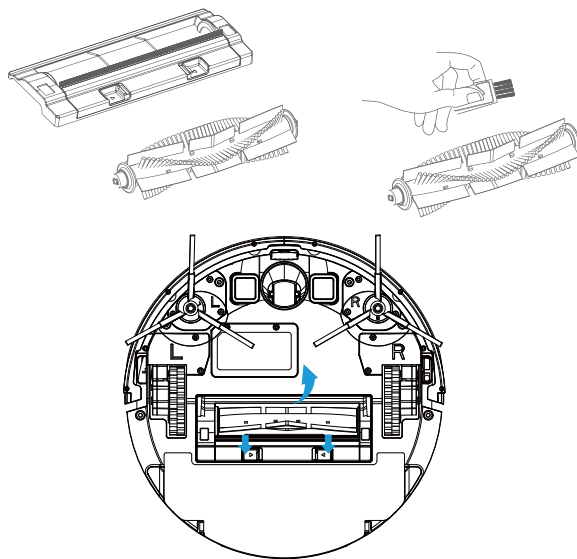

### Side brush cleaning

- A. Use a brush cleaning tool to cut off the entangled debris.
- B. Use a clean cloth to clean the side brush.

Note: Side brush replacement every 3-6 months is recommended to maintain cleaning quality.

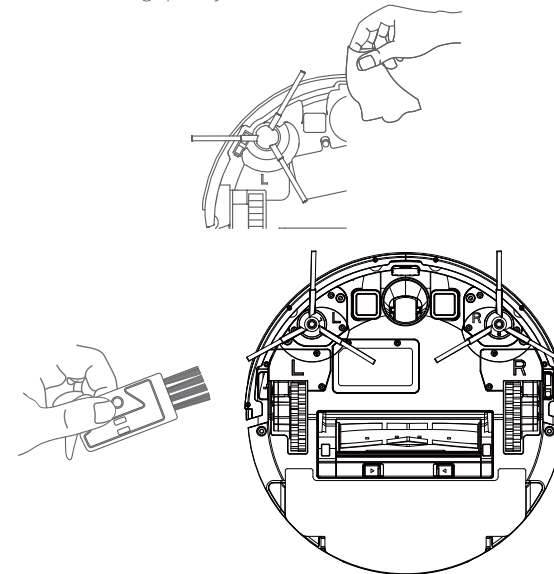

## Maintenance

C. When the side brush cannot be used, please remove the, damaged side brush and replace it in time

Note: Cleaning water must be lower than 60 degree Celsius

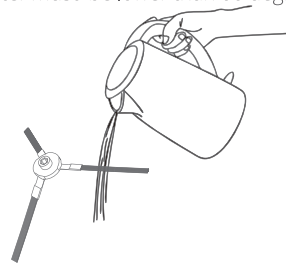

### Omnidirectional wheel cleaning

1. Turn the robot over.
2. Pull out the wheel upwards.
3. Reinstall after cleaning and press firmly.
4. Rinse the axle and the wheel with water to remove any hair and dirt.
5. Dry and reinstall the wheel then press it back in place.

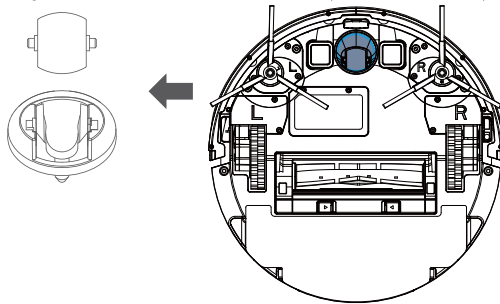

### Robot sensor and cleaning

Use a soft dry cloth to clean the sensors.

Note: Do not touch the sensors directly with liquids such as water and thinner.

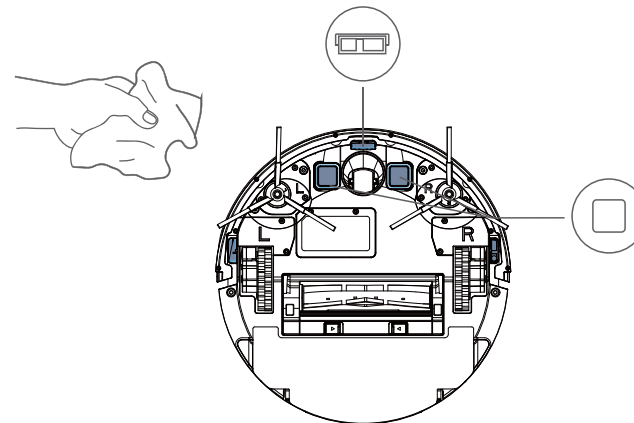
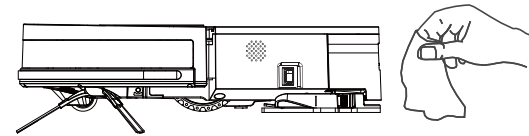

## Troubleshooting

Error	Solution
The main brush tangled up	Please clean the roller brush
The side brush tangled up	Please clean the side brush
A wheel is abnormal and the robot jammed	Please check the driving wheels
The dust bin abnormal installation	Please install the dust bin
Abnormal cliff sensor / dirty cliff sensor	Please wipe the cliff sensors
The robot is stuck	Please clean any obstacle around it
The bumper is stuck	Please check the front bumper
The robot is suspended	Please put the robot back on the ground

## FAQs

Problem	Solution
Unable to connect to WiFi	WiFi is disabled.Reset the Wi-Fi and try again. WiFi signal is poor.Make sure that the robot is in an area with good Wifi signal reception Only powered on, press the recharging button for 3-5 seconds and can enter smart network connection. Only 2.4G network is supported.

## FAQs

Problem	Solution
Unable to install the App	iOS 9.0, Android 5.0 and above systems, can download and use APP.
Unable to charge	If the charging dock is not receiving power, check that both ends of the power cable are properly connected. If contact is poor, clean the contact areas of the charging dock and the robot. Power is restored when the power indicator light turns on.
Difficult to recharge	There are too many obstacles near the charging dock. Move it to an open area. The robot is too far from the charging dock. Place it closer and retry.
Poor cleaning ability	It is recommended to clean up the ground debris first. If there is a part missing to clean, the robot will automatically schedule to clean it.
The robot is jammed	The robot will actively try various methods to get rid of jams. Or it is recommended to help manually.
Noise during cleaning	The main brush, side brush, or main wheels may be jammed. Turn off the robot and clean them. If the omnidirectional wheel is jammed, remove it for cleaning.
Pure suction power	The dust bin is full and needs emptying. The filter is blocked and needs cleaning. The main brush is jammed and needs cleaning. Let the filter foam to air dry.



## Product parameters

If the above methods cannot solve the problem, you can try the following:

1. Turn on the power switch on the side of the unit again and restart the machine.
2. If the machine keeps moving backwards, please pat the bumper with your hand and restart it.
3. If the machine does not move forward, please check whether the cliff sensor is blocked and clean the dust on the sensor cover.
4. If the problem cannot be solved by restarting, please return the machine to the after-sales service center for repair.

## The robot Parameters

Name	Parameter
Size	L320*W320*H76mm
voltage	14.4V
ated power	40W
Battery	2600mAh Li-battery
Charging base Output voltage	19V
Charging base output current	<b>600mA</b>

Remark: Storage temperature 0-45℃

## Docking station parameters

Name	Parameters
Size	L183*W140*H76mm
Rated input	19 V $\text{---}$ <b>600mA</b>
Rated output	19 V $\text{---}$ <b>600mA</b>
Rated power	50/60Hz



## Product parameter

Name and content of hazardous substances in the product

Name	Parts					
	Lead(Pb)	Mercury(Hg)	Mercury(Cd)	Hexavalent Chromium (Cr(VI))	Polybrominated Biphenyls (PBB)	Polybrominated Diphenyl Ethers (PBDE)
Circuit	×	○	○	○	○	○
Metal Parts	○	○	○	○	○	○
Plastic Casing	○	○	○	○	○	○
Battery	○	○	○	○	○	○
Other parts	○	○	○	○	○	○
<p>This form is compiled in accordance with the regulations of SJ/T 11364.</p> <p>○ Means that the content of the hazardous substance in all homogeneous materials of the part is below the limit requirement specified in GB/T 26572.</p> <p>×</p> <p>×</p> <p>Means that the hazardous substance at least in a certain homogeneous material of the part exceeds the limit requirement of GB/T 26572.</p>						



#### FCC Warning

This device complies with part 15 of the FCC Rules. Operation is subject to the following two conditions: (1) This device may not cause harmful interference, and (2) this device must accept any interference received, including interference that may cause undesired operation.

Any Changes or modifications not expressly approved by the party responsible for compliance could void the user's authority to operate the equipment.

This equipment has been tested and found to comply with the limits for a Class B digital device, pursuant to part 15 of the FCC Rules. These limits are designed to provide reasonable protection against harmful interference in a residential installation. This equipment generates uses and can radiate radio frequency energy and, if not installed and used in accordance with the instructions, may cause harmful interference to radio communications. However, there is no guarantee that interference will not occur in a particular installation. If this equipment does cause harmful interference to radio or television reception, which can be determined by turning the equipment off and on, the user is encouraged to try to correct the interference by one or more of the following measures:

- Reorient or relocate the receiving antenna.
- Increase the separation between the equipment and receiver.
- Connect the equipment into an outlet on a circuit different from that to which the receiver is connected.
- Consult the dealer or an experienced radio/TV technician for help.

#### FCC RF exposure statement:

The equipment complies with FCC radiation exposure limits set forth for an uncontrolled environment. This equipment should be installed and operated with minimum distance between 20cm the radiator your body.

#### IC Caution:

Radio Standards Specification RSS-Gen, issue 5 - English: This device contains licence-exempt transmitter(s)/receiver(s) that comply with Innovation, Science and Economic Development Canada's licence-exempt RSS(s). Operation is subject to the following two conditions: This device may not cause interference. This device must accept any interference, including interference that may cause undesired operation of the device.

#### RF exposure statement:

The equipment complies with IC Radiation exposure limit set forth for uncontrolled environment. This equipment should be installed and operated with minimum distance 20cm between the radiator and your body.

- French: Cet appareil contient des émetteurs / récepteurs exemptés de licence conformes aux RSS (RSS) d'Innovation, Sciences et Développement économique Canada. Le fonctionnement est soumis aux deux conditions suivantes: Cet appareil ne doit pas causer d'interférences. Cet appareil doit accepter toutes les interférences, y compris celles susceptibles de provoquer un fonctionnement indésirable de l'appareil.

#### Déclaration d'exposition RF:

L'équipement est conforme à la limite d'exposition aux radiations de la IC établie pour un environnement non contrôlé. Cet équipement doit être installé et utilisé avec une distance minimale de 20cm entre le radiateur et votre corps.