

Hulaed

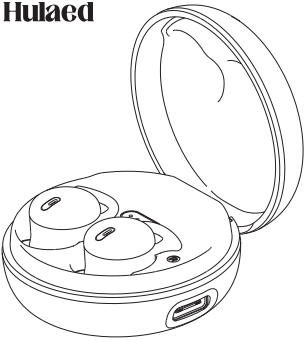

Wireless Sports Earphones
User Manual

Packing List



Charging Case x1



Earphone x2

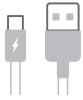

Type-C USB Cable x1
Support data transmission



User Manual x1

1/11

Product Overview

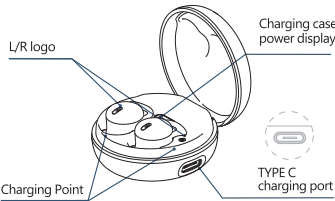
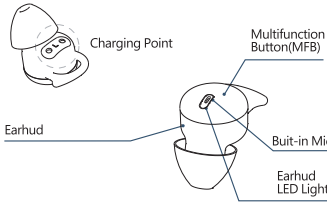

2/11

Charge

First time use, please charge it fully

Charging Status of Earphones

When being charged, earphones's LED indicator will illuminate white;
When fully charged, earphone's white indicator will on for 3 seconds then go off

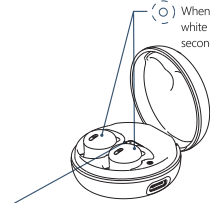

Battery Indicator of Charging Case

When charging, the pilot lamp will show the real-time power of the charging case Increasing by 25% left-to-right;
When fully charged,the pilot lamp will on 100% all the time until the power supply is cut off.

3/11

Power on

Auto Power On:

Take out the earphone from the charging case, it will turn on automatically.

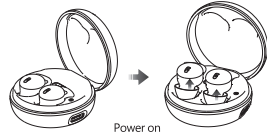

Power on

Manual Power On:

Press & hold MFB for about 3 secs, then earphone's indicator flashes white alternately, which means it turns on and is ready to pair.

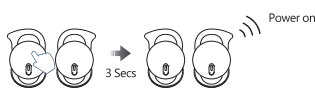

4/11

Power off

Auto Power Off:

Put the earphone back into the charging case, it will turn off automatically.

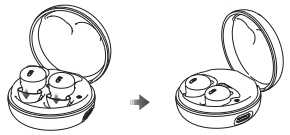

Power off

Manual Power Off:

In non-music mode, press & hold MFB about 10 secs, it will turn off with a prompt sound "power off".



5/11

How to pair



Step 1

Take out the earphones from the charging case, they will power on and pair with each other automatically.
(You should hear a prompt sound "power on" then "pairing" when first connection.)

Step 2

Activate Bluetooth setting on your phone, search

(There should be a voice prompt "connected" if you wear the earphones.)



6/11

Music

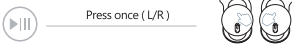

Play/Pause

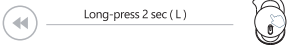

Previous Track

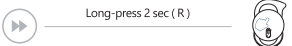

Next Track



Volume down



Volume up

7/11

Incoming Call

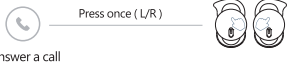

Answer a call

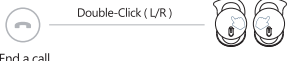

End a call

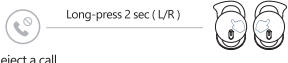

Reject a call

Switching to sleep mode

When connected to the phone, tap the left or right earbud button 4 times to switch to sleep mode, then prompt "sleeping mode." No beeps or breathing lights allowed.

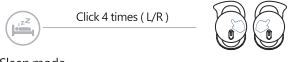

Sleep mode

8/11

Specifications

Model: Q26S
Bluetooth Version: V5.3
Support Profiles : HFP/HSP/A2DP/AVRCP
Charging Time(Earbud): 1 hours
Charging Time(Charging case): 1 hours
Battery Capacity(Earbud): 45mAh
Battery Capacity(Charging case): 250mAh
Charging Port: TYPE-C
Charging Voltage : DC 5V
Operating Frequency: 2.402G - 2.480G
Operating Range: 10m
Dimension of Speaker: 6mm

Voice Assistant

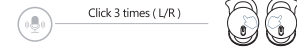

Active Siri/Assistant

Voice Assistant Language

When the phone is not connected

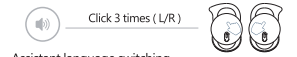

Assistant language switching

9/11

Warnings

To ensure trouble -free operation, please read user manual carefully.
Fully charge both earphones and charging case when first-time use.
Do not throw/drop/disassemble/make any modifications to the structure or any part of it.
Please charge with a rated voltage charger.
Do not replace the built-in batteries of earphones and charging case.
Do not expose the product to fire, high temperature, direct sunlight, etc

10/11

FAQ

Q Why does the music cuts in and out sometimes?

A 1-Please make sure there is no obstacle between the earphones and your device.
2-Please make sure there is no Microwave oven/WIFI transmitter around you, which is more likely to produce electromagnetic interference and result in signal interruption.

* Note: Please keep the device and the earphones as close as possible to ensure a more stable Bluetooth connection.

Q What should I do if the earphones stop charging?

A 1-We advise you to charge the earphones by using the supplied original charging cable.
2-Please make sure the charging pins and charging points are clean & dry before charging.
3-Please make sure the earphones battery is run out if sometimes it can't be charged properly.

11/11

This device complies with part 15 of the FCC Rules. Operation is subject to the following two conditions: (1) This device may not cause harmful interference, and (2) this device must accept any interference received, including interference that may cause undesired operation.

Any Changes or modifications not expressly approved by the party responsible for compliance could void the user's authority to operate the equipment.

Note: This equipment has been tested and found to comply with the limits for a Class B digital device, pursuant to part 15 of the FCC Rules. These limits are designed to provide reasonable protection against harmful interference in a residential installation. This equipment generates uses and can radiate radio frequency energy and, if not installed and used in accordance with the instructions, may cause harmful interference to radio communications. However, there is no guarantee that interference will not occur in a particular installation. If this equipment does cause harmful interference to radio or television reception, which can be determined by turning the equipment off and on, the user is encouraged to try to correct the interference by one or more of the following measures:

- Reorient or relocate the receiving antenna.
- Increase the separation between the equipment and receiver.
- Connect the equipment into an outlet on a circuit different from that to which the receiver is connected.
- Consult the dealer or an experienced radio/TV technician for help.

FCC Radiation Exposure statement

The device has been evaluatec to meel general RF exposure requirement. The device can be used in portable exposure condition without restriction.