

User Manual Ver.1.0

Wireless CarPlay | Android Auto Media Player

Vehicle Backup Camera System

7 inch



CONTENTS

Content.....	
ProductSpecification.....	
ProductPort.....	
FunctionIntroduction.....	
1.Carplay Connection Method.....	
2.Disconnect Carplay.....	
3.Android Auto Connection Method.....	
4.Disconnect Android Auto.....	
5.iPhone Screen Mirroring Method.....	
7.Audio Out put Mode.....	
8.Connection Troubleshooting.....	
10.TF CardPlayer.....	
11.Rearview Cam.....	
12.Shortcut Buttons Functions.....	
13.System Setting.....	
14.Drop-DownMenu.....	
15.InstallationGuide.....	
1.Mounting Bracket.....	
2.AdjusttheViewing Angle.....	
3.InstallationofEquipment.....	
4.RearviewCameraInstallation.....	
5.GuideLineCustomization.....	
7.Customer Service.....	
8.Package.....	

Product Specification

Key Component	Main Chip	F133-B
	ROM	1GB
	Display	7 inches; Resolution:1600*600
	TP	7 inches Capacitive Touch Screen
	Wi-Fi	2.4G/5.8G Wi-Fi
	Loudspeaker	Built-in
	Microphone	Built-in
Port	TF card Slot	Expansion memory TF card: Up to 64GB
	Type-C Jack	Type-C (Power supply mode: Car Charger or Buck Line)
	AUX Jack	One AUX 3.5MM Jack
	AV In Jack	One rear camera jack (2.5MM, 4-segment headphone holder) Support being triggered by reverse gear.
Camera	Rear Camera	CVBS or AHD720P or AHD1080P
Physical Buttons	Standby Key	One (screen and audio on/off)
	Reset Key	One
Software	OS	RTOS
	UI	Built-in Bespoke UI
	Projection screen	Wireless Carplay / Wireless Android Auto
	Language	Supported languages (Simplified Chinese, English, Japanese, Russian, French, etc.)
	Music	Synchronize mobile phone music
	Local audio play	Support: MP3/WAV/WMA/AAC/OGG/FLAC
Local video play	Support: MP4	
Environment	Work Voltage	DC 5V
	Work Current	<1.5A
	Work Temp	-10°C ~ 60°C
	Store Temp	-20°C ~ 70°C

Product Port:



Key Function

1) Screen & Audio Switch Key

- Start the car engine, and the device turns on automatically about 3-5 seconds.
- Short press the switch key to turn on/off the screen and sound only, and the system is still working. **It is not the Power Off Key.**
- This key is not available on some models.
- **[Attention:] For vehicles with continuous power supply for cigarette lighters, it is necessary to pay attention to unplug the car charger after flameout.**

2) Reset Key (On the back of the device)

If the device crashes or has other faults, short press the Reset Key to restart.

Function Introduction

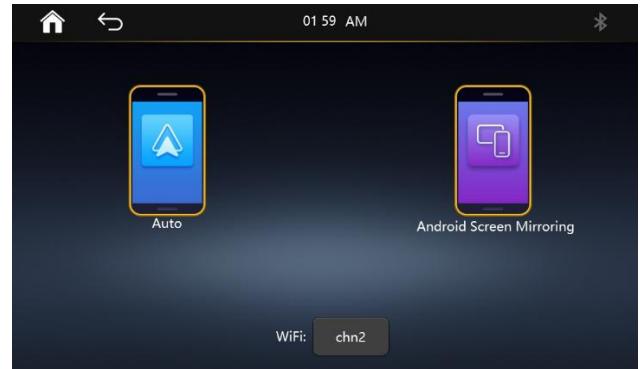
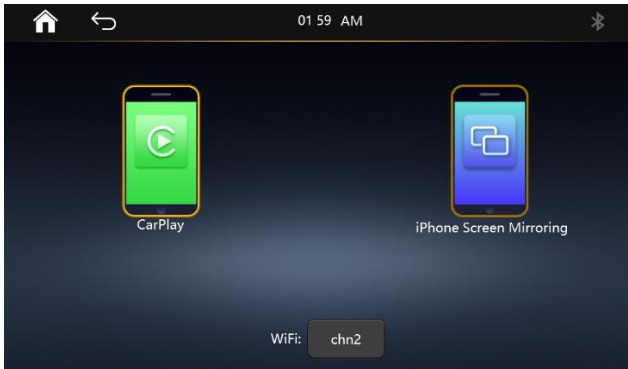

Click on Carplay or Auto icon to enter and select four link modes: Carplay, iPhone Screen Mirroring, Android Auto, Android Screen Mirroring.

1 Carplay Connection Method

- 1.1** Pressing the "Carplay" icon, you can view the device's BT name as "CarKit-****".
- 1.2** iPhone Setup follows the steps: Settings → Turn on → Search & select "CarKit-****" → Pair & Agree "Use"
- 1.3** As long as your iPhone has been paired, it will automatically enter Carplay function next time.
- 1.4 [Attention]:** Please make sure that your iPhone IOS version above

2 Disconnect Carplay

Turn off your iPhone WLAN: Settings → WLAN → Turn Off WLAN and your iPhone will Pop-up alert "Turn On WLAN to Use Wireless Carplay".

- Select "Close" to disconnect Carplay immediately.
- Choose "Turn On" to continue to use Carplay.
- At Any time, turn on the WLAN will resume using Carplay.

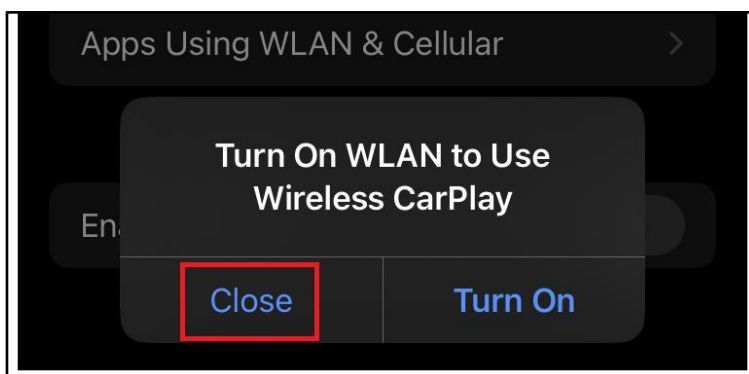

3 Android Auto Connection Method



3.1 Pressing the "Android Auto" icon, you can view the device's BT name as "CarKit-****".

3.2 Android phone setup follows the steps: Settings → Connected Devices → Pair new device → Search & select "CarKit-****" → Pair → Allow access to message → Set Successfully.

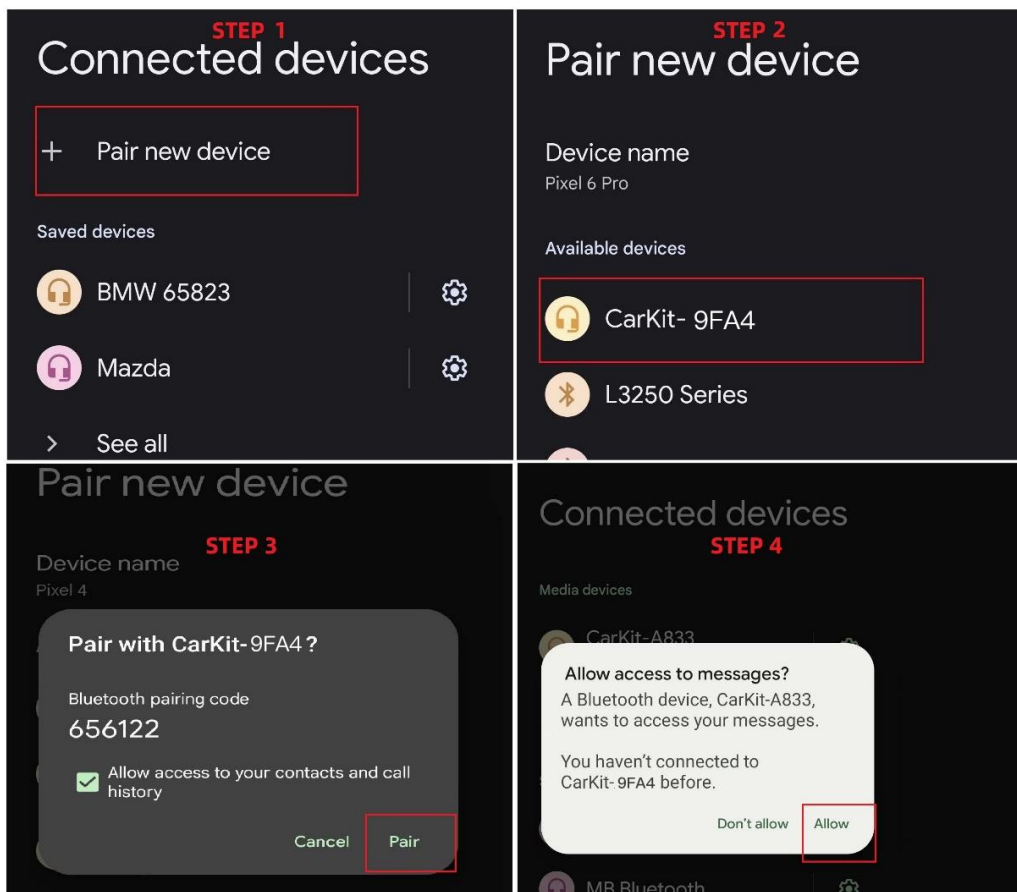

3.3 As long as your Android phone has been paired, it will automatically enter Android Auto function next time.

3.4 [Attention]: Please make sure that your Android version above 10 and your phone has Bluetooth enabled.

4 Disconnect Android Auto:

Turn off your Android phone WLAN: Settings → Network & internet →

Turn Off WLAN → Disconnect Successfully.

➤ At Any time, turn on the WLAN will resume using Android Auto.

Note: Please Keep Bluetooth Enable.

5 Attention

When Carplay / Android Auto is disconnected, the device system will return to the main interface, and you should know as follows:

➤ For Carplay: it will return to the main interface immediately at any time.

➤ For Android Auto: The first disconnection operation will stay in the Android Auto interface for a few seconds and it is normal to be unable to operate.

6 Disconnect Bluetooth:

6.1 when Carplay / Android Auto disconnects, this device system returns to the main interface, and you can make a Bluetooth phone call or just play Bluetooth music. (At this moment, your mobile phone Bluetooth is still connected with this device).

6.2 If you want to disconnect the Bluetooth with the device, please disconnect it at the device end. As shown in the figure below.

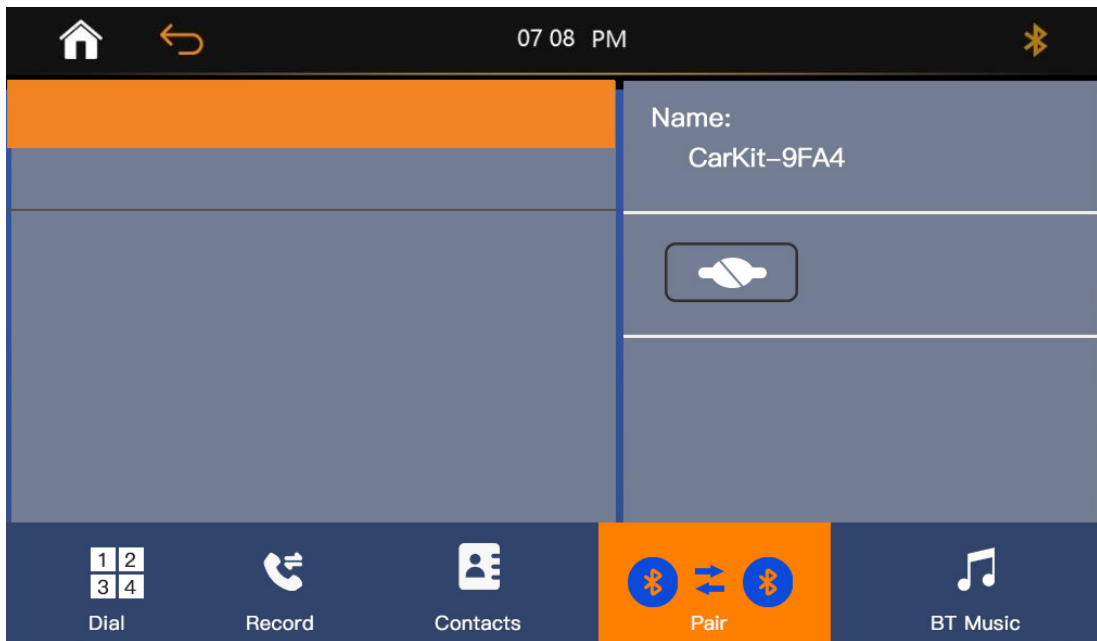

7.1 FM Transmit

7.1.1 The frequency ranges from 87.5MHz to 108MHz.

7.1.2 You can click or swipe left/right at the top to quickly select a frequency band, or you can click the Left or Right arrow to select precisely on the right.



7.1.3 Switch to FM transmission to turn it on.

If FM is turned on, the sound will be played by the car audio system through the car radio.

Please turn on the car radio and tune it to the corresponding frequency for reception before using this function, as shown in the figure below.



[Attention]:

For better sound quality, please use an unoccupied frequency band.

patiently for a few seconds, and the phone will switch automatically.

7.2.3 iPhone screen mirroring does not support transmission.

7.2.4 transmission only supports mobile phone content, which is not supported by the TF card of the device.

8 Connection Trouble shooting:

Summary of Connection / Disconnection

- Connect Carplay / Android Auto: Pair your mobile phone with the device to connect and enter the functions.
- Disconnect Carplay / Android Auto: Turn Off your mobile phone WLAN to disconnect and exit the functions.

- Disconnect : Operate at the device end.

Trouble shooting

If the above linking operation is not successful, please follow the guidelines:

- 1)** Forget the connected device's try to reconnect.
- 2)** Please restart both your mobile phone & the device, and try again.
- 3)** Check Android phone settings:

Check whether used the proxy VPN network, when your phone uses the proxy VPN network, Android Auto will be prohibited. Please exit the "Proxy VPN" network and try again. Or, Search and check **whether Android Auto is installed & run** on your phone.

- 4)** Check Apple iPhone settings:

- Setting → General → Carplay:

Our device's Carplay name is "BLH", Check whether there is another connected Carplay, if there is, please turn off or forget it.

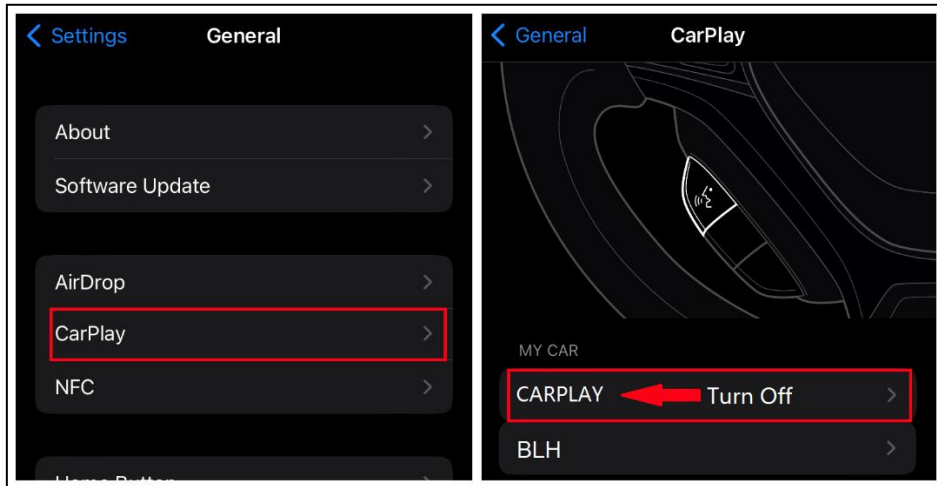

- Setting → General → Carplay → BLH, check whether BLH Carplay setting is turned off, please turn on and try again.

[Attention]: According to the above operations, it is still unable to connect, please consult our customer service personnel for help.

10 TF Card Player

Press the "TF Card" icon to enter. If the TF card is not inserted, it will prompt "SD Card Invalid" in the upper left corner.

10.1 You can view audio/video files and folders stored in TF card here.

10.2 When you click on any audio/video, you will enter the media player interface.

11 Rearview Cam

11.1 Please refer to page 19 Rearview Camera Installation before using.

11.2 If the rearview camera is not installed, it will display "No Signal".

11.3 "Rearview Cam" can be triggered in two ways:

Press "Rearview Cam" icon or Reverse gear of vehicle.

a. In case of being triggered by reverse gear, it will automatically enter and display the rear view image.

b. In case of triggering by pressing the "Rearview Cam" icon, it will





only be displayed for 60 seconds for driving safety.

[Safety Warning]:

When driving normally, please try not to turn on the rearview cam to avoid distracting attention.

If the reversing screen is interrupted by Carplay, Android Auto or Bluetooth, you can click the main interface icon "Rearview Cam" to re-enter.

12 Shortcut Buttons Functions

-  "Volume +", Increase the volume. Default & Max values is 30.
-  "Volume -", Reduce the volume. Min values is 0.
-  "Mute", Mute or resume.
-  Quickly brightness adjusts, 100% → 50% → 0% → sleep, Cycle.

13 System Setting



13.1 Basic Setup

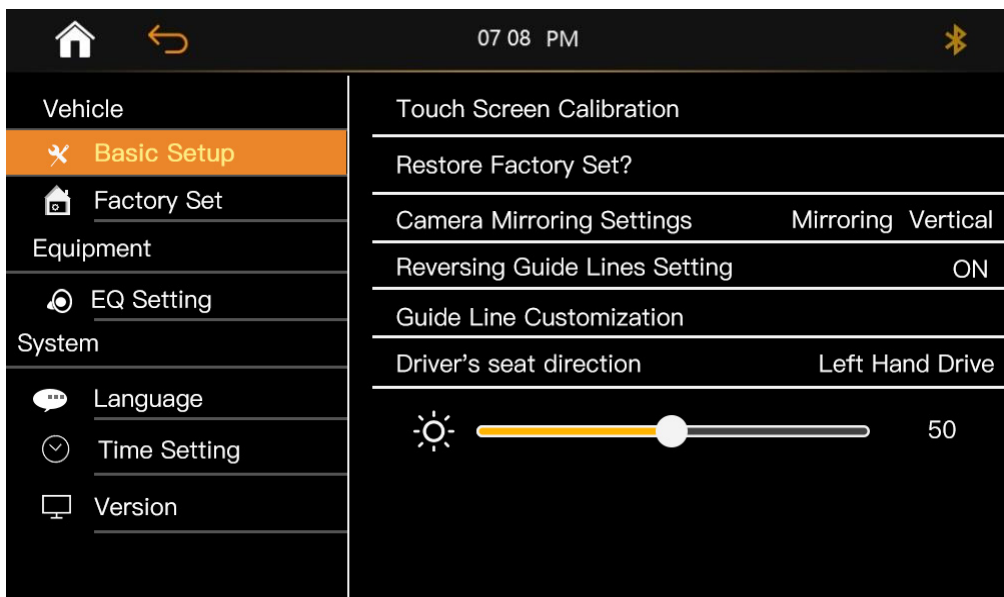

- a. Touch Calibration: Click on the cross star twice according to the prompt to complete the touch screen calibration.
- b. Restore Factory: Press to restore the default factory settings.
- c. Camera Mirroring: Used to change the image display direction.
 - Mirroring OFF: means display camera image directly.

- Mirroring Horizontal: means the Left-Right mirroring.
- Mirroring Vertical: means the Up-Down mirroring.
- Fully Mirroring: means both the Left-Right& Up-Down mirroring.

d. Display brightness Adjust, from 0 to 100.

e. Reversing Guide Lines setting, default On.

If it is turned on, the reversing Guide line will be displayed in the reversing screen.

f. Guide Line Customization:

Click and drag the coordinate point on the screen to quickly move to the target position you want to adjust. The keys on the top can be used for fine adjustment.

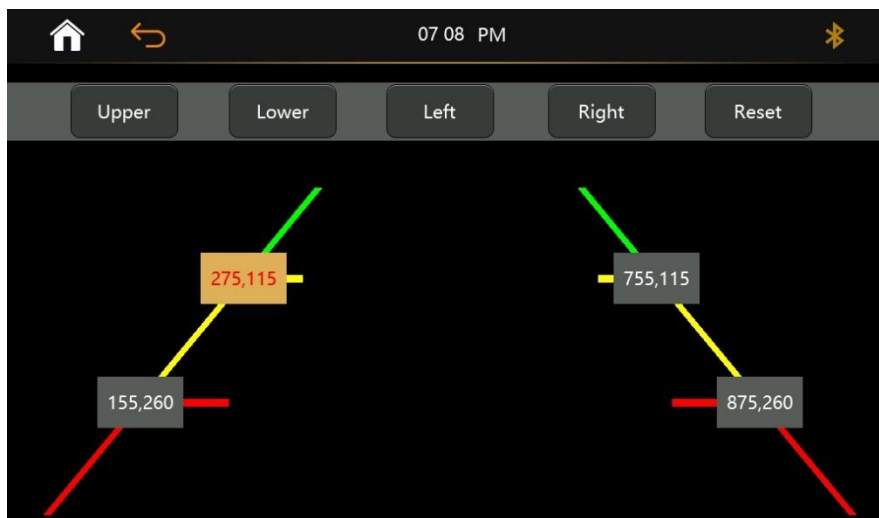

g. Driver's seat direction: Left Hand Drive or Right Hand Drive.

13.2 Factory Set

Professional maintenance, not suitable for end users. Password protection.

13.3 EQ Setting

You can adjust the sound effect parameters according to your own needs.

13.4 Language

There are 14 languages to choose from, you are free to change the languages of different countries. Default English.

13.5 Time Setting

Linking your mobile phone and **allowing access to messages** will automatically synchronize the time. Or set manually here.

13.6 Version:

View device software version information here.

14 Drop-Down Menu

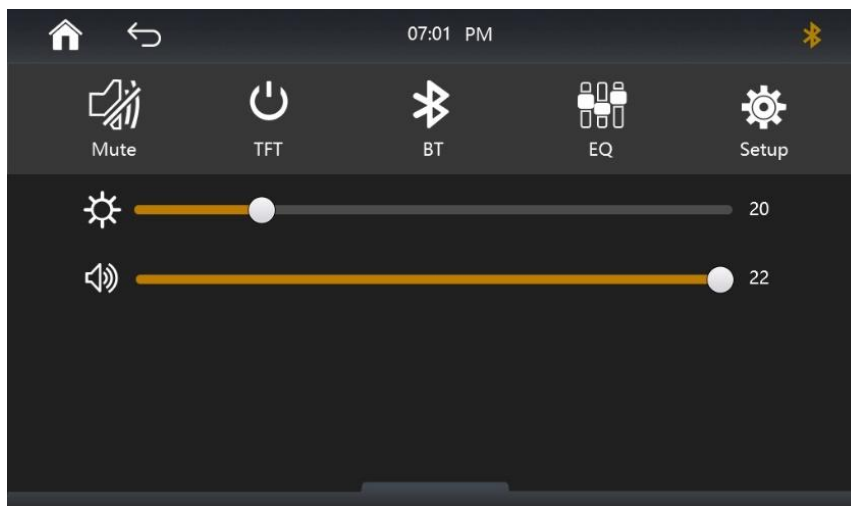

Installation Guide

1 Universal Mounting Bracket



2 Adjust the viewing angle of the screen by 360 degrees

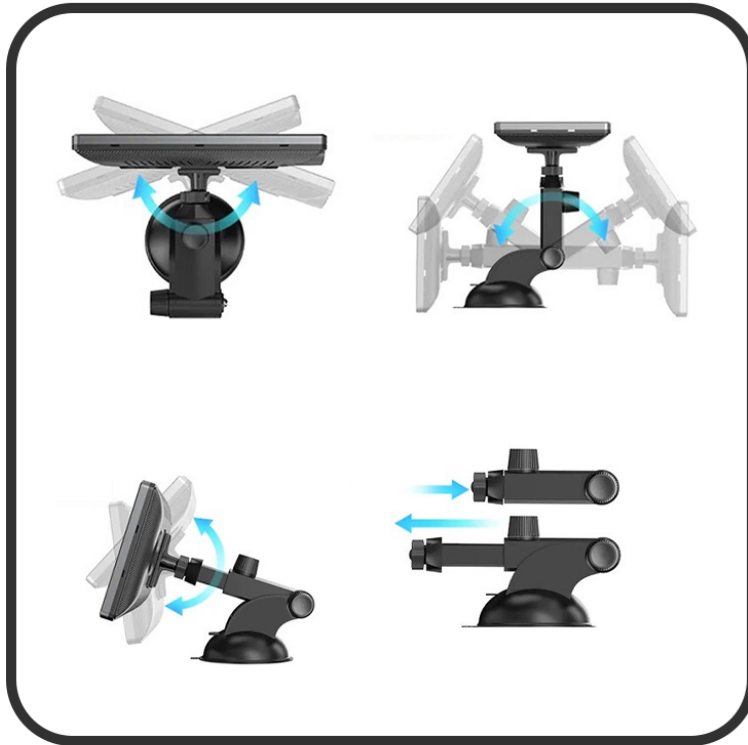

3 Installation of Equipment

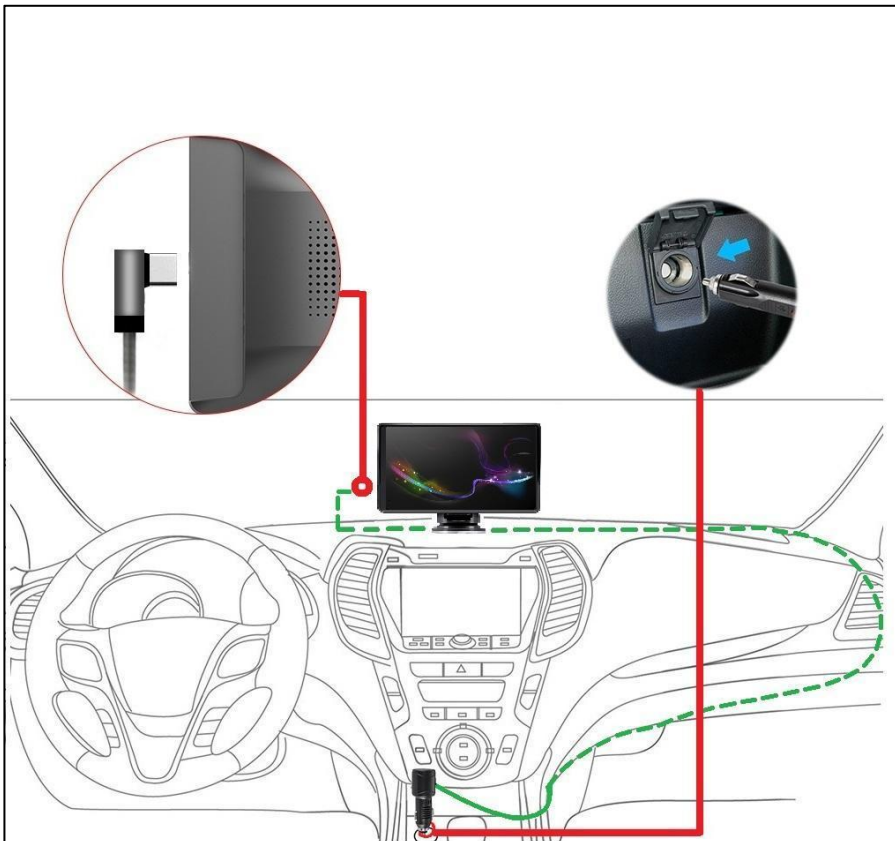

[Attention]: The products come with a certified car charger as standard, please do not use unauthorized car charger to avoid damaging the device.

4 Rearview Camera Installation

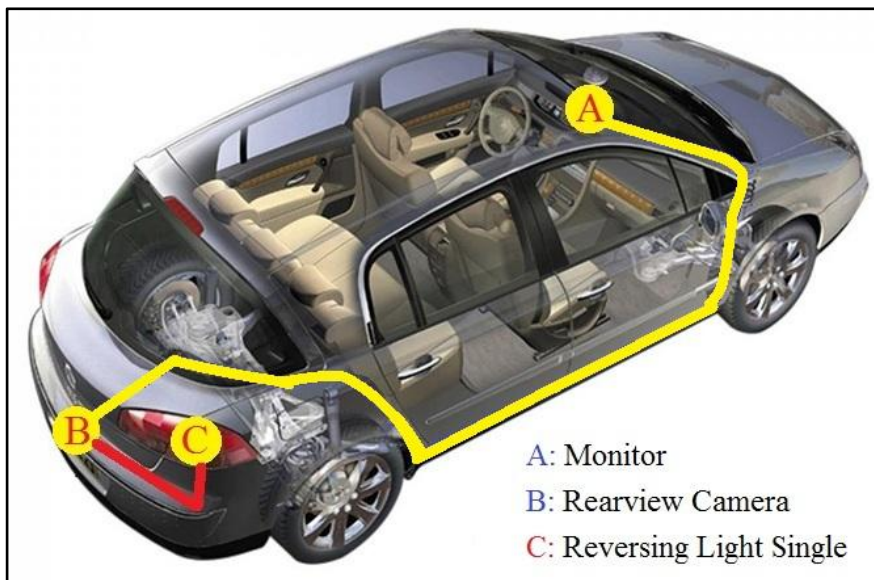

4.1 As shown in the figure, the yellow line is a schematic wiring diagram of the extension line of the rearview camera. (From A to B)

4.2 The red short line at the end of the extension line is the reversing trigger line, which is connected with the power line of the reversing light. When reversing, the rearview camera will be triggered to work.

(From B to C)



4.3 Schematic diagram of different types of wiring.

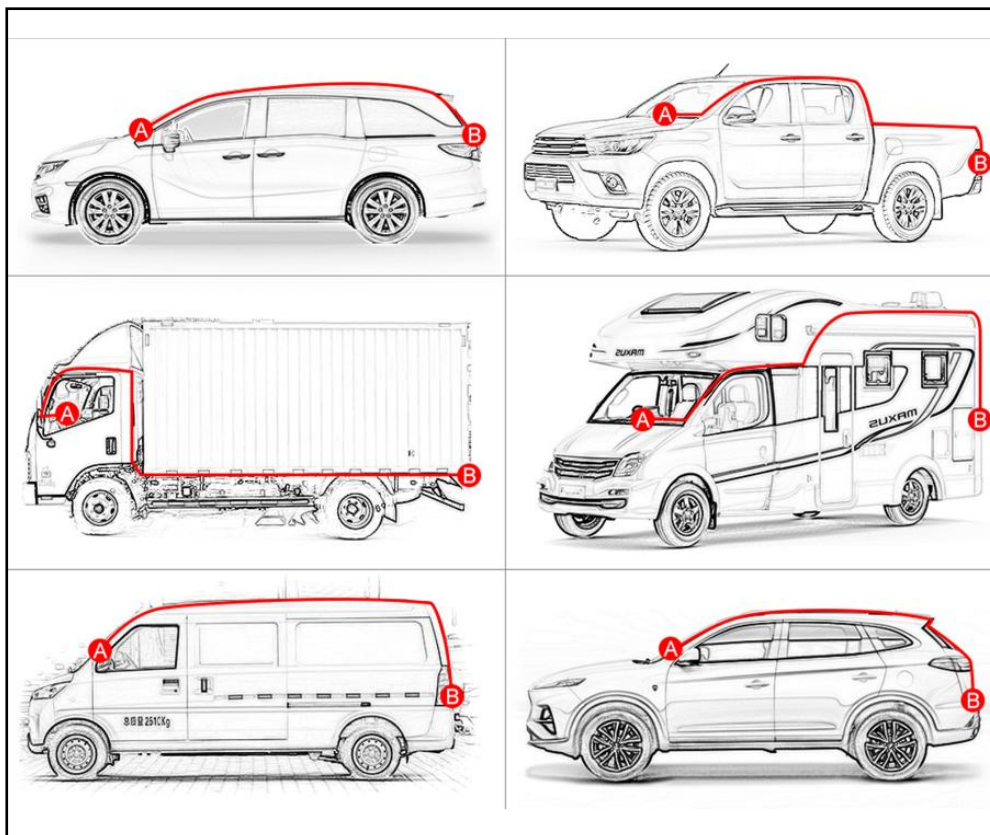

[Attention]:

As the models are different, please ask professionals to help you install them. These methods are for reference only.

4.4 After installation is completed, start the engine and put it into reverse gear. Check whether the monitor automatically displays the rear view image. If it does not work properly, please check whether it is installed correctly.

4.5 The last installation step is to adjust the rearview camera angle. Please observe the monitor and adjust the camera angle to make sure that the rear bumper is clearly visible. It is suggested that the rear

bumper should occupy 5% of the screen image.

Then, lock the lens bracket screws, and end all installation.

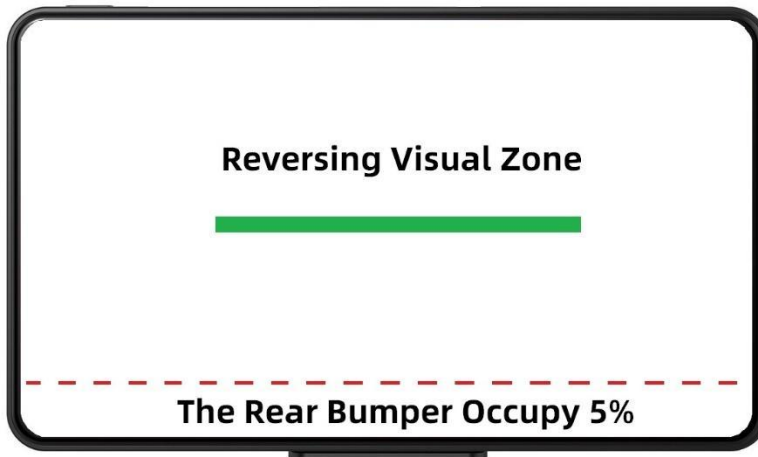

[Attention]:

Adjusting the lens angle to see the bumper can improve the safety of reversing, please install in strict accordance with the instructions.

5 Guide Line Customization

After all the hardware is installed, the last step is to enter system setup to adjust the reverse guide line.

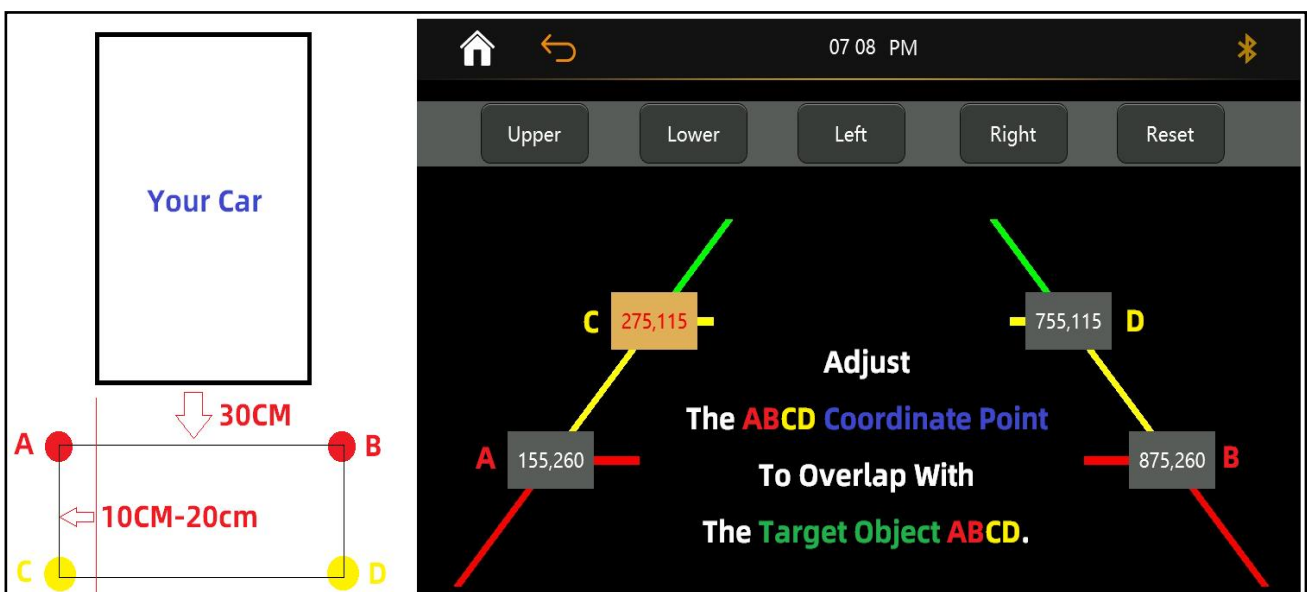

- 5.1** Click and drag the four coordinate points on the screen to quickly move to the target position you want to adjust. The up, down, left, and right keys on the top can make fine adjustments to each coordinate.
- 5.2** Place four target markers (such as water bottles) at the rear of the vehicle to indicate the width of the vehicle and the distance from the rear bumper.
- 5.3** Suggested placement of the four target markers.
- Target Marker A&B: 30cm from the rear bumper, 10-20cm wider than the car body.
 - Target Marker C&D: Point C is in a straight line with point A and the car; Point D is in a straight line with point B and the car.
- 5.4** Adjust the ABCD coordinate point to overlap with the target object ABCD marker. Then, Fine-tune with the up and down keys to ensure that A and B, C and D are on the same level.

Customer service:

Our mission:

Product Satisfaction, Service Satisfaction and Customer Satisfaction.

Please feel free to contact our technical experts for technical support and service. On working days, we will reply to your request within 48 hours. (Except Chinese holidays and weekends).

Package:

User Manual *1

7 Inch Car Media Player *1

Universal Mounting Bracket *1

Cigarette Lighter Plug *1

AUX Cable *1

Rearview Camera *1 (Optional Accessories)

Rearview Camera Extension Wire-5.5M *1 (Optional Accessories)

Made in China

FCC Warning:

This equipment has been tested and found to comply with the limits for a Class B digital device, pursuant to part 15 of the FCC Rules. These limits are designed to provide reasonable protection against harmful interference in a residential installation. This equipment generates, uses and can radiate radio frequency energy and, if not installed and used in accordance with the instructions, may cause harmful interference to radio communications. However, there is no guarantee that interference will not occur in a particular installation. If this equipment does cause harmful interference to radio or television reception, which can be determined by turning the equipment off and on, the user is encouraged to try to correct the interference by one or more of the following measures:

- Reorient or relocate the receiving antenna.
- Increase the separation between the equipment and receiver.
- Connect the equipment into an outlet on a circuit different from that to which the receiver is connected.
- Consult the dealer or an experienced radio/TV technician for help.

Caution: Any changes or modifications to this device not explicitly approved by manufacturer could void your authority to operate this equipment.

This device complies with part 15 of the FCC Rules. Operation is subject to the following two conditions:

(1) This device may not cause harmful interference, and (2) this device must accept any interference received, including interference that may cause undesired operation.

This equipment complies with FCC radiation exposure limits set forth for an uncontrolled environment. This equipment should be installed and operated with minimum distance 20cm between the radiator and your body.