

User Manual

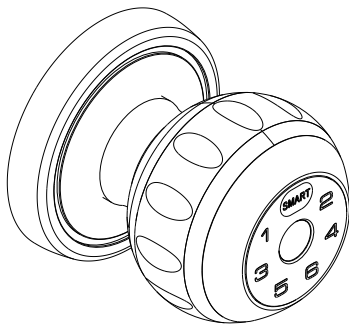

Parameters

Cover: D70mm /

Lever: L150mm /

Height: 62mm

Material:

Aluminum alloy+Acrylic

Available Thickness:

30mm ~ 50mm

Unlock Way:

Key/Fingerprint/password/Tuya APP

Power Supply:

4 x AAA Alkaline Batterys

Working Voltage: 6V

Alarm Voltage :4.8V

Capacity:

Administrator——3sets

Fingerprint——30sets

Password——25sets

Important

1. In the initialized state, any fingerprint and default administrator password can be unlocked 123456.

2.SMART=Confirm key. The password is 6 characters long.

3. In order to ensure the sensitivity of fingerprint unlocking, it is recommended to use the index finger or middle finger to unlock, and at the same time, it is recommended to record more than three fingerprints with the same finger. In this way, the success rate of fingerprint unlocking can be improved.

Menu function

1+SMART Enroll Administrator

Click 1+SMART to enter the administrator registration menu, the password screen flashes prompts you to enter the initialization administrator password 123456 and press the SMART button to finish, enter the new 6-digit administrator password and press SMART to finish, and then enter it again and hear a long sound to indicate that the administrator password is successfully entered. The first admin must be a password. A total of three administrators can be entered, and the second and third administrators can be fingerprints or passwords. If you register the administrator's fingerprint, after verifying the administrator's password, put your finger on the fingerprint head and press it 6 times in a row, and finally hear a long beep indicating that the administrator's fingerprint entry is successful.

2+SMART Enroll Users

Click 2+SMART to enter the ordinary user registration menu, the password screen flashes and enters, enter the administrator password + SMART key or administrator fingerprint, such as the registered password user, enter the 6-digit password, press SMART and then enter it again, and hear a long sound to indicate that the user's password is successfully entered. For example, if you are a registered fingerprint user, put your finger on the fingerprint head and press it 6 times in a row, and hear a long beep to indicate that the fingerprint user has successfully entered the fingerprint. A total of 15 groups of password users and 30 groups of fingerprint users can be entered.

Important note: In order to ensure the sensitivity of fingerprint unlocking, it is recommended to use the index finger or middle finger to unlock, and at the same time, it is recommended to record more than three fingerprints for the same finger, so that the success rate of fingerprint unlocking can be improved.

3+SMART Add A Temporary Password

Click 3+SMART to register the temporary password, the password screen flashes, enter the administrator password + SMART key or the administrator's fingerprint, enter the 6-digit password, press SMART and re-enter it again, and hear a long beep to indicate that the temporary password is successfully entered. A total of 10 sets of temporary passwords can be entered by people.

Tip: The temporary password will become invalid after one use.

4+SMART Delete a normal user

Click 4+SMART to enter the delete normal user menu, the password screen flashes to enter the administrator password + SMART key or administrator fingerprint. There are two deletion methods, the first is designated deletion, enter the password to be deleted + SMART or fingerprint, and hear a long beep to indicate that the deletion is successful. The second way is to enter the 1234+SMART key to delete all common user passwords, common user fingerprints and temporary passwords except for the administrator.

5+SMART Vacation Mode

Click 5+SMART to register the temporary password, the password screen flashes to enter the administrator password + SMARTT or administrator fingerprint, and enter 1+SMART to start the vacation mode. In this mode, only the administrator can unlock the lock. Enter 2+SMART to turn off vacation mode.

6+SMART Silent Mode

Click 6+SMART to go to the silent mode menu, the password screen flashes and enters the administrator password+SMART or administrator fingerprint, and enters 1+SMART to turn on the silent mode. Enter 2+SMART to turn off silent mode.

11+SMART Add APP

Tap 11+SMART to enter the Tuya Bluetooth pairing menu, the password screen flashes and enters the administrator password + SMART or administrator fingerprint, and enters 1+SMART to turn on the quick opening mode, which can be unlocked by pressing SMART or any fingerprint. Enter 2+SMART to turn off the quick opening mode.

12+SMART Reset

Click 12+SMART to restore the factory settings menu, the password screen flashes to enter the administrator password + SMART or administrator fingerprint, and a long beep is heard, prompting that the factory reset is successful.

13+SMART Quick Opening Mode

Tap 11+SMART to enter the Tuya Bluetooth pairing menu, the password screen flashes and enters the administrator password + SMART or administrator fingerprint, and enters 1+SMART to turn on the quick opening mode, which can be unlocked by pressing SMART or any fingerprint. Enter 2+SMART to turn off the quick opening mode.

Force factory reset function

Insert the long pin of the accessory bag into the small hole on the battery cover and hold it still after pressing it to the reset switch of the rear setting board, and after hearing four beeps, the SMART button will turn on the green light and release it to force a factory reset.

Unlock

After unlocking, the green light will be on for 2.5 seconds and then re-locked

Virtual Passwords

You can add other digits before and after the correct password, and you can enter a password with a maximum length of 20 digits.

System Locked

After 10 times of wrong password or fingerprint, the system locks for 1 minute

Low-voltage Alarm

When the voltage is lower than 4.8V, after waking up the system, the SMART button flashes red light and beeps 7 times, indicating that the battery needs to be replaced when the battery is low.

User Capacity

3 administrators / 45 regular users (15 passwords + 30 fingerprints) / 10 temporary passwords

APP connection

1-App Installation:

- A. Download and install the "Smart Life" app from the mobile app store than register and log in.
- B. Search the "Smart Life" app through your browser, download and install it than register and log in.
- C. Scan the QR code on the right to download the "Smart Life" app than register and log in.



2-Connect the lock with the "Smart Life"App:

- A. Turn on your mobile bluetooth and positioning.
- B. Wake up the lock and press "1" + "1" + "SMART" to verify the administrator (the administrator password is "123456" by default in the factory state). Enter the Bluetooth pairing state, the white light flashes and lasts for 2 minutes (if the green light turns on for a long time and exits the menu, means the product has been paired with the phone).
- C. Open the smart life APP, the device will automatically jump out, click "Add" to add the device, After the download is complete, click "Next" to modify the device name, and then click "Finish".

Installation

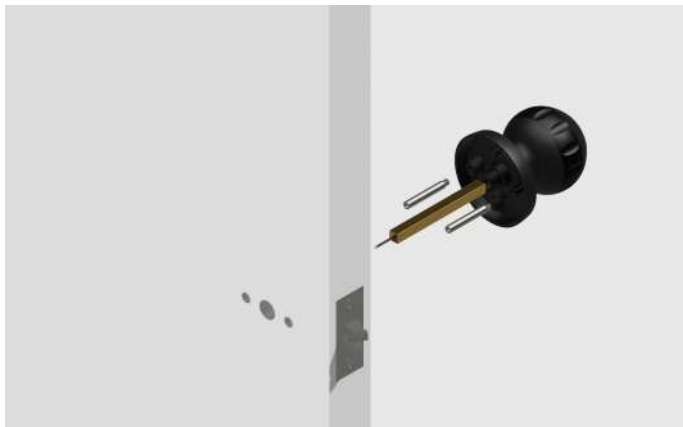

01. Install the two screw bolts on the front cover, Insert the hollow square bar into the bottom of the front lever and let the data line stick out.

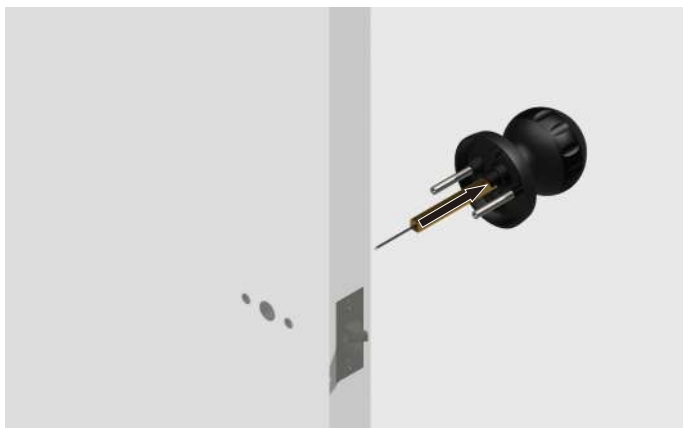

02. Please be sure to insert the square bar into the front handle to the end, otherwise it will affect the normal use of the product.

Installation



03. Insert the exterior assembly into the door hole.



04. Install the interior assembly on the door. Make sure the settings key shown in the diagram is at the top left, and the connection wire goes through the spring and the back handle.

Installation

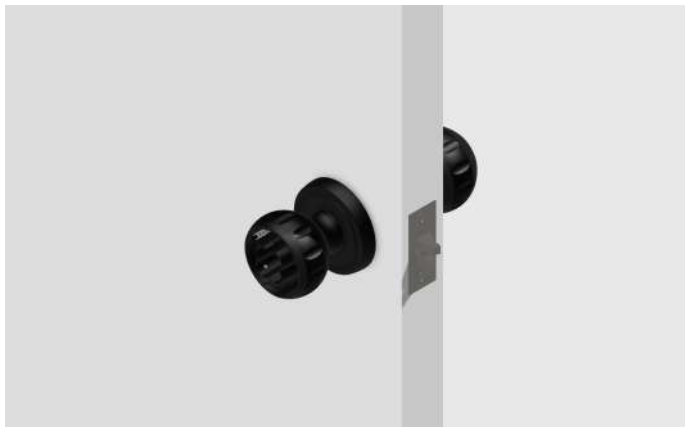

05. A-Tighten the door lock with two screws and connect the data cable.

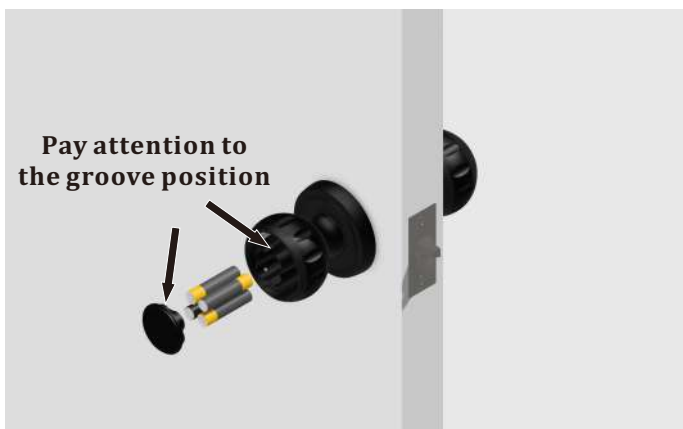

06. Install 4 AAA alkaline batteries and the battery cover.

Installation

The small round hole is on the top left



07. To install the battery cover retaining ring, make sure that the small round hole is in the upper left corner, and note that the small round hole must be in the same direction as the rear circuit board. If it is in the wrong position, the clip will not be secured. The structure of the two buckles is different, and it cannot be fixed at any position.

Be sure to twist the back handle clockwise to open the door



Lock the retaining ring clockwise

When replacing the battery press the battery cover and twist the retaining ring counterclockwise

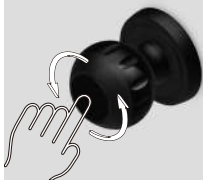

08. Press down firmly on the battery cover to hear the ticking sound, indicating that the power is successfully energized, and at the same time, rotate the retainer ring in the clockwise direction to hear the snap

A fixed sound indicates that the installation was successful. To open the battery cover, press down firmly on the battery cover, allow the spring to compress, and then rotate counterclockwise. The retaining ring buckle is out of the loop, indicating that the opening is successful.

Important:

1. If the retainer ring cannot be taken out, please pay attention to whether the retaining ring is already open, because it is in a tight fitting state, so it cannot come out on its own. Tools such as ingernails can be used to help the ring come out.
2. When unlocking the inside of the door, be sure to twist the ball handle clockwise to unlock the lock, because the counterclockwise direction is the direction in which the fixing ring is opened, and if it is twisted counterclockwise, it will drive the fixing ring to open, causing the battery cover to fall off.
3. When installing or taking out the retaining ring, be sure to press down firmly on the battery cover, the purpose is to make it easier for the spring compression to rotate the retaining ring, and ensure that the installation and removal are in place in one step.

This device complies with part 15 of the FCC Rules.

Operation is subject to the following two conditions:

- (1) This device may not cause harmful interference, and
- (2) this device must accept any interference received, including interference that may cause undesired operation.

Any Changes or modifications not expressly approved by the party responsible for compliance could void the user's authority to operate the equipment.

Note: This equipment has been tested and found to comply with the limits for a Class B digital device, pursuant to part 15 of the FCC Rules. These limits are designed to provide reasonable protection against harmful interference in a residential installation.

This equipment generates uses and can radiate radio frequency energy and, if not installed and used in accordance with the instructions, may cause harmful interference to radio communications. However, there is no guarantee that interference will not occur in a particular installation. If this equipment does cause harmful interference to radio or television reception, which can be determined by turning the equipment off and on, the user is encouraged to try to correct the interference by one or more of the following measures:

- Reorient or relocate the receiving antenna.
- Increase the separation between the equipment and receiver.
- Connect the equipment into an outlet on a circuit different from that to which the receiver is connected.
- Consult the dealer or an experienced radio/TV technician for help.