

尺寸130*160mm

130mm

160mm

V2.0 Quantum Light (Hexagon)

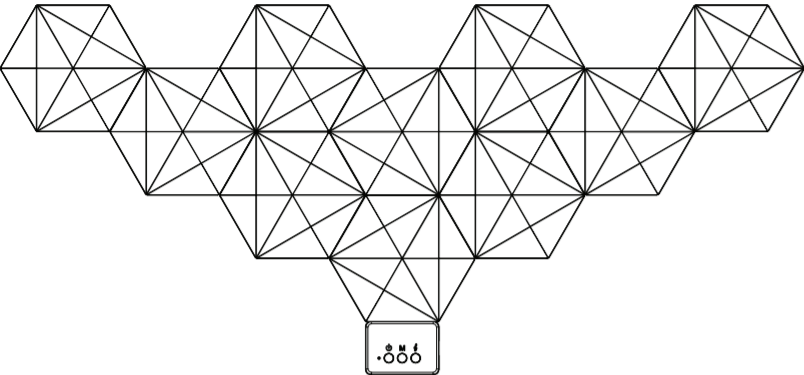

USER MANUAL



Parameters

| | |
|-----------------------|---|
| Product Name | V2.0 Quantum Light (Hexagon) |
| Input | 5V / 2A |
| Wattage of per panel | 1W |
| Maximum pieces panels | 1-15 pcs |
| Max Colors | RGB, 16.7 million |
| Working Temperature | -20°C to 40°C / -4°F to 104°F |
| Dimmability | App, Remote Controller, Button Controller |

What's in the box

Light panel x 10, Linker x 12, Button Controller x 1, Remote controller x 1, Manual x 1, Double-sided adhesive tape x 12.

Instruction for Button Controller

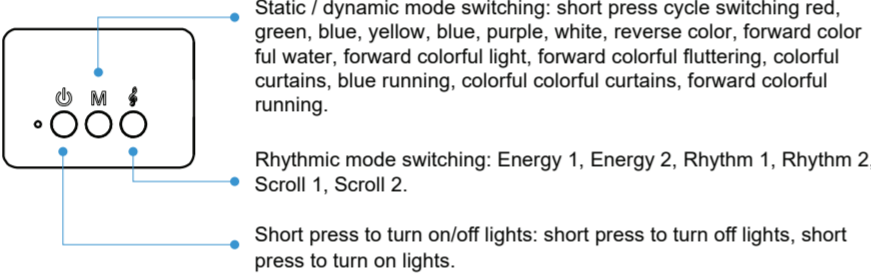

01

Instruction for Remote Controller



| | | |
|--------------------------|--------------------|---------------------------|
| Pause | Auto mode | On/Off |
| Brightness+ | Speed/Sensitivity+ | Mode+ |
| Brightness- | Speed/Sensitivity- | Mode- |
| Red | Green | Blue |
| Yellow | Cyan | Purple |
| Timed one hour light off | White | Timed two hours light off |
| Energy | Rhythm | Scrolling |
| Snowflake | Romantic | Starry Night |

Installation Instruction

- Connect the controller to the first light panel with a linker.

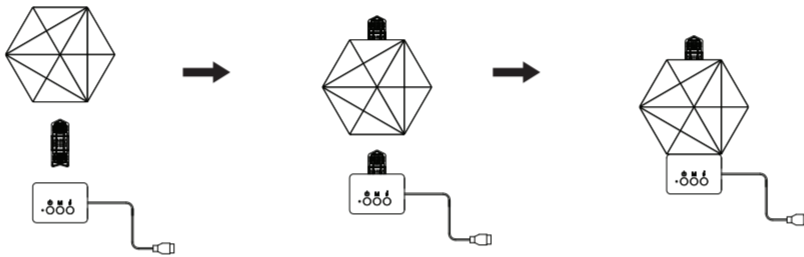

02

- Connect the light panel with the linker, and splice the shape you want.
- Ensure that the installation surface is clean, flat, and free of water stains.



- Peel off the film from the double-sided tape.
- Attach the light panel to the wall and press for 30 seconds.

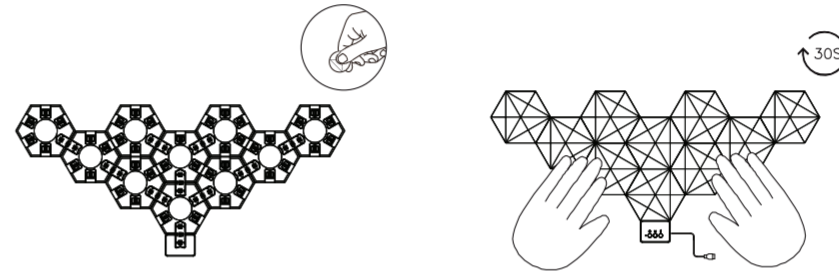

- Installation complete.

03

Packing / Weight

| Item | Inner Box | | | |
|---------------------------|-------------------------------------|---------------------|--------------------|-------------|
| | Size (mm/in) | N.W. (kg/lbs) | G.W. (kg/lbs) | Qty (set) |
| KA-PL25 (Pack of 10) | 250x100x136 mm 9.84x3.93x5.35 in | 0.63/kg 1.38/lbs | 0.73/kg 1.6/lbs | 1 |

| Item | Master Carton | | | |
|---------------------------|--|----------------------|----------------------|-------------|
| | Size (mm/in) | N.W. (kg/lbs) | G.W. (kg/lbs) | Qty (set) |
| KA-PL25 (Pack of 10) | 518x423x433 mm 20.39x16.65x17.04 in | 17.5/kg 38.58/lbs | 18.5/kg 40.78/lbs | 24 |

Steps of Connection on Mobile

- A smart phone or tablet with IOS 11.0 (or later) or Android 7.0 (or later).
- Download the " LotusLamp X " App from the APP store (IOS devices) or Google Play (Android devices).



Google play



Apple store



APP:LotusLamp X

04

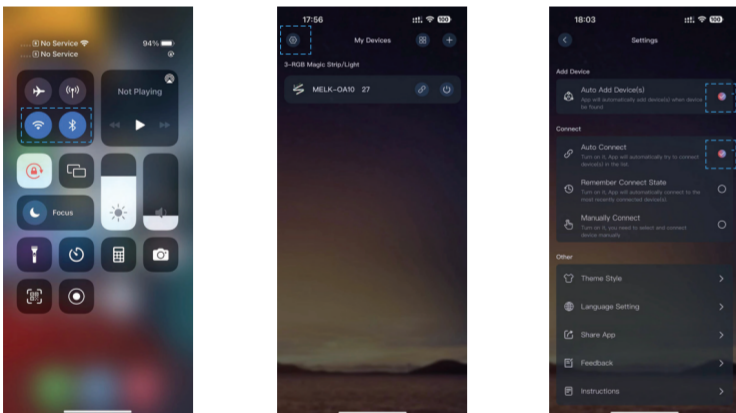

- Connect to the network and turn on Bluetooth.
- Open Settings in the APP to turn on Auto connect.
- Set Auto Add Device(s).

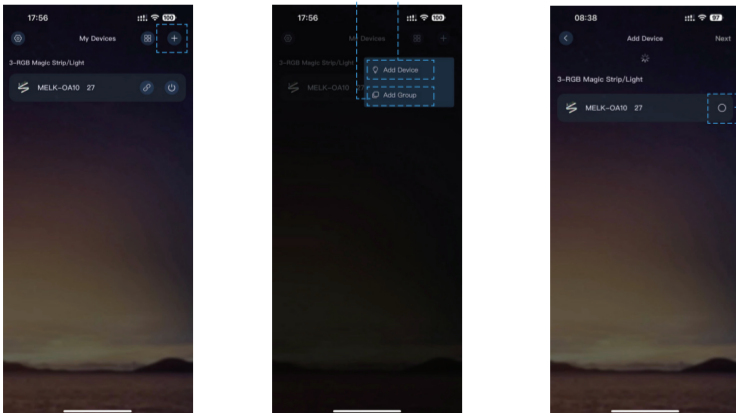

- Manually add device(s).
- Add devices, select the devices to be paired.

05

APP Interface

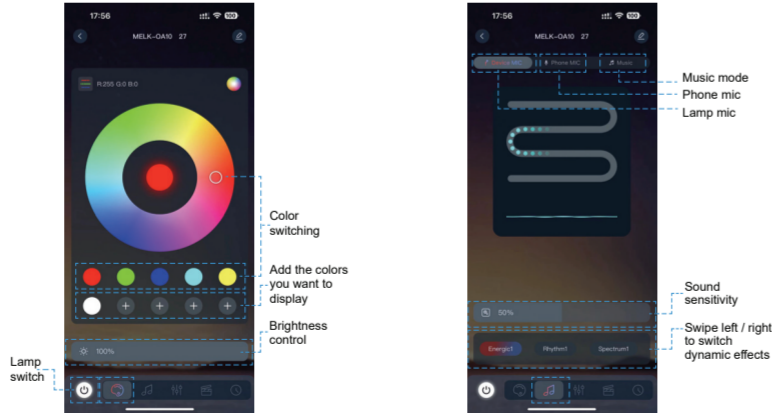

- Static mode, The lamp will display the color selected by the user.
- Microphone mode, the user can choose the MIC on the mobile phone or the lamp, and control the dynamic and color change of the lamp through the change of sound.

06

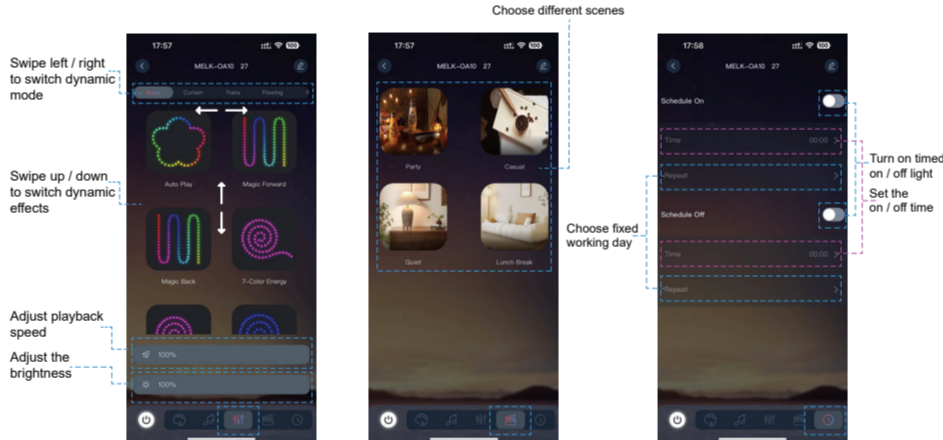

- Dynamic mode, the user can choose different dynamic effects, so that the lamp can carry out corresponding dynamic changes.
- Scene mode, Users can set different scene modes according to their preferences.
- Schedule mode, the user can set the time to turn on / on the light by setting the time.

Caution

Read and follow the safety instructions below.

- This light panel is ideally used on smooth surfaces (e. g. glass, etc.); not suitable for uneven, bumpy or wet surfaces (e. g. brick, stucco, etc.).
- Clean and ensure the surface is totally dry before sticking the light panel on.
- When installing the light panel, press its central point against the wall for more than 30s in order to maximize the adhesion.
- Avoid installation above heat source objects, in areas where direct sunlight, airflowand temperature change significantly.
- Avoid exposing the product to the outside and directly in the rain.
- Do not use sharp and hard objects or rough pollutants to impact the light panel, as not to affect the function and appearance.
- Do not leave the power cord idle on the ground to avoid stumbling.
- Children who are not supervised by adults are not allowed to use this product alone. Some parts of this product are imported, there is a risk of choking.

For more inquires, please contact LPDISPLAY_01@163.com

07

FCC Statement

This equipment has been tested and found to comply with the limits for a Class B digital device, pursuant to part 15 of the FCC Rules. These limits are designed to provide reasonable protection against harmful interference in a residential installation. This equipment generates, uses and can radiate radio frequency energy and, if not installed and used in accordance with the instructions, may cause harmful interference to radio communications. However, there is no guarantee that interference will not occur in a particular installation. If this equipment does cause harmful interference to radio or television reception, which can be determined by turning the equipment off and on, the user is encouraged to try to correct the interference by one or more of the following measures:

- Reorient or relocate the receiving antenna.
- Increase the separation between the equipment and receiver.
- Connect the equipment into an outlet on a circuit different from that to which the receiver is connected.
- Consult the dealer or an experienced radio/TV technician for help.

Caution: Any changes or modifications to this device not explicitly approved by manufacturer could void your authority to operate this equipment.

This device complies with part 15 of the FCC Rules. Operation is subject to the following two conditions: (1) This device may not cause harmful interference, and (2) this device must accept any interference received, including interference that may cause undesired operation.

RF Exposure Information

This equipment complies with FCC radiation exposure limits set forth for an uncontrolled environment. This equipment should be installed and operated with minimum distance 20cm between the radiator and your body.

08