



# Cloud Connector

Get the **Connector** app from the  
App Store or Google Play.



Follow the instructions in the Connector  
app to install your Cloud Connector.



Download on the  
**App Store**



GET IT ON  
**Google Play**



## 1. Connect to the TV

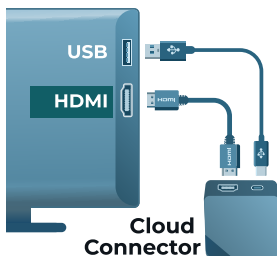

### No USB Port on TV?

Use USB power adapter rated at 5V DC min 0.5A.



**!** Only use cable provided.

## 2. Switch TV input

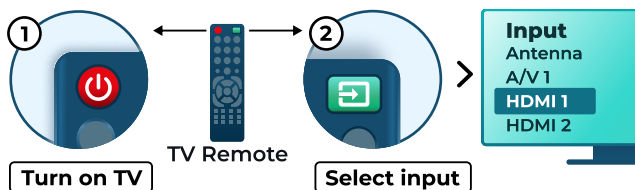

## 3. Insert remote batteries

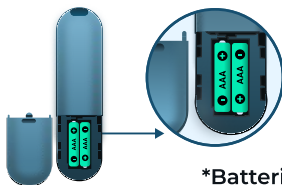

\*Batteries not included

## 4. Follow instructions on TV



## Product details

**Product Name:** Senza Cloud Connector

**Model Name:** SZC004

**RCU Name:** Bluetooth Remote Control

**Model Name:** B042-01-W9

## Importers

### France

Synamedia Technologies France SAS  
12 A Rue du Pâtis Tatelin,  
35700 Rennes,  
France  
Co. Reg. # 818 627 580

### UK

Synamedia Limited  
51 Clivemont Rd,  
Maidenhead  
SL6 7BZ  
Co. Reg. # 3080780

## Manufacturer

Shenzhen SDMC Technology Co., Ltd

Address: Room 1022, Floor 10, Building A, Customs Building, No. 2, Xin'an 3rd Road, Dalang Community, Xin'an Street, Bao'an District, Shenzhen, China

## Frequency range

Frequency band:

Bluetooth: 2402MHz – 2480MHz

2.4G Wi-Fi: 2412MHz – 2472MHz

5G Wi-Fi: 5150MHz – 5250MHz, 5250MHz – 5350MHz,  
5470MHz – 5725MHz, 5725MHz – 5850MHz

RF Effective Isotropic Radiated Power, EIRP:

Bluetooth: EIRP<20dBm

2.4G Wi-Fi: EIRP<20dBm

5G Wi-Fi: 5150-5250MHz: EIRP<23dBm

5250-5350MHz: EIRP<20dBm

5470-5725MHz: EIRP<20dBm

5725-5850MHz: EIRP<14dBm

For Senza Cloud Connector, the device complies with relevant RF radiation exposure limits when positioned at least 20cm away from your body.

For Bluetooth Remote Control, the device has been evaluated to meet general RF exposure requirement. The device can be used in portable exposure condition without restriction.

The WLAN function for this device is restricted to indoor use only when operating in the 5150 to 5350 MHz frequency range.

	AT	BE	BG	CH	CY	CZ	DK	DE	EE	EL	ES	FI
	FR	HR	HU	IE	IS	IT	LI	LT	LU	LV	MT	NL
	NO	PL	PT	RO	SE	SI	SK	TR	UK(NI)			

	UK



This product bears the selective sorting symbol for Waste Electrical and Electronic Equipment (WEEE). This means that this product must be handled pursuant to European directive 2012/19/EU in order to be recycled or dismantled to minimize its impact on the environment.

User has the choice to give his product to a competent recycling organization or to the retailer when he buys a new electrical or electronic equipment.

Apple and the Apple logo are trademarks of Apple Inc., registered in the U.S. and other countries. App Store is a service mark of Apple Inc.

Google Play is a trademark of Google LLC.

## FCC Statement

This equipment has been tested and found to comply with the limits for a Class B digital device, pursuant to part 15 of the FCC Rules. These limits are designed to provide reasonable protection against harmful interference in a residential installation. This equipment generates, uses and can radiate radio frequency energy and, if not installed and used in accordance with the instructions, may cause harmful interference to radio communications. However, there is no guarantee that interference will not occur in a particular installation. If this equipment does cause harmful interference to radio or TV reception, which can be determined by turning the equipment off and on, the user is encouraged to try to correct the interference by one or more of the following measures:

- Reorient or relocate the receiving antenna.
- Increase the separation between the equipment and receiver.
- Connect the equipment into an outlet on a circuit different from that to which the receiver is connected.
- Consult the dealer or an experienced radio/TV technician for help.

## FCC Radiation Exposure Statement

For Senza Cloud Connector, the device complies with FCC radiation exposure limits set forth for an uncontrolled environment. The distance between user and products should be no less than 20cm.

For Bluetooth remote control, the device has been evaluated to meet general RF exposure requirement. The device can be used in portable exposure condition without restriction.

This device complies with Part 15 of the FCC Rules. Operation is subject to the following two conditions:

- (1) This device may not cause harmful interference, and
- (2) This device must accept any interference received, including interference that may cause undesired operation.

## Caution!

Any changes or modifications not expressly approved by the party responsible for compliance could void the user's authority to operate the equipment.

Shielded cables must be used with this unit to ensure compliance with the Class B FCC limits.

## Caution!

Risks of explosion if the battery is replaced by an incorrect type:

- Replacement of a battery with an incorrect type that can defeat a safeguard (for example, in the case of some lithium battery types)
- Disposal of a battery into fire or a hot oven, or mechanically crushing or cutting of a battery, that can result in an explosion
- Leaving a battery in an extremely high temperature surrounding environment that can result in an explosion or the leakage of flammable liquid or gas
- A battery subjected to extremely low air pressure that may result in an explosion or the leakage of flammable liquid or gas.

Operating Temperature: 0°C ~ 40°C

Version: SZC004 - V1.00.00



## Need help?

Visit <https://cloudconnector.tv/help>

For technical support, multi language quick start guides, FAQs & more