



YUNY-Y01 PROJECTOR GUIDE TO USE

Before using this product, please read the product manual carefully. Thank you for purchasing and using this product. For your safety and benefit, please read the product manual carefully before using the product, and please keep it properly along with the invoice after reading.

Our company reserves the right to interpret the manual. In case of product technology or software upgrade, we will no longer notify. The product appearance is subject to the actual product, and this product is suitable for sales in Europe, the United States, Japan and so on.

About this product guide

Users should pay attention to important information related to the operation and maintenance of this machine, and should carefully read such information to avoid problems.

Following the following safety precautions will increase the service life of this machine. In addition to what is mentioned in this manual, please consult a person with relevant qualifications for installation and maintenance services, and do not use damaged wires, accessories and other peripheral equipment.

Non-professionals are prohibited from dismantling and repairing the projector of this equipment by themselves. Replacing wrong model accessories and batteries may cause equipment anomalies or explosion hazards. Be sure to detect and repair through official channels.

Important Notes(How to Use the Device Correctly)

- Do not point the lens towards the human eye to avoid strong light from the lens causing damage to the eyes after startup.
Do not block the air inlets and outlets of the device to avoid normal heat dissipation of the device causing damage to the internal electronic components.
Do not use chemicals or cleaning agents directly to wipe the lens. Before wiping, use a blow ball to blow off large particles attached to the lens surface to avoid scratching the lens when wiping. Then use an optical lens paper or a dust-free wipe cloth dipped in 95% or more alcohol cleaning liquid to wipe the lens from the center outwards in a circular motion to avoid leaving water marks on the lens surface during the wiping process.
Do not use chemicals, cleaning agents or water to clean the device, and avoid rainwater, moisture and liquids containing minerals corroding the circuit board.
Keep the device and its components and accessories out of reach of children.
Ensure that the device is used in a dry and ventilated environment.
Do not store the device in places that are too hot or too cold. High /low temperature will shorten the life of electronic components. The allowed storage and use environment for the device is 0°C-35°C.
Do not put the device in any heating device (such as a dryer, microwave, etc.) for drying.
Do not squeeze the device or place obstacles above or behind it, especially the lens glass part, to avoid damaging the device.
Do not throw, knock or vibrate the device strongly, causing damage to the internal circuit board.
Do not attempt to disassemble the device privately. If there are any problems, please contact after-sales service.
Do not repair any product privately. If the device or any component does not work properly, consult after-sales service or return it to the factory for repair in a timely manner.

Warning: Operation of this product in a residential environment may cause radio interference.

Accessory List

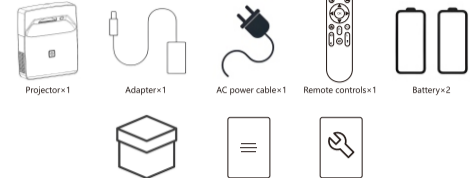

Projector Overview

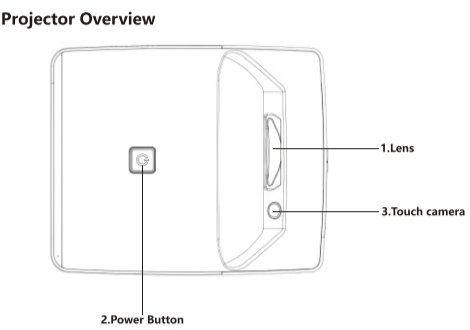
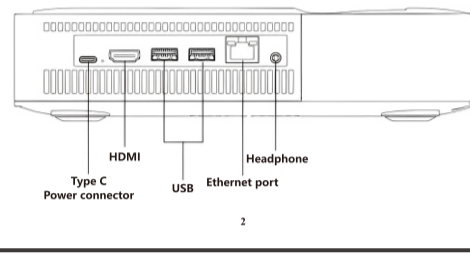

Table with 3 columns: Serial No., Part/Functional, and Description. Lists lens, power button, and touch camera.



Instructions for the Remote Control Function:

- 1. Installing batteries for the remote control.
2. Pairing the remote control.

Please keep the distance between the remote control and the projector (20cm). At the same time, press the buttons and buttons on the remote control to turn on the Bluetooth of the remote control and pair it with the projector. When the Bluetooth is paired and connected, the Bluetooth light on the remote control will indicate a blinking state.

3. Description of the remote control keys

Table with 3 columns: Serial No., Keys, and Functional Description. Lists keys like Power, Signal source, Menu, etc.

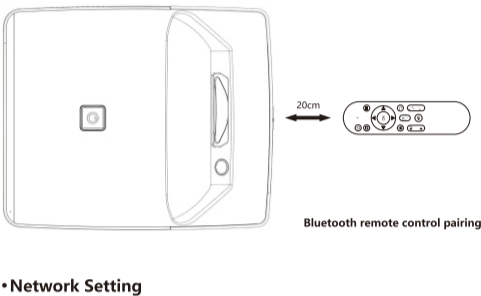

Network Setting

Setting - Network Setting - WiFi Setting - Turn on WiFi, select the wireless network in the WiFi list and enter the password to connect.

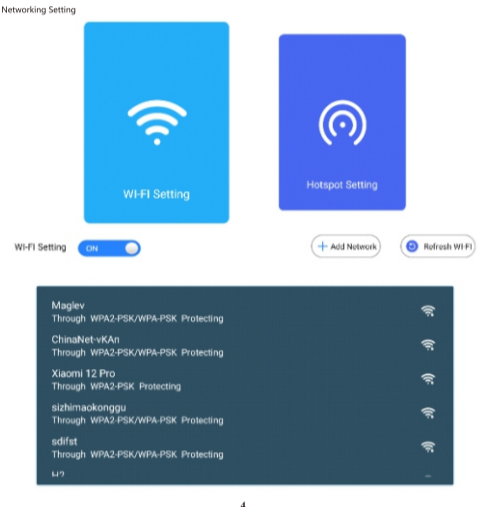

Hotspot Setting

Setting - Network Setting - Hotspot Settings - just turn on the hotspot and set it up.

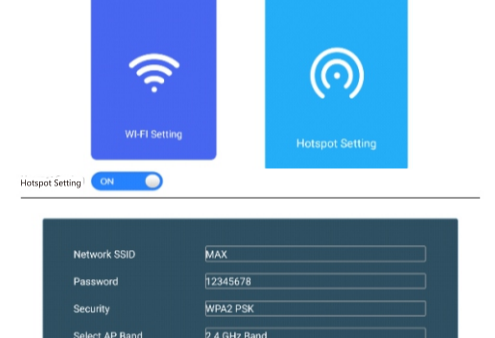

Language Setting

Setting - Language Setting - go to Language Setting to select the language you want.

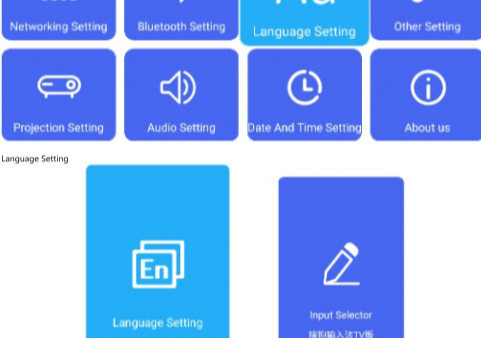

Bluetooth Setting

Setting-Bluetooth Setting-Enable Bluetooth, click Refresh Devices, and search for the device to pair successfully.

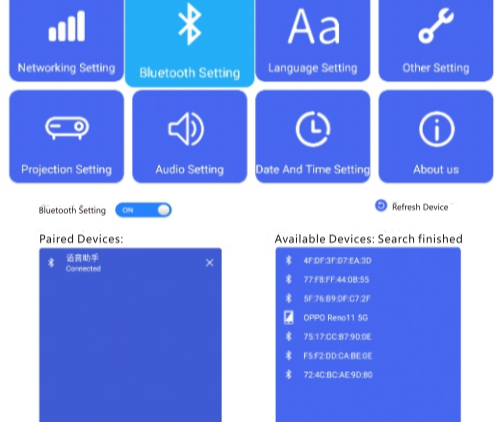

Input Setting

Setting - Language Setting - Input Selector, you can select the input method according to your needs.

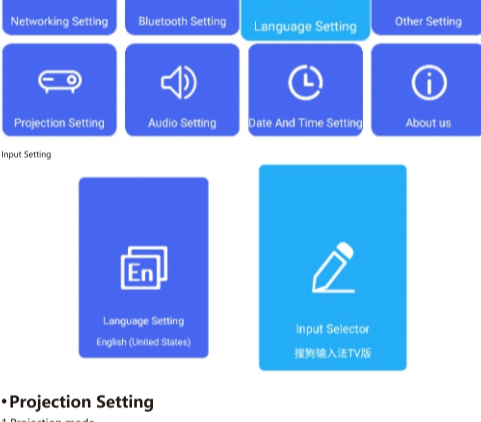

Setting-Projection Setting-Projection Mode, select Auto Adjustment, the projection host will rotate the screen according to its own placement status; you can also manually select the projection mode, horizontal projection or vertical projection, see the diagram.

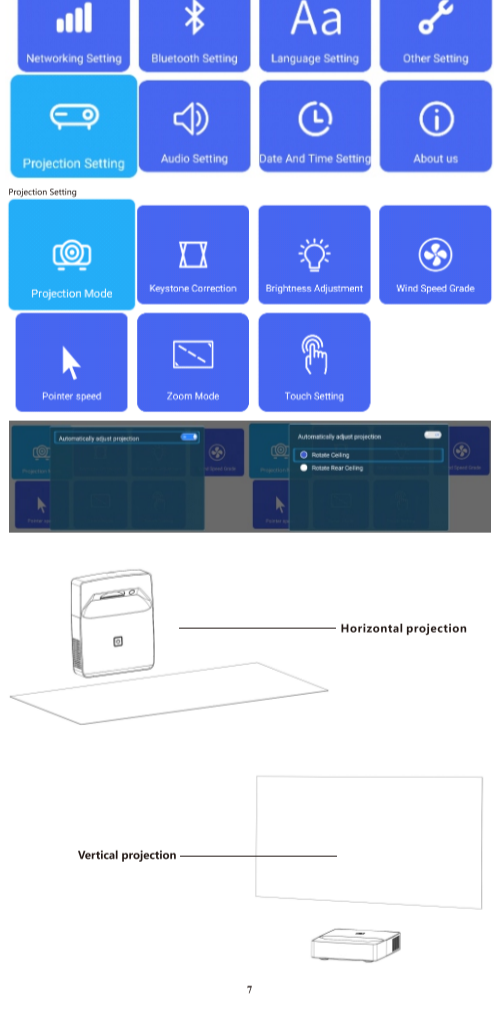

2.Keystone Correction -Keystone Correction-Manual keystone correction, select the corner point to be adjusted and press the arrow keys to make adjustment.

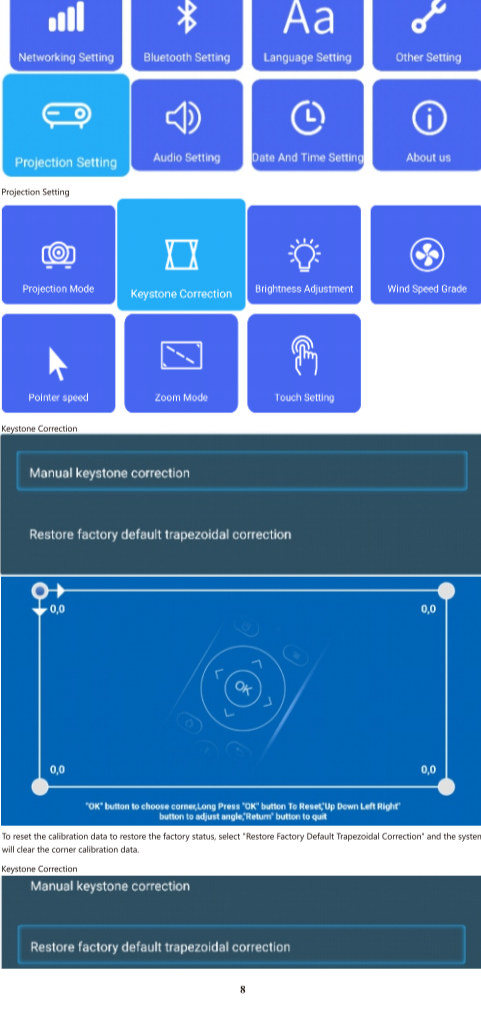

3.Brightness Adjustment Setting - Brightness Adjustment, you can select Standard Mode and High Bright Mode.

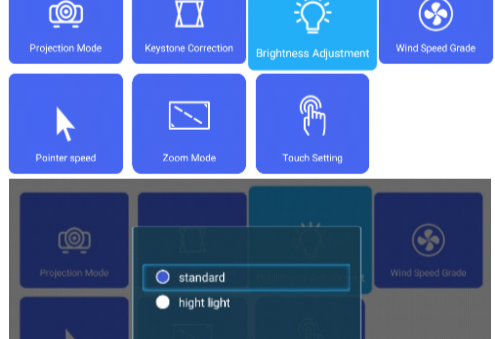

If the touch control setting is selected to be turned on, the touch control function of the screen will be enabled. If the automatic status setting is selected to be turned on, the touch control function will start automatically when the device is turned on.

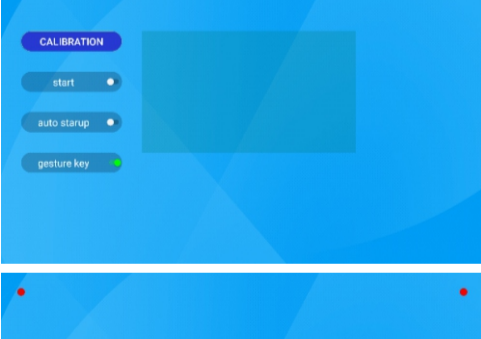

4.Touch Setting Setting-Projection Setting-Touch Setting, you can set the touch accordingly.

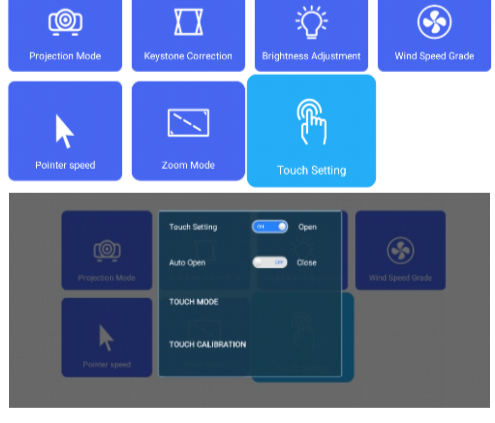

This equipment has been tested and found to comply with the limits for a Class B digital device, pursuant to part 15 of the FCC Rules. These limits are designed to provide reasonable protection against harmful interference in a residential installation. This equipment generates, uses and can radiate radio frequency energy and, if not installed and used in accordance with the instructions, may cause harmful interference to radio communications. However, there is no guarantee that interference will not occur in a particular installation. If this equipment does cause harmful interference to radio or television reception, which can be determined by turning the equipment off and on, the user is encouraged to try to correct the interference by one or more of the following measures:

- Reorient or relocate the receiving antenna.
-Increase the separation between the equipment and receiver.
-Connect the equipment into an outlet on a circuit different from that to which the receiver is connected.
-Consult the dealer or an experienced radio/TV technician for help.

Caution: Any changes or modifications to this device not explicitly approved by manufacturer could void your authority to operate this equipment.

This device complies with part 15 of the FCC Rules. Operation is subject to the following two conditions: (1) This device may not cause harmful interference (2) This device must accept any interference received, including interference that may cause undesired operation.

RF Exposure Information This equipment complies with FCC radiation exposure limits set forth for an uncontrolled environment. This equipment should be installed and operated with minimum distance 20cm between the radiator and your body.

Date And Time Setting

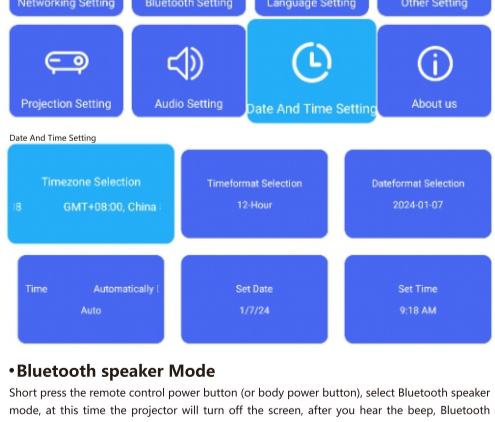

WiFi display screen casting

Android users turn on the mirroring function of their mobile phone or other mirroring device, search and pair the corresponding device, and can realize the function of wireless screen transmission.

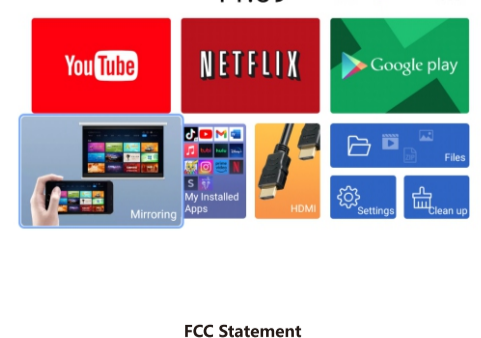

Bluetooth speaker Mode

Short press the remote control power button (or body power button), select Bluetooth speaker mode, at this time the projector will turn off the screen after you hear the beep. Bluetooth connect to other devices.

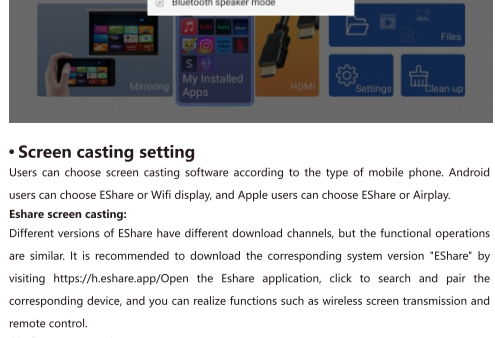

Screen casting setting

Users can choose screen casting software according to the type of mobile phone. Android users can choose ESshare or WiFi display, and Apple users can choose ESshare or Airplay.

ESshare screen casting: Different versions of ESshare have different download channels, but the functional operations are similar. It is recommended to download the corresponding system version 'ESShare' by visiting https://heshareapp.com/ you can realize functions such as wireless screen transmission and remote control.

Airplay screen casting: Apple users turn on the mirroring function of their mobile phone or other mirroring device,

FCC Statement

This equipment has been tested and found to comply with the limits for a Class B digital device, pursuant to part 15 of the FCC Rules. These limits are designed to provide reasonable protection against harmful interference in a residential installation. This equipment generates, uses and can radiate radio frequency energy and, if not installed and used in accordance with the instructions, may cause harmful interference to radio communications. However, there is no guarantee that interference will not occur in a particular installation. If this equipment does cause harmful interference to radio or television reception, which can be determined by turning the equipment off and on, the user is encouraged to try to correct the interference by one or more of the following measures:

- Reorient or relocate the receiving antenna.
-Increase the separation between the equipment and receiver.
-Connect the equipment into an outlet on a circuit different from that to which the receiver is connected.
-Consult the dealer or an experienced radio/TV technician for help.

Caution: Any changes or modifications to this device not explicitly approved by manufacturer could void your authority to operate this equipment.

This device complies with part 15 of the FCC Rules. Operation is subject to the following two conditions: (1) This device may not cause harmful interference (2) This device must accept any interference received, including interference that may cause undesired operation.

RF Exposure Information This equipment complies with FCC radiation exposure limits set forth for an uncontrolled environment. This equipment should be installed and operated with minimum distance 20cm between the radiator and your body.

内1

内2

内3

内4

内5