

iRemote

Operation Instruction

Packing list

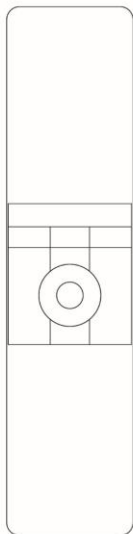

iRremote

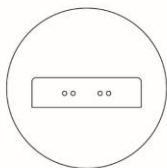

Charging base

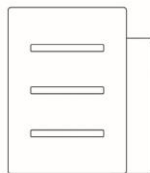

Specification

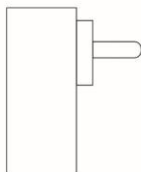

Adapter



Power line



CH



AU



UK

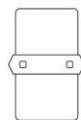

EU

Interface description

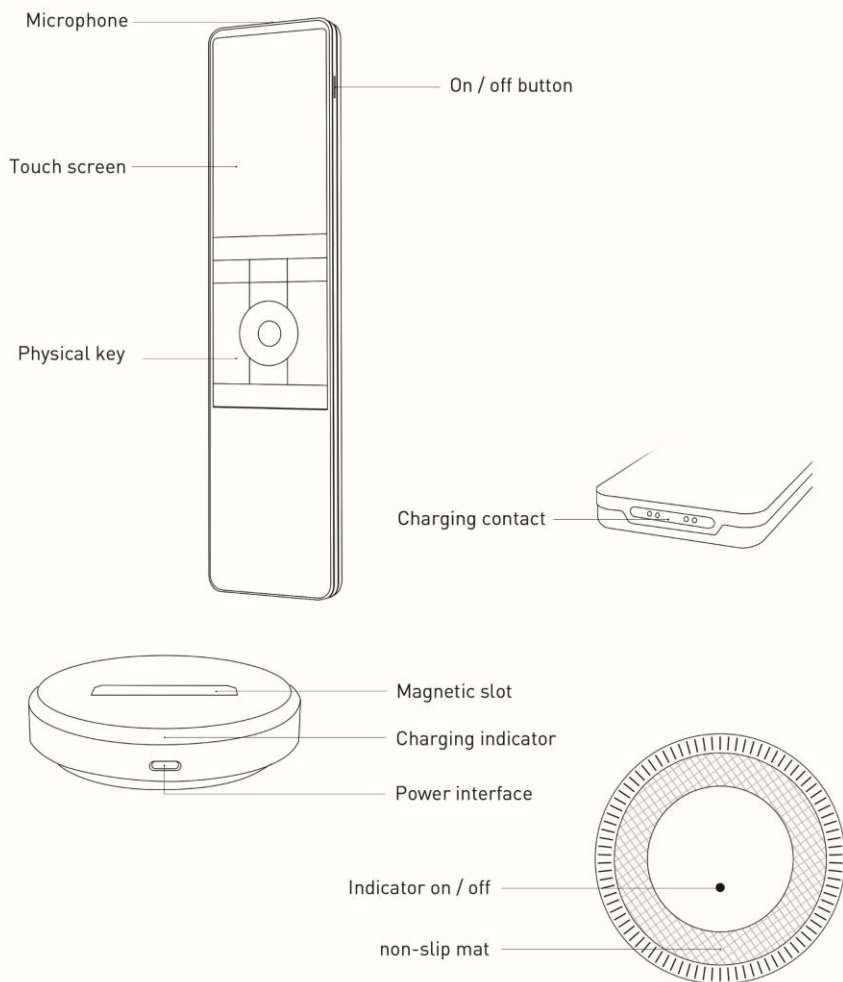

Basic settings

1. Remote control charging

Power on the base and place the remote control on the base to charge. The base has a star ring light, which is convenient for you to put the remote control back into the base in the dark. You can also turn on / off the star ring light through the button at the bottom of the remote control.

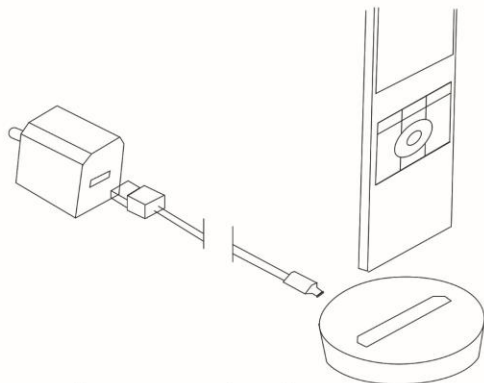

2. Remote control startup and setting

Press and hold the button on the side of the remote control for 2S, the remote control will be turned on, and WiFi and other basic information will be set through the screen prompt.

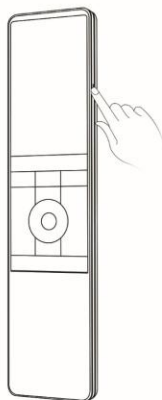

Binding device

1.Mobile app Download

Search for the corresponding app in the app store for download and installation. The app operator shall be subject to the actually released version. If you download it for the first time, please click the "register" button to register your account. If you have an account, click the "login" button.

2. Open the installed mobile app, scan the QR code on the remote control screen and complete the device binding.

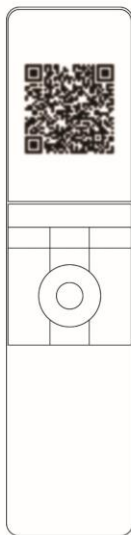

Basic operation

1. Left and right sliding

Slide left and right to switch different device control pages

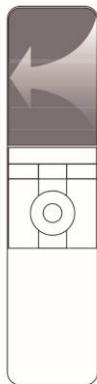

2. Slide upward

Enter more device / scene control list

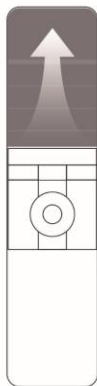

Basic operation

3. Voice function

You can press and hold the voice key of the remote control to say the command directly, or you can wake up the remote control through the wake-up word to say the command

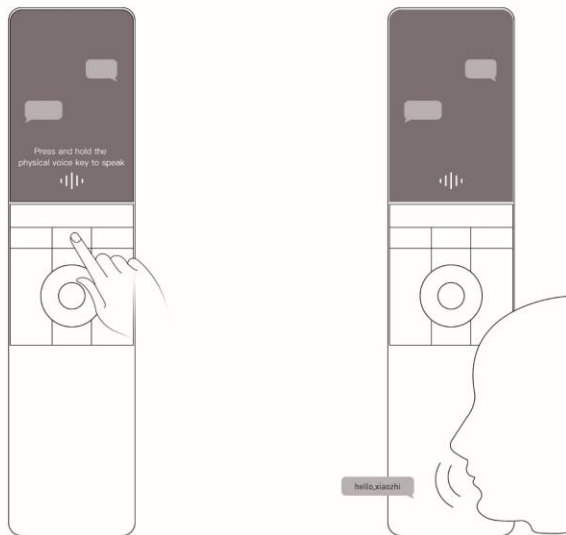

*You can enter the corresponding entrance in the intelligent central control page of the

Product information

Model	LF-R7
Size	227.0*54.8*12.2mm(lwh)
Base size	90*22mm(Φh)
mains input	DC 5V $\overline{=}$ 1.5A
Battery capacity	2000mAh
Screen size	3.1 inches, 480 x 800
Trumpet	1W
Communication protocol	Wifi, Blue

China RoHS

Parts name	Toxic and harmful substances or elements					
	Pb	Hg	Cd	Cr(VI)	PBB	PDBE
Plastic parts	○	○	○	○	○	○
Metal	○	○	○	○	○	○
Circuit board	×	○	○	○	○	○
Enclosure	○	○	○	○	○	○
<p>This table is prepared according to SJ / T 11 364.</p> <p>○ Indicates that the content of the hazardous substance in all homogeneous materials of the component is below the limit specified in GB / T 26572-2011.</p> <p>×</p> <p>Indicates that the content of the hazardous substance in at least one homogeneous material of the component exceeds the limit specified in GB / T 26572-2011.</p>						

According to SJ / T 1364 standard, this product and some internal components or external components may have environmental protection service life marks. Depending on the component and component manufacturer, the service life marks on the product and its components may be different. The environmental protection service life of components shall be subject to their environmental protection service life marks.

After sales guarantee

In accordance with the law of the people's Republic of China on the protection of consumers' rights and interests and the law of the people's Republic of China on product quality, we promise you:

- ① With this warranty regulation and relevant sales invoices, you can get the company's free warranty service. If you can't show the sales certificate, the free warranty period of the product will be calculated from its production date;
- ② In case of performance failure (excluding human factors), but the product parts are complete and the appearance is undamaged, you can enjoy the return or replacement service within 7 days from the date of sale, and the replacement or free warranty service within 15 days;
- ③ In case of performance failure (excluding human factors), you can enjoy free warranty service within 1 year from the date of sale;
- ④ If the repaired products need to be mailed, the mailing fee shall refer to the after-sales maintenance fee standard of the company;
- ⑤ The distributor makes other commitments to you than the company's guarantee, and the company will not bear any responsibility;

Non-warranty rule

- ① The warranty period has expired or relevant purchase vouchers (invoices, sales documents, etc.) cannot be provided;
- ② Product failure, incomplete parts or appearance damage caused by human factors;
- ③ Normal loss of products (such as natural loss of shell and plug-in parts, natural aging of components, etc.);
- ④ Product failure or damage caused by failure to install, use, maintain and store in accordance with the requirements of the operation manual;
- ⑤ Product failure or damage caused by transportation, loading and unloading during customer repair;
- ⑥ Product failure or damage caused by force majeure factors such as earthquake, fire, flood, lightning, etc;
- ⑦ Other product failures or damages not caused by the design, technology, manufacturing, quality and other problems of the product itself;

Please keep the product packaging for warranty use.

CHECK OUT

This device complies with Part 15 of the FCC Rules. Operation is subject to the following two conditions: (1) this device may not cause harmful interference, and (2) this device must accept any interference received, including interference that may cause undesired operation

NOTE: This equipment has been tested and found to comply with the limits for a Class B digital device, pursuant to Part 15 of the FCC Rules. These limits are designed to provide reasonable protection against harmful interference in a residential installation. This equipment generates, uses and can radiate radio frequency energy and, if not installed and used in accordance with the instructions, may cause harmful interference to radio communications. However, there is no guarantee that interference will not occur in a particular installation.

If this equipment does cause harmful interference to radio or television reception, which can be determined by turning the equipment off and on, the user is encouraged to try to correct the interference by one or more of the following measures:

- Reorient or relocate the receiving antenna.
- Increase the separation between the equipment and receiver.
- Connect the equipment into an outlet on a circuit different from that to which the receiver is connected.
- Consult the dealer or an experienced radio/TV technician for help.

Warning: changes or modifications not expressly approved by the party responsible for compliance could void the user's authority to operate the equipment

The devices has been evaluated to meet general RF exposure requirement , the device can be used in portable exposure condition without restriction