

# INSTRUCTION MANUAL

**Silonn**

Rev00

---

**SLIM32T**

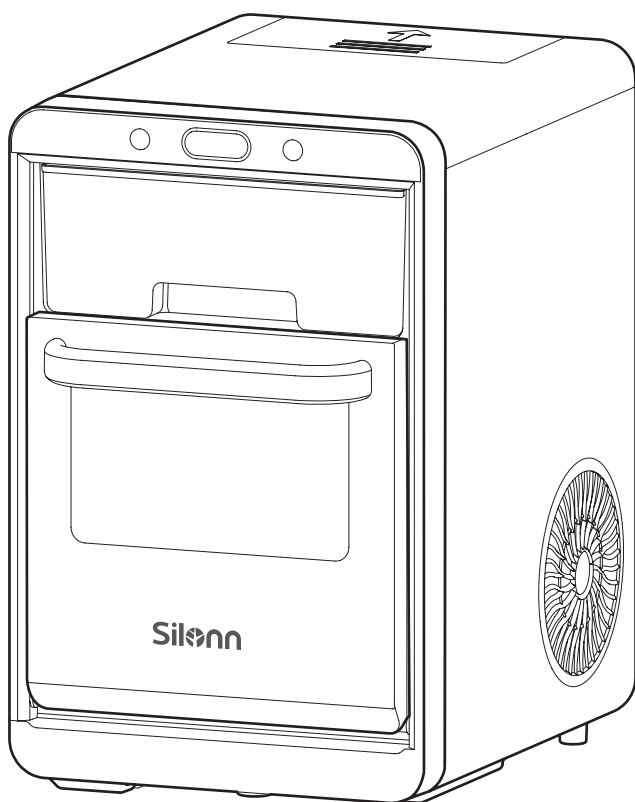

## Ice Maker

---

☎ 877-546-8603  
(US/CA) Mon-Fri 8am - 8pm (CST)

✉ [support@silonn.com](mailto:support@silonn.com)

## PAGE CONTENT

IMPORTANT SAFETY INFORMATION .....	01
PRODUCT INTRODUCTION .....	03
CONTROL PANEL INTRODUCTION .....	04
USING YOUR ICE MAKER .....	05
CLEANING AND MAINTENANCE .....	08
PRODUCT SPECIFICATIONS .....	10
TROUBLESHOOTING .....	11
WARRANTY INFORMATION .....	13

# IMPORTANT SAFETY INFORMATION

To reduce the risk of injury or property damage, please follow these safety precautions.

## WARNING



- Voltage power from outlet must match specifications on appliance nameplate.



- This appliance **must be** grounded.



- Using an extension cord may cause overheating and increase the risk of fire.

If an extension cord MUST be used:

- 1) **Only use an** extension cord with grounding plug.
  - 2) The marked rating of an extension cord **must be** equal to or greater than the rating of this appliance.
- **Do not** operate if any component, including the cord or plug, is damaged.
  - Unplug the unit before cleaning by hand.



- Only responsible and capable adults should operate the ice maker.
- **Do not** place the power cord where it could be pulled by children or pose a tripping hazard.
- Children should not be left unattended near the ice maker during operation.



- **Do not** use water that is micro-biologically unsafe or of unknown quality.



- **Do not** remove any safety, warning, or product information labels from the unit.



- **Do not** touch the evaporator with your hands while the ice maker is operating.
- **Do not** plug in or unplug the unit with wet hands.



- The unit **must be** placed and set up according to installation instructions before use. The unit is for indoor household use only.



- **Do not** store or use flammable vapors or liquids near the unit.
- **Do not** immerse any part of the unit in water.



- **Do not** attempt to disassemble, repair, modify or replace any part of the ice maker unless permitted by the manufacturer.

## WARNING



### FIRE OR EXPLOSION HAZARD Flammable Refrigerant

This unit contains an isobutane refrigerant, also known as R600a, a natural gas with high environmental compatibility. However, it is also combustible. Adhere to the warnings below to reduce the risk of injury or property damage.



1. When handling, installing, and operating the unit, care should be taken to avoid damage to the refrigerant tubing.



2. Only dispose of the unit according to Federal and Local Regulations. Contact your local authorities for the environmentally-safe disposal of the unit.



3. Keep ventilation openings around the unit's enclosure clear of obstruction.



4. **Do not** place the unit near heat sources such as an oven.



5. Ensure a minimum of three inches of clearance around the side and back walls of the unit for proper air circulation.



6. **Do not** place the unit in direct sunlight.

# PRODUCT INTRODUCTION

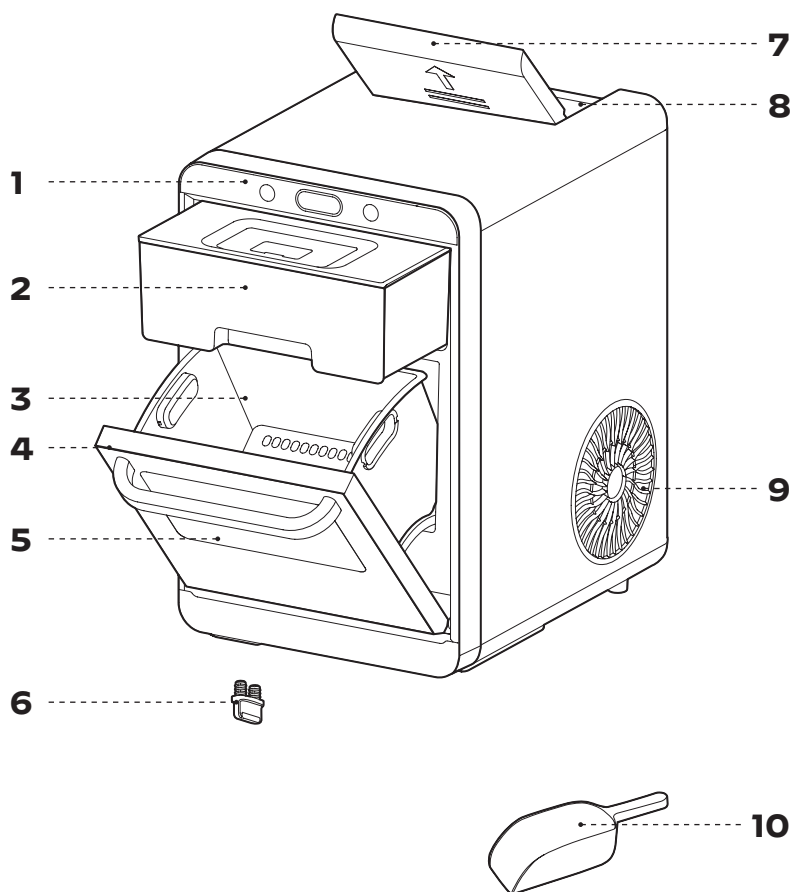

**1.** Control Panel

**2.** Drawer Water Tank

**3.** Ice Basket

**4.** Flip Door

**5.** Viewing Window

**6.** Drain Plug

**7.** Water Fill Lid

**8.** Second Water Tank

**9.** Air Exhaust Fan

**10.** Ice Scoop

# CONTROL PANEL INTRODUCTION

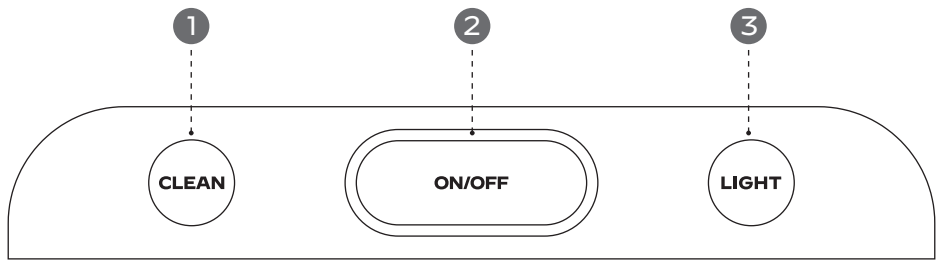

	Key (with Indicator)	Function
1	CLEAN	In standby mode, press this button and the ice maker will switch to self-cleaning mode. The indicator will illuminate.
2	ON/OFF	<p>Short press the <b>ON/OFF</b> button to turn the ice maker on.</p> <p>Short press the <b>ON/OFF</b> button to turn the ice maker off.</p> <p>The indicator stays white when making ice, green when the ice basket is full, red when the water tank is low, and blue in self-cleaning mode.</p>
3	LIGHT	Press this button to turn the ice basket lights on or off. The indicator will illuminate.

# USING YOUR ICE MAKER

## BEFORE FIRST USE

1.

Stand upright for 24hrs.

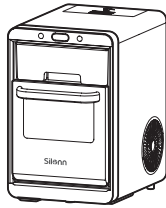

Use in locations  
50°F ~ 90°F  
(10°C ~ 32°C).

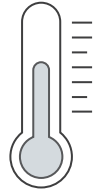

Verify all parts  
and ice maker  
accessories  
were  
received.

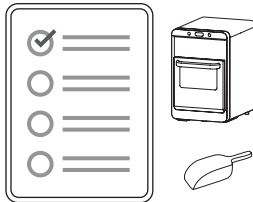

Missing parts?  
Contact Customer  
Service.



2.

Carefully remove the protective  
film and clean the ice maker  
thoroughly before first use.

**Note:** Make sure the drain plug is  
installed in place.

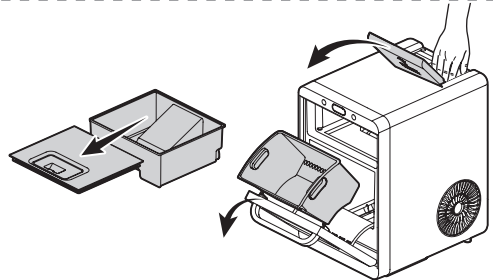

Due to temperature variations  
and other factors, ice quality  
should become stable after the  
first 1–3 cycles.

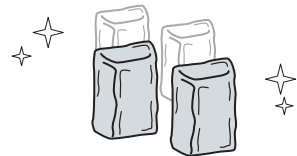

**More Cycles = Perfect Shape**

3. What Not To Do!

Unstable base.

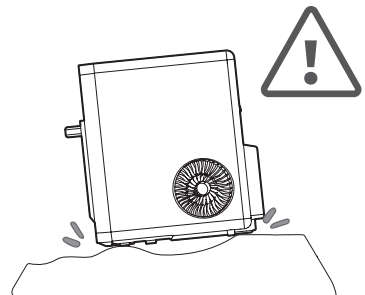

No other liquids  
(Drinking water only).

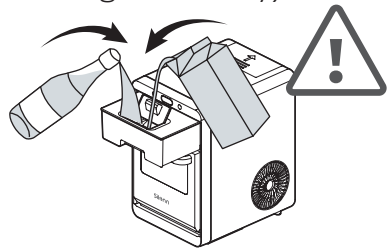

Do not use in high or low temps.

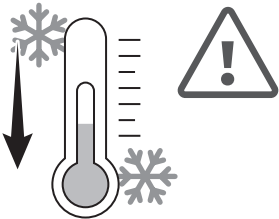

Lower than 41°F/5°C

Make sure to push the  
water tank back all  
the way, or the center  
indicator will turn red  
even if there is water  
in the water tank.

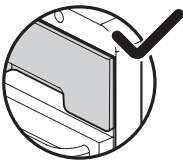
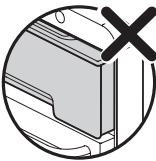
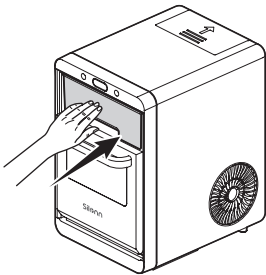

## HOW TO USE YOUR ICE MAKER

1.

Add water to the drawer water tank. Do  
not add to the second water tank.

**Note:** The drawer water tank should be  
pushed back in place after refilling.

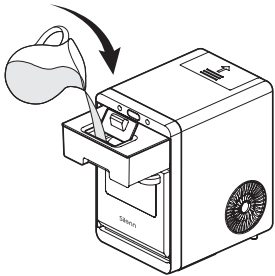

2.

Press the **ON/OFF** button.

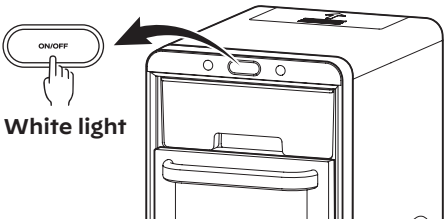



### 3.

Wait **8min-12min**. The ice-making time depends on room temp and water temp.

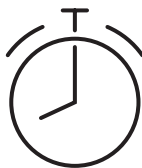

### DONE:

The center indicator turns green when the ice basket is full.

**Note:** The ice maker can produce a full basket of ice in about 100 Min.

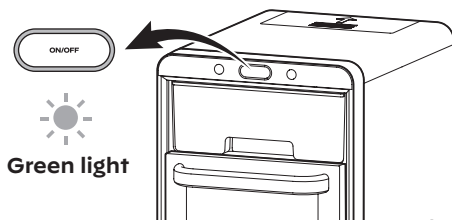

### REFILL:

When the center indicator turns red, stop making ice, and refill water. Press the **ON/OFF** button to restart the machine.

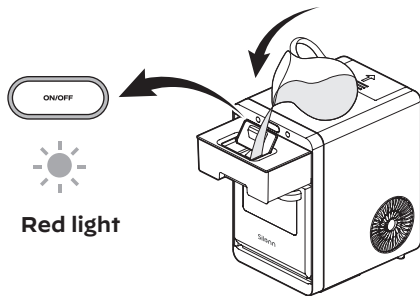

Take ice cubes out before they start to melt.

**Note:** Open the flip door gently, especially when the ice basket is full.

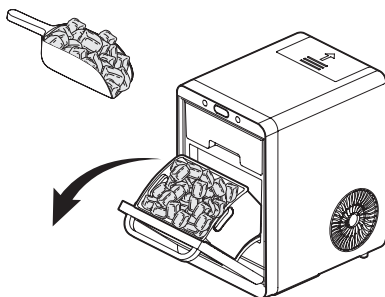

Place the ice basket in the limit slot, or it will fall into the inside of the ice maker.

If ice cubes fall into the gap of the flip door and the door cannot be closed, remove the ice cubes first.

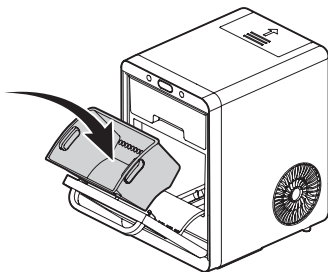

**Note:** It takes a little more time to restart the ice maker after accidental power-off.

# CLEANING AND MAINTENANCE

To keep your ice tasting fresh and the unit looking great, we recommend cleaning the unit once per week.

## SELF-CLEANING (20-MIN PROCESS)

1.

Remove the ice basket and add water to the water tank.

**Note:** In areas with hard water, professional ice maker detergent can be used to clean the ice maker. Leave the detergent in the machine for some time.

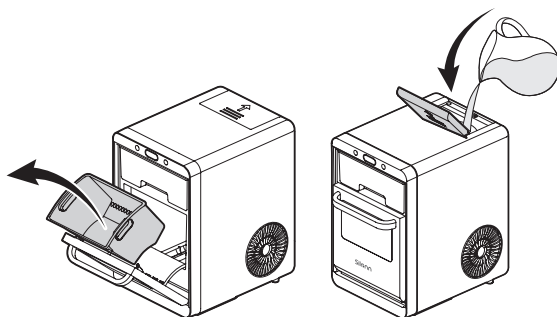

2.

### IN STANDBY MODE:

Short press the **CLEAN** button to start self-cleaning.

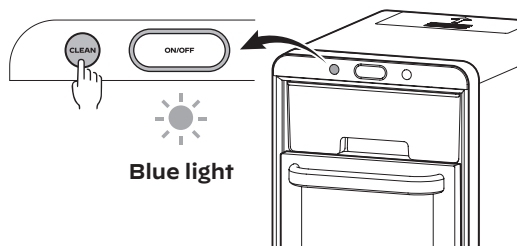

3.

Drain excess water over sink.

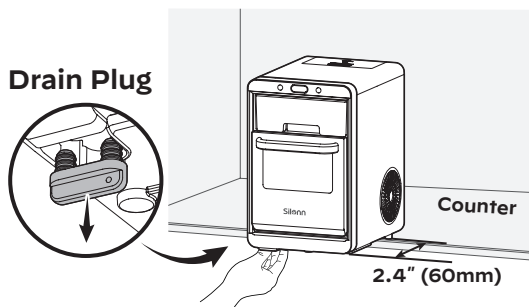

4.

Clean exterior with cloth using mild dishwashing soap.

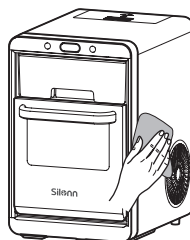

## MANUAL CLEANING

Turn off the unit and disconnect from power before cleaning.

### 1.

Clean using a soft cloth with warm water and vinegar. Clean the drawer water tank, second water tank, ice basket, and other small corners to prevent dirt buildup.

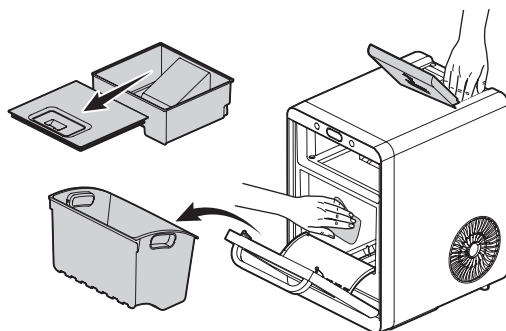

### 2.

Drain excess water over sink.

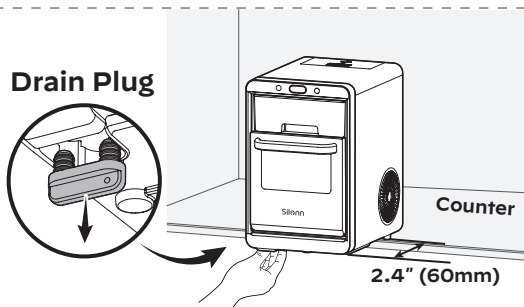

### 3.

Clean exterior with cloth using mild dishwashing soap.



## ⚠ DO's & DON'Ts while cleaning and maintaining

- **Do not** use organic solvent, boiled water, strong acid and strong alkali etc. for cleaning.
- Considering the wide range of water quality across different regions, it is recommended to perform regular manual cleaning.
- When the unit is not to be used for a long duration, **drain** the water completely & dry the interior.
- **Store** in a well-ventilated area.

# PRODUCT SPECIFICATIONS

Model	SLIM32T
Voltage/Frequency	120V/60Hz
Ice-Making Current	2.7A
Working Power	192W
Water Reservoir	0.48 gal (1.8L)
Ice Basket Capacity	2.6 lbs (1.2kg)
Ice-Making Rate	44 lbs (20kg) per Day
Ice Shape	Nugget
Material	ABS, PP, Stainless Steel
Net Weight	26.5 lbs (12kg)
Product Size	9.4 x 13.6 x 14.8 inch (240 x 345 x 376mm)

## TROUBLESHOOTING

Problem	Possible Causes	Solution
The <b>ON/OFF</b> button indicator turns red.	Low water level or not enough water.	Stop making ice, refill water, press the <b>ON/OFF</b> button, then restart and try again.
	The drawer water tank has not been pushed back in place.	Push the drawer water tank back all the way.
The <b>ON/OFF</b> button indicator turns green.	Ice is full and ready.	Empty the ice basket.
	Something is blocking the inner wall if there is no ice.	Remove the obstruction and clean the inner wall.
The <b>ON/OFF</b> button indicator flashes in red.	The ambient temperature or the water temperature in the inner tank is too high.	Please run the ice maker in a location below 90°F and pour colder water.
	Refrigerant liquid leakage.	Press the <b>ON/OFF</b> button twice to restart the ice-making program. If the problem occurs again, please contact customer service.
	The cover motor is broken.	
	The pipe in the cooling system is blocked.	

Problem	Possible Causes	Solution
<b>Making ice too slowly.</b>	The hot air outlet has been blocked by something.	Keep a 5.9 inches (15cm) distance from the hot air outlet and the wall.
	The water temperature in the inner tank is too high.	The water temperatures should be between 45°F - 90°F.
	The refrigeration system is not functioning properly.	Please contact customer service.
<b>Water leakage.</b>	The drain plug is not in place.	Reinstall the drain plug in place.
	Pipe joints in the appliance may be loose.	Please contact customer service.
	The seal has completed its service life and needs to be replaced.	

## **WARRANTY INFORMATION**

### **30-DAY LIMITED WARRANTY**

To provide customers with a quality shopping and user experience, the unit can be replaced or returned for a full refund within the 30-day period from the date of purchase.

### **30-DAY TO 1-YEAR LIMITED WARRANTY**

After the 30-day warranty has expired, a 1-year warranty from the date of purchase that covers product replacement is automatically activated. Please note that proof of purchase is required for all warranty claims.

### **30-DAY TO 1-YEAR WARRANTY LIMITATIONS**

This warranty does not cover:

- Any condition resulting from incorrect or inadequate maintenance or care.
- Damage resulting from misuse, abuse, negligence, accidents, or shipping damage.
- Dissatisfaction due to buyer's remorse.
- Normal wear and tear.
- Damages incurred after initial transportation.

## **FCC Caution:**

Any changes or modifications not expressly approved by the party responsible for compliance could void the user's authority to operate this equipment.

This device complies with part 15 of the FCC Rules. Operation is subject to the following two conditions: (1) this device may not cause harmful interference, and (2) this device must accept any interference received, including interference that may cause undesired operation.

This device and its antenna(s) must not be co-located or operating in conjunction with any other antenna or transmitter.

NOTE: This equipment has been tested and found to comply with the limits for a Class B digital device, pursuant to Part 15 of the FCC Rules. These limits are designed to provide reasonable protection against harmful interference in a residential installation. This equipment generates, uses and can radiate radio frequency energy and, if not installed and used in accordance with the instructions, may cause harmful interference to radio communications. However, there is no guarantee that interference will not occur in a particular installation. If this equipment does cause harmful interference to radio or television reception, which can be determined by turning the equipment off and on, the user is encouraged to try to correct the interference by one or more of the following measures:

- Reorient or relocate the receiving antenna.
- Increase the separation between the equipment and receiver.
- Connect the equipment into an outlet on a circuit different from that to which the receiver is connected.
- Consult the dealer or an experienced radio/TV technician for help.

To maintain compliance with FCC's RF Exposure guidelines, This equipment should be installed and operated with minimum distance between 20cm the radiator your body: Use only the supplied antenna.



# Thank You

for Choosing Us!

All of us do appreciate your ice maker purchase. We hope that you are as happy with the ice maker as we were designing and manufacturing it for you. We strive to provide you with the best quality ice makers and services in the industry.

## Questions or Problems?

 877-546-8603 Mon–Fri, 8am–8pm (CST)

 [support@silonn.com](mailto:support@silonn.com)

860-02733-00 Rev00