

Tire Pressure Monitoring System

Users' Guide
Item No.: T6



Suitable for Trucks, RVs and Trailers

I. Products Specification

- * Anti-theft sensor
- * Waterproof and dust-proof
- * Battery replaceable
- * Each sensor has individual ID
- * High sensitivity
- * Long transmission distance

II. System Components

Item	Q' ty
External Sensor	Same quantity as tire
Anti-theft Lock Nut	Same quantity as sensor
Spare Waterproof O-ring	Same quantity as sensor
Installation Wrench	2pcs for full set pack

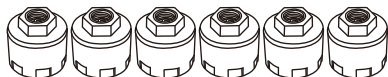

External Sensor



Anti-theft Lock Nut



Waterproof O-ring



Installation Wrench

III. Sensor Installation

NOTE:

1. Please match the sensors with monitor according to the monitor users' manual before installation.
2. Label the sensors with the number sticker provided in accessories pack according to the instruction below.
3. There will be alert on monitor when the sensor is low battery. Please replace a new CR1632 battery for safety driving.
4. Test the sensors with soap bubbles after installation to check if there is leakage.

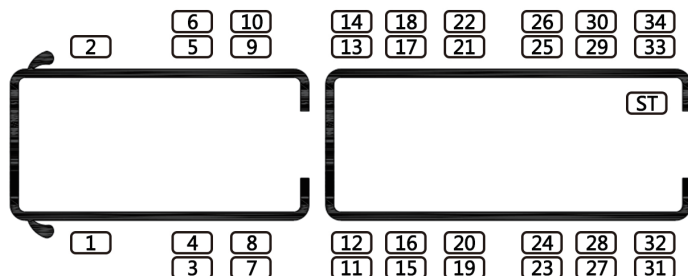

Sensor Installation

NOTE: Please turn on the monitor before sensor installation for swift signal transmission.

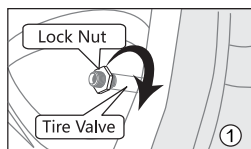

Install the sensor onto tire valve

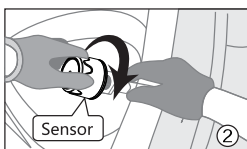

Tighten the sensor onto tire valve clockwise

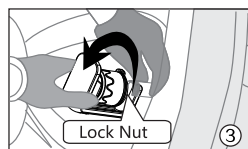

Tighten the lock nut onto the sensor anticlockwise

IV. Battery Replacement

1. Use the wrench provided to put on the sensor valve as below. Then screw off the sensor valve anticlockwise and open the battery cap.

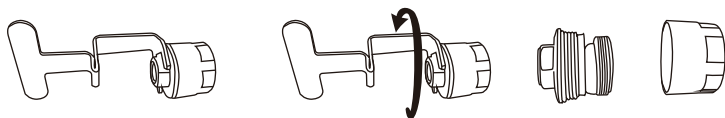

2. Take out the battery from battery pool.



3. Install a new CR1632 battery inside the battery pool, make sure positive pole upside.

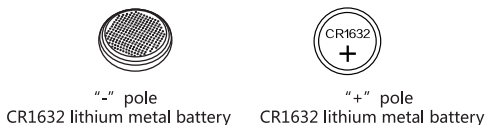

4. Put back the battery cap and tighten the cap with the wrench clockwise.

NOTE: Replace a new waterproof O-ring from the accessory pack if it's broken.

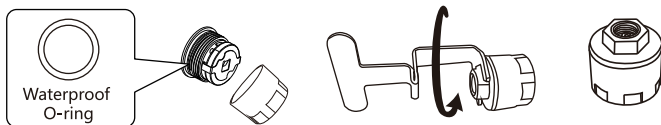

V. Specifications

Pressure Range	0~218 PSI (0~15 BAR)
Pressure Accuracy	±0.1 BAR(±1.5 PSI)
Temperature Accuracy	±3°C
Battery Life	≈2 years
Working Temperature	-40°C~125°C
Storage Temperature	-40°C~85°C
Transmission Frequency	433MHz
Size(mm)	R 21mm,H 21mm
Weight	13g

VI FCC Statement

NOTE: This equipment has been tested and found to comply with the limits for a Class B digital device, pursuant to part 15 of the FCC Rules. These limits are designed to provide reasonable protection against harmful interference in a residential installation. This equipment generates, uses and can radiate radio frequency energy and, if not installed and used in accordance with the instructions, may cause harmful interference to radio communications. However, there is no guarantee that interference will not occur in a particular installation. If this equipment does cause harmful interference to radio or television reception, which can be determined by turning the equipment off and on, the user is encouraged to try to correct the interference by one or more of the following measures:

- Reorient or relocate the receiving antenna.
- Increase the separation between the equipment and receiver.
- Connect the equipment into an outlet on a circuit different from that to which the receiver is connected.
- Consult the dealer or an experienced radio/TV technician for help.

This device complies with part 15 of the FCC Rules. Operation is subject to the following two conditions:

- (1) This device may not cause harmful interference, and (2) this device must accept any interference received, including interference that may cause undesired operation

Warning: Changes or modifications not expressly approved by the party responsible for compliance could void the user's authority to operate the equipment.