

1

Auto Vent Dashboard 10W Wireless Charger & Phone Holder Instruction Manual EAC-AV20

READ ALL INSTRUCTIONS CAREFULLY BEFORE USE AND KEEP THIS MANUAL

In the Box

- 10W Wireless Charger & Phone Holder (x1)
- Adhesive Fixed Stand (x1)
- Air Vent Clip (x1)
- Securing Knob (x1)
- Power Cable (x1)
- User Manual (x1)

Safety Precautions

- This product is NOT a toy, keep away from children and pets.
- Only use the device according to the instructions in this manual. Never use the device for anything other than its intended purpose.
- ONLY use the supplied power cable.
- Do not open this product or attempt to repair the unit yourself if it is not working properly. Doing so risks fire, shock or injury.
- When not in use, the device should be stored in a dry, cool location, away from sources of water or heat.
- Do not expose device or power cable to extreme temperatures (heat or cold), open flames, humid or wet conditions.
- Do not submerge in water. Do not use in a location where the device or power cable could fall into liquid.
- Unplug the charging cable when not in use. Do not pull the charging cable to disconnect, or use the cable as a handle.
- Do no use if device or power cable is damaged. If device or power cable is damaged, it MUST be serviced or replaced by the manufacturer or its service agent before using again.
- Attachments on the back of your smartphone can impede effectiveness of the wireless charger, and lead to overheating. Remove attachments from your smartphone before charging on this wireless charger.

2

Product

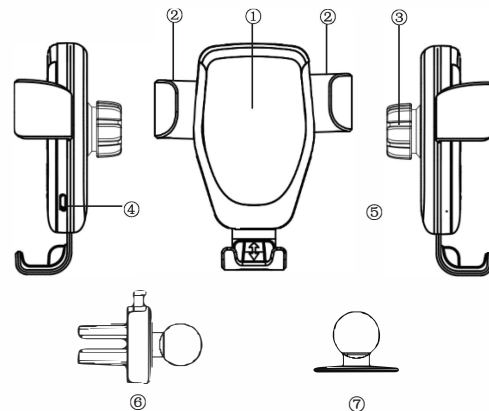

- ① Wireless Charging Surface
- ② Clamping Arms
- ③ Securing Knob
- ④ Micro USB Input
- ⑤ LED Indicator
- ⑥ Air Vent Clip
- ⑦ Adhesive Stand

How To Mount

- Turn the securing knob on the back of bracket counterclockwise to loosen.
- Push the air vent clip or adhesive stand into the ball joint adapter on the back of bracket.
- Turn the securing knob on the back of bracket clockwise to tighten.
- If using the air vent clip, press the button on air vent clip to mount the bracket to air vent of a car.
- If using the adhesive stand, peel off the sticker cover on the bottom

3

- and attach it to a smooth surface, such as the car dashboard.
- Place smartphone on the phone mount, the clamping arms will hold the smartphone automatically.
- Slide smartphone upwards to remove from the mount.
- The 360° rotating ball joint on the mount enables adjustment for flexible viewing angles while driving.

Instructions

- Plug the small connector of the included charging cable into the micro USB charging port on the phone mount.
- Plug the large connector of the included charging cable into an USB power source, such as the USB port on a computer or into a compatible 5V USB car charger (not included).
- The LED indicator will flash **RED** and **BLUE** alternatively 3 times before glow solid **RED** to indicate the wireless charger is in standby mode and ready to begin charging.
- Place a wireless charging enabled smartphone on the charging surface, the smartphone will begin to charge automatically. The LED will glow **BLUE** while smartphone is charging.

Note: If the LED indicator is flashing when the wireless charger is in use, either the smartphone is NOT wireless charging enabled, or there is an object between the smartphone and wireless charging surface interfering with the charging process.

Tech Specifications

- Input Power: DC 5V/3A
- Wireless Charging Output: 10W

FCC Information

This device complies with Part 15 of the FCC Rules.

Caution: Any changes or modifications not expressly approved could void the user's authority to operate the equipment.

Note: This equipment has been tested and found to comply with the limits for a Class B digital device, pursuant to Part 15 of the FCC Rules. These limits are designed to provide reasonable protection

4

harmful interference in a residential installation. This equipment generates, uses and can radiate radio frequency energy and, if not installed and used in accordance with the instructions, may cause harmful interference to radio communications. However, there is no guarantee that interference will not occur in a particular installation. If this equipment does cause harmful interference to radio or television reception, which can be determined by turning the equipment off and on, the user is encouraged to try to correct the interference by one or more of the following measures:

- Reorient or relocate the receiving antenna.
- Increase the separation between the equipment and receiver.
- Connect the equipment into an outlet on a circuit different from that to which the receiver is connected.
- Consult the dealer or an experienced radio/TV technician for help.

This device complies with part 15 of the FCC rules. Operation is subject to the following two conditions (1) this device may not cause harmful interference, and (2) this device must accept any interference received,

The equipment complies with FCC radiation exposure limits set forth for an uncontrolled environment. During the operation of device a distance of 15 cm surrounding the device and 20 cm above the top surface of the device must be respected.

FC
Made in China