

QERE

Model E28
Instructions for use

Schematic diagram



Specifications

Name	QERE Earphone
Model	QERE E28
BT Version	5.3
Protocol	HFP, HSP, A2DP, AVRCP, SPP, PBAP, TWS+
Communication distance	10M/33 feet (free space)
Earbuds battery capacity	3.7V/35mAh
Charging box battery capacity	3.7V/250mAh
Music time	about 6-7 hours
Talking time	about 6 hours
Earbuds charging time	about 1 hour
Charging case charging time	about 2 hours
Charging case battery life	about 14 hours
Speaker size	Ø15mm
Speaker resistance	32Ω15%
Transmission frequency	2400KHz-2.4800GHz
Microphone sensitivity	<42dB
Charging port	Type-C

Features:

1. Light weight & comfortable fit
2. BT version is 5.3, prompt pairing & connection
3. Clear sound & call
4. Smart touch control
5. Master Slave switch seamlessly
6. Compatible with Android, IOS mobile devices

Device connection

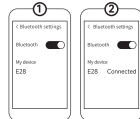

Turn on the phone's Bluetooth, then search for the E28 Bluetooth name and click connect.

Step 1: Make sure the phone's Bluetooth is turned on/Equipment search E28

Step 2: connection succeeded



Operation Instructions

Turn on

Open the lid of the charging case and the earbuds turn on.

Turn off

1.Put the earbuds back in the charging case to turn off .
2.If it turns on for 3 minutes without connection, it will automatically shut down.

TWS Pairing

When the left and right earbuds are both in the charging case and the lid is closed, they automatically enter TWS pairing mode in about 15-30 seconds.

Connect with mobile phone

1.Turn on the wireless function of mobile phone;
2.Turn on the earbuds (open the lid of the charging case) and search for the device model on the mobile phone and click it. If the connection is successful, there will be a prompt tone when you put on the earbuds.

Reconnect

The earbuds will automatically connect back with last paired device when they turn on next time.

Answer the call

Double touch L or R earbud

Hang up the call

Double touch L or R earbud

Refuse the call

Triple touch L or R earbud

Earbuds charging

Put the earbuds into the charging case and close the lid

Charging case charging

When charging, the LED light will flash. If they are fully charged, the LED light is always on.

Music play&pause

Double touch R earbud

Next track

Triple touch R earbud

Volume+

Touch R earbud four times

Previous track

Triple touch L earbud

Volume-

Touch L earbud four times

Voice assistant / Siri

Double touch L earbud

Product Safety Information

- Please follow the safety cautions and use the product in a correct way to avoid casualties and damages.
Please follow the following notes to prevent accidents like fire, overheat, chemical leakage and explosion.
- (1) To reduce the risks of fire and damage of the battery, please do not expose the product to the rain or moisture environment.
- (2) To reduce the risks of fire, please do not cover the product with inflammable like carpet and quilt.
- (3) To prevent the product from further damages, it is prohibited to dismantle the broken device without permit. In this case, please consult the After sales Department for the repair.
- (4) Please do not use it when the device is over heating.
- (5) Please do not apply any batteries, powers or accessories other than specified in the Instruction.
- (6) Please do not use self-made or modified batteries.
- (7) Do not use the wireless charging transmitter that has not passed the Qi certification standard to charge the charging box.
- (8) Do not place the device near heat sources or exposed fire sources, such as electric heaters, microwave ovens, stoves, water heaters, candles or other places that may generate high temperatures.

QERE

Model E28
Instructions for use

Schematic diagram

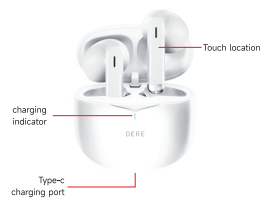

Specifications

Name	QERE Earphone
Model	QERE E28
BT Version	5.3
Protocol	HFP, HSP, A2DP, AVRCP, SPP, PBAP, TWS+
Communication distance	10M/33 feet (free space)
Earbuds battery capacity	3.7V/35mAh
Charging box battery capacity	3.7V/250mAh
Music time	about 6-7 hours
Talking time	about 6 hours
Earbuds charging time	about 1 hour
Charging case charging time	about 2 hours
Charging case battery life	about 14 hours
Speaker size	Ø15mm
Speaker resistance	32Ω15%
Transmission frequency	2400KHz-2.4800GHz
Microphone sensitivity	<42dB
Charging port	Type-C

Features:

1. Light weight & comfortable fit
2. BT version is 5.3, prompt pairing & connection
3. Clear sound & call
4. Smart touch control
5. Master Slave switch seamlessly
6. Compatible with Android, IOS mobile devices

Device connection

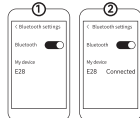

Turn on the phone's Bluetooth, then search for the E28 Bluetooth name and click connect.

Step 1: Make sure the phone's Bluetooth is turned on/Equipment search E28

Step 2: connection succeeded



Operation Instructions

Turn on

Open the lid of the charging case and the earbuds turn on.

Turn off

1.Put the earbuds back in the charging case to turn off .
2.If it turns on for 3 minutes without connection, it will automatically shut down.

TWS Pairing

When the left and right earbuds are both in the charging case and the lid is closed, they automatically enter TWS pairing mode in about 15-30 seconds.

Connect with mobile phone

1.Turn on the wireless function of mobile phone;
2.Turn on the earbuds (open the lid of the charging case) and search for the device model on the mobile phone and click it. If the connection is successful, there will be a prompt tone when you put on the earbuds.

Reconnect

The earbuds will automatically connect back with last paired device when they turn on next time.

Answer the call

Double touch L or R earbud

Hang up the call

Double touch L or R earbud

Refuse the call

Triple touch L or R earbud

Earbuds charging

Put the earbuds into the charging case and close the lid

Charging case charging

When charging, the LED light will flash. If they are fully charged, the LED light is always on.

Music play&pause

Double touch R earbud

Next track

Triple touch R earbud

Volume+

Touch R earbud four times

Previous track

Triple touch L earbud

Volume-

Touch L earbud four times

Voice assistant / Siri

Double touch L earbud

Product Safety Information

- Please follow the safety cautions and use the product in a correct way to avoid casualties and damages.
Please follow the following notes to prevent accidents like fire, overheat, chemical leakage and explosion.
- (1) To reduce the risks of fire and damage of the battery, please do not expose the product to the rain or moisture environment.
- (2) To reduce the risks of fire, please do not cover the product with inflammable like carpet and quilt.
- (3) To prevent the product from further damages, it is prohibited to dismantle the broken device without permit. In this case, please consult the After sales Department for the repair.
- (4) Please do not use it when the device is over heating.
- (5) Please do not apply any batteries, powers or accessories other than specified in the Instruction.
- (6) Please do not use self-made or modified batteries.
- (7) Do not use the wireless charging transmitter that has not passed the Qi certification standard to charge the charging box.
- (8) Do not place the device near heat sources or exposed fire sources, such as electric heaters, microwave ovens, stoves, water heaters, candles or other places that may generate high temperatures.

FCC Warning:

This equipment has been tested and found to comply with the limits for a Class B digital device, pursuant to part 15 of the FCC Rules. These limits are designed to provide reasonable protection against harmful interference in a residential installation. This equipment generates, uses and can radiate radio frequency energy and, if not installed and used in accordance with the instructions, may cause harmful interference to radio communications. However, there is no guarantee that interference will not occur in a particular installation. If this equipment does cause harmful interference to radio or television reception, which can be determined by turning the equipment off and on, the user is encouraged to try to correct the interference by one or more of the following measures:

- Reorient or relocate the receiving antenna.
- Increase the separation between the equipment and receiver.
- Connect the equipment into an outlet on a circuit different from that to which the receiver is connected.
- Consult the dealer or an experienced radio/TV technician for help.

Caution: Any changes or modifications to this device not explicitly approved by manufacturer could void your authority to operate this equipment.

This device complies with part 15 of the FCC Rules. Operation is subject to the following two conditions:

(1) This device may not cause harmful interference, and (2) this device must accept any interference received, including interference that may cause undesired operation.

This equipment complies with FCC radiation exposure limits set forth for an uncontrolled environment. This equipment should be installed and operated with minimum distance 0cm between the radiator and your body.