

PROJECTOR

FCC WARNING

This device complies with part 15 of the FCC Rules. Operation is subject to the following two conditions: (1) this device may not cause harmful interference, and (2) this device must accept any interference received, including interference that may cause undesired operation. Any changes or modifications not expressly approved by the party responsible for compliance could void the user's authority to operate the equipment.

NOTE: This equipment has been tested and found to comply with the limits for a Class B digital device, pursuant to Part 15 of the FCC Rules. These limits are designed to provide reasonable protection against harmful interference in a residential installation. This equipment generates, uses and can radiate radio frequency energy and, if not installed and used in accordance with the instructions, may cause harmful interference to radio communications.

However, there is no guarantee that interference will not occur in a particular installation. If this equipment does cause harmful interference to radio or television reception,

which can be determined by turning the equipment off and on, the user is encouraged to try to correct the interference by one or more of the following measures:

- Reorient or relocate the receiving antenna.
- Increase the separation between the equipment and receiver.
- Connect the equipment into an outlet on a circuit different from that to which the receiver is connected.
- Consult the dealer or an experienced radio/TV technician for help.

To maintain compliance with FCC's RF Exposure guidelines, This equipment should be installed and operated with minimum 20cm distance between the radiator and your body: Use only the supplied antenna.

USER'S MANUAL

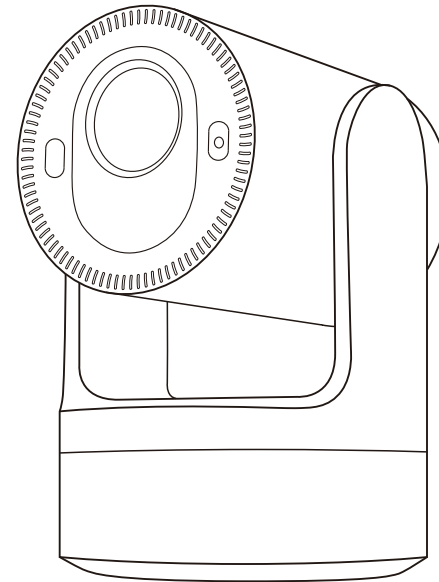

(English) CATALOG

- 01-03 Safety Instructions
- 04 Package List
- 05-06 Check Before Use
- 07 Getting Started
- 08 Connection
- 09-10 Installation and Debugging
- 11-14 Start Using and Wireless Connection
- 15 Projector Installation
- 16 Technology features
- 17-20 Questions&Answers



Safety Instructions

Important safety considerations

Attentions:

Thank you for purchasing this series of digital projector.

Please read through this "User's manual" for proper use of this product.

Please keep this manual together with the warranty card in a safe place for reference as needed after reading.

Please read this "User's manual" to find things you need to know in use or in case of problems.



Note:

Do not open the enclosure to avoid electric shock. No components in the projector can be repaired by customers. Please entrust qualified professional maintenance personnel for repair.



The identification warns users of the voltage without insulating treatment in the projector, which may cause electric shock via surface magnetic field. Therefore, it's very dangerous to contact with any component inside the projector.



The identification reminds users to be very careful and cautious in the operation and maintenance. Therefore, carefully read the manual to avoid any failures.

Warning

Do not expose the projector to rain or moisture to avoid fire or electric shock; do not open the enclosure.

Important safety considerations

The following safety instructions ensure the long service life of the projector to avoid fire or electric shock. Make sure to carefully read them and pay attention to all the following warnings.

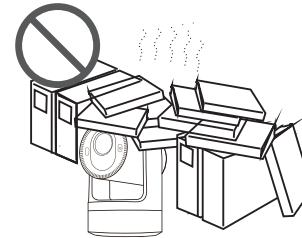

Do not install the projector in sites with improper ventilation.

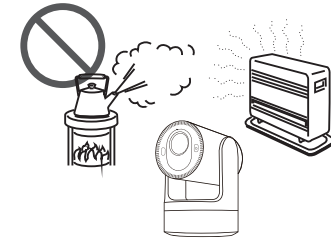

Do not install the projector in hot and humid sites.

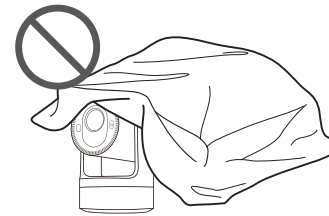

Do not block the ventilation holes (intake or exhaust)

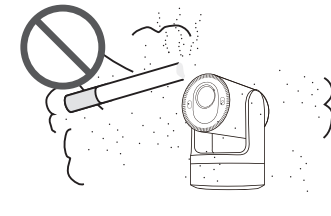

Do not install the projector in dust and smoke sites.



Do not install the projector near the temperature and smoke transducer. It may cause a sensor failure.

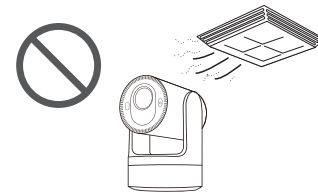

Do not install the projector in sites with direct blowing of warm and cool air-condition wind. Otherwise it may cause the project failure due to moisture condensation or temperature increment.

Important safety considerations

Installation

- Please use the projector in a dark room for best results.
- Please use the projector with caution to avoid dropping or shocking, which may damage the internal components.

Power Supply

- Use the power cord with caution to avoid unduly bending. Damaged power cord may cause electric shock or fire.
- Unplug the power cord from the outlet after using the projector.

Cleaning

- Unplug the power cord from the projector.
 - Use a wet cloth to clean the cabinet regularly. Neutral detergent may be used for serious smudge. Do not use strong detergent or solvent such as alcohol or diluent.
 - Use an air brush or lens paper to clean the lens and be careful not to scratch or abrade them.
 - Please clean the ventilation opening and the loudspeaker regularly with a cleaner. The projector will be overheated with blocked dust, causing the failure.
- Please use the projector with a soft brush. Do not use rigid accessories, such as a crevice cleaning tool, to avoid damage to the projector.

Notes on Fire and Electric Shock

- Make sure of adequate ventilation and blocked outlet to avoid heat accumulation within the projector.
- Prevent foreign objects from falling into the projector, such as paper clips and paper scraps, do not attempt to retrieve any such object. Do not insert any metal object, such as an iron wire or a screwdriver, into the projector. Make sure to immediately turn off the power and ask qualified professional maintenance personnel to remove any object falling into the projector.
- Do not place any liquid on the projector.

Moving

- Please use soft package materials and attach the lens cover to protect the lens when moving the projector. Also, do not impose severe mechanical vibration on the projector.

High Temperature Warning

- During and after the projection, the temperature near the outlet will rise, therefore touching may cause burns. Do not peep at the lens, or it may cause severe eye injury.



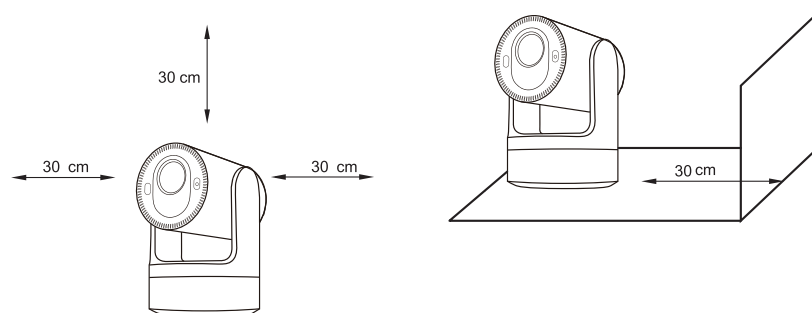

Installed Away from Walls

- Please leave at least 30cm from the wall to maintain the projector's performance and reliability.

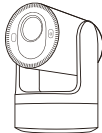
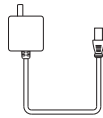

Package List

Package Include

 Projector x1	 Power Cable x1	 HD Cable x1 (Optional)
 Remote Control x1 (Batteries are not included)	 Projector User Manual	

Tips:

Blurry Image

*First, correct the keystone to a rectangle.

* Second, Press the Remote control Autofocus F+ or F- button to obtain the best clarity.

*Elective Projection Distance: 2.9~18 feet.

*If there is any part missing, please contact our customer service email address contact the seller you bought this device.

Check Before Use

Names and Functions of Projector Components

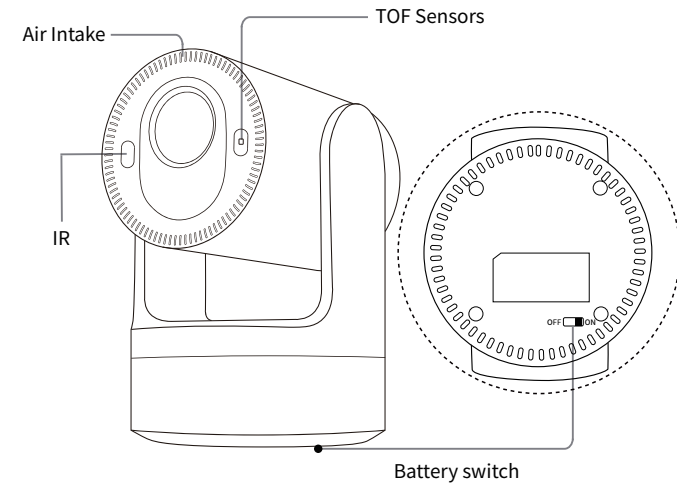
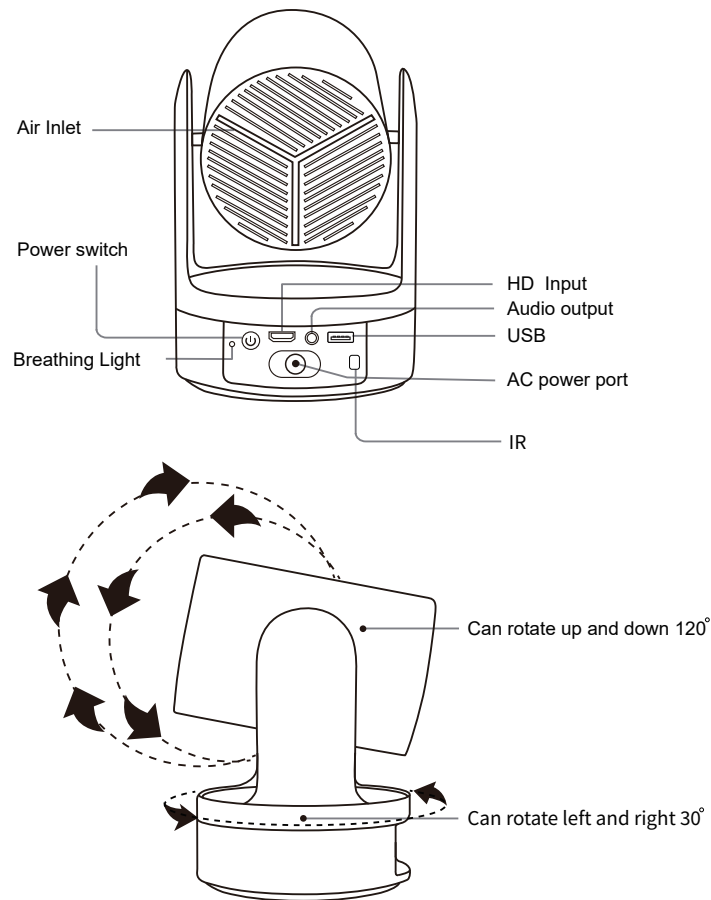

Warning

The battery switch controls the charging and discharging of the built-in Battery, which is turned off by default when leaving the factory.

- 1) Turn ON the battery switch at first use (→ ON) , Plug in the power adapter and charge the battery at the same time.
- 2) It is recommended to turn OFF the battery switch (→ OFF) when not in use for a long time to avoid the continuous consumption of the battery.
- 3) When the projector is used outdoors, the battery switch (→ ON) is turned ON and the battery is independently powered.
- 4) when the projector needs to be shut down and restarted due to unexpected operation error, the following steps can be followed:

Unplug the power adapter-turn OFF the battery switch (→ OFF),Turn ON the battery switch (→ ON) .

Check Before Use

Get to Know the Remote Control

IR Transmitter

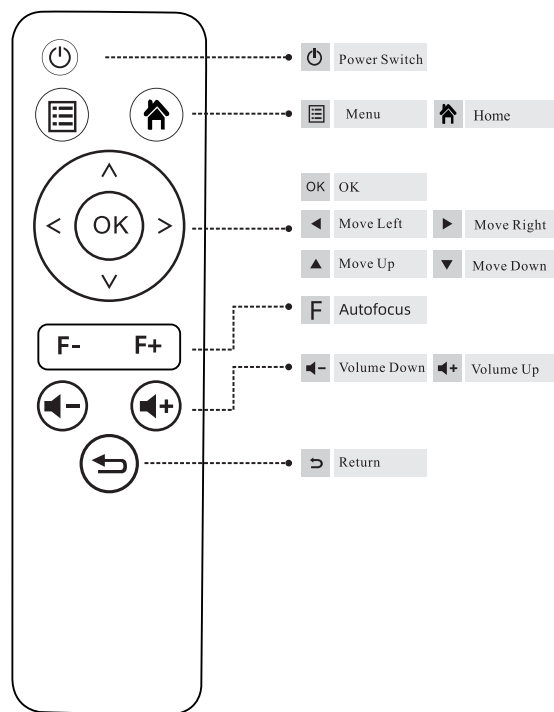

! Attentions:

Please be careful when operating the remote control. Do not drop or tread on the remote control, or splash any kind of liquid into the remote control.

Do not place the remote control near a heat source, in a place exposed to direct sunlight or in a damp room.

Connection

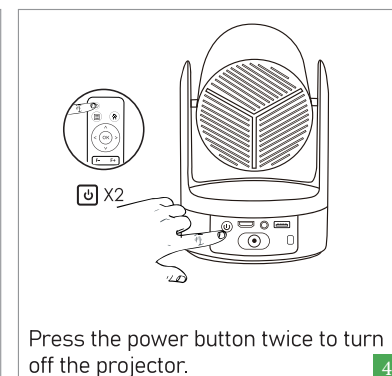
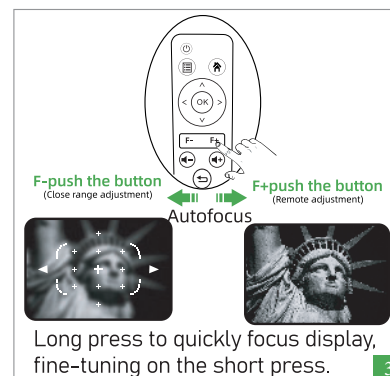
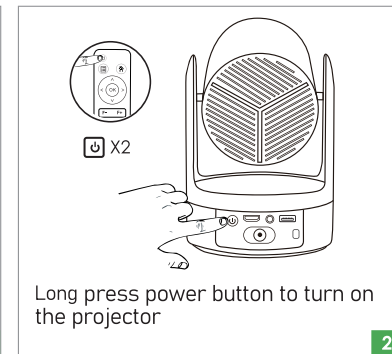
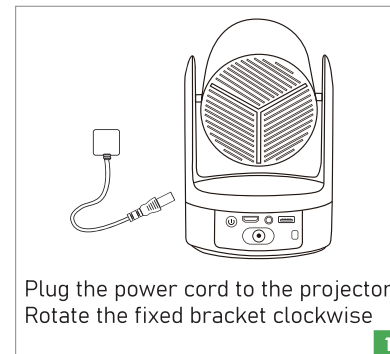

Connect multiple devices and applications.

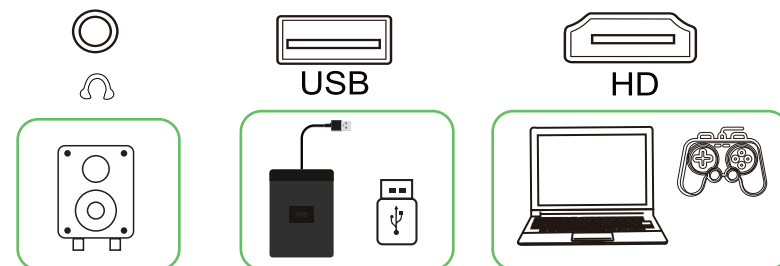

Installation and Debugging

How to install and debug a projector quickly

1 Install the Projector

You can choose to place the projector on the horizontal plane or attach it to a hanging bracket.

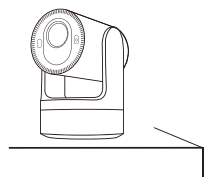

Horizontal Placement

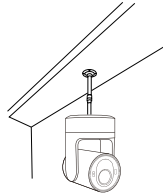

Hanging Bracket Installation
(Battery-operated models do not support ceiling installation)

! Attentions:

The hanging bracket is an accessory that is not supplied.

2 Automatic focus adjustment

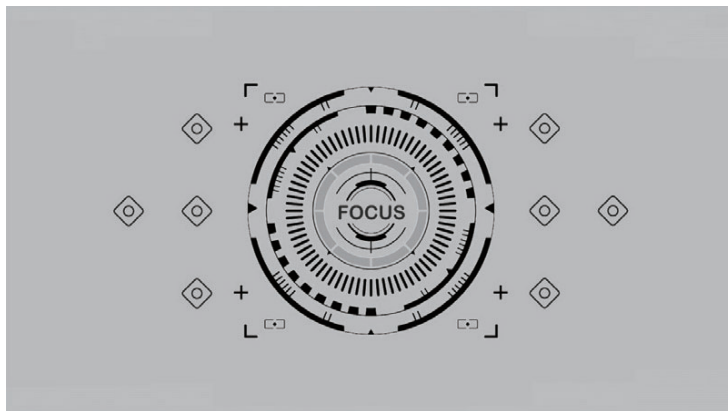

After the projector is placed in a fixed position
Power on and display the autofocus screen, The picture will automatically adjust to the clearest

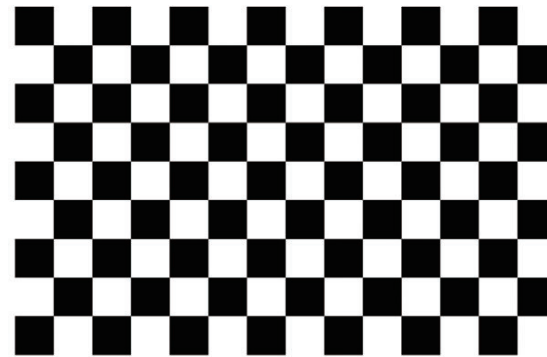

How to install and debug a projector quickly

3 Automatic keystone correction



Next The machine will automatically perform keystone correction, Until the screen becomes a standard rectangle

4 Safe Shutdown

- (1) Use the key  on the remote control to shutdown the projector.
- (2) Press and hold the key  on the control panel to shutdown the projector.
- (3) Press the soft key  on the Port and shutdown the projector according to the prompts
- (4) Please unplug the power cord after the projector shutdowns to save energy. Press and hold the key on the control panel to shutdown the projector.

Start Using

Input Source Switching

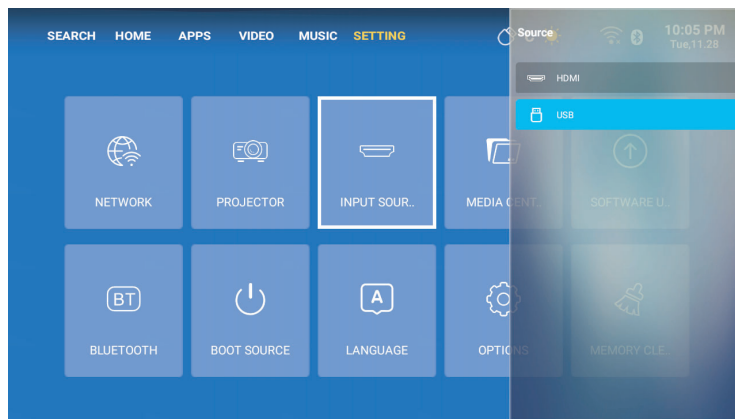
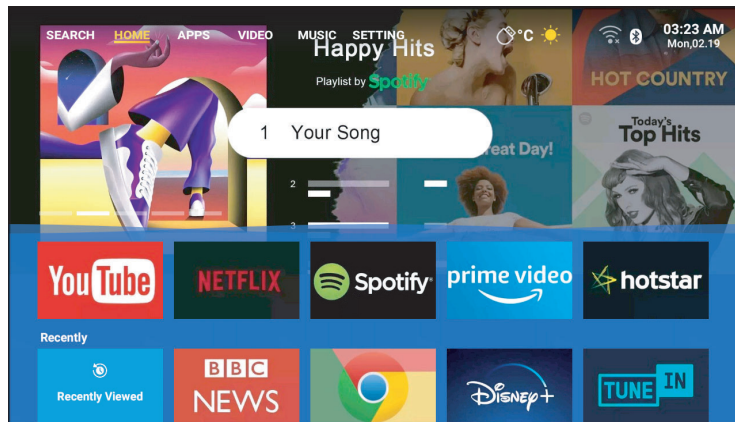

1. In the main screen, use the left or right button of the remote control to select "SETTING"
2. Select "INPUT SOURCE" below the remote control and press the "OK" key to read the "USB" content.

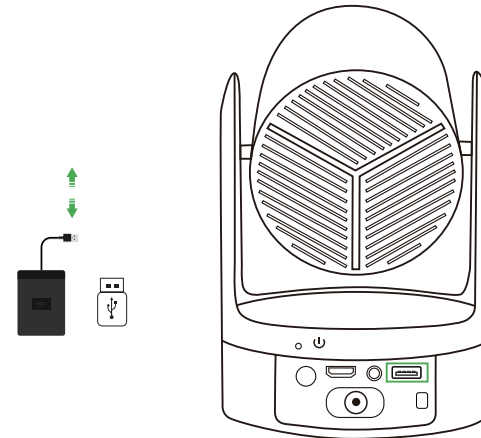

USB interfaces support USB flash disk, mobile hard disk reading and playback

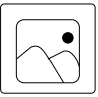
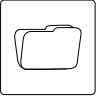

List of supported formats.

 <p>Movie</p>	<p>Support Movie:</p> <p>3GP/AVI/FLV/MP4 / MPG / MPEG2 H.265/VP9/H.264/MVC/MPEG1/VOB/TS/M2TS/DAT/MKV/MPEG4/AVS/VC-1/VP6-8/</p>	<p>Note:</p> <p>1.Support video with maximum 3840*2160 resolution and High-definition picture quality. 2.Playing the audio and video encoding in RM/RMVB/VC1/FLV/DTS format requires separate authorization and purchase. Even if it can be used, it is also a demo version.If it is not a member, it is not eligible for official announcement. 3.Playing Dolby AC3/DivX and other formats of audio coding requires separate authorization and purchase, and cannot be used by default</p>
 <p>Music</p>	<p>Support Music:</p> <p>MP3 / APE / AAC / FLAC / OGG / WAV / WMA / MID / DTS / M4A</p>	
 <p>Photo</p>	<p>Support Photo</p> <p>JPG、 PNG、 BMP、 JPEG</p>	<p>Note:</p> <p>Too high resolution, not supported</p>
 <p>document</p>	<p>Support document</p> <p>Txt</p>	

Projection Settings (Android Version)

Get a better viewing effect with appropriate settings. The main content of the projection can be set in the following steps.

1.If needs setting, first select "SETTINGS" on the "SETTING" screen, and press the "Ok" key on the Remote control.

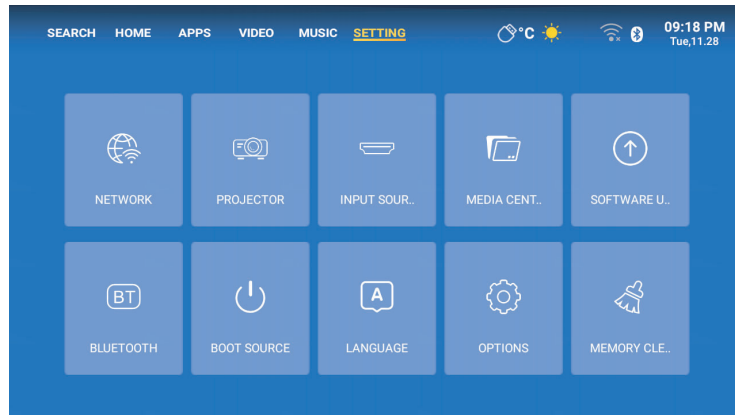

2.Here you can set and use "network", "Bluetooth", "projector", "Language", "options" etc.



Android Miracast (wireless connection) IOS Airplay (Wireless Connection)

Streaming with your router's Wi-Fi(wireless connection)

Then select "APPS" at the top of the home page, use the "down" button of the remote control to move to the "My apps" area in the lower left corner, and use the "left and right" button of the remote control to select "EshareServer" or "iMirror" or "Miracast" or "AirScreen" etc. application to start the application.

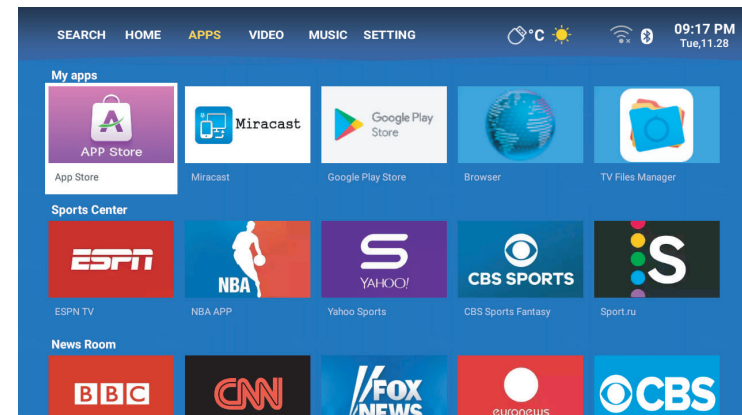

Note: If the remote control is not working in an application, you can Tap the "Menu" key button of the remote control for 3 times to call up or cancel the virtual mouse in the application. (When the Bluetooth remote control is not turned on)

Projector Installation

Place your projector on the ceiling

1. When installing the projector on the ceiling, please purchase a projector bracket recommended by an installation professional and follow the instructions supplied of the bracket.
2. Before installing the projector on the ceiling, please check if the mounting structure can support the weight of the projector and the bracket, If in doubt please consult and get the advice about the installation.

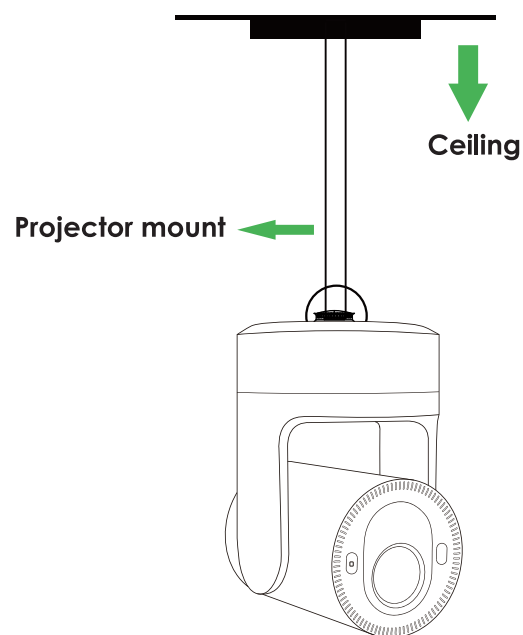

Fixed Hanger Screw Hole Type: 1/4inch.

NOTE: Projector bracket and screw (s) are not included.

Battery-operated models do not support ceiling installation

Technology features

Parameters

Product Name	Projector	Color	16700K
Image System	LCD	Light Source	LED
Support Max	3840*2160 Pixels	Aspect Ratio	16:9
Image Size	32"~200"	Projection Distance	2.9~18 feet
Projection Mode	Front / Rear /Ceiling	Transmission ratio	1.3 : 1
Speaker	4Ω 3W	Power	AC100~240V
Weight	1.25kg	Size	138*138*265mm
Input	USB*1, HD*1	Output	Audio*1

Projection Distance and Screen Size

Recommended Projection Distance: 2.9~18 feet

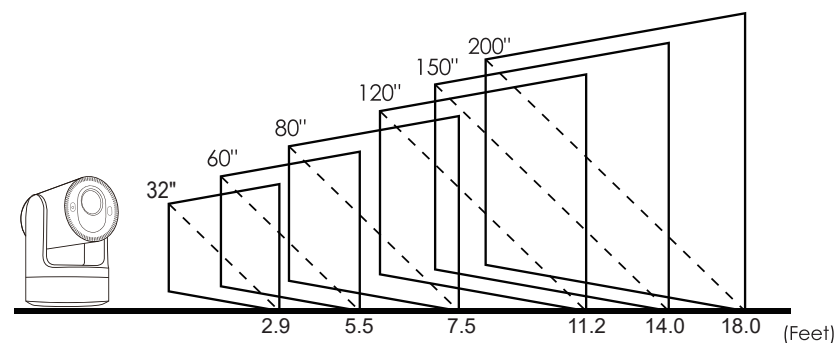

Questions&Answers

*Problems listed below might occur during the operation of your projector. Please refer to the possible factors which might cause the issue to do troubleshooting. Any questions during use, please feel free to contact our customer service team.

[Image]Q: How can I do if there is black spots, bright spots and yellowing in the projection picture?

A1: It was caused by dust, it can be cleaned, please contact our customer service team for the cleaning operation.

[Audio]Q: Why is the display of the projector available but without audio?

A1: The projector or the connected device (PC, TV, etc.) is muted.

A2: The video format is not supported by the projector.

A3: Dolby sound is not supported, exit to play again.

A4: Fire stick: Enter "Setting" and find "Display & Sound". Then select on for "navigation sounds". Select Stereo (or PCM) for "surround sound."

[Audio]Q: Why is the audio of the projector available but without display?

A1: The video format is not supported by the projector.

A2: Encryption applied to the videos or media player which holds the video.

A3: If the lamp of the projector is off with only audio playing, the lamp is defective. Please contact our customer service team for a replacement.

A4: Try another HD cable if you select the HD Input Source.

A5: Try YouTube if your Screen mirroring player Netflix, Amazon Prime, Hulu and Disney+. The problem will happens when playing these applications because of copyright.

[Audio]Q: Video playback is out of sync with sound and picture?

A1: The fluency of playing is related to the network; If you are connecte to a wifi device, it generally has a delay display.

[Signal]Q: Why does the projection screen show No Signal?

A1: Make sure all cables are plugged correctly and firmly.

A2: Make sure you select the right Input Source. For example, if you connect with phone. Please follow the "Connections" section in the manual.

[Image]Q: How can I do if the image is blurry or out of shape?

A1: Adjust the focus ring by moving it leftward/rightward till it shows the correct image.

A2: Place projector on a flat surface horizontally or vertically. An inclination any angle may result in blurry displays or uneven colors.

A3: Darker environment suggested achieving the best pro cine performance.

A4: The eligible distance of 2.9~18 feet/32inch~200inch between the projector and projecting screen/wall.

A5: Projecting wall or screen is clean white if possible.

[Image]Q: How can I do if the image is up side down?

A1: Press the "Menu" on the remote to enter the Settings. Then, select "Projection Mode". Press "OK" button to rotate the image.

[Image]Q: How can I do if the projection screen is not square or allied horizontally?

A1: Make sure the projector is placed on a flat surface with projector light in the middle of the screen.

A2: Make sure the projector screen is placed horizontally.

[Image]Q: How can I do if there is color distortion?

A1: Make sure the video source has a fine resolution.

A2: Adjust the colors: enter Menu-Picture-Color Temperature, then select different modes and adjust the value accordingly.

A3: Reset the projector to manufacturer setting: enter Menu-System-Restore Factory Default to reset.

[Image]Q: How can I do if there is line/blurry screen in the projection picture?

A1: Please restart it to see if it can be solved. The line/blurry screen is caused by the motherboard or screen. If you can't solved it, please contact our customer service team for help.

[Remote Control]Q: How can I do if the remote is unresponsive?

A1: Make sure the batteries are installed correctly and the power is enough.

A2: Please make sure the IR receiver is not covered.

A3: Contact our customer service team for a replacement.

[Setting]Q: How can I change the language?

A1: Press the "Menu" on remote to enter the System Setting. Enter "OSD Language"

[Display]Q: How should I do if there are small dots on display?

A1: Tap the projector slightly to shake off the dust which may be caused during installing or shipping.

A2: Clean the lens with clean non-woven fabrics. Try cleaning the projector. When cleaning the projector, you can dip it in alcohol.

[Damage]Q: How should I do if there is expanding dark spot or smoke when using the projector?

A1: Check if the fan noise increases or the fan stops working. Unplug the projector and contact our customer service team for assistance.

A2: Make sure the outlet and projector power adapter are not wet or humid which will cause sparks or smoke on outlet when power on the projector.

[Shut Off]Q: Why does the projector is shut off during playing?

A1: Make sure the power plug is working and firmly fitted into the outlet.

A2: If the fan doesn't work when using it, please contact our customer service team for assistance.

A3: Overheat on the projector will activate built-in power-off protection panel. Restart the projector when it gets cooler.

[3D]Q: Can this projector support 3D effect?

A1: The projector supports 3D video source, and 3D viewing performance is achievable with Red-Blue 3D Glasses; but please understand the experience will not be better than in the theater and we do not recommend it if you have a higher expectation about 3D effect.

[USB]Q: Why doesn't anything work in the main interface especially with external storage connected?

A1: Correct Input Source must be selected when you use the USB disk, otherwise no signal will be shown on the screen.

[Lamp]Q: Why doesn't the projector's lamp light up or power on?

A1: Please contact our customer service team for further help.

[Connection]Q: The projector ports is insensitive?

A1: Try to replace the cable. If it still can't be solved, please contact our customer service team for help.

[Wifi Connection]Q: When the projector opens the same screen mirror interface, no signal blue screen is displayed, and WiFi does not display?

A1: Attempt to power off and restart whether to recover.

[MAC]Q: No sound from the MAC connected projector?

A1: Select apple menu > system preferences, and then click sound. In the output panel, make sure your input is correct selected.

A2: If you use the minidisplayport converter to connect, make sure your Mac can connect via mini DisplayPort to send audio.

A3: If you are connecting from the Mac mini, unplug any audio device that is connected to the computer audio output port.

[Screen Mirroring]Q: Video cannot be mirrored to the projector? Or is there sound or picture in the mirror image? No picture, no sound?

A1: Copyrighted video cannot be mirrored on the same screen, for example (prime, Hulu, Netflix, Disney +).

A2: Is the source resolution too high (For example H.264 or 4k)? You can try to switch the video refresh rate to 30Hz or 60Hz. and the video source cannot exceed 3840*2160.

PS: (prime, Hulu, Netflix, Disney +) streaming media with copyright can try to play the same screen on the web page.

[Screen Mirroring]Q: Screen mirror jam, frame drop, delay, automatic disconnection?

A1: The smoothness of the screen image is related to the quality of the network.

[Screen Mirroring]Q: Screen mirroring can't connect to the network?

A1: The router at home is fully connected (sometimes the connection of our mobile phones is unsuccessful, and the router itself limits the number of connected devices).

A2: The password entered is incorrect (check the password).

A3: The machine is too far from the router device.

A4: If the WiFi of the machine fails, turn it off and start it for test, or restore the factory setting once.

[Mounting]Q: What kind of screws do I need for mounting this projector?

A1: 1/4inch