

TDS8

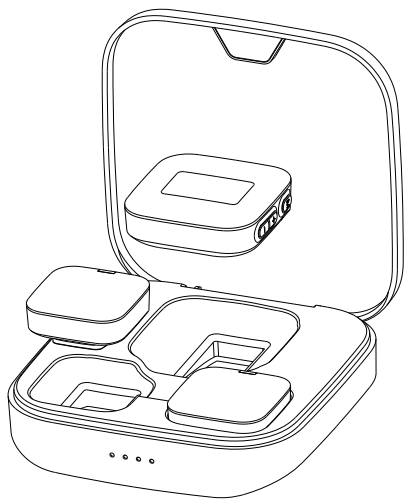

Dual Channel Wireless Microphone System User Guide

1

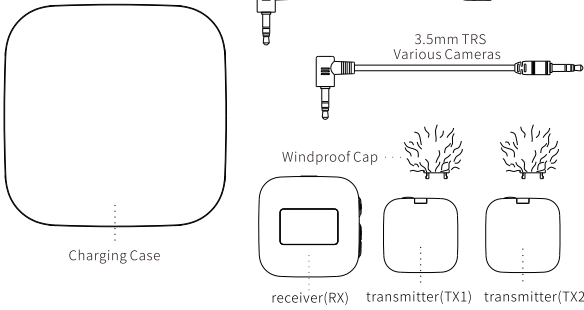

2

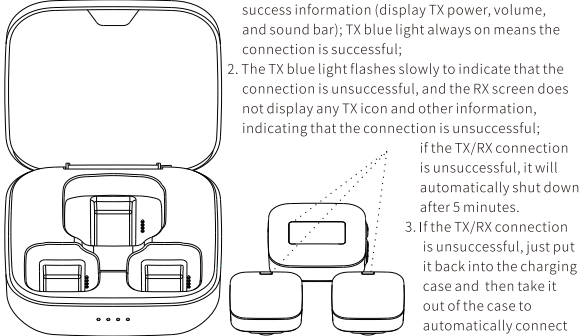

1. The TX/RX will automatically start up and connect automatically when it is out of the charging case; the RX screen will display the TX connection success information (display TX power, volume, and sound bar); TX blue light always on means the connection is successful.
2. The TX blue light flashes slowly to indicate that the connection is unsuccessful, and the RX screen does not display any TX icon and other information, indicating that the connection is unsuccessful.
3. If the TX/RX connection is unsuccessful, it will automatically shut down after 5 minutes.
3. If the TX/RX connection is unsuccessful, just put it back into the charging case and then take it out of the case to automatically connect

3

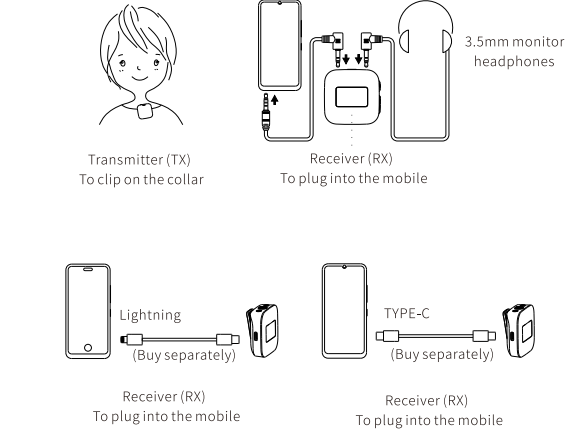

4

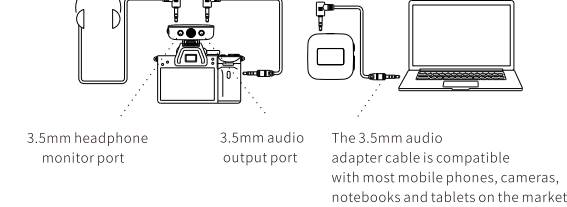

5

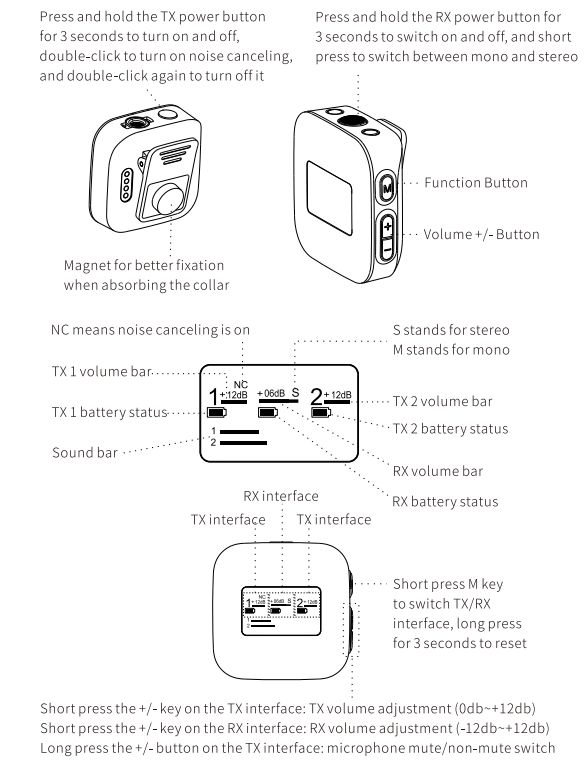

6

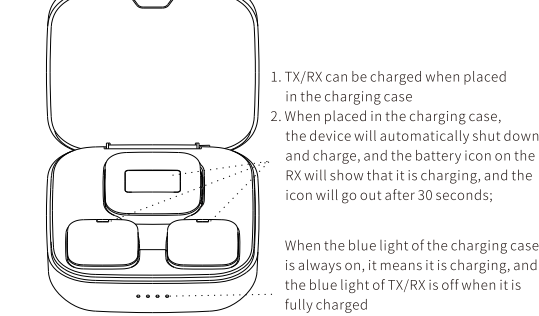

7

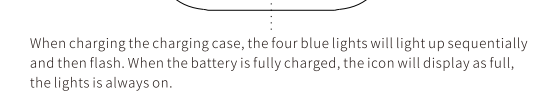

8

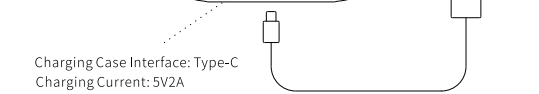

Product Parameters

Wireless Transmission Mode:	2.4GHz adaptive frequency hopping
Transmission Range:	150m
Polar Pattern:	Omnidirectional
Microphone Sensitivity:	-38dB±1dB(1dB=1V/Pa@1KHz)
Microphone Distortion:	<0.1%
Microphone Sample Rate:	48KHz
Frequency Response:	20Hz~20KHz
Product Dimensions:	TX:37*31*372.5mm RX:50.9*50*24.5mm Charging Case:110.6*110.6*33.7mm
Net Weight:	TX:20.3g RX:38.4g Charging Case:186.5g
Battery Capacity:	TX:250mAh RX:600mAh Charging Case:3000mAh
Working Current:	TX:25mA RX:60mA
Operating Time:	TX>About 9.5 hours, RX>About 9.5 hours
Charging Time:	Charging TX and RX 2 times at the same time TX>About 1 hour RX>About 1.5hour Charging Case>About 2 hours

Safety Guidelines

1. Keep out of reach of children when charging
2. Store this product away from dust, do not store it in a humid environment for a long time
3. When idle for a long time, it is recommended to charge the battery once a month to avoid reducing battery life due to long-term storage
4. Do not throw this product to avoid falling damage, do not suffer from water droplets, or place it in a container with liquid
5. Do not use sharp objects to scratch or expose to the sun, and do not approach exposed fire sources

Warranty Card

User/Organization name: _____

Contact: _____ Tel: _____

Order Number: _____

Purchase Date: _____

Date	After-sales Record	Recipient

QUALIFIED CERTIFICATE	
Product Name:	Dual Channel
Wireless Microphone System	
Model Name:	Inspector:
TDS8	QC PASS 06
DATE:	

Product list: charging box*1, receiver*1, transmitter*2, Transfer line*2, Magnets*2
windproof cap*2, charging cable*1, storage bag*1, manual*1

The schematic diagram used in this manual is for reference only, the actual product may be different from it, and the actual product in the package shall prevail

FCC Statement

This equipment has been tested and found to comply with the limits for a Class B digital device, pursuant to part 15 of the FCC Rules. These limits are designed to provide reasonable protection against harmful interference in a residential installation. This equipment generates, uses and can radiate radio frequency energy and, if not installed and used in accordance with the instructions, may cause harmful interference to radio communications. However, there is no guarantee that interference will not occur in a particular installation. If this equipment does cause harmful interference to radio or television reception, which can be determined by turning the equipment off and on, the user is encouraged to try to correct the interference by one or more of the following measures:

- Reorient or relocate the receiving antenna.
- Increase the separation between the equipment and receiver.
- Connect the equipment into an outlet on a circuit different from that to which the receiver is connected.
- Consult the dealer or an experienced radio/TV technician for help.

Caution: Any changes or modifications to this device not explicitly approved by manufacturer could void your authority to operate this equipment.

This device complies with part 15 of the FCC Rules. Operation is subject to the following two conditions: (1) This device may not cause harmful interference, and (2) this device must accept any interference received, including interference that may cause undesired operation.

RF Exposure Information

The device has been evaluated to meet general RF exposure requirement. The device can be used in portable exposure condition without restriction.