

WG11-6 Instruction

1. Product Overview

Product Name: Wireless Charger

Product Model No.: WG11-6

Used Location: used on the furniture (sofa or chair etc.)

2. Environment requirement

Operation temperature: $-10^{\circ}\text{C} \sim +45^{\circ}\text{C}$.

Storage temperature: $-10^{\circ}\text{C} \sim 55^{\circ}\text{C}$.

Operating Humidity: 10%~80%RH, non-condensing.

Storage Humidity: 10%~85%RH, non-condensing.

3. Directions for Operation

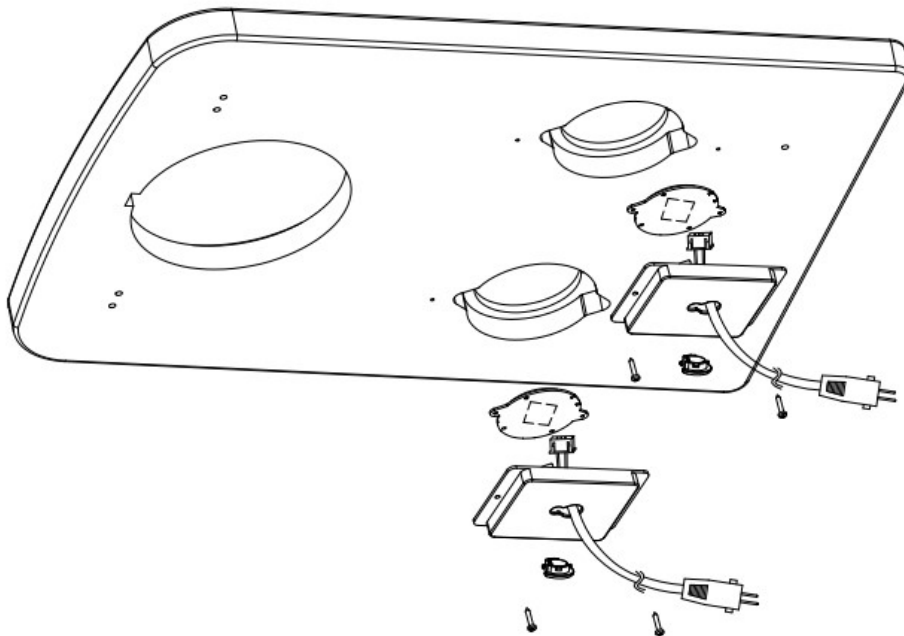

- Input rating: DC 29V
- Working Frequency: 110K-200K
- Max wireless output rating: 30W
- Charging distance: 3-8mm

- 3.1 Please connect with the power supply.
- 3.2 Put the charging equipment on the wireless charger label indicating area.
- 3.3 When the charging equipment complete, can be taken away.
- 3.4 In the processing of charging can be free to pick up, answer the phone, freeing discharge or charge.

4. Matters needing attention:

- 4.1 The function will only work normally in proper working power conditions.
- 4.2 If problems are identified, they must be treated by professional personnel.
- 4.3 Please connect with power supply(input 100-240V AC, output 29VDC)

Please take attention that changes or modification not expressly approved by the party responsible for compliance could void the user's authority to operate the equipment.

This device complies with Part 15 of the FCC Rules. Operation is subject to the following two conditions:

- (1) This device may not cause harmful interference, and
- (2) This device must accept any interference received, including interference that may cause undesired operation.