

BH01

USER MANUAL

Thanks for choosing langsdm product

LANGSDOM

AIRNOVA

We appreciate you for purchasing the Langsdom AirNova Smart Sports Audio Sunglasses, the following instructions will guide you to use it easily.

Wearing

Please place the sunglasses on the auricle, rotate it and adjust it to the best angle to ensure that it is comfortable and stable.

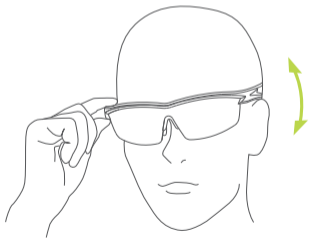

Adjustable Nasal Pad

Use your hand to gently adjust the nasal pad to the right angle and height.

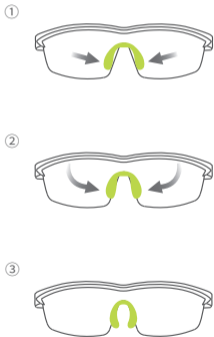

Accessories



Audio Sunglasses*1



User Manual*1



Charging Cable*1



Glasses Case*1



Glasses Cloth*1



Storage Bag*1

* If there is any missing or damaged content in the above diagram, please contact the distributor.

* It is recommended that new device be fully charged before use.

Diagram

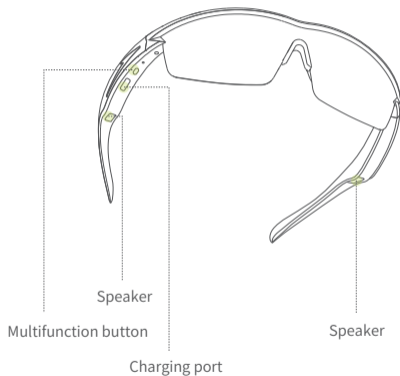

Manually On/Off

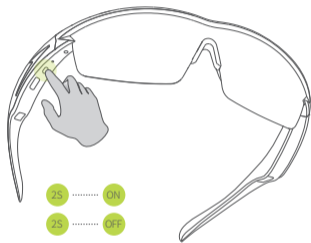

1. In the off state, long press the multifunction button for about 2 seconds to turn on the glasses.
2. In the startup state, long press the multifunction button for about 2 seconds to turn off the glasses.

Pairing

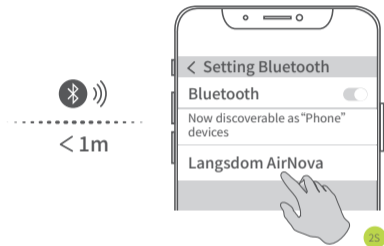

When pairing for the first time, the distance between the Bluetooth glasses and the phone is controlled within 1 meter, long press the button for about 2 seconds to turn on, and the red and blue lights of the indicator flash alternately, to enter the pairing state. In the phone Bluetooth list, select “Langsdom AirNova” and pair the Bluetooth glasses with the phone connection.

Factory Setting

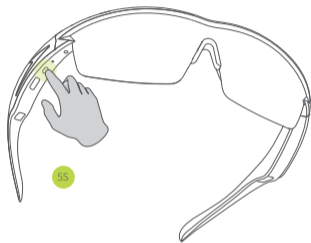

When the Bluetooth glasses are off, long press the glasses multi-function button for 5 seconds to clear the Bluetooth pairing record, long press the glasses multi-function button for 2 seconds and 5 seconds to let go, there will be a power-on prompt, and the Bluetooth glasses can be re-paired after reset.

Extended Link

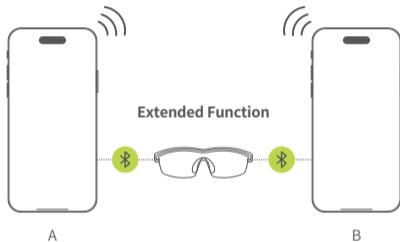

1. Disconnect the headphone from device A after it connected.
2. Turn on the Bluetooth of device B, search for “Langsdorn AirNova” and select to connect.
3. Turn on the Bluetooth of device A and select “Langsdorn AirNova” to connect.

Button Operation

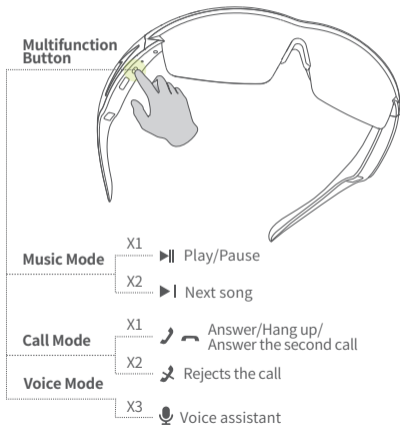

Charging

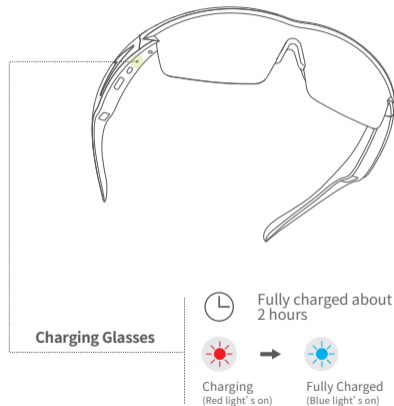

Warning

1. Don't undress with glasses on, so as not to scratch the skin or twist the glasses.
2. When wearing or removing glasses, please grab the mirror foot with both hands facing outwards and remove, if you buy one hand to remove, it is easy to cause deformation of glasses.
3. If the frame is distorted and cannot be worn normally, resulting in a feeling of weight on the nose and ears, please contact the dealer in time.
4. If the screw is loose or deformed, the lens may fall off, please stop using it and do not disassemble it by yourself, and contact the dealer in time.
5. Please use the special lens cloth attached with the box to wipe the lens and frame. When you are not using the glasses, please put the glasses into the box, so as not to damage the glasses by uncertain external forces.
6. Don't place the glasses in a high heat and high humidity environment to avoid damage to the lens.
7. Don't touch organic solvents and alkaline liquids, do not soak the glasses in water for a long time.

Service

1. Please contact us if any problems, we will provide you professional service.
2. Warranty is only covered by the first year of purchase. Free repair service if the failure is caused by product quality.
3. Please provide the product warranty card and the corresponding order number so that we can better solve the problem for you.

Product Parameters

Model: BH01

Frame material: TR90

Lens material: TAC polarized sun lens

Bluetooth version: V5.3

Play time: About 10 hours

Battery capacity: 120mAh

Charging mode: Type-C

Charging time: About 2 hours

RoHS Testing

Parts	Hazardous Substance					
	(Pb)	(Hg)	(Cd)	(Cr ⁶⁺)	(PBB)	(PBDE)
Speaker	○	○	○	○	○	○
Battery	○	○	○	○	○	○
Plastic	○	○	○	○	○	○
PCB	○	○	○	○	○	○
Others	○	○	○	○	○	○

○: Hazardous substance contained in all homogeneous materials of this part is below the limit requirement.
×: Hazardous substance contained in homogeneous materials of this part is above the limit requirement.

Certificate Of Quality

Product Model _____

Product Type _____

Executive Standard Q/LSD 001-2021

Inspection Date _____

Inspector _____

Test _____



Name:	Address:
Purchase Date:	Telephone:
Product Model:	Product Number:
Warranty Content:	Warranty Date:
Faults&Treatment Methods:	

Warranty Service

Warranty Policy

One year warranty service .Provide free repair service if the failure is caused by such quality issues as caused by product.

Non-Warranty Situation

1. The warranty date is expired.
2. No valid warranty card or invoice or information doesn't match.
3. Appearance and internal damage caused by human factors.
4. The breakdown and damage caused by the force majeure.
5. The breakdown caused by the manipulation that hasn't follow the requests of the manual.
6. Failure or damage caused by forced use of this product beyond normal use conditions.
7. The damage caused by the dismantle movement of a non-our-company authorized maintainer.
8. Malicious damage and tampering with the warranty part of the manual or product information.
9. The breakdown and damage doesn't caused by such as design,manufacturing and quality of the product.

*Langsdom has reserved the right of final explanation of the warranty terms.

FCC warning

FCC ID: 2AZDD-AIRNOVA

Any Changes or modifications not expressly approved by the party responsible for compliance could void the user's authority to operate the equipment.

Note: This equipment has been tested and found to comply with the limits for a Class B digital device, pursuant to part 15 of the FCC Rules. Operation is subject to the following two conditions:

- (1) This device may not cause harmful interference, and
- (2) this device must accept any interference received, including interference that may cause undesired operation.

These limits are designed to provide reasonable protection against harmful interference in a residential installation. This equipment generates uses and can radiate radio frequency energy and, if not installed and used in accordance with the instructions, may cause harmful interference to radio communications. However, there is no guarantee that interference will not occur in a particular installation. If this equipment does cause harmful interference to radio or television reception, which can be determined by turning the equipment off and on, the user is encouraged to try to correct the interference by one or more of the following measures:

- Reorient or relocate the receiving antenna.
- Increase the separation between the equipment and receiver.
- Connect the equipment into an outlet on a circuit different from that to which the receiver is connected.
- Consult the dealer or an experienced radio/TV technician for help.

The device has been evaluated to meet general RF exposure requirement. The device can be used in portable exposure condition without restriction.