

Smart Watch User Manual

things prepare

When taking care of your bracelet, please remember the following tips:

- Clean the bracelet regularly, especially the inside of the bracelet, to keep it dry.
- Adjust the tightness of the bracelet to ensure air circulation.
- It is not advisable to use excessive skin care products on the wrist with the bracelet.
- If you experience skin irritation or discomfort, please stop wearing it.

Boot up

Long press the side button for 3 seconds or plug in the magnetic charging cable to charge and boot.

Recharge

Magnetic charging.



Bracelet APP download and binding

1. Download and install the APP

Use your mobile phone to scan the QR code and download the APP.

Scan QR code with mobile phone to download APP. For IOS system, select APP , storesearch Da Fit. Android system, select Google Play to download and install Da Fit.Or scan QR code to download



Da Fit

Note: your mobile phone must support Android 5.1 or IOS 8.0 or above, and Bluetooth 4.0 or above.

2. Bind smart bracelet with APP

1. Click on "Add Device" to bind the smart bracelet.
2. Click on your device in the device list scanned.
3. The IOS system will show a Bluetooth pairing request and you can click on Bluetooth "Pairing" to confirm. Connect it directly to Androidsystem.
4. Successfully bound.

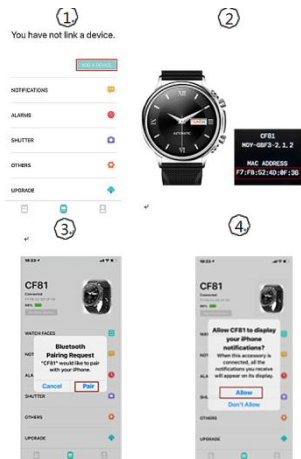

This device complies with Part 15 of the FCC Rules. Operation is subject to the following two conditions: (1) this device may not cause harmful interference, and (2) this device must accept any interference received, including interference that may cause undesired operation

NOTE: This equipment has been tested and found to comply with the limits for a Class B digital device, pursuant to Part 15 of the FCC Rules. These limits are designed to provide reasonable protection against harmful interference in a residential installation. This equipment generates, uses and can radiate radio frequency energy and, if not installed and used in accordance with the instructions, may cause harmful interference to radio communications. However, there is no guarantee that

interference will not occur in a particular installation.

If this equipment does cause harmful interference to radio or television reception, which can be determined by turning the equipment off and on, the user is encouraged to try to correct the interference by one or more of the following measures:

- Reorient or relocate the receiving antenna.
- Increase the separation between the equipment and receiver.
- Connect the equipment into an outlet on a circuit different from that to which the receiver is connected.
- Consult the dealer or an experienced radio/TV technician for help.

Warning: changes or modifications not expressly approved by the party responsible for compliance could void the user's authority to operate the equipment

The device has been evaluated to meet general RF exposure requirement, the device can be used in portable exposure condition without restriction

Brief introduction of bracelet function

Power-on state:

Switch the main screen menu interface, such as the interface shown below;



Key Function

Press the up button to return to the main interface, press and hold for 3 seconds to enter the multi-sports mode, and press the main function button down

Unbind

Android phones can be disconnected from the phone by simply clicking Remove Device.

After IOS removes the device, the Bluetooth of the mobile phone needs to be ignored.

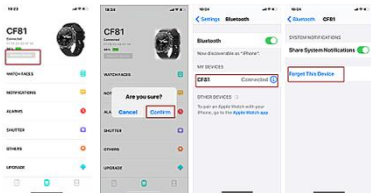

common problem

1. Why does the bracelet automatically disconnect the Bluetooth connection after the screen of the Android phone is off?

1>. Lock the background APP.

After the Da Fit process is cleared, it will cause the bracelet to be disconnected from the phone.

2>Set the APP to start automatically.

3>Unlimited background operation.

The Android mobile phone installs the APP, and the default is to intelligently restrict the background operation, and you need to manually set the APP without taking any restrictive measures.

2. Why can't the bracelet receive push notifications?

1>. Confirm that the message push switch is turned on on the mobile client.

2>. The confirmation message can be displayed normally in the notification bar of the mobile phone. The bracelet message push is pushed by reading the message in the mobile notification bar; if there is no message displayed in the mobile notification bar, the bracelet will not be able to receive the push.

(You need to find the notification settings in the phone settings, turn on WeChat, QQ, phone, SMS, The notification switch of the mobile client).

3> Open the phone --- Settings, the top search box, enter "notification usage rights", and re-open Da Fit.

3. Why can't I wear a wristband to take a hot bath?

Answer: The temperature of the bath water is relatively high, it will

produce a lot of water vapor, and the water vapor is in the gas phase, and its molecular radius is small, and it is easy to infiltrate from the gap of the shell of the bracelet. When the temperature drops, it will condense into liquid again.

Phase droplets can easily cause a short circuit in the internal circuit of the bracelet, damage the circuit board of the bracelet, and then damage the bracelet.



警告:

Please consult your doctor before starting a new exercise. Although the smart bracelet can monitor real-time dynamic heart rate, it cannot be used for any medical purposes.