

User Manual



Smart Switch 3Way

Features



WIFI Connection



Mechanical ON/OFF Switch

Product Introduction

- Excellent design and high-quality materials to ensure long-term stable and reliable service to users
- Wi-Fi connection has the most applicability, and has access to multiple platforms
- Silent mechanical push button design provide the user's best feedback

Specification

| | |
|------------------|--------------------------|
| Input Power: | 100~240V AC 50~60Hz |
| Control: | Relay |
| Communication: | WIFI 802.11 b/g/n 2.4GHz |
| Control Channel: | 1 CH |
| Max Current: | 15A |
| Standby Power: | ≤0.5W |
| Button Life: | 500K times |
| Dimension: | 105*45*42.5mm |

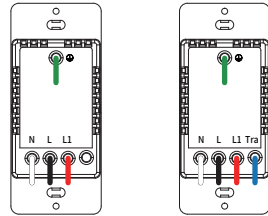
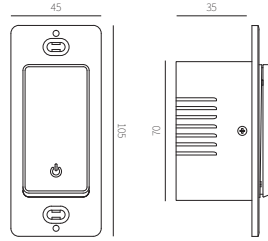

Normal

3 Way

Installation

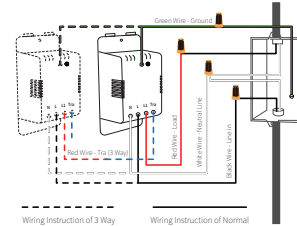

Black Wire - Line In
Red Wire - Load
White Wire - Neutral Line
Green Wire - Ground
Blue Wire - Tra (3 Way)

1. Disconnect power by circuit breaker
2. Check the Line with voltage tester pen, make sure the power is off to prevent electric shock
3. Follow the wiring instructions, connect the dimmer wires to each other leads and check for short circuits
4. Screw the dimmer into the back box
5. Mounting switch cover plate
6. Connect circuit breaker restore power

Connection & Operation

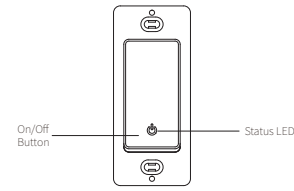

1. Once connect power correctly, the Green led on the bottom of switch will turn on, switch is ready to serve
2. Push on/off button to turn on/off the light

Reset the product:
Press and hold ON/OFF button for 5 seconds then release, Green power indicator will flash, switch get into setup mode, please follow setup instruction to complete setup to start smart function

APP Operation

1. Scan QR code and download the app iOS or Android version



2. Register and log in
The user needs to register by mobile phone number. After registration, you can use this username to log in the APP and proceed to the next step.
*Support some third-party accounts log in directly.

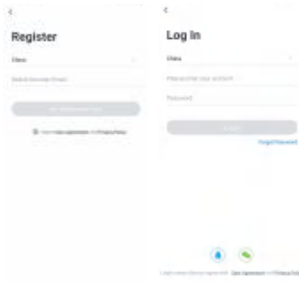

APP Operation

3. Add Devices
After the user login, click the "+" icon in the upper right corner of the main page to enter the add device interface, select the "Switch" menu and click the switch device icon

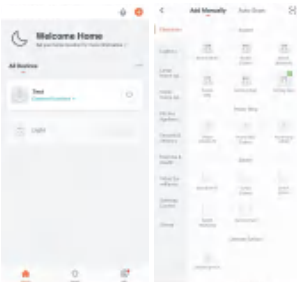

APP Operation

4. Add Devices
To ensure that the new switch power LED is flashing, select the Wi-Fi and enter the password then click Next.

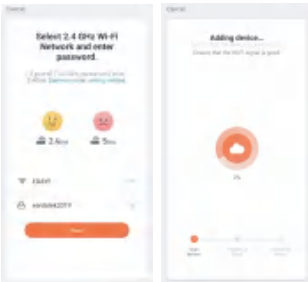

APP Operation

5. Add Devices
Wait system to search the device, connect and configure the device will takes up to 3min.
Once the device configure successfully, please also input preferred name and select location.

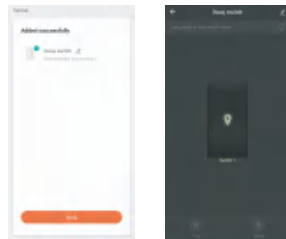

- Remark:
1. Smart phone and device must connect to same Wi-Fi during setup mode
 2. The device must be added to the account before it can be controlled remotely
 3. After the device is successfully accessed, other users can obtain control of the product through the sharing function.
- Troubleshooting
1. Can not connect to Wi-Fi router
 - a) Also make sure you have good Wi-Fi signal strength at the location of the switch
 - b) Metal box and metal surface - wall board may block Wi-Fi signal
 - c) Make sure input correct Wi-Fi password
 - d) The switch only support 802.11 b/g/n 2.4GHz Wi-Fi signal, 5GHz NOT support

APP Operation

6. Control switch with APP



7. Add timer mode in the APP



APP Operation

8. All added devices can be viewed in the main menu of the APP

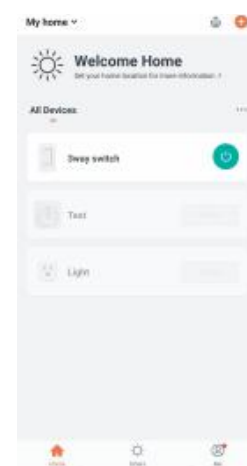

FCC Caution.

This device complies with part 15 of the FCC Rules. Operation is subject to the following two conditions: (1) This device may not cause harmful interference, and (2) this device must accept any interference received, including interference that may cause undesired operation.

§ 15.21 Information to user.
Any Changes or modifications not expressly approved by the party responsible for compliance could void the user's authority to operate the equipment.

§ 15.105 Information to the user.
Note: This equipment has been tested and found to comply with the limits for a Class B digital device, pursuant to part 15 of the FCC Rules. These limits are designed to provide reasonable protection against harmful interference in a residential installation. This equipment generates uses and can radiate radio frequency energy and, if not installed and used in accordance with the instructions, may cause harmful interference to radio communications. However, there is no guarantee that interference will not occur in a particular installation. If this equipment does cause harmful interference to radio or television reception, which can be determined by turning the equipment off and on, the user is encouraged to try to correct the interference by one or more of the following measures:

- Reorient or relocate the receiving antenna.
- Increase the separation between the equipment and receiver.
- Connect the equipment into an outlet on a circuit different from that to which the receiver is connected.
- Consult the dealer or an experienced radio/TV technician for help.

This equipment complies with FCC radiation exposure limits set forth for an uncontrolled environment. This equipment should be installed and operated with minimum distance 20cm between the radiator and your body.

ISED Statement

- English: This device complies with Industry Canada license-exempt RSS standard(s). Operation is subject to the following two conditions: (1) This device may not cause interference, and (2) This device must accept any interference, including interference that may cause undesired operation of the device.

The digital apparatus complies with Canadian CAN ICES-3 (B)/NMB-3(B).

- French: Le présent appareil est conforme aux CNR d'Industrie Canada applicables aux appareils radio exempts de licence. L'exploitation est autorisée aux deux conditions suivantes: (1) l'appareil ne doit pas produire de brouillage, et (2) l'utilisateur de l'appareil doit accepter tout brouillage radioélectrique subi, même si le brouillage est susceptible d'en compromettre le fonctionnement. L'appareil numérique du CIEM conforme canadien peut - 3 (b) / nmb - 3 (b).

This device meets the exemption from the routine evaluation limits in section 2.5 of RSS 102 and compliance with RSS 102 RF exposure, users can obtain Canadian information on RF exposure and compliance.

cet appareil est conforme à l'exemption des limites d'évaluation courante dans la section 2.5 du cnr - 102 et conformité avec rss 102 de l'exposition aux rf, les utilisateurs peuvent obtenir des données canadiennes sur l'exposition aux champs rf et la conformité.

This equipment complies with Canada radiation exposure limits set forth for an uncontrolled environment.

This equipment should be installed and operated with minimum distance 20cm between the radiator & your body.

Cet équipement est conforme Canada limites d'exposition aux radiations dans un environnement non contrôlé.

Cet équipement doit être installé et utilisé à une distance minimale de 20 cm entre le radiateur et votre corps.