

## Belt Replacement

Belt Tensioner Block

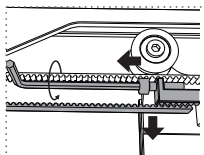

Loosen screws and push out belt

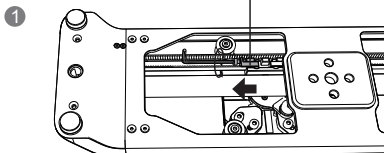
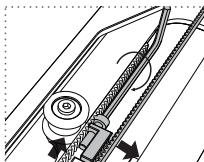
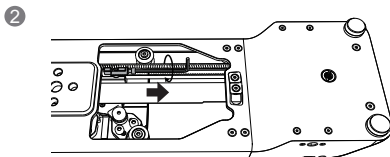

Loosen screws and push out belt

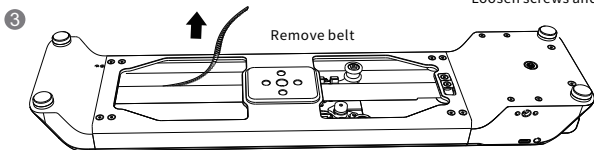

Remove belt

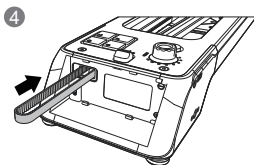

Insert spare belt through battery compartment

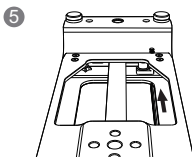

Synchronous Pulley

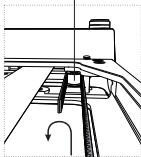

Route one end around synchronous pulley

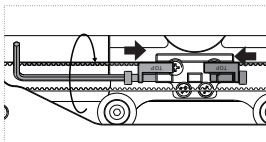
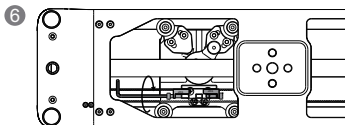

Insert both ends into tensioner block and tighten

## Usage Scenarios

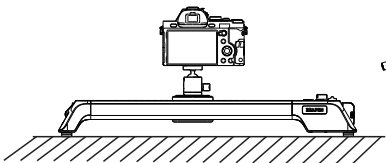

Flat Surface Mode

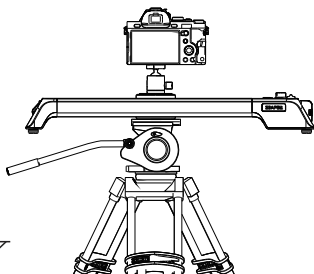

Tripod Mode

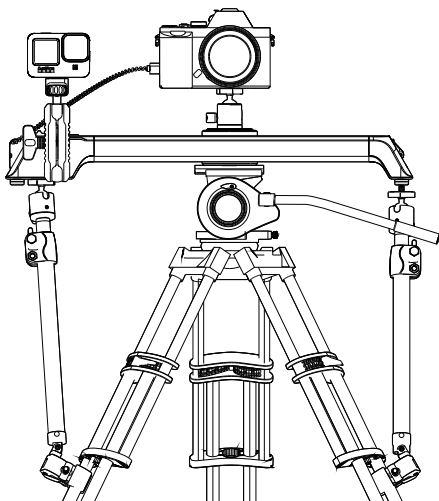

Extended Accessory Usage

## APP Download

Search "Zeapon Lab" in app stores or download from ZEAPON official website!

Official website: <https://zeapon.com>



## APP-Slider Connection

- 1 Long press slider power button to turn on
- 2 Open "Zeapon Lab" APP on phone

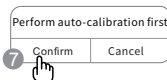
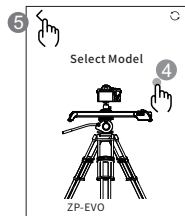
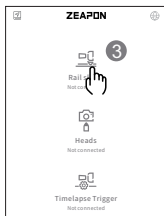

Slider will complete auto-calibration after clicking "Confirm"

## APP Interface Functions

### Battery Level Display

### Back to Device Selection

### Path Point Setting Area

Drag joystick to move slider to target position then click to set point

Selection box position is movement starting point  
Long press set point to delete

### Speed Adjustment Slider

Drag to adjust speed

Delete All Points

Time required to complete path

### Speed Input Box

Can input 0-100% speed value

Slider Control Joystick  
Drag to move slider

Loop Button

Start Button

Mode Selection Menu

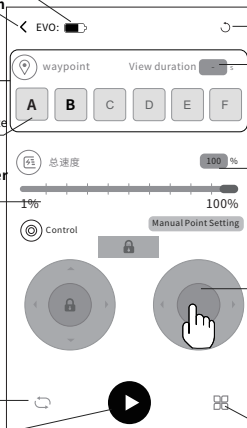

- Video Mode
- Smart Time-lapse
- Custom Time-lapse
- Stop Motion
- Panorama Mode
- Matrix Mode
- Camera Mode

## APP Point Setting After connecting APP to slider

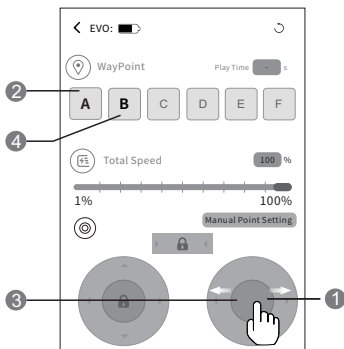

- 1 Drag joystick to move slider to any position
  - 2 Tap A to set point A
  - 3 Drag joystick to move slider to any position
  - 4 Tap B to set point B
- Repeat to set up to 6 points (A-F)

## APP Manual Point Setting

After connecting APP to slider

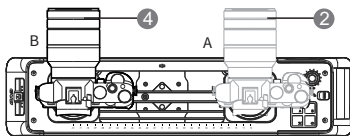
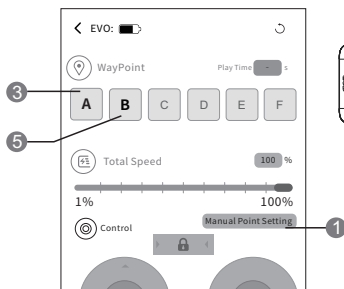

- 1 Click manual point setting
- 2 Drag slider to any position
- 3 Tap A to set point A
- 4 Drag slider to any position
- 5 Tap B to set point B

Repeat steps 2-5 to set up to 6 points (A-F)

## Cycle Mode

After setting path points, click "Loop" icon at bottom left to toggle



## Delete Path Points

Long press last point to delete it after setting

Click "↻" icon to delete all points



## Change Starting Point

Default starting point is last set point.  
Click A to move slider to A point,  
switching starting point

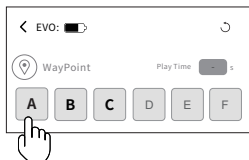

## Speed Adjustment

Input value or drag slider to adjust speed in real-time

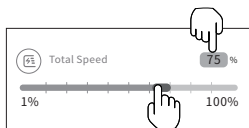

## Firmware Update

After connecting APP to slider

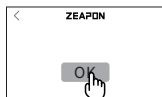
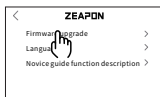

- 1 Click "⚙️" icon at top right
- 2 Select "Firmware Upgrade"
- 3 Choose device
- 4 Click "Confirm" and wait

## Video Mode



- 1 Set path points per "APP Point Setting/Manual Point Setting"
- 2 Click start button, slider moves from B to A

## Smart Time-lapse

Note: Must connect camera to slider via shutter cable

### Interface Notes

Note: Gray fields are auto-calculated, others can be manually input

Photos	50	Auto-calculated photo count
FPS	24	Fixed frame rate
Play Time	8	Auto-calculated video duration
Waiting time	h m s	Time required to capture all photos
Shutter time	0.5 s	Input camera shutter speed here
Noise Reduction	0.5 s	Enable when using camera's noise reduction
Interval time	1 s	Interval between photos
Speed	100 %	
Select a scene	Daily 1s   Cloudy 5s   Night Scene 3s	Recommended scene intervals

### Operation Steps

- 1 Set points per "APP Point Setting"
- 2 Input shutter speed
- 3 Set interval time
- 4 Click start button

Photos	50
FPS	24
Play Time	8 s
Waiting time	h m s
Shutter time	0.5 s
Noise Reduction	0.5 s
Interval time	1 s
Speed	100 %
Select a scene	Daily 1s   Cloudy 5s   Night Scene 3s

1% 100%

1 2 3 4

## Custom Time-lapse

Note: Must connect camera to slider via shutter cable

Note: Gray fields are auto-calculated, others can be manually input

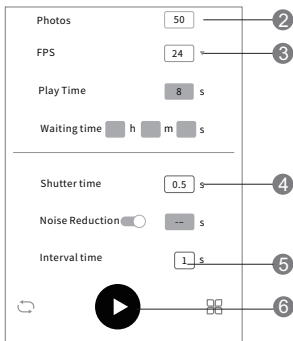

### Operation Steps

- 1 Set points per "APP Point Setting"
- 2 Input photo count
- 3 Select frame rate
- 4 Set shutter speed
- 5 Set interval time
- 6 Click start button

## Stop Motion

Note: Must connect camera to slider via shutter cable

Note: Gray fields are auto-calculated, others can be manually input

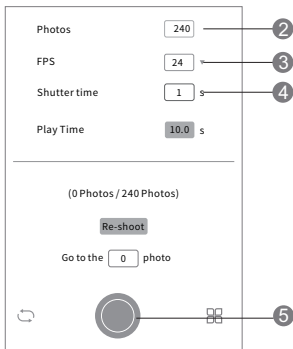

### Operation Steps

- 1 Set points per "APP Point Setting"
- 2 Input photo count
- 3 Select frame rate
- 4 Set shutter speed
- 5 Click capture start button

For more APP functions and shooting modes, please refer to official tutorial

## Product Specifications

Model	FPE1	FPE2
Horizontal Load Capacity	≤5KG	≤5KG
Vertical Load Capacity	≤2.5KG	≤2.5KG
Minimum Speed	0.5mm/s	0.5mm/s
Maximum Speed	57mm/s	57mm/s
Maximum Orbital Angle	55°	55°
Lens Center Travel	240mm	440mm
Battery Voltage	DC 7.2V-8.4V	DC 7.2V-8.4V
USB-C Input	5V~12V	5V~12V
Operating Power	15W	15W

## Important Notes

All components of this slider have been pre-adjusted to optimal tightness and smoothness. Do not disassemble as it may be difficult to restore to original condition, causing slider looseness and affecting performance.

The slider shown in this manual is: FPE1

Tripod, head, quick release plate, support arms, battery, shutter cable and other accessories shown are not included in this package, for demonstration only.

Search "Zeapon Lab" in app stores or download from ZEAPON official website!

Official website: <https://zeapon.com>



Download App from Zeapon web





This device complies with part 15 of the FCC Rules. Operation is subject to the following two conditions: (1) This device may not cause harmful interference, and (2) this device must accept any interference received, including interference that may cause undesired operation.

Any Changes or modifications not expressly approved by the party responsible for compliance could void the user's authority to operate the equipment.

**Note:** This equipment has been tested and found to comply with the limits for a Class B digital device, pursuant to part 15 of the FCC Rules. These limits are designed to provide reasonable protection against harmful interference in a residential installation. This equipment generates uses and can radiate radio frequency energy and, if not installed and used in accordance with the instructions, may cause harmful interference to radio communications. However, there is no guarantee that interference will not occur in a particular installation. If this equipment does cause harmful interference to radio or television reception, which can be determined by turning the equipment off and on, the user is encouraged to try to correct the interference by one or more of the following measures:

- Reorient or relocate the receiving antenna.
- Increase the separation between the equipment and receiver.
- Connect the equipment into an outlet on a circuit different from that to which the receiver is connected.
- Consult the dealer or an experienced radio/TV technician for help.

#### FCC Radiation Exposure statement

The device has been evaluatec to meel general RF exposure requirement. The device can be used in portable exposure condition without restriction.