



USER GUIDE

Bluetooth Smart Finder with Motion Alert

Lost it? Find it in seconds

Mappos Limited
Kemp House 160 City Road London EC1V 2NX
Made in China www.mappos.com

STEP 1: _____
Please download the App "mappos" from App Store or Google Play.



Compatible devices:
For Apple iPhone 4S, iPhone 5/5S, iPhone 6/6S/6P, iPhone 7, iPhone 8, iPhone X and newer with iOS 8.0 and higher.

For Android: Samsung S3/S4/S5/S6/S7/S8, Samsung Note 3/4/5/6/7/8, Huawei P7/P8/P9/P10, VIVO, OPPO and others with Android 4.3 or newer and BLE 4.0 supported.



STEP 2: _____
Turn on Bluetooth.
Make sure your phone Bluetooth is on.

STEP 3: _____
Sign up for New User.
Start "mappos" App and tap the "Sign Up".

STEP 4: _____
Pair the mappos to your phone.
1). Make sure you turn on your phone's Bluetooth
2). Hold the mappos finder close to your phone.
3). Hold the button on the mappos until you hear a beep and the LED starts flashing.

Find My Phone via mappos: _____
When mappos is connected to your phone, hold the mappos button and your phone will make a sound alert.



Find mappos via Phone : _____
When mappos is connected to your phone, open the mappos App and tap the "ring" icon on the App; the mappos will beep and the LED will flash.



Motion Alert and History: _____
When this option is on, the finder and phone will sound an alert when the finder is moved. They will alert once in every 90 seconds to avoid continuous disturbance.

You can get the recent movement history when the finder is connected to the phone.

Separation Alarm: _____
When the phone and mappos are out of range, both phone and mappos will make a sound alert.
Phone Alert: The phone will make a sound alarm if it's on.
mappos Alert: The mappos will make a sound alarm if it's on.

Last Seen location: _____
The App will record the last disconnection location on the map.

Mark as Lost: _____
If you have lost your item, our mappos network may help you to find it.

When the mappos is "mark as lost", the mappos will broadcast a beacon signal.
When another mappos user passes by and scans the beacon signal, the GPS location will be sent to you.
The more users pass by, the easier to it is to find.

Know the mappos: _____
1) Strap hole
2) Button to pair with your phone, wake up finder or take photos
3) Notch to open finder
4) LED

Battery replacement: _____
Use the included pick to open finder at the notch.
Replace old battery with a new one. Press cover closed.
Re-pair finder with phone.

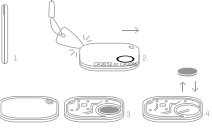

Camera Remote: _____
The button on the mappos also doubles as a camera remote. Never be left out of a group picture again.



Trouble Shooting: _____		
Issue	Cause	Solution
I'm asked to enter a PIN when trying to pair with my phone.	You're trying to pair mappos via your phone's bluetooth settings.	Pair mappos with your phone using the mappos App instead ("+" symbol in the top right corner).
I can't pair mappos with my phone.	Bluetooth is off.	Turn on Bluetooth in the phone setting.
	mappos is too far away from the phone.	Place mappos close to your phone while pairing until you hear a beep.
	mappos battery is empty.	Replace the battery.
The battery lasts only a few days.	mappos control module is faulty.	Replace the battery. If you have the same issue with a new battery, please contact us.
mappos location does not appear on the map	GPS is turned off or the mappos App cannot access GPS.	Activate GPS and make sure the mappos App can access your phone's GPS.
My phone battery drains too fast.	This is a rare issue that may occur with some phones and is related to the power consumption of GPS module or other components.	Only activate GPS or Bluetooth when you actually need it, i.e., when you're looking for your mappos.

Battery Safety Notes: _____
WARNING! ⚠️ Fire Hazard! Do not short-circuit batteries. Batteries may overheat or explode.
WARNING! ⚠️ Danger to life. Keep batteries out of the reach of pets and children. If swallowed, seek medical advice immediately.
WARNING! ⚠️ Do not expose batteries to water or fire. Do not attempt to charge non-rechargeable batteries. The batteries may explode.

Disposal: _____
The packaging is made of eco-friendly, recyclable material.
Please ask your local authorities about appropriate methods of disposal. Defective or empty batteries must be recycled in accordance with Directive 2006/66/EC. Return batteries and/or the device to the designated collection facility. Batteries contain toxic substances that must be treated separately from domestic waste.

IP Rating Notes: _____
The devices are rated to be splash proof only. Do not immerse the device in water to avoid irreparable damage.

Warranty Provisions: _____
The device has been manufactured and thoroughly tested to meet strict quality standards. The warranty covers defects in the material and manufacturing process. It does not cover product components that are subject to normal wear and tear (wear parts), or damage to fragile components such as switches, batteries or the casing. Consumer-inflicted damage, improper use, or incorrect maintenance of the product will void the warranty. Follow the instructions in the user guide to ensure proper use of the device. Refrain from using the device in ways that are advised against or warned of in the user guide. Improper use, excessive force or modifications made by unauthorised service providers will void the warranty. The repair or replacement of a defective device will not renew the warranty period.

Warranty Period: _____
Should you experience a fault or manufacturing defect within 1 year of the date of purchase, we will repair or replace the product free of charge. Consumer-inflicted damage, improper use or incorrect maintenance of product will void the warranty. Please keep the original packaging. This document is required as a proof of purchase.

FCC Statement: _____
This equipment has been tested and found to comply within the limits for a Class B digital device pursuant to part 15 of the FCC Rules. These limits are designed to provide reasonable protection against harmful interference in a residential installation. This equipment generates, uses, and can radiate radio frequency energy and, if not installed in accordance with the instructions, may cause harmful interference to radio communications. However, there is no guarantee that interference will not occur in a particular installation.
Caution: Any changes or modifications to this device not explicitly approved by the manufacturer could void your authority to operate this equipment. This device complies with part 15 of the FCC Rules. Operation is subject to the following two conditions: (1) This device may not cause harmful interference, and (2) this device must accept any interference received, including interference that may cause undesired operation.
The device has been evaluated to meet general RF exposure requirement. The device can be used in portable exposure condition without restriction.

