

料号：1405000128
品名：B端通用说明书
尺寸：105*120mm
材质：80g双胶纸
折叠方式：风琴折
备注：1PC/台

Mini PC

用户手册

User Manual

用户指南

尊敬的用户：感谢您使用本产品。为了您的安全和利益，请在使用产品之前仔细阅读本产品手册及随机附带的全部资料！

免责声明：

- 请务必使用原装电源，对于任何第三方适配器引起的问题或故障，本公司不承担任何责任。
- 用户可以使用第三方提供的音乐、视频、图片和软件，但对于版权问题或软件故障，我们不承担任何责任。
- 如果出现故障，我们将严格遵守保修条款，但是在使用过程中可能造成财产损失或经济损失，我们将不承担任何责任。
- 设备随出厂时内置的软件，可以在实际测试后使用。但是，如果在寻找兼容性或其它问题时删除或不删除，不会对机器造成任何影响。请注意，不是产品质量问题。
- 公司保留对产品进行改进的权利，产品规格和设计如有变更，恕不另行通知！请以实物为准。
- 请勿自行拆解产品，非因产品自身质量问题而由外部物理损害或化学损害导致产品质量受损的，本公司不承担任何赔偿责任。

注意事项：

- 在执行可能造成文件破坏或丢失的操作时，一定要格外小心。
- 迷你主机使用过程中，要注意对病毒的防护，尽量使用病毒防火墙。
- 如果长时间不使用迷你主机，请将主机关机，并断开电源。
- 不可短时间频繁开、关迷你主机，两次开机时间建议至少间隔10秒以上，最好不少于60秒。
- 注意防潮，体质使用环境的清洁卫生，若主机上有灰尘，请使用干的软布擦拭。
- 避免强光直接照射到迷你主机上，而且不要靠近强磁场。
- 不要将食物、食物等流体弄到主机上，不要用力拉扯数据线，电源线等。

快速安装

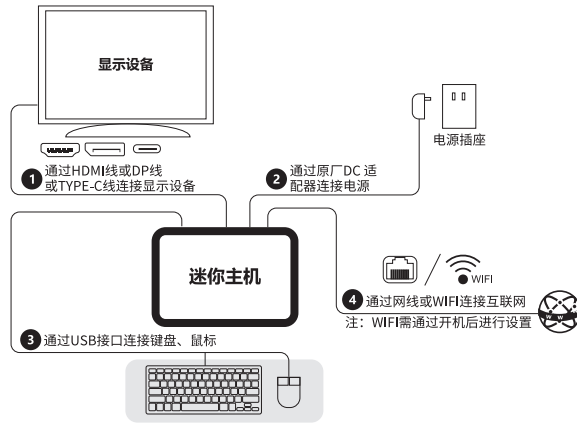

升级内存与更换硬盘

升级前准备

- 关闭所有与迷你电脑连接的外围设备；
- 关闭迷你电脑并断开电源线；
- 卸下迷你电脑的外壳螺丝，将外壳打开

1. 更换内存

- 要升级内存，请务必选择满足以下要求内存模块：DDR4-2133/2400/3200 MHz SO-DIMM。

注意：如果打算仅安装一个内存模块，则将其安装在下部内存槽中。

- **拆下旧的内存模块** 轻轻展开内存插槽两端的金属固定夹，使模块从插槽（C）中弹出。握住模块的边缘，将其从插座中取出，然后将其存放在防静电包装中。

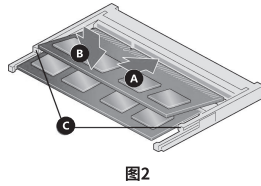

- **安装新的内存模块** 首先把内存模块底部边缘缺口与插槽座上的突起对齐；然后将内存模块的底部边缘以45度角插入插座（A）；插入模块后，向下推动模块的外边缘，直到固定夹卡入到位（B），并确保夹子牢固就位。

2. 更换或安装M.2 SSD (安装新SSD需要重新安装系统)

- 用螺丝刀逆时针方向将螺丝从连接器中卸下预装（如果有）的SSD内存（图3所示）；将新M.2 SSD底部的缺口与连接器上的凸起对齐，然后装M.2 SSD的底部边缘插入连接器（图4所示），最后用螺丝刀顺时针方向通过螺丝将M.2 SSD固定到支架上（图5所示）。

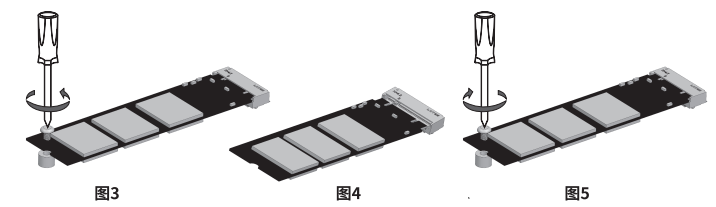

3. 更换或者安装2.5寸硬盘

- 用包装中附带的螺丝，将2.5寸硬盘以及硬盘金属支架固定在主体壳上。
- 将主机中的硬盘连接线插入到硬盘对应接口中，硬盘安装完成。

4. 关闭外壳

注：安装所有组件后，请务必关闭迷你主机外壳。建议您使用螺丝刀手动完成此操作，以免拧的过紧可能导致螺丝损坏（避免使用大功率手动工具进行拆装）。

功能接口示意图

电源开关	USB接口	高清接口	DP接口	VGA接口
LAN网口	电源接口	音频接口	USB-C接口	

安装VESA支架

请按照以下说明安装和使用VESA安装支架

- 1.将包装盒中随附的两个铜制螺丝钉A固定在主机背部对应螺孔中（如图8所示）。
- 2.使用包装盒中随附的四个黑色小螺钉，将VESA支架固定到显示器或电视的背面（如图9所示）。
- 3.将迷你主机通过固定在主机底部的两颗螺丝A滑到VESA安装支架B上即可完成安装。

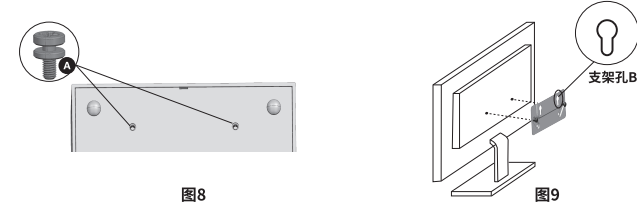

User Manual

Respected users: Thank you for using this product, for your safety and benefit, please read this product manual and all the information that comes with it carefully before using the product!

Disclaimer:

- 1.Please use the original power supply, we cannot be held responsible for any problems or failures caused by any third party adapters.
- 2.Users may use music videos, images and software provided by third parties, but we cannot be held responsible for copyright issues or software failures.
- 3.If the product failure, we will strictly abide by the warranty terms, but we will not be held responsible for any property damage or financial loss that may be caused during use.
- 4.The equipment comes with built-in software at the factory, which can be used after the actual test. However, it will not affect the machine in any way if it is removed or not when looking for compatibility or other issues. Please note that it is not a product quality issue.
- 5.The company reserves the right to make improvements to its products and product specifications and designs are subject to change without notice! Please refer to the actual product.

Precautions

- 1.Be extremely careful when performing operations that may cause file damage or loss.
- 2.Pay attention to the virus protection, try to use the virus firewall during using this Mini PC.
- 3.If you don't use the device for a long time, please turn off it, and disconnect the power.
- 4.Do not turn on and off the device frequently for a short period of time.
- 5.It is recommended that the interval between two boots should be at least 10 seconds, preferably no less than 60 seconds.
- 5.Pay attention to moisture, keep the use environment clean and sanitary, if there is dust on the device, please wipe it with a dry soft cloth.
- 6.Avoid direct exposure of strong light to the device, and stay away from strong magnetic fields.
- 7.Don't get water, food and other fluids onto the device, and don't pull the data and power lines with force.

Quick Installation

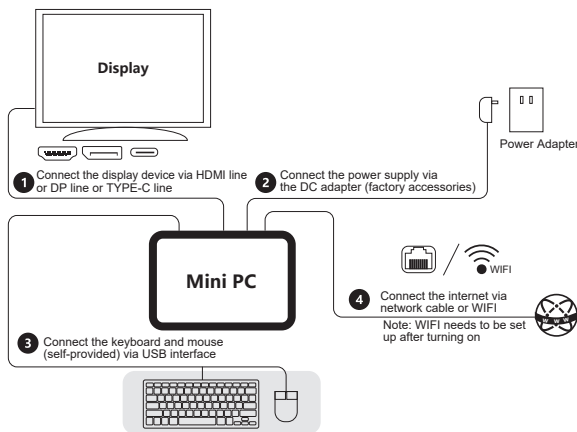

Upgrading Memory and Replacing Hard Drive

Preparation for upgrade

- A.Switch off all peripheral devices connected to the Mini PC.
- B.Turn off the Mini PC and disconnect the power cord.
- C.Remove the four screws from the bottom cover of the Mini PC and open the bottom cover.

1.Replacing memory

To upgrade the memory, please be sure to select a memory module that meets the following requirements: DDR4 :2133/2400/3200 MHz SO-DIMM
Note: If you intend to install only one memory module, please install it in the lower memory slot.

Remove the old memory module. Gently unfold the metal retaining clips on each end of the memory slot to allow the module to pop out of the slot (C). Hold the module by its edges and remove it from the socket, then store it in its anti-static packaging.

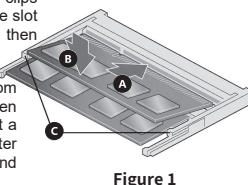
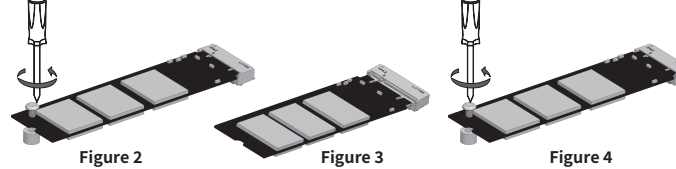

Figure 1

Install the new memory module. Firstly, align the notch on the bottom edge of the memory module with the protrusion on the slot holder, then insert the bottom edge of the memory module into the socket (A) at a 45 degree angle. After inserting the module, push down on the outer edge of the module until the retaining clip snaps into place (B), and ensure the clips are securely in place.

2.Replace or install M.2 SSD (installation of new SSD requires system re-installation)

Remove the pre-installed (if any) SSD memory from the connector with a screwdriver counterclockwise (shown in Figure 2); align the notch on the bottom of the new M.2 SSD with the tab on the connector, then insert the bottom edge of the M.2 SSD into the connector (shown in Figure 3), and finally use a screwdriver clockwise to Secure the M.2 SSD to the bracket with screws (shown in Figure 4).



3.Replace or Install 2.5-inch Hard Drive

- 1.Use the screws included in the package to fix the 2.5-inch hard disk and the hard disk metal bracket to the On the bottom shell (as shown in Figure 5);
- 2.Insert the hard disk cable in the host into the corresponding interface of the hard disk, then finish the hard drive installation.

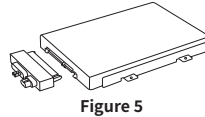

Figure 5

4.Closing the bottom cover

Note: After installing all the components, please make sure to close the bottom cover of the mini pc. It is recommended that you do this manually using a screwdriver to avoid over-tightening may cause damage to the screws (avoid using powerful hand tools for (avoid using powerful hand tools for disassembly)).

Functional Interface Diagram

Power	USB	HDMI	DP	VGA
RJ45	DC	AUDIO	USB-C	

Installation of VESA bracket

Please follow the instructions below to install and use the VESA mounting bracket:

- 1.Fix the two brass screws A included in the box into the corresponding screw holes on the back of the mini pc (as shown in Figure 6).
- 2.Using the four small black screws included in the box, attach the VESA bracket to the back of the monitor or TV (as shown in Figure 7).
- 3.Fix the mini pc through the two screws A fixed to the bottom of the main unit, slip over the VESA mounting bracket hole B to complete the installation

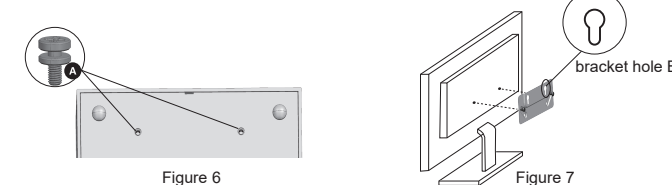

Figure 6

Figure 7

FCC STATEMENT This device complies with Part 15 of the FCC Rules. Operation is subject to the following two conditions:

- (1) This device may not cause harmful interference, and
- (2) This device must accept any interference received, including interference that may cause undesired operation.

Changes or modifications not expressly approved by the party responsible for compliance could void the user's authority to operate the equipment. This equipment has been tested and found to comply with the limits for a Class B digital device, pursuant to part 15 of the FCC Rules. These limits are designed to provide reasonable protection against harmful interference in a residential installation. This equipment generates, uses and can radiate radio frequency energy and, if not installed and used in accordance with the instructions, may cause harmful interference to radio communications. However, there is no guarantee that interference will not occur in a particular installation. If this equipment does cause harmful interference to radio or television reception, which can be determined by turning the equipment off and on, the user is encouraged to try to correct the interference by one or more of the following measures:

—Reorient or relocate the receiving antenna. —Increase the separation between the equipment and receiver.

—Connect the equipment into an outlet on a circuit different from that to which the receiver is connected.

—Consult the dealer or an experienced radio/ TV technician for help.

FCC Radiation Exposure Statement: This equipment complies with FCC radiation exposure limits set forth for an uncontrolled environment. In order to avoid the possibility of exceeding the FCC radio frequency exposure limits, Human proximity to the antenna shall not be less than 20cm(8 inches)during normal operation

ISED Statement

English: This device contains licence-exempt transmitter(s)/receiver(s) that comply with Innovation, Science and Economic Development Canada's licence-exempt RSS(s). Operation is subject to the following two conditions:

- (1) This device may not cause interference.
- (2) This device must accept any interference, including interference that may cause undesired operation of the device.

The digital apparatus complies with Canadian CAN ICES-3 (B)/NMB-3(B).

French: Cet appareil contient des émetteurs/récepteurs exempts de licence qui sont conformes aux RSS exemptés de licence d'Innovation, Sciences et Développement économique Canada.

L'exploitation est soumise aux deux conditions suivantes :

- (1) Cet appareil ne doit pas provoquer d'interférences.
- (2) Cet appareil doit accepter toute interférence, y compris les interférences susceptibles de provoquer un fonctionnement indésirable de l'appareil.

L'appareil numérique du ciem conforme canadien peut - 3 (b) / nmb - 3 (b).

This device meets the exemption from the routine evaluation limits in section 2.5 of RSS 102 and compliance with RSS 102 RF exposure, users can obtain Canadian Information

on RF exposure and compliance.

cet appareil est conforme à l'exemption des limites d'évaluation courante dans la section 2.5 du cnr - 102 et conformité avec rss 102 de l'exposition aux rf, les utilisateurs peuvent obtenir des données canadiennes sur l'exposition aux champs rf et la conformité.

This equipment complies with Canada radiation exposure limits set forth for an uncontrolled environment.

Cet équipement est conforme aux limites d'exposition aux rayonnements du Canada établies pour un environnement non contrôlé.

This equipment should be installed and operated with minimum distance 20cm between the radiator & your body.

Cet équipement doit être installé et utilisé à une distance minimale de 20 cm entre le radiateur et votre corps.