

Gaming Headset



VIP002W USER MANUAL

Dear customer:

Thank you for purchasing our product. Please read this user manual carefully and keep it for further reference.

Packing List

- a. Wireless Gaming Headset x1
- b. Wireless Transmitter box x1
- c. USB Charging Cable x1
- d. 3.5 Audio Cable x1

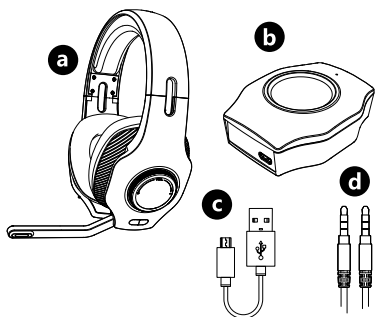

Instruction

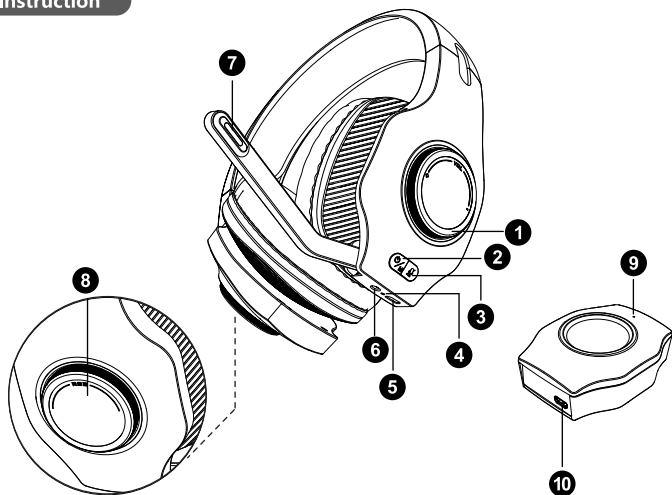

1. Volume knob button**2. Multi-function button**

- Press and hold for three seconds to turn on / off;
- Short press to switch the sound effect mode:
A beep sounds for the game mode;
Two beeps sound for music mode.

3. Mic mute + pairing button**4. Status indication light**

- When the headset is not connected to the wireless transmitter box, the charging indicator will continue to flash;
- When the headset is connected to the wireless transmitter box, the charging indicator is always on.

5. Charging port

- Plug the charging cable in when the headset is turned on, the headset will turn off automatically.

6. 3.5 Audio Jack port

- After the audio cable is inserted into the headset, the wireless headset will switch to a wired headset.

7. Microphone indication light**8. Light color knob button**

- Turn clockwise to the end, the light will automatically change color.

9. Wireless Transmitter indicating light

- When the headset is not connected to the transmitter box, the indicator light will continue to flash;
- The indicator light is always on when the headset is connected to the transmitter box.

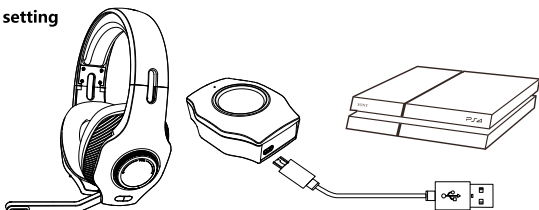
10. Wireless Transmitter box port**Connection Method****● PS4 connection setting**

1. Insert the USB Transmitter directly into the USB jack on the PS4 game console, and then long press the power button of the headset to turn on the device. After the connection is successful, proceed to the next step.
2. PS4 host audio output settings: select "Settings-Peripheral Devices-Audio Devices-Output to Headphones-All Audio" on the menu page.

● XBOX ONE connection setting



1. Connect the wireless headset to the XBOX ONE controller using the matching 3.5 audio cable.
(After the audio cable is inserted into the headset, the wireless headset will be switched to a wired headset, and the power button of the headset will not be available)

● Computer connection setting

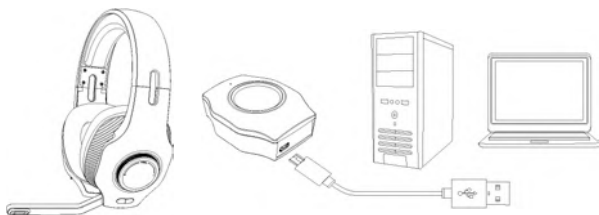

1. Insert the USB Transmitter directly into the USB jack on the computer, and then long press the power button of the headset to turn on the device. After the connection is successful, proceed to the next step.
2. Computer audio output setting: select "Playback device-2.4G Wireless Headphone-set as default device"
3. Click "Record-2.4G Wireless Headphone-Set as default device"

● Wired connection

A device with a 3.5 audio jack can be connected via a 3.5 audio cable.



Specifications

Wireless Headphone

Continuous working hours: $\geq 6\text{h}$

Charging hours: $\approx 3\text{h}$

Frequency range: 2.402-2.480GHz

Latency: 24mS

Transmission power: -5dBm

Transmission distance: 10m

Receiving sensitivity: -82dB

Speaker diameter: 40mm

Speaker impedance: 16 Ω

Speaker frequency response: 20~20KHz

Microphone specification: 4.0*1.5mm

Microphone frequency response: -42 \pm 3dB

Microphone direction: OMNI DIRECTIONAL

Wireless Transmitter box

Device name: 2.4G Wireless Headphone

Working voltage: 5V

Latency: 24mS

Transmission power: -5dBm

Transmission distance: 10m

Receiving sensitivity: -82dB

Produktliste

- a. Wireless Headset x1
- b. Drahtlose Senderbox x1
- c. USB-Kabel x1
- d. 3.5 Audiokabel x1

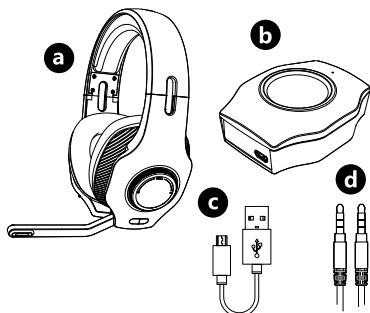

Produktbeschreibung

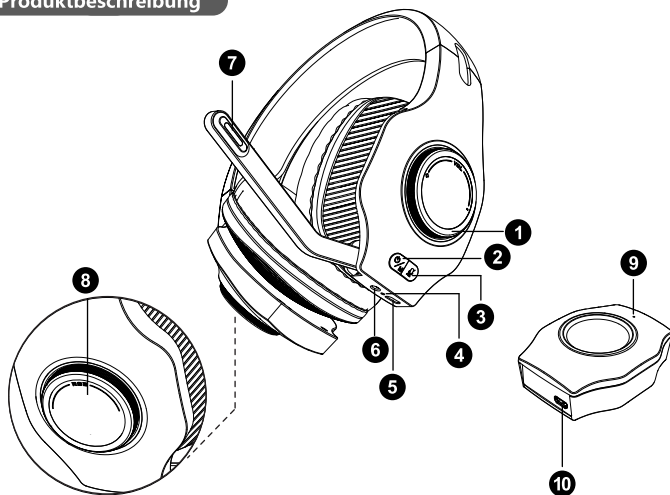

FCC Caution.

(1)§ 15.19 Labelling requirements.

This device complies with part 15 of the FCC Rules. Operation is subject to the following two conditions: (1) This device may not cause harmful interference, and (2) this device must accept any interference received, including interference that may cause undesired operation.

§ 15.21 Changes or modification warning Any Changes or modifications not expressly approved by the party responsible for compliance could void the user's authority to operate the equipment.

§ 15.105 Information to the user.

Note: This equipment has been tested and found to comply with the limits for a Class B digital device, pursuant to part 15 of the FCC Rules. These limits are designed to provide reasonable protection against harmful interference in a residential installation. This equipment generates uses and can radiate radio frequency energy and, if not installed and used in accordance with the instructions, may cause harmful interference to radio communications. However, there is no guarantee that interference will not occur in a particular installation. If this equipment does cause harmful interference to radio or television reception, which can be determined by turning the equipment off and on, the user is encouraged to try to correct the interference by one or more of the following measures:

- Reorient or relocate the receiving antenna.
- Increase the separation between the equipment and receiver.
- Connect the equipment into an outlet on a circuit different from that to which the receiver is connected.
- Consult the dealer or an experienced radio/TV technician for help.