

HY - LED - GLOBE - M22

2058731

Content

This box contains

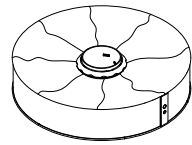

1 x Central Structure

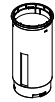

2 x Handle



1 x Support

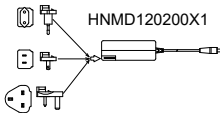

1 x Adapter

Assembly

- Put the main assembly on a stable clean surface
- Follow the below steps to assemble the giant ball parade

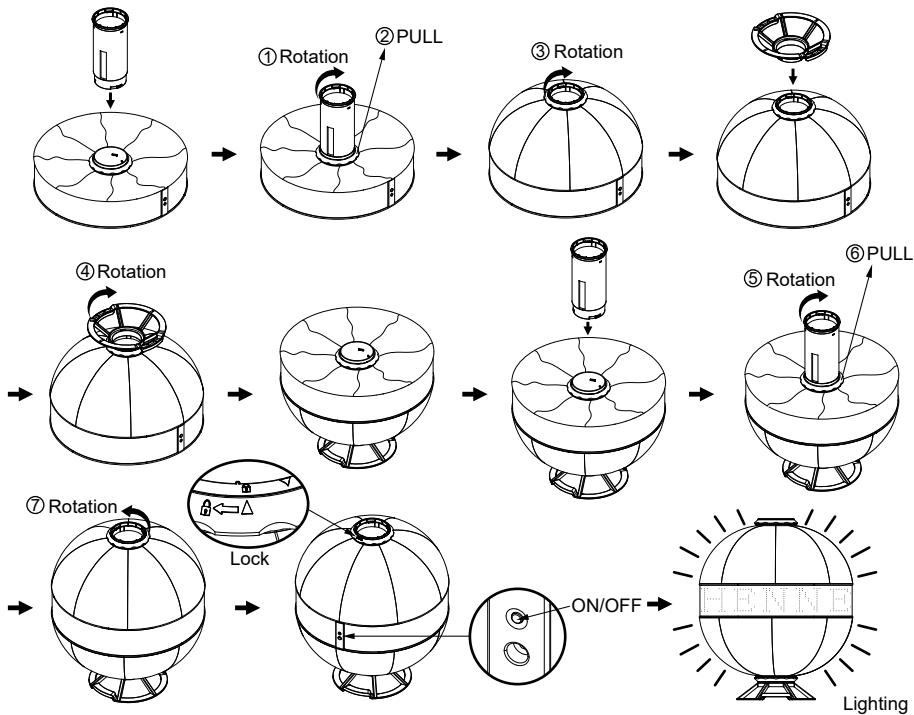

Disassembly

- Reverse the above steps
- Store all components in dry and safe place

Precautions

- Clean with a dry fabric or sponge
- This item is not intended to be waterproof
- Charging time: 6~8 hours / Autonomy: 5 to 7 hours

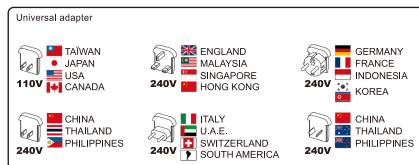
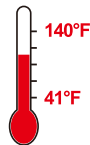
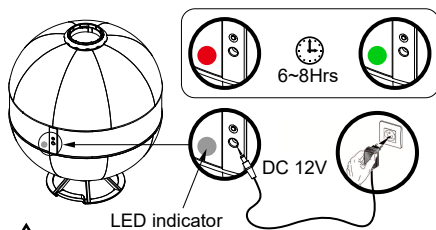

IF NOT USED DURING 6MONTHS, BATTERY MAY NOT WORK ANYMORE;
MAKE SURE TO CHARGE AT LEAST EVERY 3MONTHS FOR OPTIMAL PERFORMACE.

Installation method of cloth

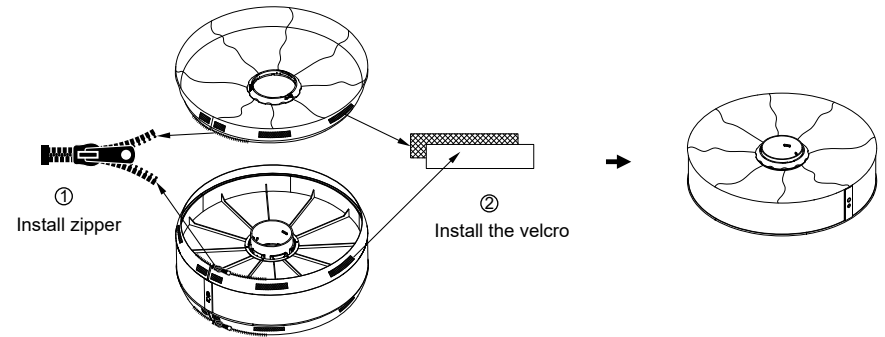

Pairing to the Hennessy Connected App

- To download the mobile app, scan the Apple or Android QR code, or search for "Hennessy Connected" on Apple Appstore or Google Play
- Turn on the Bluetooth on your mobile phone
- Turn on the Giant Ball
- Open the app and follow the instructions
- Click "Find Devices" to search for available devices
- Press the corresponding device ID to connect the device
- Follow the in-app instruction for the customization of the Giant Ball Parade

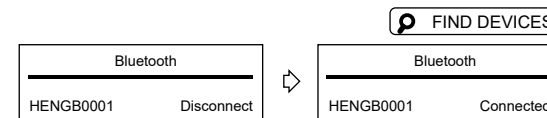

Warnings

This instructions need to be followed to ensure the safety of the user and a good use of the product.

1. Don't drop any components as it will damage the products.
2. Don't expose any components to an open flame.
3. Don't expose any components to direct sunlight.
4. Ensure the connections are dry and free from debris before installation.
5. Use only the manufacturer supplied adapter.
6. The manufacturer is not legally responsible for any kind of malfunction of the product directly caused by user negligence.
7. The manufacturer is not responsible for unauthorized repair or modification of the product.
8. The product is not intended for persons under the legal drinking age according to local laws.
9. Battery Charger used with this product is to be regularly examined for damage to the cord, plug and enclosure and in other parts, and in the events of such damage, battery charger must not be used until the damage has been repaired.
10. Alimentation damaged must not be used.
11. Do not dismantle, open or shred batteries.
12. Do not short-circuit a battery.
13. Do not use any charger other than that specifically provided for use with the product.
14. Do not leave a battery on prolonged charge when not in use.
15. After extended periods of storage, it may be necessary to charge and discharge the batteries several times to obtain maximum performance.
16. Keep this information for future reference.
17. The product and battery should be handed over to an appropriate collection point for the recycling of used batteries, electrical and electronic equipment.

Item No: 2058731 - HY - LED - GLOBE - M22
FCC ID: 2AUFF2058731
Power Rating: 12V DC 24W 50 / 60Hz
Adapter Model: HNMD120200X1

FCC:

1. Warning:

Warning: Changes or modifications to this unit not expressly approved by the party responsible for compliance could void the user's authority to operate the equipment.

2. Note:

NOTE: This equipment has been tested and found to comply with the limits for a Class B digital device, pursuant to Part 15 of the FCC Rules. These limits are designed to provide reasonable protection against harmful interference in a residential installation. This equipment generates, uses and can radiate radio frequency energy and, if not installed and used in accordance with the instructions, may cause harmful interference to radio communications.

However, there is no guarantee that interference will not occur in a particular installation. If this equipment does cause harmful interference to radio or television reception, which can be determined by turning the equipment off and on, the user is encouraged to try to correct the interference by one or more of the following measures:

- Reorient or relocate the receiving antenna.
- Increase the separation between the equipment and receiver.
- Connect the equipment into an outlet on a circuit different from that to which the receiver is connected.
- Consult the dealer or an experienced radio/TV technician for help.

This device meets low-power exclusion level, so the device complies with EMF basic restrictions according to standard EN62479. Radio operating frequency range 2402 MHz- 2480MHz, Max radio power 2dBm

IMPORTANT SAFETY INSTRUCTIONS

When using an electrical furnishing, basic precautions should always be followed, including the following:

Read all instructions before using (this furnishing).

DANGER – To reduce the risk of electric shock:

1. Always unplug this furnishing from the electrical outlet before cleaning or servicing.

WARNING – To reduce the risk of burns, fire, electric shock, or injury to persons:

1. Unplug from outlet before putting on or taking off parts.
2. Close supervision is necessary when this furnishing is used by, or near children, invalids, or disabled persons.
3. Use this furnishing only for its intended use as described in these instructions. Do not use attachments not recommended by the manufacturer.
4. Never operate this furnishing if it has a damaged cord or plug, if it is not working properly, if it has been dropped or damaged, or dropped into water. Return the furnishing to a service center for examination and repair.
5. Keep the cord away from heated surfaces.
6. Never operate the furnishing with the air openings blocked. Keep the air openings free of lint, hair, and the like.
7. Never drop or insert any object into any opening.
8. Do not use outdoors.
9. Do not operate where aerosol (spray) products are being used or where oxygen is being administered.
10. To disconnect, turn all controls to the off position, then remove plug from outlet.
11. For loading always put heavier items at the bottom and not near the top in order to help prevent the possibility of the furnishing tipping over.
12. Mount furnishings at the correct height.

SAVE THESE INSTRUCTIONS

The light source of this luminaire is not replaceable; when the light source reaches its end of life the whole luminaire shall be replaced

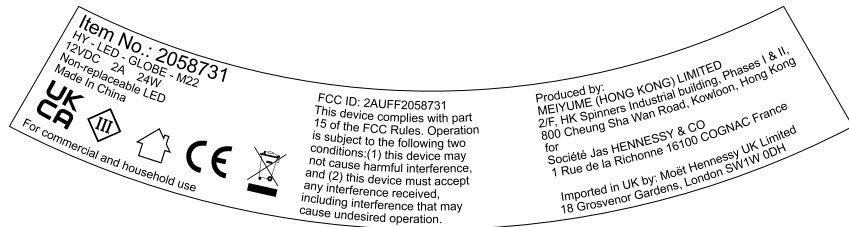

Produced by MEIYUME (HONG KONG) LIMITED
2/F, HK Spinners Industrial building, Phases I & II,
800 Cheung Sha Wan Road, Kowloon, Hong Kong
for Jas HENNESSY & CO - Rue de la Richonne –
16100 Cognac France

Importer: Moët Hennessy C/O Champion Logistics Group
Address: 100 Whitehall Drive Northlake IL 60154
telephone number: 708-836-1140 Ext. 411

Imported in UK by: Moët Hennessy UK Limited
18 Grosvenor Gardens, London SW1W 0DH

EU Declaration of Conformity

We,

MEIYUME (Hong Kong) LIMITED

2/F, HK Spinners Industrial Building, Phases I & II, 800 Cheung Sha Wan Road, Kowloon, Hong Kong

Declare that the DoC is issued under our sole responsibility and belongs to the following product(s):

Device Name: HY - LED - GLOBE - M22

Model No.: 2058731

The object of the declaration described above is in conformity with the essential requirements of the relevant Union harmonization legislation:

Radio Equipment Directive 2014/53/EU

The following harmonized standards and technical specifications have been applied:

Health and Safety (Article 3.1a): EN 62368-1:2014+A11:2017

EN 62479:2010

EMC (Article 3.1b): EN 55032:2015+A11:2020+A1:2020

EN IEC61000-3-2:2019+A1:2021

EN 61000-3-3:2013+A1:2019+A2:2021

EN 55035:2017+A11:2020

ETSI EN 301 489-17 V3.2.4

ETSI EN 301 489-1 V2.2.3

Radio Spectrum (Article 3.2): ETSI EN 300328 V2.2.2

Technical Compliance File Held by:

MEIYUME (Hong Kong) LIMITED

2/F, HK Spinners Industrial Building, Phases I & II, 800 Cheung Sha Wan Road, Kowloon, Hong Kong

Signed for and on behalf of MEIYUME (Hong Kong) LIMITED

Name and Title: Michael Ho, Senior Manager - Merchandising

Address: 2/F, HK Spinners Industrial Building, Phases I & II, 800 Cheung Sha Wan Road, Kowloon, Hong Kong

Hong Kong SAR

Place of issue

Dec 31, 2022

Date of issue

Michael Ho

Signature of Authorized Person



This symbol indicates that during the replacement of the used batteries, we request you to follow the current regulations for their elimination. Pls disposethem in a location foreseen for that purpose to ensure their elimination in a proper manner and with respect for the environment.



This symbol, affixed to the product or its packaging, indicates that the product must not be processed with household waste. It must be brought to an electric and electronic waste collection point for recycling and disposal. By ensuring the appropriate disposal of this product you also help in preventing potentially negative consequences for the environment and human health. The recycling of materials helps preserve our natural resources. For further information regarding the recycling of this products, please contact your municipality, local waste disposal centre or the store where the product was purchased.

Made in China

