

# User Manual

**Large Capacity Pet Feeder**

# Important safety instructions

---

Read all of the instructions below before using this product. Do not make any changes or create settings that are not described in this manual.

If physical injury, loss of data or damage is caused by failure to follow instructions, the warranty does not apply.

- This product can be used by children aged from 12 years above and persons with reduced physical, sensory or mental capabilities or lack of experience and knowledge if they have been given supervision or instruction concerning use of this product in a safe way and understand the hazards involved.
- Do not place anything on the top of the product.
- Do not expose the product to the temperature lower than 20°C.
- Ensure the desiccant package is intact before use to avoid it mixing with food.
- The product can only hold dry pet food with a diameter of 5 to 20mm.
- If the adapter is getting wet, cut off power. Never unplug the glove without insulating gloves. Contact our Customer Support to purchase a replacement.
- To avoid electric shock, do not place the power cord or plug in water or other liquids. Only use a power cord that is recommended or sold by the product manufacturer.
- Dispose of packaging properly. Some components may be packed in poly bags which can cause suffocation. Keep them away from children and pets.
- When the batteries are running low, replace them immediately; or the battery corrosion will damage the product.

## What's in the box



Feeder

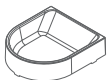

Food Tray  
(With Stainless Steel Food Tray)



Power Adapter



User Manual

## At a glance



Dessicant Compartment

Top Cover Opening Latch

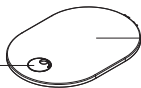

Food Hopper

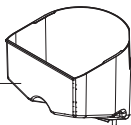

Food Delivery Cylinder

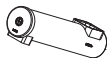

Battery Compartment

Set Button



Food Outlet

Power Switch



Body

Camera

Power Port

Food Tray

## Assemble&Disassemble

### Disassemble the food hopper

**( Noted: Keep the food hopper empty before disassemble it )**

Hold the spiral compartment and pull it out follow the direction of food outlet when detach the Food Delivery Cylinder.

### Assmble the food hopper

- 1.Please put the spiral compartment in the slot of the product bottom
- 2.Adjust the bottom hexagonal card and align it the the spiral compartment
- 3.Put the spiral compartment below the arrow sticker
- 4.Press down the spiral compartment then finish the assemble

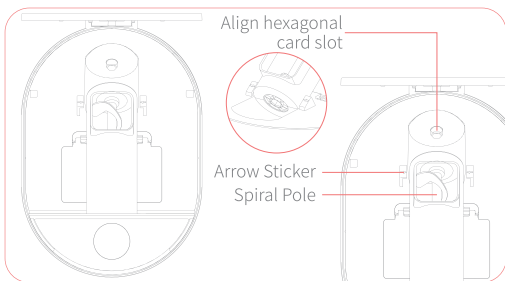

### Clean Your Feeder

1. Power off and unplug.
2. Please use the soft cloth with some suds to wipe gently.
3. Food hopper and food tray are detachable for washing.  
(Dish-washer is supported )
4. Please dry the food tank before assembling it.

## Check Before Using

1. To avoid any power cut situation, please install 4\*D size batteries before installing the food hopper.
2. Please press SET button twice for initial food dispensing settings.
3. Quick check the status of Link indicator, please ensure the Link indicator is slow flashing.(Please press and hold SET button for 3S if the link indicator is solid on)

## Start Your Smart Life

1. Dowoload "Smart Life" APP by App Store or Google Play Store.
2. Please allow all "location/ Network/ Notification" access before getting configuration with your pet feeder.
3. Log in or Sign Up your account.



Scan QR Code to Download "Smart Life" as well

## Configure Your Smart Pet Feeder- EZ Mode

Click “Add Device” and choose “Pet Feeder With Camera(Wi-Fi) Under “Small Home Appliances” category.

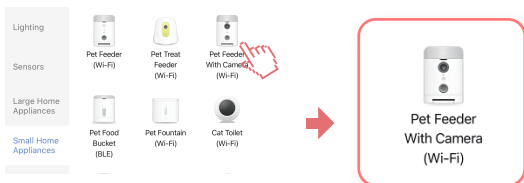

2. Click the mode switch button on the right top corner ,and then Click “Next” .

3. Please ensure that you have entered correct password and your current WiFi frequency is 2.4GHz. (If not, please switch your WiFi option via WLAN page)

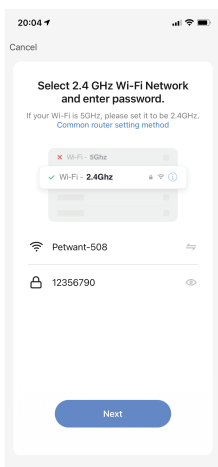
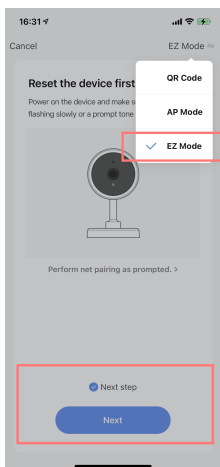

4. It will spend 2 minutes on completing the configuration.

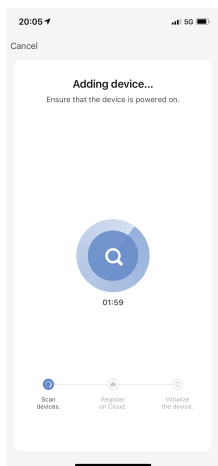

### Tips about Mode Switch:

a) There will be two options for users to get smart feeder connected. If you fail to get configuration through EZ Mode, please press and hold SET button on the unit for 3s.

b) You will hear “ AP Mode” if you successfully get the configuration mode switched.

# Configure Your Smart Pet Feeder- AP Mode

1. Click “Add Device” and choose “Pet Feeder With Camera(Wi-Fi) Under “Small Home Appliances” category.



2. Switch to “AP Mode” on top right page and Click “Power on ..... prom” and then Click “Next” .

3. Please ensure that you have entered correct password and your current WiFi frequency is 2.4GHz. (If not, please switch your WiFi option via WLAN page)

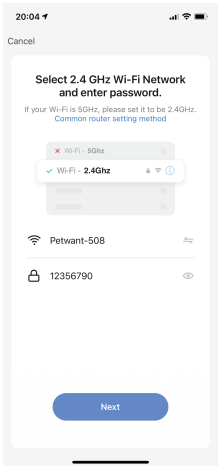
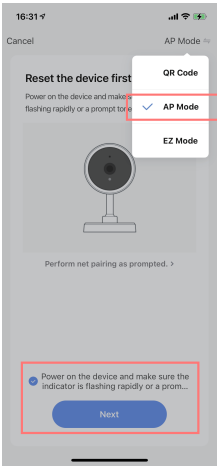



4 “Go to Connect” “Smartlife-XXXX”  
AP hotspot through WLAN page.

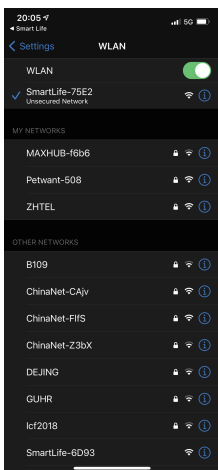

5. Back to Connection page in the  
APP after connected with the AP  
hotpot.

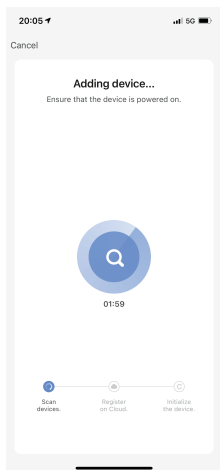

6. It will spend 1-2 mins on  
completing the configuration.

## Function Showcase

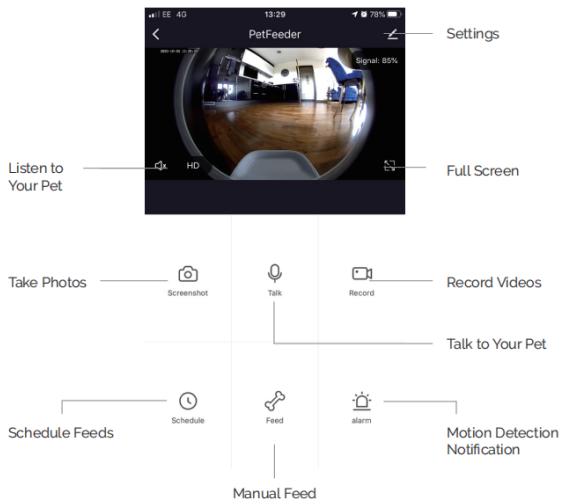

Note: The one way talking is a default factory setting. If need two way talk, please click the button, and change it in the "Basic Functions"

### ● Programmed Feeding Schedules

Click "Schedule" to add feeding times. Here you can set different feeding times and portions. You can set up to 4 meals and 20 portions per meal. In the overview of all feeding times, you can simply activate or deactivate individual feeding times.

### ● Instant Feeding

1. Press "Feed" and choose the number of portions that you want to give out right now.
2. By pressing "Short Record" you can record a 10-second long audio message. This is played at meal time to get your pet's attention
3. Under "Feed Record" you can see all previous feeding times.

## Motion Detection

Under “Alarm” you can activate the motion detection of your camera to receive notification when your pet approaches the dispenser.

## Other Settings

You can access additional features by going into the settings menu. These are:

- Checking the feeder's status.
- Activating and deactivating motion detection
- Sharing your device with others(Up to 20 people)
- You can also set the audio mode to one-way or two-way
- Remove Device

## Product Parameters

Product Name	Large Capacity Pet Feeder
Item Size	359mm*250mm*378mm
Product Size with Food Tray	539mm*250mm*378mm
Food Tray Capacity	Around 1.5L
Product Capacity	10L
Net Weight	4.4kg
Material	ABS
Vedio Resolution	Support 1080p
Camera	215°Wide Angel
Protection Level	IP65
Food Size	Supoort 5-20mm diameter range dry food
Max Meals	4 Meals/Day
Max Portions	20 Portions/Meal
1 Portion Wight	Around 20g
Manual Feeding	Support
Voice Recording	Support 10s Voice Recording
Power	DC 5V / 2A
Battery	4*D Size Batteries
Desiccant	Suggest replace every 1 month
Use Enviroment Temperature	0-40°C

changes or modifications not expressly approved by the party responsible for compliance could void the user's authority to operate the equipment.

This device complies with Part 15 of the FCC Rules. Operation is subject to the following two conditions:

(1) this device may not cause harmful interference, and

(2) this device must accept any interference received, including interference that may cause undesired operation.

Note: This equipment has been tested and found to comply with the limits for a Class B digital device, pursuant to Part 15 of the FCC Rules. These limits are designed to provide reasonable protection against harmful interference in a residential installation. This equipment generates, uses, and can radiate radio frequency energy, and if not installed and used in accordance with the instructions, may cause harmful interference to radio communications. However, there is no guarantee that interference will not occur in a particular installation.

If this equipment does cause harmful interference to radio or television reception, which can be determined by turning the equipment off and on, the user is encouraged to try to correct the interference by one or more of the following measures:

- Reorient or relocate the receiving antenna.
- Increase the separation between the equipment and receiver.
- Connect the equipment into an outlet on a circuit different from that to which the receiver is connected.
- Consult the dealer or an experienced radio/TV technician for help.