



PODZ TWS EARBUD



QUICK START GUIDE

IMPORTANT SAFETY

Read all instructions before using your earbuds.  
**Important:** Use of earbuds while operating a vehicle, motorcycle, watercraft or bicycle is not recommended and is illegal in some areas. Check and obey applicable laws and regulations on the use of earbuds while your operating a vehicle. Be careful and attentive while driving. Stop listening to your audio device if you find it disruptive or distracting while operating any of vehicle or performing another activity that requires your full attention.  
• Never expose your earbuds to high temperatures, extreme cold or submerge in water.  
• If the product overheats, has been dropped or damaged or has been dropped in a liquid, discontinue use.  
• In order to avoid the risk of electric shock, never attempt to open your earbuds or repair them, consult a certified professional.  
• Your earbuds are not to be used by children without adult supervision.  
• Do not clean the earbuds with harmful chemicals or detergents.

MAINTENANCE

**Store the earbuds.**  
When you're not using the earbuds, store them in the charging case. Close the charging case to help preserve battery life and keep the charging case free of debris. When storing the earbuds for an extended period of time (more than 4 weeks), make sure they are stored at room temperature and the charging case battery level is greater than 40%.  
**Clean the earbuds and charging case.**  
**Earbud nozzles:** Wipe only with a dry, soft cotton swab or equivalent. CAUTION: Never insert any cleaning tool into the nozzle.  
**Charging contacts (on earbuds) and charging pins (in charging case):** To prevent rusting, wipe with a dry, soft cotton swab or equivalent.  
**Charging case:** Wipe only with a dry, soft cotton swab or equivalent.

GETTING STARTED

- ① Micro USB charging port

② Charging Case LED indicators

③ Charging Case Power Button
- ④ Left earbud LED indicator

⑤ Left control button

⑥ Right earbud LED indicator

⑦ Right control button

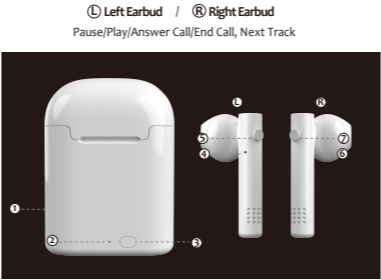

CHARGING YOUR CASE

- Charge on the go charging case, with the included micro USB cable for 2-3 hours. (LED (2) will blink red)  
*Do not charge longer than suggested time. Do not charge overnight.*
- When LED (2) is illuminated solid red, battery case is fully charged.



CHARGING YOUR EARBUDS



- Place Right and Left Earbuds into charging case and press the power button on the battery case (3)
- Charging case LED indicator (2) will illuminate Blue and the earbud LED indicators (4, 6) will illuminate Red, indicating that the earbuds are charging properly. When Earbuds LEDs (4, 6) off, earbud batteries are fully charged.
- After earbuds are fully charged, press the charging case power button (3) to turn the charging case off.

