

Flexbook Touch

User Manual



TABLE OF CONTENTS

TECHNICAL SUPPORT	1
COMPATIBILITY	1
SETUP	2
SHORTCUT MAP	3
TOUCHPAD FUNCTION	3
INSTALLATION AND REMOVAL	4
ROTATION	5
USAGE	5
CHARGING	6
TROUBLESHOOTING	7
PRODUCT SPECS	8
COMPLIANCE	8

TECHNICAL SUPPORT

If you have any issues or questions, let us know ASAP! We would love to get you taken care of and happy right away! All units come with a full 12 month warranty, so you can relax and take comfort in your purchase.

For the fastest & friendliest support, contact us (not Amazon) via one of the contact methods below.

1. Email: support@typecase.co
2. Phone: 832 - 303 - 5080
3. Chat: <https://typecase.co/support>

COMPATIBILITY

Compatible with iPadOS 13 (and newer). We recommend updating your iPadOS to **13.4.1** for best performance.

To check your iPad system version:

1. Go to Settings  > General > About > Software Version.
2. Upgrade your version to iPadOS **13.4.1** or above to use the touchpad function correctly.

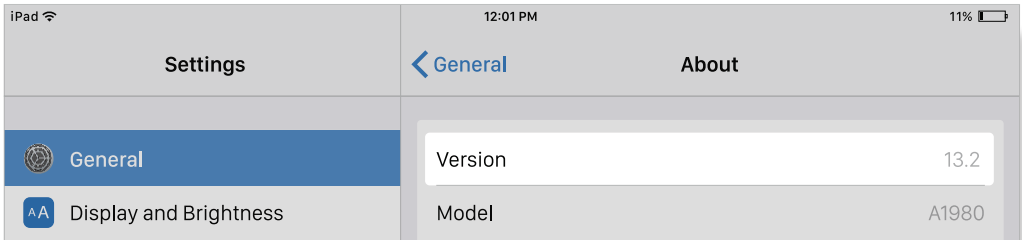

To upgrade your iPadOS to the latest version:

1. Open your device's Settings  > General > Software Update.

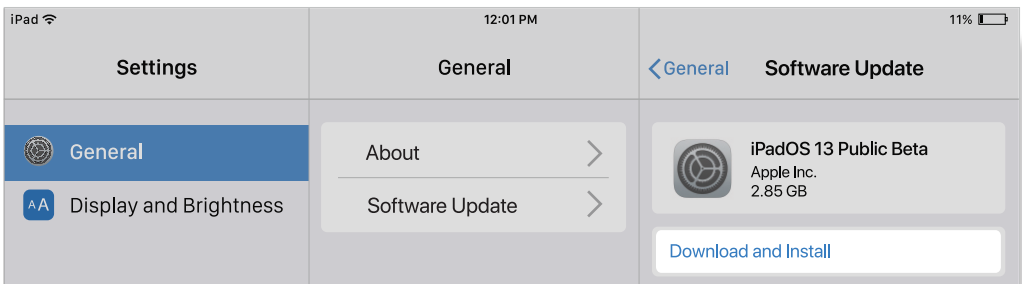

2. Tap Download and Install.

* If you see Resume Download, tap that instead.

SETUP

To pair with your iPad:

1. Switch **ON/OFF** switch to **ON** position.
2. Bluetooth indicator light will start blinking. If Bluetooth indicator light does not start blinking, press and hold the **'Pair'** button for **3 seconds**.
3. Toggle Bluetooth ON in the Settings app  (device is connected when Bluetooth indicator stops flashing).

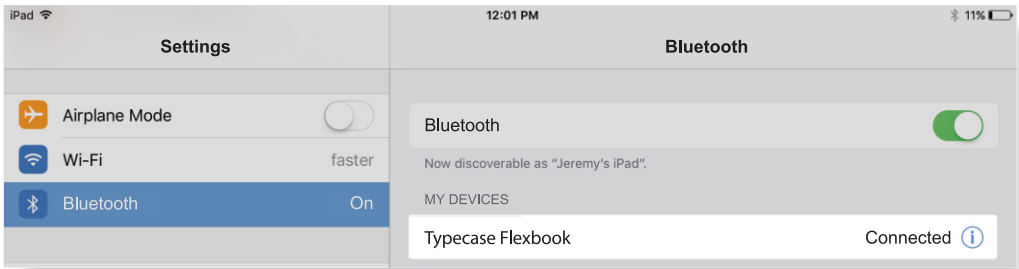
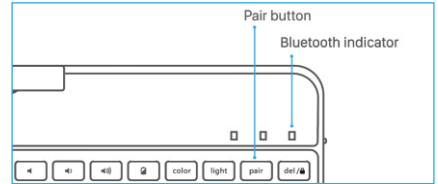
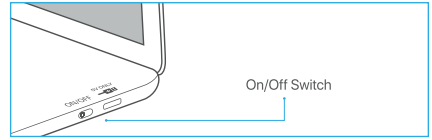

4. Tap **'Typecase Flexbook'** under **'MY DEVICES'** in the Bluetooth section of the Settings app.
5. Tap **'Pair'** in the pop-up window like shown below.

* When pairing to new devices, please repeat steps 1-3.

Pairing process is considered complete after **'Connected'** indicator appears.

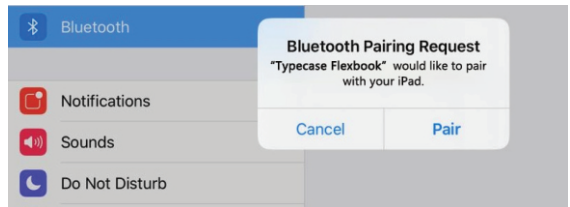

If your system is 13.3.1, please follow the steps to enable touchpad function:

1. Go to Settings  > Accessibility > Touch.
2. Make sure **Assistive Touch** option is turned On.

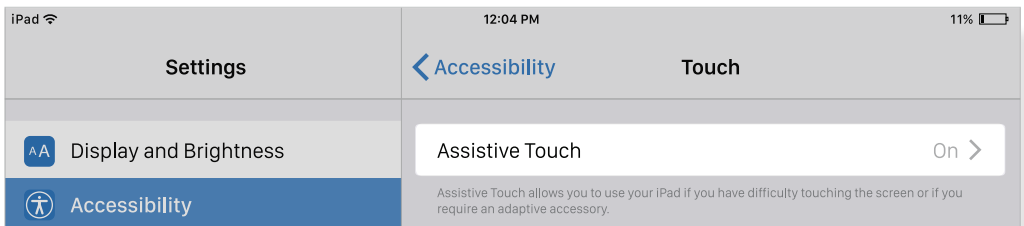

SHORTCUT MAP

Notice: Long Hold  in any app to view available shortcuts.

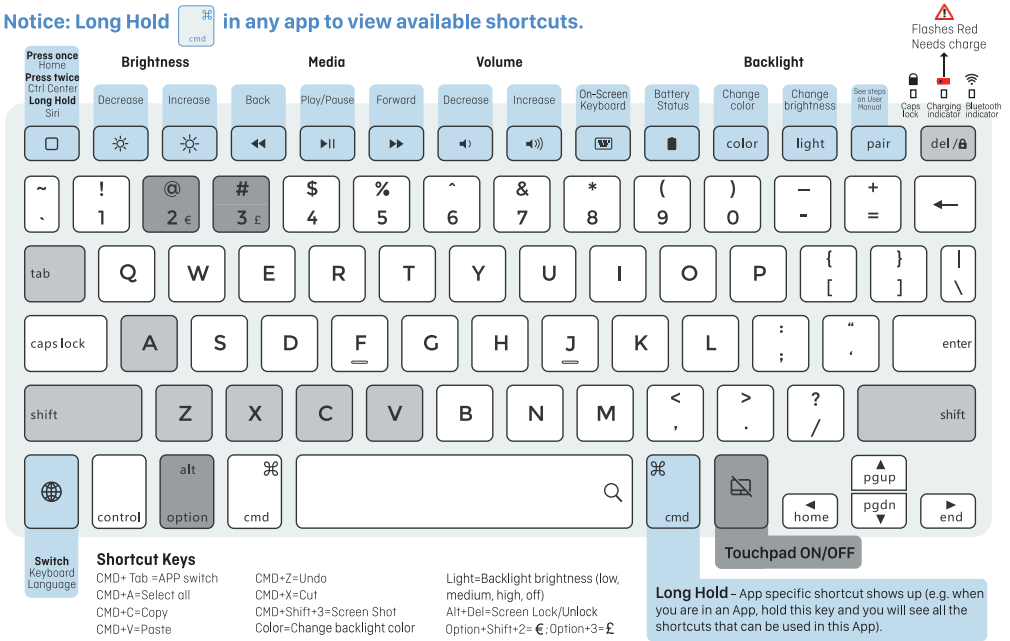

Brightness
 Decrease, Increase

Media
 Back, Play/Pause, Forward

Volume
 Decrease, Increase

Backlight
 On-Screen Keyboard, Battery Status, Change color, Change brightness, See steps in User Manual, Caps Lock, Charging Indicator, Bluetooth Indicator, Flashes Red Needs charge

Shortcut Keys
 CMD+Tab=APP switch
 CMD+A=Select all
 CMD+C=Copy
 CMD+V=Paste
 CMD+Z=Undo
 CMD+X=Cut
 CMD+Shift+3=Screen Shot
 Color=Change backlight color
 Light=Backlight brightness (low, medium, high, off)
 Alt+Del=Screen Lock/Unlock
 Option+Shift+2=€; Option+3=£

Touchpad ON/OFF

Long Hold - App specific shortcut shows up (e.g. when you are in an App, hold this key and you will see all the shortcuts that can be used in this App).

TOUCHPAD FUNCTION

Notice: Make sure bluetooth connected and touchpad function turned on!

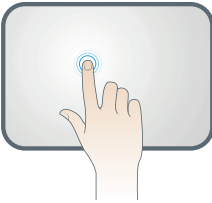

One Finger Tap Mode

Action 1: Tap one time while on main interface;
Function: mouse cursor manipulation.

Action 2: tap 2 times and slide;
Function: select or move the icon.
Jump out of the mode: refer to the right instruction.

Action 3: Tap two times when iPad is in sleeping mode
Function: Wake up iPad

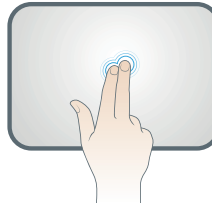

Two Fingers Tap Mode

Action 4: Tap the pad one time;
Function: Show the shortcuts.

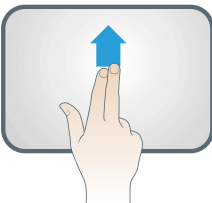
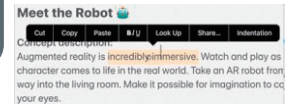

Two Fingers Scroll

Action 5: Slide fingers up or down;
Function: Scroll web page or file up/down or scroll splitted screen
Action 6: Slide fingers left or right
Function: Turn the page to the left or right

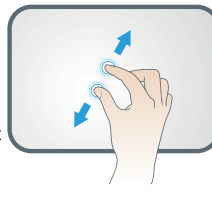

Two Fingers Zoom

Action 7: Two fingers slide for zooming in or out.
Function: Can only be used on the websites or spreadsheets.

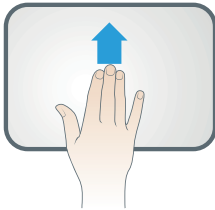

Three Fingers Swipe UP

Action 8: Swipe Up;
Function: Switch between Main interface and previous program or page.

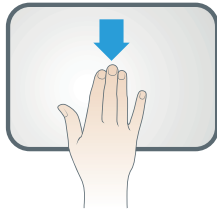

Three Fingers Swipe Down

Action 9: Swipe Down;
Function: Switch between main interface and splitted screen.

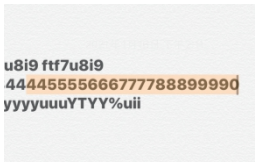

Shift+Cursor

Function: Select the text



Move the cursor to the bottom of the screen

Function: Get access to the dock to switch

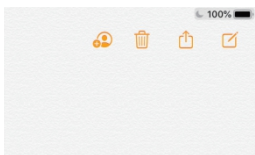

Move the cursor to the upper corner

Function: Enter the control center

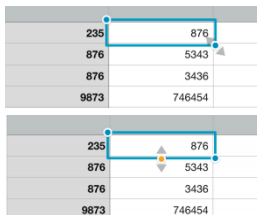

Usage for Excel-Apply the cursor on one cell

1. Drag the cell to the right: Make the cell wider
2. Drag the cell to up or down: Multiple choose cells

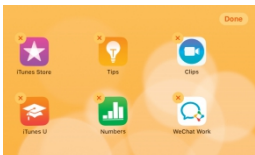

In App Page:

Touch and hold the left pad, you can drag the app icon to where you want

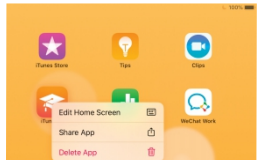

Touch and hold the right pad, show the manu for the APP (Same as Right Click on Mouse)

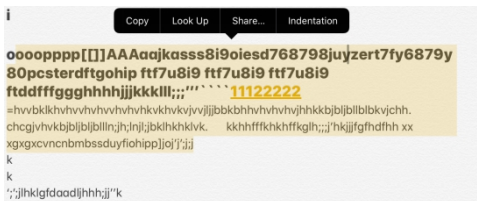

In Edit Page:

Touch and hold the left pad, you can choose the text you want and you can drag and drop the text to around.

Touch and hold the right pad, there will be shortcut for you to choose

INSTALLATION AND REMOVAL

Installation:

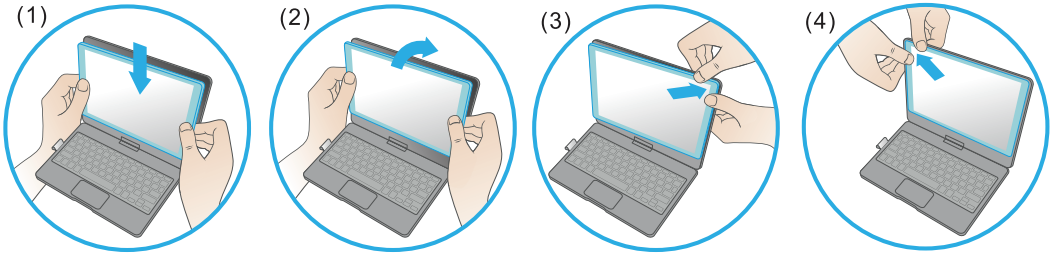

1. Align the lower edge of the iPad with the keyboard case.
2. Slightly push the iPad until all of the edges align.
3. Press the upper corner of the iPad with your fingers to put it in place.
4. Repeat pressing the remaining corners until iPad is held tightly inside the case.

Removal:

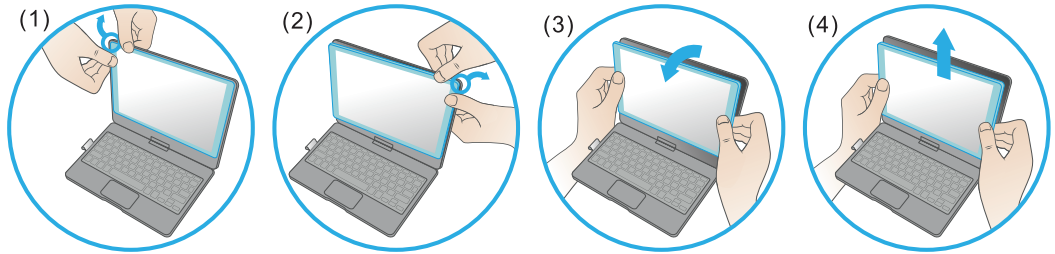

1. Hold iPad on both sides of the upper corner and use thumbs to gently push off the back cover. It's held in place by two tabs.
2. Repeat for the second upper corner.
3. Peel away the upper part completely.
4. Pull up to remove iPad from case.

ROTATION



Twist to rotate 360°



Open up to 180°

WARNING

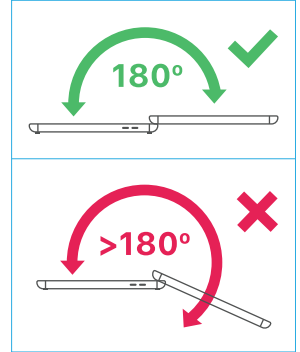

USAGE



CHARGING

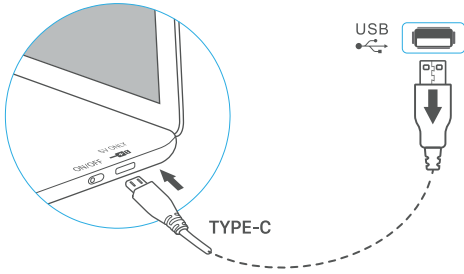

iPad adapters

1. Switch on the keyboard (if battery light is flashing, please charge the keyboard).
2. Plug the charging cable (included) into the keyboard and power adapter (not included, iPad or iPhone power adapter recommended);
 - a) Battery indicator turns red when keyboard is charging;
 - b) Battery indicator turns blue when charging is complete.

TROUBLESHOOTING

If the keyboard is not working correctly, please check the following:

1. The Bluetooth function on the iPad (or other Bluetooth devices) is enabled;
2. The Bluetooth keyboard is within 33 feet;
3. The Bluetooth keyboard is charged;
4. Make sure the keyboard is turned on (the battery indicator is illuminated);
5. Press the key 'Pair' and check the Bluetooth status;
6. Make sure a keyboard has already paired via Bluetooth.

If you have unwanted auto-correction or punctuation, please follow these steps:

1. Open Settings app > General > Keyboard > **Hardware Keyboard**;
2. Toggle **OFF** Auto-Capitalization, Auto-Correction, and "." shortcut (please refer to the picture below).

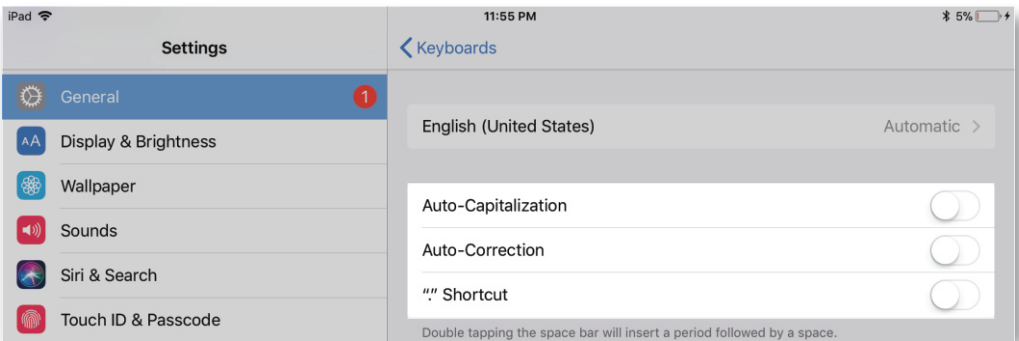

If Bluetooth pairing fails, please try the following steps:

1. Remove all Bluetooth devices on your iPad;
2. Switch off the Bluetooth function on your iPad;
3. Reboot the iPad;
4. Turn on the Bluetooth on your iPad;
5. Switch the keyboard off and on;
6. Repeat the steps described on page 2 and 3 to pair the keyboard.

PRODUCT SPECS

Operating distance: 10 meters (33 feet)

Modulation System: GFSK

Working voltage: 3.0-4.2V

Working current: 0.88-3.85mA

Sleeping current: < 125µA

Charging current: 500-800mA

Continuous working time without backlight: 60 hours

Charging time: < 2 hours

Charging voltage: 5V

Key's life span: > 5 million strokes

Operating temperature: -10 ±55°C

Maintenance: Please preserve the keyboard under normal temperature and recharge under normal voltage.

COMPLIANCE

NOTE: This equipment has been tested and found to comply with the limits for a Class B digital device, pursuant to part 15 of the FCC Rules. These limits are designed to provide reasonable protection against harmful interference in a residential installation. This equipment generates uses and can radiate radio frequency energy and, if not installed and used in accordance with the instructions, may cause harmful interference to radio communications. However, there is no guarantee that interference will not occur in a particular installation. If this equipment does cause harmful interference to radio or television reception, which can be determined by turning the equipment off and on, the user is encouraged to try to correct the interference by one or more of the following measures:

- Reorient or relocate the receiving antenna;
- Increase the separation between the equipment and receiver;
- Connect the equipment into an outlet on a circuit different from that to which the receiver is connected;
- Consult the dealer or an experienced radio/TV technician for help.

Changes or modifications not expressly approved by the party responsible for compliance could void the user's authority to operate the equipment. This device complies with Part 15 of the FCC Rules. Operation is subject to the following two conditions:

- 1) this device may not cause harmful interference, and
- 2) this device must accept any interference received, including interference that may cause undesired operation.