

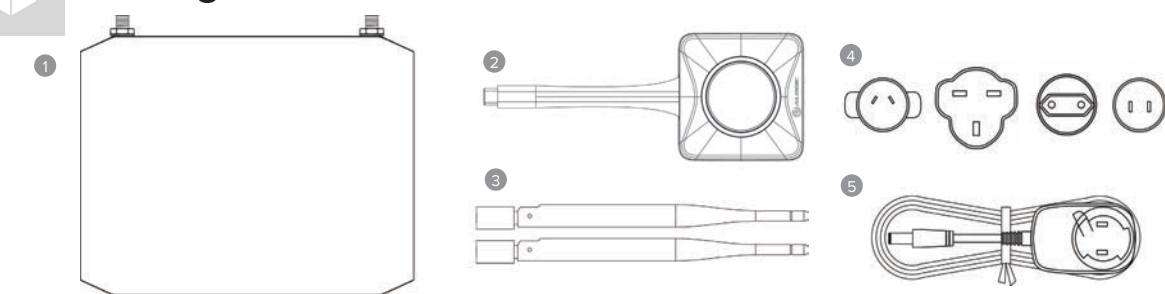

Package Contents



Package Contents | Packungsinhalt | Contenido del Paquete | Contenu du Colis | Contenuto confezione |

パッケージ内容 | محتويات الحزمة

| | | | |
|---|--|---|--|
| EN Receiver (Base Station) | ES Receptor (estación base) | IT Ricevitore (stazione base) | AR جهاز الاستقبال (المحطة الأساسية) |
| DE Empfänger (Basisstation) | FR Récepteur (Station de base) | JP 受信機 (基地局) | |
| EN Transmitter (Wireless Presenter Button) | ES Transmisor (inalámbrico Botón de presentador) | IT Trasmittitore (senza fili pulsante presentatore) | AR جهاز إرسال (لاسلكي) (زر مقدم العرض) |
| DE Sender (drahtlos Moderatoratstaste) | FR Émetteur (sans fil Bouton Présentateur) | JP 送信機 (ワイヤレス) 発表者ボタン | |
| EN Antennas | ES Antenas | IT Antenne | AR هوائيات |
| DE Antennen | | | |
| EN Power Adapter Plugs for (AU/NZ, EU, UK and US) | ES Enchufes adaptadores de corriente para (AU/NZ, UE, Reino Unido y EE. UU.) | IT Spine adattatori di alimentazione per (AU/NZ, UE, Regno Unito e Stati Uniti) | AR مقابس محول الطاقة ل (أستراليا/نيوزيلندا، الاتحاد الأوروبي، المملكة المتحدة والولايات المتحدة) |
| DE Netzteilstecker für (AU/NZ, EU, UK und US) | FR Prises d'adaptateur secteur pour (AU/NZ, UE, Royaume-Uni et États-Unis) | JP AU/NZ、EU、UK、US 電源アダプタプラグ (オーストラリア/ニュージーランド、EU、英国、米国) | |
| EN Multi Country Power Adapter DC12V/1A | ES Adaptador de corriente para varios países DC12V/1A | IT Adattatore di alimentazione multipaese DC12V/1A | AR محول طاقة متعدد DC12V/1A |
| DE Multi-Länder-Netzteil DC12V/1A. | FR Adaptateur secteur multi-pays DC12V/1A | JP マルチカントリー電源アダプター DC12V/1A | |

1



Ports and Features

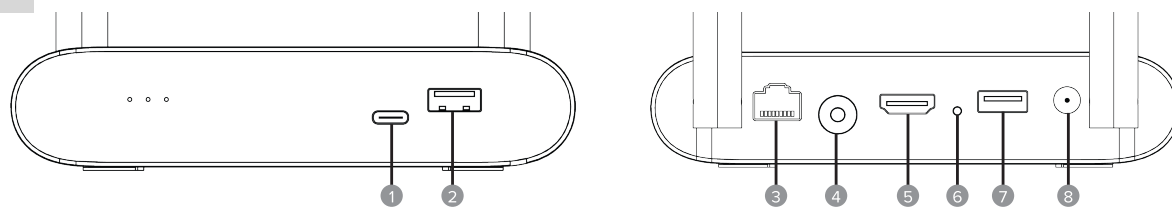

| | | | |
|--|--|--|--|
| EN USB-C - For presenter button pairing | ES USB-C: para emparejamiento de botones del presentador | IT USB-C: per l'associazione dei pulsanti del presentatore | AR USB-C - لإقران زر مقدم العرض |
| DE USB-C – Zum Koppeln der Presenter-Tasten | FR USB-C - Pour le couplage des boutons du présentateur | JP USB-C - プレゼンターボタンのペアリング用 | |
| EN USB-A - For touchscreen and mouse inputs | ES USB-A: para entradas de pantalla táctil y mouse | IT USB-A: per input touchscreen e mouse | AR USB-A - لإدخالات شاشة اللمس والماوس |
| DE USB-A – Für Touchscreen- und Mauseingaben | FR USB-A - Pour les entrées d'écran tactile et de souris | JP USB-A - タッチスクリーンおよびマウス入力用 | |
| EN Ethernet port | ES Puerto Ethernet | IT porta Ethernet | AR منفذ إيثرنت |
| DE Ethernet Anschluss | FR port Ethernet | JP イーサネットポート | |
| EN 3.5mm audio output | ES 3.5 Salida de audio | IT 3.5 Uscita audio | AR مخرج صوت 3.5 ملم |
| DE 3.5 Audioausgang | FR 3.5 Sortie audio | JP 3.5 オーディオ出力 | |
| EN HDMI display output | ES Salida de pantalla HDMI | IT Uscita display HDMI | AR مخرج شاشة HDMI |
| DE HDMI-Display-Ausgang | FR Sortie d'affichage HDMI | JP HDMIディスプレイ出力 | |
| EN Reset button | ES Botón de reinicio | IT Pulsante di reset | AR زر إعادة الضبط |
| DE Reset-Knopf | FR Bouton de réinitialisation | JP リセットボタン | |
| EN USB-A - For touchscreen and mouse inputs | ES USB-A: para entradas de pantalla táctil y mouse | IT USB-A: per input touchscreen e mouse | AR USB-A - لإدخالات شاشة اللمس والماوس |
| DE USB-A – Für Touchscreen- und Mauseingaben | FR USB-A - Pour les entrées d'écran tactile et de souris | JP USB-A - タッチスクリーンおよびマウス入力用 | |
| EN Power adapter input | ES Entrada del adaptador de corriente | IT Ingresso adattatore di alimentazione | AR إدخال محول الطاقة |
| DE Netzteilzugang | FR Entrée de l'adaptateur secteur | JP 電源アダプター入力 | |

2

Instructions to Set Up and Use the Device

1 Install Antennas

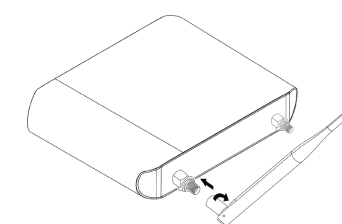

2 Connect to Display

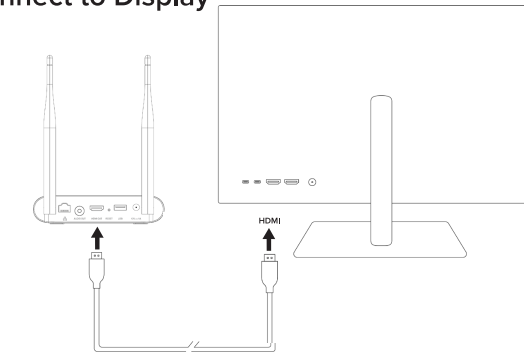

3 Connect Power Adapter

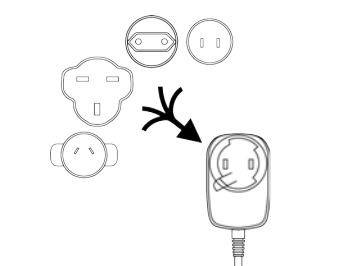

4 Connect to Power Socket

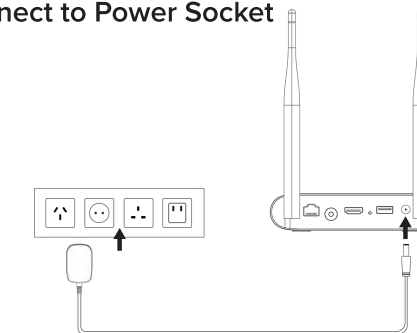

5 Configure the Device



Important
Log in to the device and change the default administrator password before use.

3



Using the Device

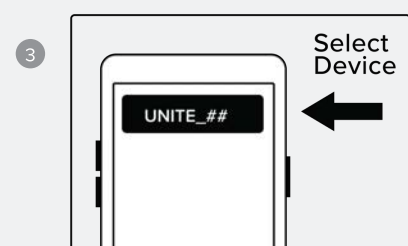
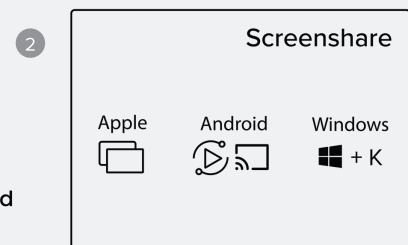
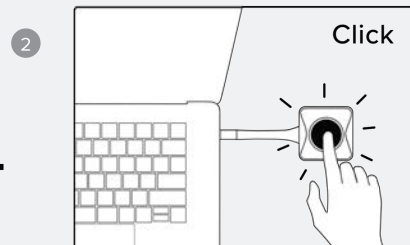
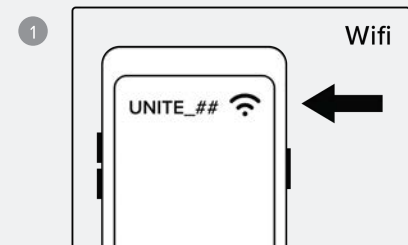
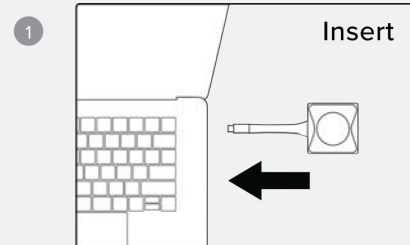

4



Instructions to Set Up and Use the Device

Setting Up the Device (Refer to the images on page 3)

- Unpack the device. Locate the two antennas and connect them to the rear of the base station. Screw the locking collars clockwise to secure the antennas in place.
- Connect a monitor to the HDMI port on the base station. The base station can also be connected to an audio system, and USB pointing devices such as mice and touchscreens.
- If desired, the base station may be connected to a wired network. Refer to the Installation and Administration Guide available from the ALOGIC website at www.alogic.co for important security considerations when connecting the base station to a corporate network.
The power adapter is supplied with four plugs to suit the power outlets in different countries. Choose the correct plug for your country and connect it to the power adapter by inserting into the opening and rotating into place.

4 Connect the power adapter to the base station and to a wall power outlet and ensure that the display is switched on. Once the base station has booted up and is ready for use, instructions will be shown on the display to guide users on how to show their computer on the display wirelessly.

- Connect to the IP address of the base station with a browser to change the name of the device and configure other settings. The default credentials to access the web configuration interface are as follows.

User: admin
Password: admin

It is recommended that the password is changed prior to using the device to avoid unauthorised access to the settings.

Using the Device (Refer to the images on page 4)

- Connect the included wireless presenter button to a USB-C port on a computer. The USB-C port used must support video output.

It may take up to 20 seconds for the button to start receiving video from the laptop and be ready to send it to the display when it is plugged in to the laptop. When the LED ring flashes blue and then stays solid blue it is ready to present.

Press the button to start showing the computer on the display. The LED ring will turn red to indicate that video is being sent. Press the button a second time to stop showing the computer on the display.

- Mobile devices can be shown on the display by using native screen casting from the device. The device supports AirPlay (iOS), Google Cast (Android) and Miracast (Windows/Android) for connecting to the display directly from these devices.

More than one device can connect to the wireless presenter at the same time. Up to two devices can be shown on screen at the same time, either using a connection button or by connecting directly.

Adding and Pairing Buttons

Up to 16 buttons may be used with each wireless presenter base station for instant switching between devices. Additional buttons are available for purchase separately (model WPA-BTN-1C).

Buttons added to the system must be paired with the base station by plugging them into the USB-C port on the front of the base station before they can be used. Existing buttons may also need to be paired with the base station if a significant configuration change occurs such as a firmware update having been applied.

To pair presenter buttons with the base station, connect the button to the USB-C port on the front of the base station. The button has successfully paired with the base station when the red light on the button illuminates and remains on.

Resetting the Device

To factory reset the device, press and hold the reset button for 5 seconds.

Troubleshooting

| Symptom | Resolution |
|---|--|
| Video breaks up or drops out | <ul style="list-style-type: none"> Verify that a good quality and fault free HDMI cable is used between the base station and display. Ensure that the video cable is as short as possible. Change the WiFi channels used by the base station from the web configuration interface to use quieter channels. Avoid using the same channels as other wireless presenters in adjacent rooms with overlapping signals. |
| Presenter button does not allow video to be sent to the display | <ul style="list-style-type: none"> Check that the computer's USB-C port supports video output. The presenter button can only send video to the display if the computer supports USB-C DisplayPort Alternate Mode video output. Some computers have multiple USB-C ports but only support video on one or two of the ports. Presenter button may need pairing with the base station; pair the button with the base station using the steps in the Adding and Pairing Buttons section. |
| Presenter button flashes blue continuously | <ul style="list-style-type: none"> Pair the button with the base station using the steps in the Adding and Pairing Buttons section. |
| Sound from a computer isn't heard when multiple computers are connected to the wireless presenter | <ul style="list-style-type: none"> Only sound from the last connected device will be heard when more than one device is connected. Disconnecting and reconnecting to the wireless presenter will make a device take precedence so that audio from that device is heard. |

5

6

Specifications

| | | |
|------------------------------------|---|------------------|
| Model | WPA-BASE-1CB – Wireless Presenter Base Station + 1 Button WPA-BTN-1C – Additional Wireless Presenter Button (Sold separately) | |
| Device Compatibility | <ul style="list-style-type: none">USB-C Button Connection: Compatible with all Windows, MacOS, ChromeOS computers that support USB-C DisplayPort Alternate Mode video output. | |
| Video Support | <ul style="list-style-type: none">Direct Connection: Supports direct connection from laptops and iOS/Android mobile devices using Airplay, Google Cast, Miracast and DLNA connections. Supports input resolutions up to 3840x2160 at 30Hz Supports the following output resolutions 3840x2160, 1920x1200, 1920x1080, 1280x720, 1024x768 | |
| Video Latency | 150ms | |
| Video Encoding | H.264, H.265 | |
| Audio Support | <ul style="list-style-type: none">Supports HDMI audio output Supports stereo analogue audio output via 3.5mm connector | |
| Audio Support | 1 x HDMI 2.0 display connection 2 x USB-A, supports HID input devices 1 x USB-C port; for pairing wireless presenter buttons only 1 x 3.5mm analogue audio output 1 x 100Base-T Ethernet | |
| Frequency Bands | 2.4GHz / 5Ghz | |
| Wireless Encryption | WPA2-PSK | |
| Wireless Range | Wireless transmission distance up to 30M (unobstructed) | |
| | Base Station | Presenter Button |
| Power | 12VDC 1A | USB-C, 5VDC <3W |
| Dimensions | 142 x 109 x 30mm | 159 x 62 x 17 mm |
| Weight | 333.8g | 67g |
| Environment Characteristics | <ul style="list-style-type: none">Operating Temperature 0°C to +35°C Operating Humidity 10% to 85% RH (no condensation) | |
| Compliance | CE, UKCA, RCM, RoHS, FCC. FCCID: 2ATCA-WPA-BASE, 2ATCA-WPA-BTN-C | |
| Warranty | 2 Years | |

7



注意事項

- 本装置は屋内での使用のみを目的としています。
- 装置を故意に損傷させたり、湿気のある場所、直射日光の当たる場所、高温になる場所に放置しないでください。
- 装置を分解したり、適切な使用方法やお手入れを怠った場合には、製品の保証が無効となります。
- ALOGICは、お客様の不適切な使用や不注意から生じた装置の破損や付随的な損害については、一切の責任を負いませんのでご了承ください。

تحذير

- هذا الحامل معد للاستخدام في الأماكن المغلقة فقط
- لا تقم بإتلاف الجهاز عمداً أو تعريضه للرطوبة أو لأشعة الشمس المباشرة أو لظروف درجات الحرارة المرتفعة
- سيؤدي تفكيك الجهاز أو الفتحيل في استخدامه استخداماً صحيحاً والعناية به إلى إبطال الضمان على المنتج
- أي مسؤولية عن تلف الجهاز أو الأضرار العرضية الناجمة عن الاستخدام غير السليم أو نقص الرعاية وليس مسؤولاً ALOGIC لا يتحمل عن إصلاح/استبدال الجهاز أو أي أضرار أخرى في هذه الظروف



Warning

Warning

- This device is designed for indoors use only.
- Do not deliberately damage the device or expose it to damp, direct sunlight, or high temperature conditions.
- Disassembling or failing to properly use and care for your device will void the warranty on the product.
- ALOGIC bears no responsibility for damage to the device or incidental damages arising from improper use or lack of care and is not liable for repair/replacement of the device or other damages in these circumstances.

Warnung

- Dieses Gerät ist nur für die Nutzung im Inneren vorgesehen.
- Beschädigen Sie das Gerät nicht absichtlich und setzen Sie es nicht Feuchtigkeit, direkter Sonneneinstrahlung oder hohen Temperaturen aus.
- Wenn Sie Ihr Gerät zerlegen oder nicht ordnungsgemäß verwenden und pflegen, erlischt die Garantie für das Produkt.
- ALOGIC übernimmt keine Verantwortung für Schäden am Gerät oder dessen Zubehör, die durch unsachgemäße Verwendung oder mangelnde Pflege entstehen, und haftet unter diesen Umständen nicht für die Reparatur / den Austausch des Geräts oder anderen Zubehörtteilen.

Advertencia

- Este dispositivo está diseñado para uso en interiores únicamente.
- No dañe deliberadamente el dispositivo ni lo exponga a la humedad, la luz solar directa o condiciones de alta temperatura.
- Desarmar o no usar y cuidar adecuadamente su dispositivo anulará la garantía del producto.
- ALOGIC no asume ninguna responsabilidad por daños al dispositivo o daños incidentales que surjan de un uso inadecuado o falta de cuidado y no es responsable de la reparación / reemplazo del dispositivo u otros daños en estas circunstancias.

Avertissement

- Ce produit est destiné à un usage en intérieur exclusivement.
- Ne pas endommager l'appareil délibérement ou bien l'exposer à l'humidité, la lumière directe du soleil, ou des températures élevées.
- Tout désassemblage ou utilisation malpropre de votre appareil entraînera l'annulation de votre garantie.
- ALOGIC ne sera pas tenu responsable des dommages causés à l'appareil, ou des dommages liés à une mauvaise utilisation ou un manque de soin et ne sera pas tenu d'assurer la réparation/le remplacement de l'appareil dans ces circonstances.

Avertissement

- Apparecchio da non usare all'aperto.
- Non danneggiare deliberatamente l'apparecchio, non esporlo a umidità, ai raggi diretti del sole o a temperature eccessivamente alte.
- Smontare, trattare o usare l'apparecchio in modo improprio annullerà la garanzia del prodotto.
- ALOGIC non si assume alcuna responsabilità per danni all'apparecchio o danni accidentali dovuti all'uso improprio o alla mancata attenzione, non ritenendosi responsabile per riparazione/sostituzione dell'apparecchio o per altri danni in queste circostanze.



UNITE 4K Wireless Presentation System



8

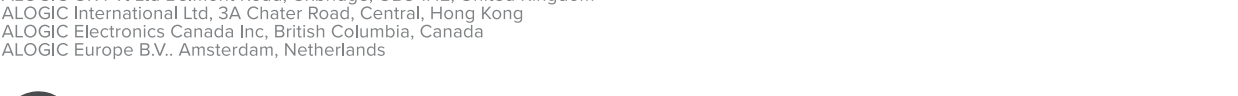
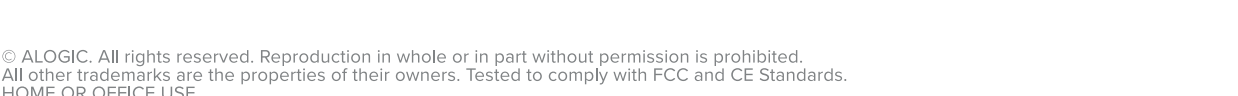
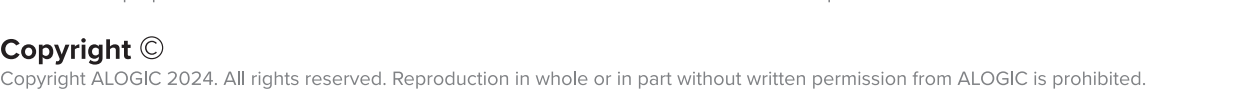
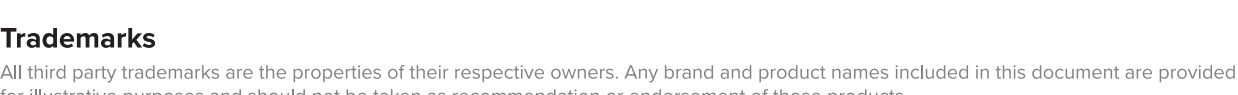
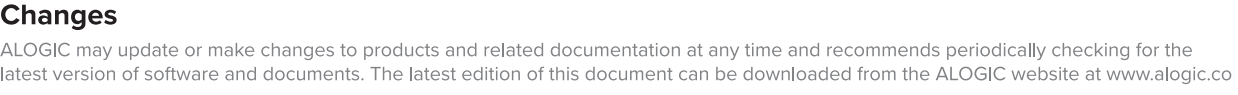
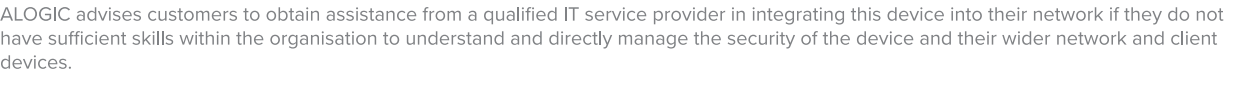
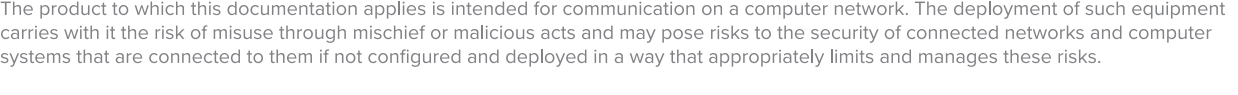
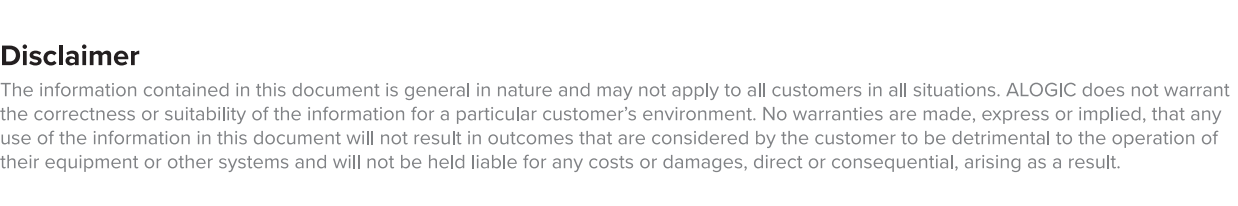

FCC Compliance Statement

This device complies with part 15 of the FCC Rules. Operation is subject to the following two conditions: (1) this device may not cause harmful interference, and (2) this device must accept any interference received, including interference that may cause undesired operation.

Note: This equipment has been tested and found to comply with the limits for a Class B digital device, pursuant to part 15 of the FCC Rules. These limits are designed to provide reasonable protection against harmful interference in a residential installation.

This equipment generates, uses, and can radiate radio frequency energy and, if not installed and used in accordance with the instructions, may cause harmful interference to radio communications. However, there is no guarantee that interference will not occur in a particular installation.

If this equipment does cause harmful interference to radio or television reception, which can be determined by turning the equipment off and on, the user is encouraged to try to correct the interference by one or more of the following measures:

- Reorient or relocate the receiving antenna.
- Increase the separation between the equipment and receiver.
- Connect the equipment to an outlet on a circuit different from that to which the receiver is connected.
- Consult the dealer or an experienced radio/TV technician for help.

Changes or modifications to this product not authorized by ALOGIC could void the electromagnetic compatibility (EMC) and wireless compliance and negate your authority to operate the product.

9

10