

Quick Start Guide

E50

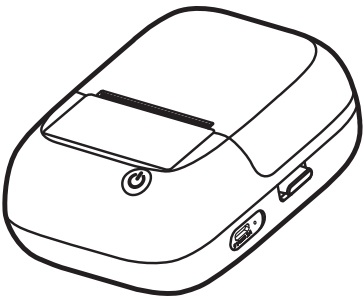

1. Download App and More Guide

1.1 Downloading the App

Method 1: Search for the "Print Master" app on App Store® or Google Play™ for download and installation.



Method 2: Scan the QR code to download the app.

You can scan the code using your cell phone's camera, the built-in QR code scanning feature of your browser, or a dedicated QR code scanning app.



As the Safari browser on Apple devices does not support direct QR code scanning, please use your device's built-in QR code scanner instead.

1.2 More Instructions

You can choose from the following methods to download the driver, check the detailed digital instructions which includes tutorial videos and access frequent questioned answers

Method1:Scan the QR code

You can scan the code using your cell phone's camera, the built-in QR code scanning feature of your browser, or a dedicated QR code scanning app. As the Safari browser on Apple devices does not support direct QR code scanning,please use your device's built-in QR code scanner instead.



Method 2: Visit <https://www.aimotech.cn/download/>



<https://www.aimotech.cn/download/>

2. Product Description

2.1 Packing List



Printer
×1



Quick Start Guide
×1

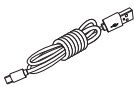

Type-C Cable
×1

2.2 Printer Parts

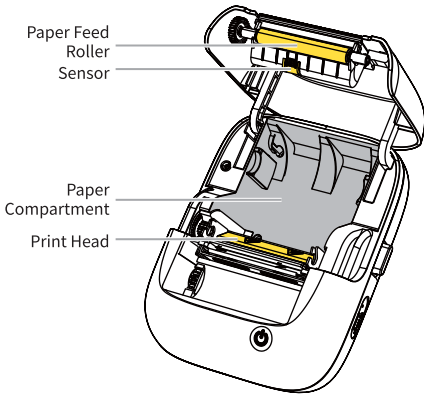
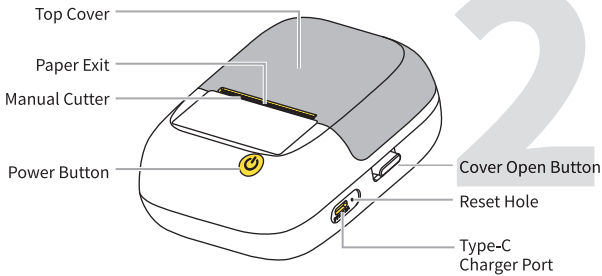

3. Quick Use

3.1 Install One-piece Consumable

01 Take new consumable

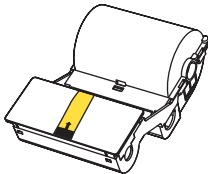

02 Press Cover Open Button

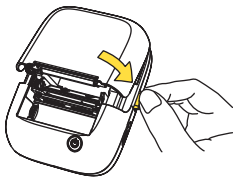

03 Remove the protective film

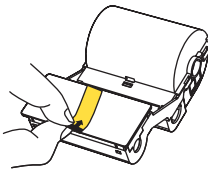

04 Place the consumable into Paper Compartment

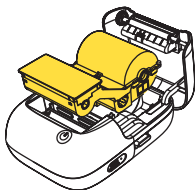

05 Pull the label paper out of the slot

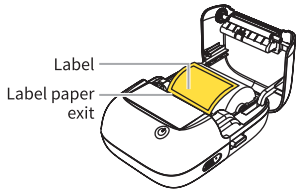

06 Close the Top Cover

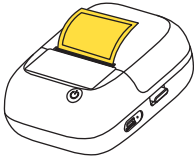

07 Long press Power Button for 3s to power on; click Feed Button to feed paper after the screen turn light

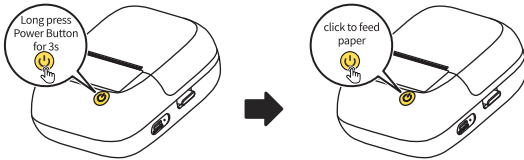

To install consumable when the power is on, click Feed Button to feed

4. Safety Instructions

4.1 Manual Cutter and Print Head Instructions

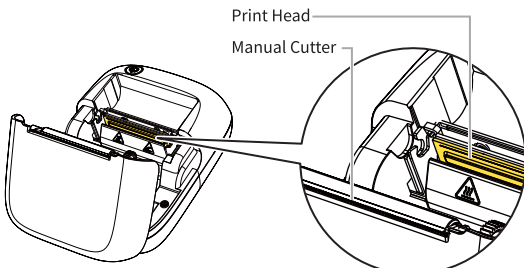

Manual Cutter Warning: This cutter has sharp edges. Do not touch the edges of the cutter.

Print Head Warning: The component can be HOT! Touching it when it is hot can cause burns to your fingers. Before you touch the Print Head, please wait for at least 30 minutes after turning off the printer.

4.2 Charging Instructions

- Please prepare your own power adapter (DC 5V/2A) with a Type-A port.
- Insert the Type-C end (flat end) of the USB cable into E50's Type-C Port; insert the Type-A end (wide end) of the USB cable into the Type-A port of the power adapter.
- When connected and plugged in, the printer's white indicator light shows it is charging.
- When the battery is depleted, charge for 20 minutes for quick usage. For a full charge, please charge for 2-3 hours or until the Indicator Light turns solid green.
- As the printer may heat up during charging, avoid placing it on materials such as cotton or linen. Once the battery is fully charged, please unplug the charger promptly.
- Once charged, please unplug the charger promptly.

Avoid using the printer while charging. Using the printer while charging may lead to reduced charging speed, compromised print quality, and shortened battery life. Please use 5V=2A power adapters for charging to avoid potential injuries led by fire, electric shock or burns.

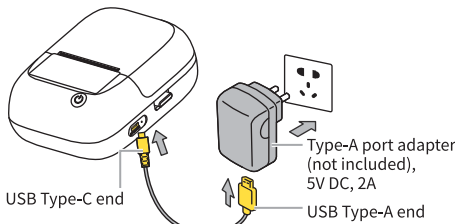

5. Operation Panel Instructions

5.1 Indicator Light Instructions

Light	Printer status
Solid white light	Standby/ Battery full when power on
White light flashes slowly	Battery being charged when power on
White light flashes quickly	Battery being charged when power off
Solid red light	Printer anomaly (due to cover open, overheating, lack of paper, paper jam, printing paused, memory error, etc.)
Red light flashes quickly	Battery level less than 20% while printer not being charged
Red light flashes slowly	Battery level less than 5% while printer not being charged

5.2 Button Instructions

Buttons	Operation	Function
Power Button/ Feed Button	Long press for 3s (when power off)	Power on
	Long press for 3s (when power on)	Power off
	Long press to restart (when power on)	Restart to calibrate Sensor
	Click (Cut Label)	Feed a label
	Click (Continuous Label)	Feed 20mm
	Click (When printing)	Pause printing
	Click (When print paused)	Resume printing
	Double-click (When print paused)	Cancel printing

6. Information to User

6.1 FCC WARNING

Note: This equipment has been tested and found to comply with the limits for a Class A digital device, pursuant to part 15 of the FCC Rules. These limits are designed to provide reasonable protection against harmful interference when the equipment is operated in a commercial environment. This equipment generates, uses, and can radiate radio frequency energy and, if not installed and used in accordance with the instruction manual, may cause harmful interference to radio communications. Operation of this equipment in a residential area is likely to cause harmful interference in which case the user will be required to correct the interference at his own expense.

This device complies with Part 15 of the FCC Rules. Operation is subject to the following two conditions:

- This device may not cause harmful interference, and
- This device must accept any interference received, including interference that may cause undesired operation.

Change or modifications not expressly approved by the manufacturer responsible for compliance could void the user's authority to operate the equipment.

6.2 ISED NOTICE(Canada)

CAN ICES(B)/NMB(B)

This device contains licence-exempt transmitter(s)/receiver(s) that comply with Innovation, Science and Economic Development Canada's licence-exempt RSS(s). Operation is subject to the following two conditions: 1.This device may not cause interference. 2. This device must accept any interference, including interference that may cause undesired operation of the device.

Cet appareil contient un émetteur (S)/ récepteur (S) exempté (S) de licence qui est conforme aux RSS(S) exemptés (S) de licence d' innovation, Science et développement économique Canada. Le fonctionnement est soumis aux deux conditions suivantes: 1. Cet appareil ne peut pas causer d' interférences. 2. Cet appareil doit accepter toute interférence, y compris les interférences qui peuvent causer un fonctionnement indésirable de l' appareil.

7. Warranty Card

Exchange

Return

Customer Information	Name
	Sex
	Phone No.
Product Information	Address
	Date of Purchase
	Order No.
Return/Exchange Form	Serial No.
	Reason for Return/Exchange

Special Notes

The company assumes full responsibility for the revision and explanation of this manual, exercising utmost diligence to guarantee its accuracy. Nevertheless, please note that any technical improvements to the product may not be separately notified, and that the images of the product, accessories, software interfaces, etc. in this manual serve solely as illustrations and references. Due to product updates and upgrades, the actual product may vary slightly from the images. Please refer to the physical product for accurate representations.