

# **User Manual**

## **Industrial PC**

**Model No.: PC-GS2192A-FGB**

# Disclaimer

This manual is authorized and belongs to ShenZhen Geshem, without permission, any unauthorized copying is forbidden. The content of this manual can't represent the commitment of Shenzhen Geshem, as the company continues to improve the products; the company has the right to modify this manual without further notice.

We have no responsibility for any direct/indirect/intentional or unintentional damages and potential problems caused by unsuitable installation and usage.

## **Guarantee Clause:**

The product has 12 months' warranty. If the user has special requirement, please do it as the contract signed by the two parties.

## **Trademarks:**

All the trademarks mentioned in this manual are registered trademarks of their respective companies.

Android® is the registered trademark of Google company.

Netware® is the registered trademark of Novell Inc.

# Safety Instruction

1. Please read the user manual carefully before using the product, and carefully keep it for future reference.
2. Before connecting power supply to the product, please confirm the voltage is compliant with the requirement of the device.
3. To avoid electric shock or damage to the product, please unplug the power cord from the socket before cleaning the device by wet rag.
4. Please do not use liquid or aerosol cleaner to clean up the device.
5. To avoid short circuit or fire, please do not let any liquid get into or splash into the product.
6. For a device which needs to use power cord, there must be an easy-to-reach power socket around the device.
7. Please do not use the product in a damp environment.
8. Before installation, please make sure the device is placed on a solid surface; accidental drop or tipping may cause malfunction or damage to the device.
9. Before you connect or unplug any signal cable, make sure all power cords are unplugged in advance.
10. To avoid unnecessary damage caused by frequent power-on/off, wait at least 30 seconds after turning off the computer before re-turning on the computer.
11. If the product will not be used for a long time, please disconnect the power cord, to avoid damage to the product by transient voltage.
12. If the product needs to be upgraded, installed or dismantled, please implement all the operation on an ESD workstation, for some precision devices are sensitive to ESD;
13. Ensure excellent heat dissipation and ventilation of the system.
14. Please do not open or dismantle the device by yourself. For the sake of safety, this device can only be opened by a professional maintenance person.

## Packing List

- A Fanless industrial computer with touch screen
- 1\*AC 100V~240V transferred to DC+12V/5A Power adapter
- 1\*AC 110V~240V to DC+12V/5A power adapter
- 1\*AC220V power cable
- 1\*Certification, 1\*packing list

# Contents

1. Product Introduction.....	1
1.1 Brief instruction.....	1
1.2 Product Specifications .....	2
1.3 I/O Interface.....	4
2. Application Planning .....	5
2.1 Transportation.....	5
2.2 Storage .....	5
2.3 Unpack and check the delivered equipment .....	6
3. Installation instruction .....	7
3.1 Product Photo.....	7
3.2 Drawing of Product Installation dimensions .....	8
3.3 Installation drawing.....	8
4. Product specification.....	10
4.1 Basic Software SPEC.....	10
4.2 Interface definition .....	10
4.3 Network interface.....	11
4.4 COM(RJ45) .....	11
4.5 Standard HDMI A type interface.....	12
4.6 Power interface .....	12
5. FCC Caution .....	13
5.1 FCC Caution.....	13

# 1. Product Introduction

---

## 1.1 Brief Introduction

PPC-GS0792T-FGB is a low-power-consumption, high-performance and Fanless embedded industrial computer, and its material is Al-Alloy front panel, and back panel Al-alloy for dissipation.

This product is with Cortex-A17 and the on-board RK3288 SoC Quad Core @ 1.8GHz processor, 2GB memory and 8GB eMMC storage, and it has rich I/O interfaces and it is with fully-sealed Fanless design, supporting Android 5.1. or above.

This product can be used in the field of mechanical equipment, Solar photovoltaic, Vehicle controlling and industrial automation (like paper-making, environment protection.etc) .

## 1.2 Product specifications

Item		Definition
Main Index	Processor	<ul style="list-style-type: none"> <li>RK3288 SoC Cortex-A17 Quad Core @ 1.8GHz Max.</li> </ul>
	Memory	<ul style="list-style-type: none"> <li>Standard 2GB DDR3</li> </ul>
	OS	<ul style="list-style-type: none"> <li>Google Android 5.1 or Above</li> </ul>
	Storage	<ul style="list-style-type: none"> <li>EMMC 8GB/16GB/32GB select (standard 8GB) , NAND Flash compatible</li> </ul>
	Network Function	<ul style="list-style-type: none"> <li>1*RJ45 1000M LAN</li> <li>Include BT+WIFI module, support Wi-Fi 802.11a/b/g/n/ac, 2.4G/5G dual band, Support BT 4.0 dual antenna</li> </ul>
	Audio	<ul style="list-style-type: none"> <li>1*Line out</li> </ul>
	LED display features	<ul style="list-style-type: none"> <li>Display: 7" TFT LED</li> <li>Resolution: 7"---1280*800;</li> <li>Brightness: 7"---1000cd/m<sup>2</sup></li> <li>可视 Visual Angle (CR≥10)</li> <li>Horizontal Level: 80°~80°; Vertical: 80°~80°</li> </ul>
	Touch Screen	<ul style="list-style-type: none"> <li>Connection: USB</li> <li>Type :Multi-points Capacitive touch</li> </ul>
Main Function	I/O	<ul style="list-style-type: none"> <li>Provide 4 COM(RJ45 output): COM1(RS232) , COM2(RS232) , COM3(RS232) , COM4 (RS232) COM:4*RS232 (RJ45)</li> <li>2*USB</li> <li>1*1000M LAN</li> <li>1*HDMI</li> <li>1*audio in/ out</li> <li>1*TF Card slot</li> </ul>
	Dimensions	<ul style="list-style-type: none"> <li>186mm (L) ×135mm (W) ×52.2mm (H) ;</li> </ul>
Main Function	Mechanical	<ul style="list-style-type: none"> <li>Housing: Aluminium alloy with blasting oxidation surface treatment</li> <li>Color:Black</li> <li>Heat conduction:Al-alloy body with heat conduction design</li> <li>Material: high-density al-alloy cooling panel</li> </ul>

Item		Definition
	<b>Weight</b>	<ul style="list-style-type: none"> <li>PC-GS2192A-FGB: N/W: 1.1Kg; G/W: 1.9Kg</li> </ul>
	<b>TEMP</b>	<ul style="list-style-type: none"> <li>Operation temperature:-10℃～50℃ with air flow</li> <li>Storage temperature:-20℃～60℃</li> </ul>
	<b>Humidity</b>	<ul style="list-style-type: none"> <li>95% @40℃ ( non-condensing)</li> </ul>
	<b>EMC</b>	<ul style="list-style-type: none"> <li>Meet GB9254 Level A</li> <li>Meet GB/T 17618</li> </ul>
	<b>RELIABILITY</b>	<ul style="list-style-type: none"> <li>MTBF≥5000h</li> <li>MTTR≤0.5h</li> </ul>
	<b>Safety</b>	<ul style="list-style-type: none"> <li>Meet basic requirement of GB4943</li> </ul>
	<b>Protection Level</b>	<ul style="list-style-type: none"> <li>Front Panel IP65(Optional)</li> </ul>
	<b>ENVIRONMENT</b>	<ul style="list-style-type: none"> <li>Anti-vibration: 5-19Hz/1.0mmamplitude; 19-200Hz/1.0g acceleration</li> <li>Anti-Shock: Acceleration 10g,11ms duration;</li> </ul>
	<b>Power feature</b>	<ul style="list-style-type: none"> <li>Input Volt/Freq: 100～240VAC/50～60Hz (Adapter);</li> <li>Input Volt/Current: 12V DC (Optional without adapter);</li> <li>Power 7.2W(standby), 13.2W(rated)</li> </ul>
<b>Hardware Version</b>		<ul style="list-style-type: none"> <li>TVI3001U-V1.31</li> </ul>
<b>Software Version</b>		<ul style="list-style-type: none"> <li>rk3288-userdebug 5.1.1LMY49F harri3 20190221.120035 test-keys</li> </ul>



## 1.3 I/O Interface Introduction



## 2. Application Planning

---

### 2.1 Transportation

Well-packaged products are suited for transportation by truck, ship, and plane. During transportation, products should not be put in open cabin or carriage. During transshipping, products should not be stored in open air without protection from the atmospheric conditions. Products should not be transported together with inflammable, explosive and corrosive substances and are not allowed to be exposed to rain, snow and liquid substances and mechanical force.

### 2.2 Storage Requirements

Products should be stored in package box when it is not used. And warehouse temperature should be 0°C~40 °C, and relative humidity should be 20% ~ 85%. In the warehouse, there should be no harmful gas, inflammable, explosive products, and corrosive chemical products, and strong mechanical vibration, shock and strong magnetic field interference. The package box should be at least 10cm above ground, and 50cm away from wall, thermal source, window and air inlet

#### Caution!

Risk of destroying the device!

When shipping the PC in cold weather, please pay attention to the extreme temperature variation. Under this circumstance, please make sure no water drop (condensation) is formed on the surface or interior of the device. If condensation is formed on the device, please wait for over twelve hours before connecting the device.

## 2.3 Unpack and check the delivered equipment

### Unpack the equipment

**Pay attention to the following things when you unpack the equipment.**

- Please take the advice not to throw away the original packaging material and please retain to use it when the equipment should be transported again.
- Please put the document in a safe place. It will be used in the initial adjustment of equipment and it is a part of the equipment.
- When you check the delivered equipment, please check whether it is obviously damaged during the transportation.
- Please check whether the delivered parcel includes the whole equipment and the accessories you ordered separately. If there is any discrepancy or damaged during transportation, please contact our customer-service staff

### 3. Installation Instructions

#### 3.1 Product photo



Photo 3-1

### 3.2 Product Image & Dimensions Drawing

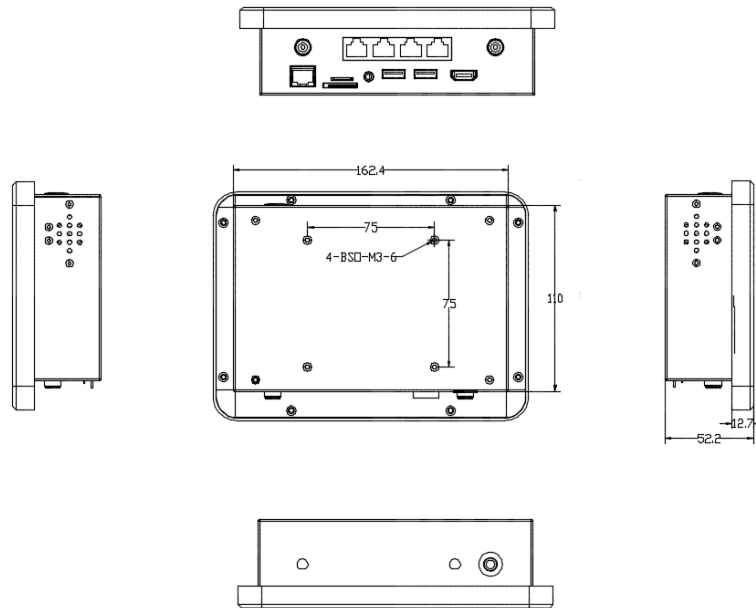
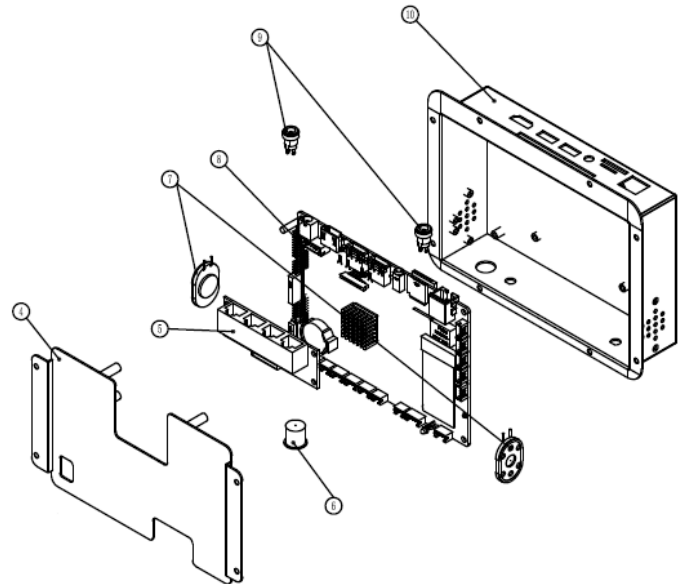

photo 3-2

### 3.3 Installation Sketch



			4. Screen bracket
5.RJ45 COM Plate	6.ON/OFF button	7.Speaker	8. Mother board
9.Power	10. Back cover		

## 4. Product Specification

### 4.1 Basic software Specification

OS	Google Android 5.1 and above
Basic software function	Camera, web browser, Online chat ,e-mail,E-book,Resource manager
音 Sound Mode	Calendar,Clock, Calculator, recording
Language support	Multiple language
Recording	Support MP3,WMA format
TOOL	Calendar/Alarm Clock/calculator/notes/weather+ clock/recording
Word processing	EPUB, WORD, EXCEL, POWERPOINT, PDF, TXT
E-book	PDF/TXT/CHM/DOC/EXCEL/EPUB/RTF/FB2
Input method	Standard Andriod key-board, Optional third-input (optional Chinese, Korean,Japanese etc.)
Net	Browser –ChromeLite/GOOGLE Market/Email/Gmail/Google talk
System management	APK installer, Original Android system, open root authority, support ODM development /System setting/google Maps/global time/support OTA remote-upgrade

### 4.2 Interface definition

1.This device provides 2\*USB 2.0, and definition as below:

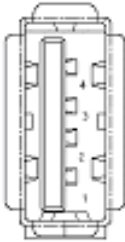
 USB1~2	USB2.0	Signal
	1	5V
	2	D-
	3	D+
	4	GND

### 4.3 Network interface

1\*1000M LAN interface, definition as below

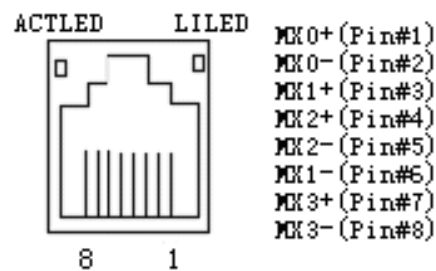

LAN

ACTLED (Single Green Light)	Network status	LILED (Double: Green/Orange)	Network Speed
		Green	1000Mbps
Twinkle	data transmission	Orange	100Mbps
Light Off	No data transmission	Light Off	10Mbps

### 4.4 COM definition (RJ45 output)

This device provides 4\*RS232 Definition as below

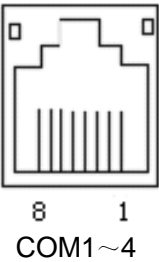
	PIN	Signal
		RS-232
	1	NC
	2	NC
	3	GND
	4	RXD
	5	GND
	6	5V
	7	TXD
	8	5V

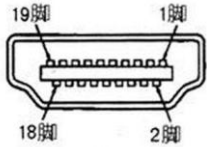

## 4.5 Standard HDMI A Type interface

 <p>HDMI</p>	PIN	Signal	PIN	Signal
	1	DATA2+	2	DATA2shielding
	3	DATA2-	4	DATA1+
	5	DATA1 shielding	6	DATA1-
	7	DATA0+	8	DATA0shielding
	9	DATA0-	10	DATA1_CK+
	11	DATA1_CKshielding	12	DATA1_CK-
	13	CEC	14	Reserved
	15	SCL (DDC clock)	16	SDA (DDC data)
	17	DCC/CEC GND	18	+5V
	19	Hot swap check	/	

## 4.6 Power interface

This device support DC +12V power input, can with power adapter, definition as below

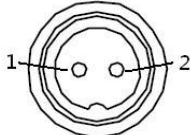
 <p>DC12V input</p>	PIN	Signal
	1	+12V
	2	GND

## 5. FCC Caution

---

### 5.1 FCC Caution

This device complies with part 15 of the FCC Rules. Operation is subject to the following two conditions: (1) this device may not cause harmful interference, and (2) this device must accept any interference received, including interference that may cause undesired operation.

Any changes or modifications not expressly approved by the party responsible for compliance could void the user's authority to operate the equipment.

NOTE: This equipment has been tested and found to comply with the limits for a Class B digital device, pursuant to Part 15 of the FCC Rules. These limits are designed to provide reasonable protection against harmful interference in a residential installation. This equipment generates, uses and can radiate radio frequency energy and, if not installed and used in accordance with the instructions, may cause harmful interference to radio communications. However, there is no guarantee that interference will not occur in a particular installation.

If this equipment does cause harmful interference to radio or television reception, which can be determined by turning the equipment off and on, the user is encouraged to try to correct the interference by one or more of the following measures:

- Reorient or relocate the receiving antenna.
- Increase the separation between the equipment and receiver.
- Connect the equipment into an outlet on a circuit different from that to which the receiver is connected.
- Consult the dealer or an experienced radio/TV technician for help.

To maintain compliance with FCC's RF Exposure guidelines, This equipment should be installed and operated with minimum distance between 20cm the radiator your body: Use only the supplied antenna.

FCC ID: 2AQR9PCGS2192AFGB