

Remote control your FoxShot via Mobile Device

Select Foxshot Wi-Fi

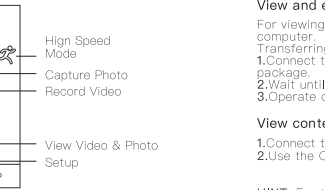

Control With Phone



⚠ When multiple Foxshot cameras are detected, to carefully select the Wi-Fi name of which you want to connect.

View & Export Contents

View and export contents on computers

For viewing videos and photos on computers, please first transfer the files into the computer.

1. Connect the camera with computer with the included USB cable comes with the package.
2. Wait until computer recognize the camera as a USB disk
3. Operate on screen to view and export videos or photos.

View contents on mobile devices

1. Connect the camera with Foxshot APP.
2. Use the Control function in the APP to view contents on smartphones.

HINT: For transferring the files into the computer with card readers (sold separately) and the file manager of computers, please connect your card reader with the computer then insert the TF card. Then you can transfer the files into the computer or delete selected files in the memory card.

Fix Your Foxshot Camera

Fix it with gel stickers

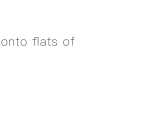

With gel stickers, you can equip the camera onto flats of helmets, automobiles and other equipment.

- Please follow the guidelines:
- Adhesive mounts can only be equipped onto smooth surfaces. They cannot work on porous or grained surfaces. Press hard until the mount is fixed to ensure the mount and the surface are closely bonded.
 - Adhesive mounts can only be equipped onto clean surfaces. Wax, oil, dust or other debris might reduce the stickness and affect the fastness of the mount. Once the mount gets loose, the camera might be lost.
 - Please equip the adhesive mount at room temperature. Equipping it onto icy or moist surfaces in cold or wet environment might lead to adhesive's failure.
 - Read national and local laws and regulations to make sure it is allowed to equip the camera on specific equipment (eg. Hunting equipment). Abide by the regulations restricting the use of consumer electronics.

Fix your foxshot with other accessories

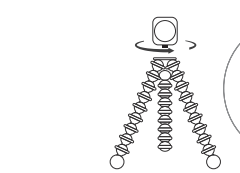

With gel stickers, you can equip the camera onto flats of helmets, automobiles and other equipment.

Accessory available at getfoxshot.com
Make your Foxshot truly versatile.

Clearing of Faults

I can't turn on my Foxshot

Please make sure that you have charged your Foxshot. To charge your camera, please use the included USB cable comes with the package to connect the camera with your computer, or you can use charging equipment made by Foxshot.

Foxshot won't work when I press the button

If the system crashes, long press the power button for 15 seconds to 20 seconds, then it will restart. It will save all your contents and settings in this way.

I forget the Wi-Fi password of Foxshot.

The default Wi-Fi password of Foxshot is 12345678. If you forget the password after changing the default one, please contact our customer service hi@getfoxshot.com

How to turn off Foxshot

If being charged with adapters, Foxshot will go off automatically when recording stops. When connected with mobile App via Wi-Fi, long press the power button will not turn it off. Only after switching off Wi-Fi, will the long press work.

My Foxshot cannot be charged

Please make sure your USB cable works well. The green light of the camera turns on when activated by computers, then the red light will keep on showing while the camera is being charged. When it is full charged, the red light turns off, you can turn off the camera to turn off the green light. When being charged via chargers, the camera goes off automatically if not recording.

My Foxshot cannot record while being charged

Foxshot can record while being charged, but it doesn't record under the condition of ① The TF card is full ② Computer reads Foxshot as a USB disk.

My Foxshot cannot be recognized when being connected to the computer

Please make sure you are using an USB cable with data transfer function. When there is no power left in Foxshot, you need to charge it until it can be turned on without chargers, then try to connect it again.

I can't connect APP with Foxshot

Please make sure you have turned on Wi-Fi of the camera properly where the blue indicator blinks. Long press the Wi-Fi button will switch to photo mode, so just short press the button to turn on or turn off Wi-Fi. When APP is disconnected with the camera for 5 minutes, Wi-Fi of Foxshot will go off automatically. You need to turn on Wi-Fi of the camera for connecting again.

The video stutters when being played on the computer

It is not the problem of files if the video stutters. The following reasons might explain: Incompatible video player: not all video players support Codec H.264. Please use the latest video player for the best performance. The computer fails to meet the minimum requirement of HD display. The higher the resolution and frame rate of the video, the more resources consumed for playback on the computer. Please make sure your computer meets the minimum requirement listed by playback software. If your computer cannot meet the requirement, please choose 720p30FPS when recording and make sure all other programs on the computer have been shut down.

FCC Statement

This equipment has been tested and found to comply with the limits for a Class B digital device, pursuant to part 15 of the FCC Rules.

These limits are designed to provide reasonable protection against harmful interference in a residential installation. This equipment generates, uses and can radiate radio frequency energy and, if not installed and used in accordance with the instructions, may cause harmful interference to radio communications.

However, there is no guarantee that interference will not occur in a particular installation. If this equipment does cause harmful interference to radio or television reception, which can be determined by turning the equipment off and on, the user is encouraged to try to correct the interference by one or more of the following measures:

- Reorient or relocate the receiving antenna.
- Increase the separation between the equipment and receiver.
- Connect the equipment into an outlet on a circuit different from that to which the receiver is connected.
- Consult the dealer or an experienced radio/TV technician for help.

RF Exposure Information

The device has been evaluated to meet general RF exposure requirement. The device can be used in portable exposure condition without restriction.

Get more details of Foxshot camera from the link:
<http://www.getfoxshot.com/home>

RoHS CE FC X R

12

13

14

15

16

17

18

19

20

What is Foxshot?

Foxshot is a small Water-Resistant Camera that can be attached to any surface. Foxshot is also versatile with characteristics such as wearable, polychrome, HD 1080P, magnetic sticking, and live stream video(with Foxshot app). Make your own kind of stickers and capture your diverse stories with Foxshot.

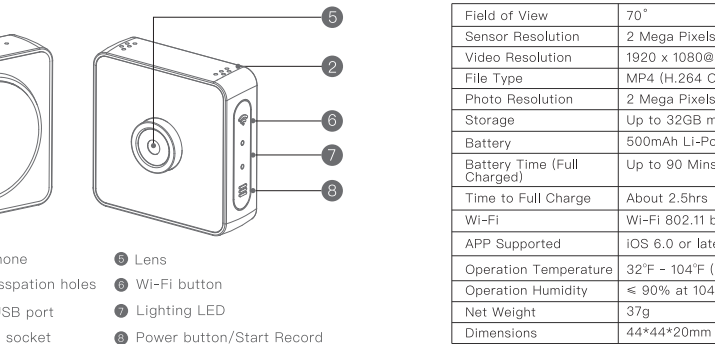

- 1 Microphone
- 2 Heat dissipation holes
- 3 Micro USB port
- 4 TF card socket
- 5 Lens
- 6 Wi-Fi button
- 7 Lighting LED
- 8 Power button/Start Record

2

Field of View	70°
Sensor Resolution	2 Mega Pixels
Video Resolution	1920 x 1080@30 fps
File Type	MP4 (H.264 Codec)
Photo Resolution	2 Mega Pixels
Storage	Up to 32GB micro SD (not included)
Battery	500mAh Li-Polymer Rechargeable Battery
Battery Time (Full Charged)	Up to 90 Mins (Wi-Fi Off)
Time to Full Charge	About 2.5hrs
Wi-Fi	Wi-Fi 802.11 b/g/n 2.4GHz
APP Supported	iOS 6.0 or later, Android 4.3 or later
Operation Temperature	32°F - 104°F (0°C - 40°C)
Operation Humidity	≤ 90% at 104°F (40°C)
Net Weight	37g
Dimensions	44*44*20mm

3

CHARGING THE BATTERY

For the best experience with your new camera, we recommend fully charging the battery before first use.

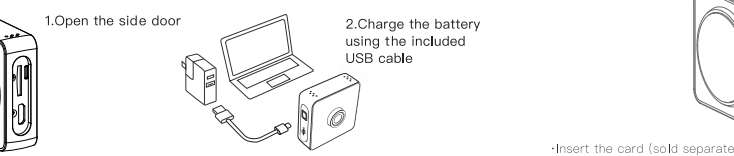

- ⚠ The battery cannot be removed from the camera. Please use the included USB cable originally comes with the package, cable from other sources might be unable to charge the battery. Only chargers with output rating within 5V 1A are allowed. So try to charge with your laptop's USB port or adapter. The camera status lights turn on during charging and turn off when charging is complete. When charging with a computer, be sure that the computer is connected to a power source. If the camera status light does not turn on, use a different USB port. The battery gets full charged in about 2.5 hours.
- ⚠ Foxshot is not water resistant when the controls cover is open.

4

INSERTING + REMOVING TF CARDS



- ⚠ Use carefully when handling memory cards. Avoid liquids, dust, and debris. As a precaution, power off the camera before inserting or removing the card. Check manufacturer guidelines regarding use in acceptable temperature ranges.

5

CLEANING + REPLACING GEL

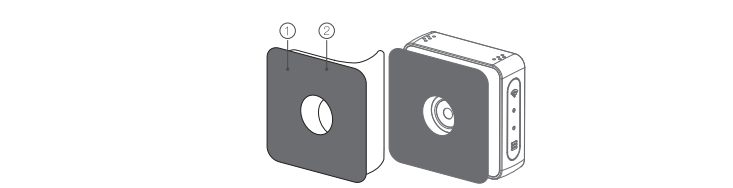

- 1. Take out the gel sticker comes with the package.
- 2. Remove the white layer (1) of the sticker.
- 3. Attach the layer (2) and layer (3) hard in the back of FoxShot.
- 4. Remove the lucid layer (3).

6

STICK THE DECORATIVE STICKER

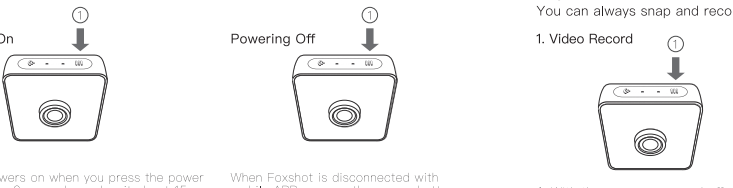

- 1. Take out the decorative sticker comes with the package.
- 2. Remove the white layer (1) of the sticker.
- 3. Attach the sticker (1) in the front of FoxShot.

7

POWERING ON + OFF

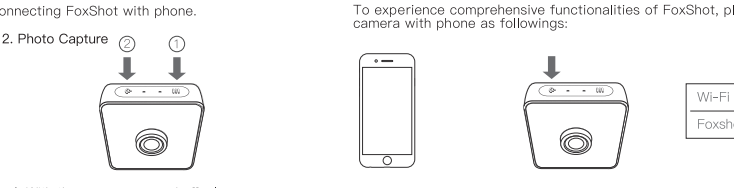

- ⚠ The green LED will be on and buzz bee once.
- ⚠ Please aware your FoxShot is charged with enough power remaining.

8

Capture Video/Photo

You can always snap and record without connecting FoxShot with phone.



- 1. With the camera powered off, please first turn on FoxShot (see Powering on and off), and short press the power button (1) to begin recording. The camera status lights blink while the camera is recording.
- 2. With the camera powered on, short press the power button (1) to start recording video. The camera status lights blink while the camera is recording.
- 3. To stop recording, press the power button (1) again.

9

Connect with Phone

To experience comprehensive functionalities of FoxShot, please connect your camera with phone as followings:

- ⚠ Please wait for 15 seconds to fully activate Wi-Fi with the camera powered on.
- ⚠ Search FoxShot on Google Play or App Store for the newest version of FoxShot App.
- ⚠ System requirements of phone Android 4.3+ and above iOS 7

10

Download App

To experience comprehensive functionalities of FoxShot, please connect your camera with phone as followings:

- ⚠ Please wait for 15 seconds to fully activate Wi-Fi with the camera powered on.
- ⚠ Search FoxShot on Google Play or App Store for the newest version of FoxShot App.
- ⚠ System requirements of phone Android 4.3+ and above iOS 7

11