



cat2see  
smart technology for cats

## user manual smart waterer

### 3 add your cats

A. Manage your cats by navigating to 'Settings' from the bottom panel in the main screen.

B. Tap on the 'Add New Cat' button to add your cats. It is recommended that you fill up accurate information as much as possible in order to track the recommended amount of the daily hydration that matches your cat's physical characteristics

### 1 open an account

A. Install Cat2See app from the Google Play Store if you have an Android device. For Apple devices, install it from the AppStore. Finally launch the app.

B. Register a new account by tapping on the **Create one** button at the bottom.

C. Fill the 'Register' form with your full name, age and gender. Enter your E-mail address that will be associated with your account and choose a password with minimum 8 characters. Browse a photo which will appear to other users as your profile photo.

### 2 connect smart waterer

A. From the main screen, tap the 'Connect to Cat Water Dispenser' button to start the wizard, then tap 'Next'.



B. Open the batteries cover and insert 4 AAA batteries into the battery compartment and close the plastic cover. Tap 'Next' to proceed.



C. Turn on the waterer by locating the power switch button at the back of the waterer. Then press and hold the button for 2 seconds until you see a blinking blue light. Tap 'Next' to proceed.



D. Make sure that only one (disconnected) waterer is turned on. If you have other waterers which you've already connected, it's ok, you can keep them turned on.



### 4 fill with fresh water

A. Carefully lift the waterer from the floor and spill out the remaining water from the bowl into your kitchen sink.

B. In case there is still water in the container, flip the whole waterer up side down (above the sink), twist to open the container from the bottle neck and spill the remaining water. Do not attempt to twist or pull out the blue cover. The cover is permanently attached to the bottle in order to preserve its internal air pressure allowing the waterer to function properly.

C. Keep the bowl in a dry area before filling with water.

D. Flip the bowl and place it on top of the container while both parts are turned up side down, then screw them together.

E. Flip the bowl back while using your finger to block the water from flowing through the nozzle until the waterer is positioned on the floor.

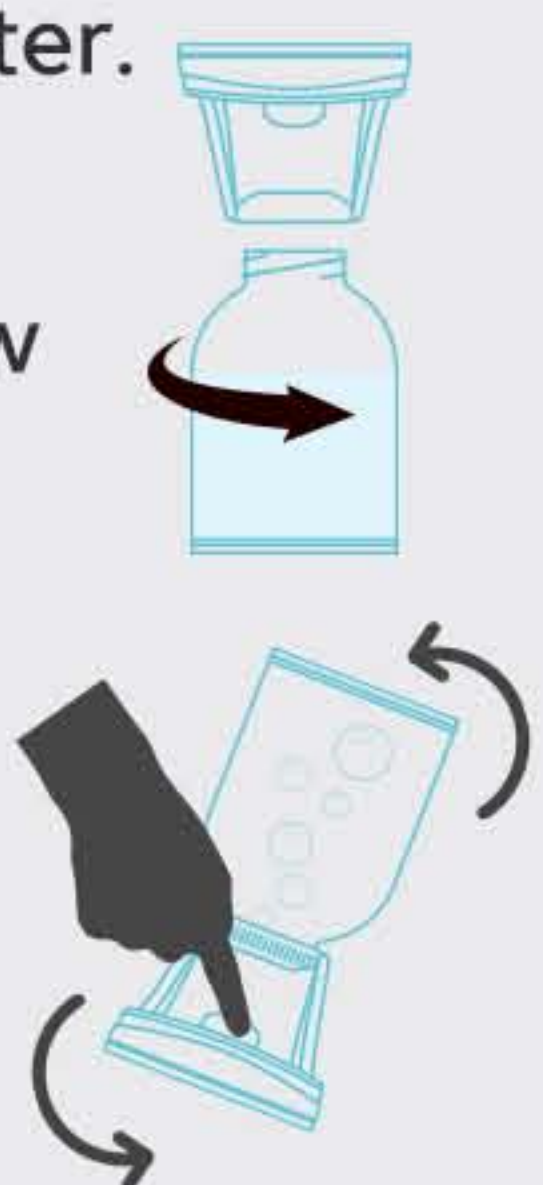

### 5 control water oxidation

A. Trigger oxidation on demand by tapping the oxidation button.



B. Turn on or off automatic oxidation from the details section. Finally tap on 'Save'.

**ENSURE THAT ENVIRONMENTAL CONDITIONS ARE MAINTAINED. FAILURE TO FOLLOW THESE CARE INSTRUCTIONS MAY VOID THE WARRANTY:**

A. Keep away from wet areas or wet floor.

B. Use the waterer with fresh water only. Do not use with other liquids.

C. Do not attempt to **OPEN / TWIST** the container's cover. Such attempt will cause irreversible damage to the waterer.

D. Use the Cat2See app occasionally to check for battery level using the battery notifications.



## FCC statement

This device complies with Part 15 of the FCC Rules. Operation is subject to the following two conditions: (1) This device may not cause harmful interference, and (2) this device must accept any interference received, including interference that may cause undesired operation.

Caution: Changes or modifications not expressly approved by the party responsible for compliance could void the user's authority to operate the equipment.

NOTE: This equipment has been tested and found to comply with the limits for a Class B digital device, pursuant to part 15 of the FCC Rules. These limits are designed to provide reasonable protection against harmful interference in a residential installation. This equipment generates, uses and can radiate radio frequency energy and, if not installed and used in accordance with the instructions, may cause harmful interference to radio communications. However, there is no guarantee that interference will not occur in a particular installation. If this equipment does cause harmful interference to radio or television reception, which can be determined by turning the equipment off and on, the user is encouraged to try to correct the interference by one or more of the following measures:

- Reorient or relocate the receiving antenna.
- Increase the separation between the equipment and receiver.
- Connect the equipment into an outlet on a circuit different from that to which the receiver is connected.
- Consult the dealer or an experienced radio/TV technician for help.