

Mirarobot

S60 FPV



INSTRUCTION MANUAL

WARNING

Please read the **ENTIRE** instruction manual to become familiar with the features of the product before operating. Failure to operate the product correctly can result in damage to the product, personal property and cause serious injury.

This is a sophisticated hobby product. It must be operated with caution and common sense and requires some basic mechanical ability. Failure to operate this product in a safe and responsible manner could result in injury or damage to the product or other property. This product is not intended for use by children without direct adult supervision. Do not attempt disassembly, use with incompatible components or augment product in any way without the approval of Wuxi Mirarobot Science & Technology Co., Ltd. This manual contains instructions for safety, operation and maintenance. It is essential to read and follow all the instructions and warnings in the manual, prior to assembly, setup or use, in order to operate correctly and avoid damage or serious injury.

Age Recommendation: Not for children under 14 years. This is not a toy.

NOTICE: All instructions, warranties and other collateral documents are subject to change at the sole discretion of Wuxi Mirarobot Science & Technology Co., Ltd. For up-to-date product literature, visit www.mirarobot.com.

MEANING OF SAFETY SIGNAL WORDS

The following terms are used throughout the product literature to indicate various levels of potential harm when operating this product:

- **NOTICE:** Procedures, which if not properly followed, create a possibility of physical property damage AND a little or no possibility of injury.
- **CAUTION:** Procedures, which if not properly followed, create the probability of physical property damage AND a possibility of serious injury.
- **WARNING:** Procedures, which if not properly followed, create the probability of property damage, collateral damage, and serious injury OR create a high probability of superficial injury.

GENERAL PRODUCT SAFETY PRECAUTIONS

- Keep all batteries, chemicals, small parts and anything electrical out of the reach of children.
- Avoid water exposure to this product. Keep parts dry.
- Keep moving parts clean.

OPERATING SAFETY PRECAUTIONS

- As the user of this product, you are responsible for operating it safely, not endangering yourself and others, or damaging the product or the property of others.
- Operate your product in open spaces away from people and property.
- **NEVER** operate your product with damaged electrical components.
- Keep the transmitter powered on while model is powered on.
- Let parts cool after use before touching, motors will get hot in use.
- Remove batteries after use, as applicable.

CONTENTS

- Airframe x1
- Motors-6mm Brushed x 4
- On-board Electronics/Gyro x1
- Battery-200mAh 1S 3.7V 40C Li-Po x1
- Charger-1S USB Li-Po Charger, 200mAh x1
- Transmitter x1
- AA Battery x3

SPECIFICATIONS

- Length: 83mm (3.26in)
- Height: 28mm (1.10in)

- Propeller Diameter: 65mm (2.56in)
- Flying Weight: 27g (0.95oz)

CHARGING WARNINGS

 **Failure to comply with the following warnings could result in product malfunction, electrical issues, excessive heat, FIRE, and ultimate injury and property damage.**

- **NEVER** leave charging batteries unattended.
- **NEVER** charge batteries overnight.
- **NEVER** charge damaged batteries, if the battery begins to swell during charging or use, discontinue immediately.
- **ALWAYS** use included battery and charger.
- Disconnect the battery after charging.
- Charge batteries away from flammable materials in a well-ventilated area.
- **NEVER** charge, transport, or store batteries in hot, cold, or very sunny places. (recommended between 41-104°F or 5-40°C).

CHARGE THE FLIGHT BATTERY

- **NOTICE:** Inspect the battery to make sure it is not damaged e.g., swollen, bent, broken or punctured. Charge only batteries that are cool to the touch and are not damaged.
- ◆ Insert the charger into a USB port.
- ◆ Connect the battery to the charger.
- ◆ Disconnect the flight battery from the charger immediately upon completion of

charging.

Charging (Solid red LED)

Charge Done (LED OFF)

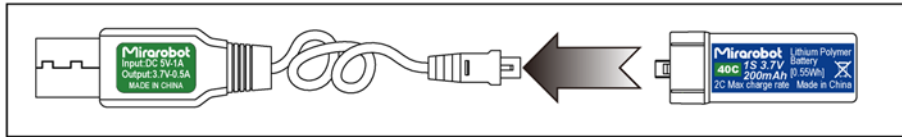

⚠ CAUTION

- Only use chargers specifically designed to charge the included Li-Po battery. Failure to do so could result in fire, causing injury or property damage.
- **NEVER** exceed the recommended charge rate.
- Once charging is complete, immediately remove the battery.
- **NEVER** leave a battery connected to the charger.

INSTALL THE TRANSMITTER BATTERIES

Install 3 AA batteries into the transmitter, noting polarity. Replace the transmitter batteries when the power LED flashes and the transmitter beeps. We recommend using only alkaline AA batteries in the transmitter.

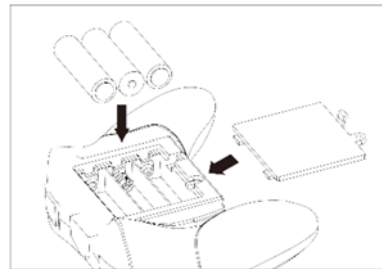

INSTALL THE FLIGHT BATTERY

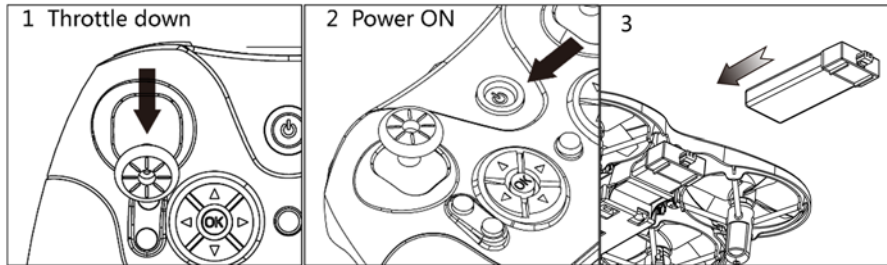

⚠ CAUTION

Always disconnect the Li-Po battery from the drone when not flying to avoid over-discharging the battery. Batteries discharged to a voltage lower than the lowest approved voltage may become damaged, resulting in loss of performance and potential fire when the batteries are charged.

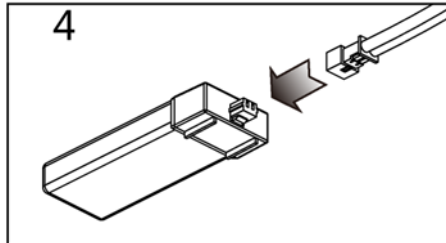

TRANSMITTER AND RECEIVER BINDING

Your RTF Transmitter comes pre-bound. However, if you need to re-bind, follow the directions below.

1. Place the drone flat on the floor and then plug in the battery. Green light will briefly flash.
2. When the remote controller is off, press the binding key (upper left corner G) and then turn ON the remote controller (press the power button) release the binding key. Then, bind successfully.
3. The green light flashes in two seconds to represent the normal reception data.
4. Auto-calibration: When you set the drone on a flat surface, the red LED's will flash briefly, as it calibrates the accelerometers. If you are moving or holding the drone, it will not calibrate until you set it down.

Note: You do not need to do it again once the binding is successful. Power on the remote controller then connected to the battery.

Arming the motors: Put the drone on the floor. Move the throttle down and wait for the red LED to flash.

TRANSMITTER CONTROL

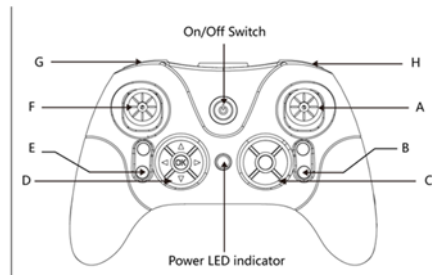

A	C	D	F	G	H
Aileron (Left/Right)	Trim adjustment	Trim adjustment	Rudder (Left/Right)	Bind button	Mode switch
Pitch rudder (Front/Rear)			Throttle (Up/Down)		

Flight Mode Selection

Stability mode (red LED): The bank angle is limited. The quadcopter will turn back to level flight when the sticks are released.

Agility mode (no LED): The angular velocity is controllable and the quadcopter won't turn back to level flight when the sticks are released.

NOTICE: Do not attempt to change flight modes while flying with the

transmitter. Attempting to do so will cause the transmitter to register a faulty center position. Always land the quadcopter and release the sticks before changing flight modes.

UNDERSTAND THE PRIMARY FLIGHT CONTROLS

If you are not familiar with the controls of your quadcopter, take a few minutes to familiarize yourself with them before attempting your first flight.

Throttle

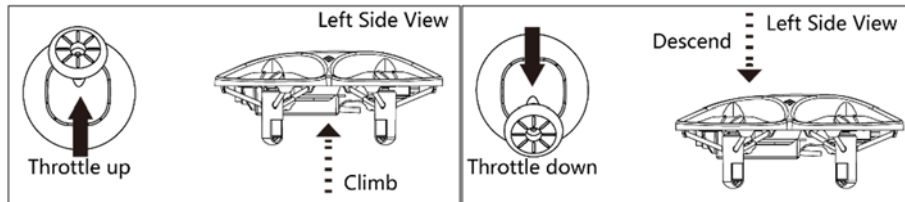

Rudder

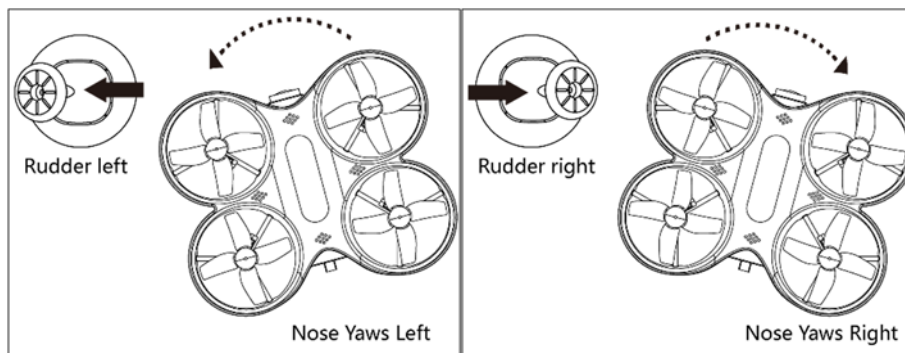

Elevator

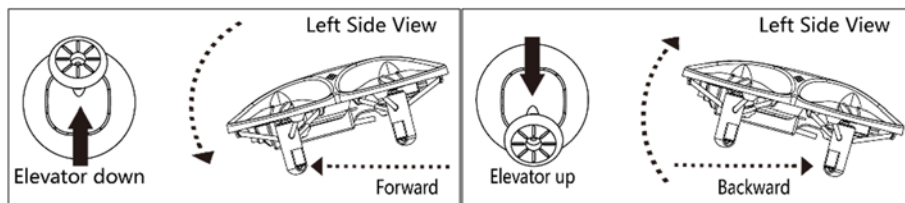

Aileron

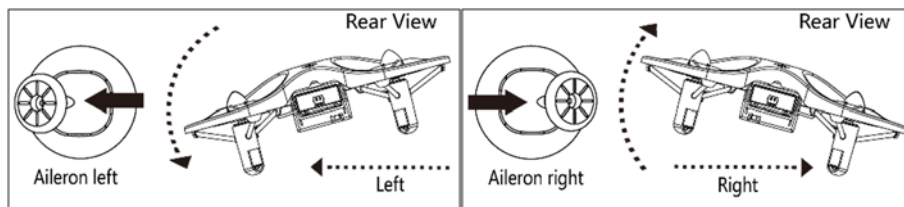

FLY THE QUADCOPTER

Takeoff

Increase the throttle until the model is approximately 2 ft.(600mm) off the ground in a low-level hover and concentrate on balancing the throttle stick`s position so that the quadcopter holds a steady hover altitude. In some cases, you may need to make a few short "hops" to an altitude of just a few inches until you become familiar with the control inputs and trim settings required to maintain a steady hover and altitude.

Hovering

The quadcopter requires minor throttle adjustments to maintain its altitude in hover. Remember to keep these throttle adjustments as minimal as possible. Large adjustments could result in a loss of control or a possible crash.

While attempting to establish a low-level hover, check to see if any trim adjustments are required to help keep the quadcopter from constantly drifting. If you find that it constantly drifts without any directional control input, land the model before making any adjustments to the trim settings.

- If the nose of the quadcopter rotates to the left or right, adjust the rudder trim.
- If the quadcopter continually drifts forward or backward, adjust the elevator trim.
- If the quadcopter continually drifts to the left or right, adjust the aileron trim.

Continue making minor trim adjustments until the machine hovers at a low altitude with very little drifting and directional control input, if this is your first multicopter, seek the help of an experienced pilot to trim the model for you before making your first flight.

With your quadcopter properly trimmed and maintaining a stable low-level hover, practice using the rudder, elevator and aileron controls to familiarize yourself with the machine's responses to control inputs. Remember to keep the control inputs as minimal

as possible.

Average flight times are approximately 4 minutes. **Always** unplug the battery as soon as you land!

NOTICE: Crash damage is not covered under warranty.

To prevent excessive wear to the motors, always allow the motors to cool between flights.

Low Voltage Cutoff(LVC)

Once the battery reaches 3V under load, the drone will slowly reduce the power supplied to the motor until complete shutdown occurs. This helps prevent over-discharge of the Li-Po battery. Land immediately once the ESC activates LVC. Continuing to fly after LVC can damage the battery.

NOTICE: Disconnect and remove the Li-Po battery from the drone after use to prevent trickle discharge.

During storage, make sure the battery charge does not fall below 3V.

FPV CAMERA AND VIDEO TRANSMITTER

NOTICE: Consult local laws and ordinances before operating FPV (first person view) equipment. In some areas, FPV operation may be limited or prohibited. You are responsible for operating this product in a legal and responsible manner.

1. Power on your radio transmitter, then power on the drone.
2. Power on video receiver to make sure the channel is clear.
3. Select the desired video transmitter channel by pressing the button on the quadcopter to scroll through the available bands (fat shark/IRC or race) and channels (1-8). Fat shark channel 1 is indicated by a red internal LED on the quadcopter. Keep pressing and releasing the button to scroll through the remaining channels.
4. Perform a range test before flying.

If you experience static in the video feed, select a different channel.

NOTICE: The 25mW micro video transmitter range on your quadcopter is less than your flight control transmitter range.

Tips: If you are flying with an FPV headset and are prone to motion sickness, sit in a chair.

Fly in open areas, away from people, trees, cars and buildings. The range of the system can be impacted by any obstructions blocking your signal. It is normal to see break up in the video going behind trees and other obstacles.

FPV IMAGE TRANSMISSION

Specifications:

- 5.8G wireless camera
- FM Modulation
- 32 channels in total
- Frequency groups
- Switch between NTSC/PAL
- Lens angle: H 120° /V 100°
- Default: A-CH1: 5740MHz
- LEDs: 8 for channel, 4 for frequency groups

Frequency of transmission channels:

Channel Freq. Groups	CH1	CH2	CH3	CH4	CH5	CH6	CH7	CH8
A	5740	5760	5780	5800	5820	5840	5840	5840
B	5845	5845	5825	5805	5785	5765	5745	5745
C	5732	5732	5732	5769	5806	5843	5843	5843
D	5733	5752	5771	5790	5809	5828	5847	5847

Change the frequency by pressing the switch on the battery frame to connect with different FPV display or VR glasses. With one press to change frequency and hold for 2s to choose frequency group.

Video Display

If you want to experience the flight with a FPV display, 32CH 5.8G FPV is recommended.

FPV starts as soon as the drone is turned on, then turn on the display.

Tune the FPV display according to its instructions.

If you want to experience the flight with VR equipment, the 5.8G 32CH goggles are recommended.

Install and tune the VR equipment according to its instructions.

TROUBLESHOOTING GUIDE

Problem	Possible Cause	Solution
Will not respond to throttle	Throttle too high and /or throttle trim is too high	Reset controls with the throttle stick and throttle trim at the lowest setting
Does not function and smells burnt after connecting the flight battery	Flight battery connected with the wrong polarity	Replace the 3-in-1 board. Connect the flight battery noting proper polarity

<p>LED on receiver flashes rapidly and quadcopter will not respond to transmitter (during binding)</p>	<p>1.Transmitter too near drone during binding process 2.Bind switch or button was not held while transmitter was powered on 3.Drone or transmitter is too close to large metal object, wireless source or another transmitter</p>	<p>1. Power off the transmitter. Move the transmitter a large distance from the drone. Disconnect and reconnect the flight battery to the drone. Follow the binding instructions 2.Power off transmitter and repeat bind process 3.Move drone and transmitter to another location and attempt binding again</p>
---	--	---

<p>LED on the receiver flashes rapidly and the quadcopter will not respond to the transmitter (after binding)</p>	<p>1.Less than a 5-second wait between first powering on the transmitter and connecting the flight battery to the quadcopter 2.Flight battery or transmitter battery charge is too low 3.Drone or transmitter is too close to large metal object, wireless source or another transmitter</p>	<p>1. Leave the transmitter powered on. Disconnect and reconnect the flight battery to the quadcopter 2.Replace or recharge batteries 3.Move drone and transmitter to another location and attempt connecting again</p>
<p>Crashes immediately upon lift-off or doesn't lift off</p>	<p>Propellers in wrong locations</p>	<p>Make necessary adjustment</p>

FCC Information

This device complies with part 15 of The FCC rules. Operation is subject to the following two conditions: (1) This device may not cause harmful Interference, and (2) this device must accept any interference received, including Interference that may cause undesired operation.

NOTE: The grantee is not responsible for any changes or modifications not expressly approved by the party responsible for compliance. Such modifications could void the user's authority to operate the equipment.

NOTE: This equipment has been tested and found to comply with the limits for a Class

B digital device, pursuant to part 15 of the FCC Rules. These limits are designed to provide reasonable protection against harmful interference in a residential installation.

This equipment generates uses and can radiate radio frequency energy and, if not installed and used in accordance with the instructions, may cause harmful interference to radio communications. However, there is no guarantee that interference will not occur in a particular installation. If this equipment does cause harmful interference to radio or television reception, which can be determined by turning the equipment off and on, the user is encouraged to try to correct the interference by one or more of the following measures:

- Reorient or relocate the receiving antenna.
- Increase the separation between the equipment and receiver.
- Connect the equipment into an outlet on a circuit different from that to which the receiver is connected.
- Consult the dealer or an experienced radio/TV technician for help.

NOTICE

Changes or Modifications not expressly approved by the part responsible for compliance could void the user's authority to operate the equipment.

This product contains a remote controller and a aircraft.

The remote controller contains a radio transmitter with wireless technology which has been tested and found to be compliant with the applicable regulations governing a radio transmitter in the 2400 MHz-2483.5 MHz frequency range.

The aircraft contains two radio transmitters with wireless technology which has been tested and found to be compliant with the applicable regulations governing a radio transmitter in the 2400 MHz-2483.5 MHz and 5725 MHz-5850 MHz frequency range.

Remote Controller Rated power: 5dBm. Aircraft Rated power: 5dBm (2400 MHz-2483.5 MHz), 14dBm (5725 MHz-5850 MHz Band).

Compliance Information for the European Union

EU Compliance Statement

Hereby, Mirarobot declares that the radio equipment type S60 FPV is in compliance with Directive 2014/53/EU. The full text of the EU declaration of conformity is available

at the following internet address: www.mirarobot.com.

This device may be used in each member state.



Instructions for disposal in the European Union

This Product must not be disposed of with other waste. Instead, it is the user's responsibility to dispose of their waste equipment by handing it over to a designated collections point for the recycling of waste electrical and electronic equipment. The separate collection and recycling of your waste equipment at the time of disposal will help to conserve natural resources and make sure that it is recycle in a manner that protects human health and the environment. For more information about where you can drop off your waste equipment for recycling, please contact your local city office, your household waste disposal service or where you purchased the product.



WARNING

ALL INSTRUCTION AND PRECAUTIONS MUST BE READ
AND FOLLOWED EXACTLY.

WARNING: PROCEDURES, WHICH IF
NOT
PROPERLY FOLLOWED, CREATE THE
PROBABILITY OF PROPERTY DAMAGE,
COLLATERAL DAMAGE AND SERIOUS
INJURY OR CREATE A HIGH
PROBABILITY OF
SUPERFICIAL INJURY.

Failure to exercise care while using this product and comply with the following conditions and guidelines could result in product malfunction, excessive heat, fire, property damage, and ultimately injury.

Lithium Ion batteries are not toys. For the purposes of this document Li-Ion, Li-Po or Li-Fe batteries will be described as "Batteries".

Handling and Storage

Never alter, puncture or impact Batteries or related components.

Do not directly connect the terminals with metal objects. This will short-circuit Batteries, resulting in heat and electrical discharge.

Never store loose Batteries together, the Batteries' terminals may contact one another causing a short circuit.

Never expose Batteries to extreme temperatures or direct sunlight.

Always disconnect Batteries when not in use.

Before the First Charge

Ensure batteries are not damaged, as this may cause a short circuit or fire.

Charging

- **Always** refer to your charger's manual to ensure safe operation.
- **Always** charge Batteries in an open area away from flammable materials, liquids and surfaces.
- **Never** charge Batteries that are hot to the touch (above 120 F)

Safety

If at any time Batteries become damaged, hot, or begin to balloon or swell, discontinue charging (or discharging) immediately. Quickly and safely disconnect the charger. Then place the Batteries and/or charger in a safe, open area away from flammable materials in an approved Li-Po bag to observe. After one hour, remove the Batteries from service. **DO NOT** continue to handle, attempt to use, or ship the Batteries. Failure to follow these procedures can cause damage to Batteries, personal property or cause serious injury.

Damaged or swollen Batteries can be unstable and very hot. **DO NOT** touch Batteries until they have cooled. Dispose of Batteries in the manner required by your city, country, state or Country. Contact the appropriate Mirarobot Product support office to speak to a Service technician for more information.

In the event of fire, a Class D, dry chemical fire extinguisher must be used then batteries must be placed inside of an approved Li-Po bag.

Additional Guidelines and Warnings

- In the event of a crash, always quickly and safely disconnect and remove Batteries from the model. Then follow the previously listed safety procedures.
- If the internal contents of Batteries come into contact with your skin, wash the affected area(s) with soap and water immediately.
- If it comes into contact with your eye(s), flush them with generous amounts of water for 15 minutes and seek immediate medical attention.

Battery Limited Warranty

All instructions, warranties and other collateral documents are subject to change at the sole discretion of Wuxi Mirarobot Science & Technology Co., Ltd. For up to date product literature, visit www.mirarobot.com.

Warranty Period

Exclusive Warranty-Wuxi Mirarobot Science & Technology Co., Ltd. (Mirarobot) warrants that the products purchased (the "Product") will be free from defects in materials and workmanship at the date of purchase by the Purchaser.

Limited Warranty

Mirarobot reserves the right to change or modify this warranty without notice and disclaims all other warranties, express or implied.

(a) This warranty is limited to the original Purchaser ("purchaser") and is not transferable. REPLACEMENT AS PROVIDED UNDER THIS WARRANTY IS THE EXCLUSIVE REMEDY OF THE PURCHASER This warranty covers only those Products purchased from an authorized Mirarobot dealer. Third party transactions are not covered by this warranty. Proof of purchase is required for warranty claims.

Limitations- Mirarobot MAKES NO WARRANTY

(b) OR REPRESENTATION, EXPRESS OR IMPLIED, ABOUT NON-INFRINGEMENT, MERCHANTABILITY OR FITNESS FOR A PARTICULAR PURPOSE OF THE PRODUCT. THE PURCHASER ACKNOWLEDGES THAT THEY ALONE HAVE DETERMINED THAT THE PRODUCT WILL SUITABLY MEET THE REQUIREMENTS OF THE PURCHASERS INTENDED USE.

(c) Purchaser Remedy- Mirarobot's sole obligation hereunder shall be that Mirarobot will, at its option, replace any Product determined by Mirarobot to be defective in the

event of a defect, this is the Purchaser's exclusive remedy. Replacement decisions are at the sole discretion of Mirarobot. This warranty does not cover cosmetic damage or damage due to acts of God, accident, misuse, abuse, negligence, commercial use, or modification of or to any part of the Product. This warranty does not cover damage due to improper installation, operation maintenance or attempted repair by anyone.

Replacement decisions are at the sole discretion of Mirarobot. This warranty does not cover cosmetic damage or damage due to accident, misuse, abuse, negligence, commercial use, or modification of or to any part of the Product. This warranty does not cover damage due to improper installation, operation maintenance or attempted repair by anyone.

MIRAROBOT DOES NOT INSPECT OR REPAIR BATTERIES. NEVER SHIP BATTERIES TO MIRAROBOT.

Damage Limits

MIRAROBOT SHALL NOT BE LIABLE FOR SPECIAL INDIRECT OR CONSEQUENTIAL DAMAGES, LOSS OF PROFITS OR PRODUCTION OR COMMERCIAL LOSS IN ANY WAY CONNECTED WITH THE PRODUCT, WHETHER SUCH CLAIM IS BASED IN CONTRACT, WARRANTY, NEGLIGENCE, OR STRICT LIABILITY. Further, in no event shall the liability of Mirarobot exceed the individual price of the Product on which liability is asserted. As Mirarobot has no control over use, setup, final assembly, modification or misuse, no liability shall be assumed nor accepted for any resulting damage or injury. By the act of use, setup or assembly the user accepts all resulting liability.

If you as the purchaser or user are not prepared to accept the liability associated with the use of this Product, you are advised to return this Product immediately in new and unused condition to the place of purchase.

LIMITED WARRANTY

WHAT THIS WARRANTY COVERS-Wuxi Mirarobot Science & Technology Co., Ltd (Mirarobot) warrants to the original purchaser that the product purchased (The "product") will be free from defects in materials and workmanship at the date of purchase.

WHAT IS NOT COVERED-This warranty is not transferable and does not cover (i) cosmetic damage, (ii) damage due to acts of God, accident, misuse, abuse, negligence, commercial use, or due to improper use, installation, operation or maintenance,

(iii)modification of or to any part of the Product, (iv)attempted service by anyone other than a Mirarobot authorized , (v) Product not purchased from an authorized Mirarobot dealer, (vi)Product not compliant with applicable technical regulations, or (vii) use that violates any applicable laws, rules, or regulations.

OTHER THAN THE EXPRESS WARRANTY ABOVE, MIRAROBOT MAKES NO OTHER WARRANTY OR REPRESENTATION, AND HEREBY DISCLAIMS ANY AND ALL IMPUED WARRANTIES, INCLUDING, WITHOUT LIMITATION, THE IMPUED WARRANTIES OF NON-INFRINGEMENT, MERCHANTABILITY AND FITNESS FOR A PARTICULAR PURPOSE. THE PURCHASER ACKNOWLEDGES THAT THEY ALONE HAVE DETERMINED THAT THE PRODUCT WILL SUITABLY MEET THE REQUIREMENTS OF THE PURCHASER'S INTENDED USE.

LIMITATION OF LIABILITY-MIRAROBOT SHALL NOT BE LIABLE FOR SPECIAL, INDIRECT, INCIDENTAL OR CONSEQUENTIAL DAMAGES, LOSS OF PROFITS OR PRODUCTION OR COMMERCIAL LOSS IN ANY WAY, REGARDLESS OF WHETHER SUCH CLAIM IS BASED IN CONTRACT, WARRANTY, TORT, NEGLIGENCE, STRICT LIABILITY OR ANY OTHER THEORY OF LIABILITY, EVEN IF Mirarobot HAS BEEN ADVISED OF THE POSSIBILITYOF SUCH DAMAGES. Further, in no event shall the liability of Mirarobot exceed the individual price of the Product on which liability is asserted. As Mirarobot has no control over use, setup, final assembly, modification or misuse, no liability shall be assumed nor accepted for any resulting damage or injury. By the act of use, setup or assembly, the user accepts all resulting liability. If you as the purchaser or user are not prepared to accept the liability associated with the use of the Product, purchaser is advised to return the Product immediately in new and unused condition to the place of purchase.

LAW-These terms are governed by Illinois law (without regard to conflict of law principals). This warranty gives you specific legal rights, and you may also have other rights which vary from state to state. Mirarobot reserves the right to change or modify this warranty at any time without notice.

WARRANTY SERVICES

QUESTIONS, ASSISTANCE, AND SERVICES-Your local hobby store and/or place of purchase cannot provide warranty support or serve. Once assembly setup or use of the Product has been started you must contact your local distributor or Mirarobot directly. This will enable Mirarobot to better answer your questions and service you in

the event that you may need any assistance. For questions or assistance, please visit our website at www.mirarobot.com, submit a Product Support inquiry, or call the toll free telephone number referenced in the Warranty and Service Contact Information section to speak with a Product Support representative.

INSPECTION OR SERVICES-If this Product needs to be inspected or serviced and is compliant in the country you live and use the Product in, please use the Mirarobot Online Service Request submission process found on our website or call Mirarobot to obtain a Return Merchandise Authorization (RMA) number. Pack the Product securely using a shipping carton. Please note that original boxes may be included, but are not designed to withstand the rigors of shipping without additional protection. Ship via a carrier that provides tracking and insurance for lost or damaged parcels, as Mirarobot is not responsible for merchandise until it arrives and is accepted at our facility. An Online Service Request is available at <http://www.mirarobot.com>. If you do not have internet access, please contact Mirarobot Product Support to obtain a RMA number along with instructions for submitting your product for service. When calling Mirarobot, you will be asked to provide your complete name, street address, email address and phone number where you can be reached during business hours. When sending product into Mirarobot, please include your RMA number, a list of the included items, and a brief summary of the problem. A copy of your original sales receipt must be included for warranty consideration. Be sure your name, address, and RMA number are clearly written on the outside of the shipping carton.

NOTICE: DO NOT SHIP LI-PO BATTERIES TO MIRAROBOT. IF YOU HAVE ANY ISSUE WITH A LI-PO BATTERIES, PLEASE CONTACT THE APPROPRIATE MIRAROBOT PRODUCT SUPPORT OFFICE.

WARRANTY REQUIREMENTS-FOR WARRANTY CONSIDERATION, YOU MUST INCLUDE YOUR ORIGINAL SALES RECEIPT VERIFYING THE PROOF-OF-PURCHASE DATE.

Provided warranty conditions have been met, your Product will be serviced or replaced free of charge. Service or replacement decisions are at the sole discretion of Mirarobot.

NON-WARRANTY SERVICE-SHOULD YOUR SERVICE NOT BE COVERED BY WARRANTY, SERVICE WILL BE COMPLETED AND PAYMENT WILL BE REQUIRED WITHOUT NOTIFICATION OR ESTIMATE OF THE EXPENSE UNLESS THE EXPENSE EXCEEDS 50% OF THE RETAIL PURCHASE COST.

By submitting the item for service you are agreeing to payment of the service without notification. Service estimates are available upon request. You must include this request with your item submitted for service. Non-warranty service estimates will be billed a minimum of 0.5 hour of labor. In addition, you will be billed for return freight. Mirarobot accepts money orders and cashier's checks, as well as Visa, MasterCard, American Express, and Discover cards. By submitting any item to Mirarobot for service, you are agreeing to Mirarobot's Terms and Conditions found on our website www.mirarobot.com

ATTENTION: MIRAROBOT SERVICE IS LIMITED TO PRODUCT COMPLIANT IN THE COUNTRY OF USE AND OWNERSHIP. IF RECEIVED, A NON-COMPLIANT PRODUCT WILL NOT BE SERVICED. FURTHER, THE SENDER WILL BE RESPONSIBLE FOR ARRANGING RETURN SHIPMENT OF THE UNSERVICED PRODUCT, THROUGH A CARRIER OF THE SENDER'S CHOICE AND AT THE SENDER'S EXPENSE. MIRAROBOT WILL HOLD NON-COMPLIANT PRODUCT FOR A PERIOD OF 60 DAYS FROM NOTIFICATION, AFTER WHICH IT WILL BE DISCARD.

RF warning statement

This product contains a remote controller and a aircraft.

The device of remote controller has been evaluated to meet general RF exposure requirement. The device of remote controller can be used in portable exposure condition without restriction.

The device of aircraft complies with RF radiation exposure limits set forth for an uncontrolled environment. This equipment should be installed and operated with minimum distance of 20 cm between the radiator and your body.

Wuxi Mirarobot Science&Technology Co., Ltd.
Qingyun Building5, NO.99, Furongsan Road, Xishan Economic-
Technological Development Zone, Wuxi, Jiangsu, China
Tel:0086-510-83781667
Fax:0086-510-83781609
Email: marketing@mirarobot.cn
www.mirarobot.com