

69mm ± 1.5

Quick start guide

M416L

This guide will introduce you to the mobile and its essential features.  
Please visit Meizu's official website for more information.

154.5mm ± 1.5

MEIZU

Mobile Appearance

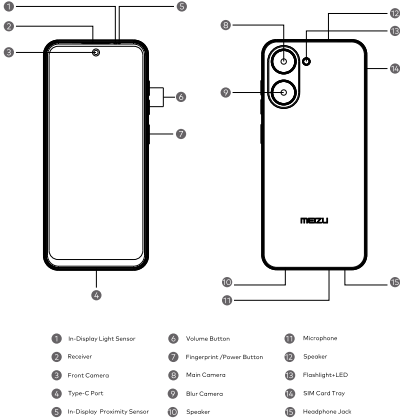

Important Notifications

1. Power Button Instructions:
- After powering on, press and hold the power button for 0.5s to activate the Voice Assistant;
  - For initial startup, press and hold the power button for 5s. After powering on, press and hold the power button for 3s to access the power off/restart interface;
  - If the mobile phone is acting abnormally, please press and hold the power button continuously. This will force the phone to power off and then restart.
2. The rear cover and battery are non-removable. Please do not attempt to remove them yourself. If you need a replacement, please contact MEIZU after-sales service or your authorised local MEIZU representative.

SIM Card Installation (SIM card supports 2G/3G/4G)

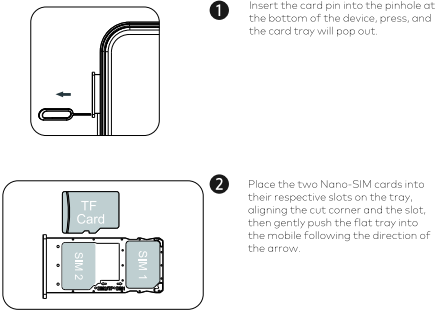

EN

- Switch between primary/accessory SIM cards in Settings when using dual SIM cards;
- Please use a standard Nano-SIM (contact your operator for a standard card). Cut or non-standard Nano-SIM cards may result in the device's malfunctioning;
- Damage to the device due to the use of non-standard Nano-SIM cards, incorrect installation, or incorrect SIM card tray installation will cause the warranty to become void.

Specifications

Product model	M416L	
Main screen parameter	6.79"	
Dimension	78mm*170.8mm*9.35mm	
Battery	4850mAh/18.76Wh(Min) 4900mAh/18.96Wh(Typ)	
Camera	13 Megapixels +0.08 Megapixels Rear 8 Megapixels Front	
Operating temperature	0°C -35°C	
SAR Values	FCC SAR	0.76W/Kg(Head) 0.74W/Kg(Body)

Radio Waves Specifications

Radio	Frequency	Max Output Power
GSM	850MHz	34dBm
	900MHz	34dBm
	1800MHz	31dBm
	1900MHz	31dBm
WCDMA	Bands 2/4	24dBm
	Bands 5/8	24dBm
LTE	Bands 2	26dBm
	Bands 3/4/12/28/66	25.5dBm
	Bands 5/7	24.5dBm
	Bands 17/26	25dBm
Bluetooth	2.400GHz-2.4835GHz	8.5dBm(EIRP)
2.4G Wi-Fi	2.400GHz-2.4835GHz	17.5dBm(EIRP)
5G Wi-Fi	5.150GHz-5.350GHz	11.5dBm(EIRP)
	5.470GHz-5.725GHz	11.5dBm(EIRP)
	5.725GHz-5.850GHz	11.5dBm(EIRP)