

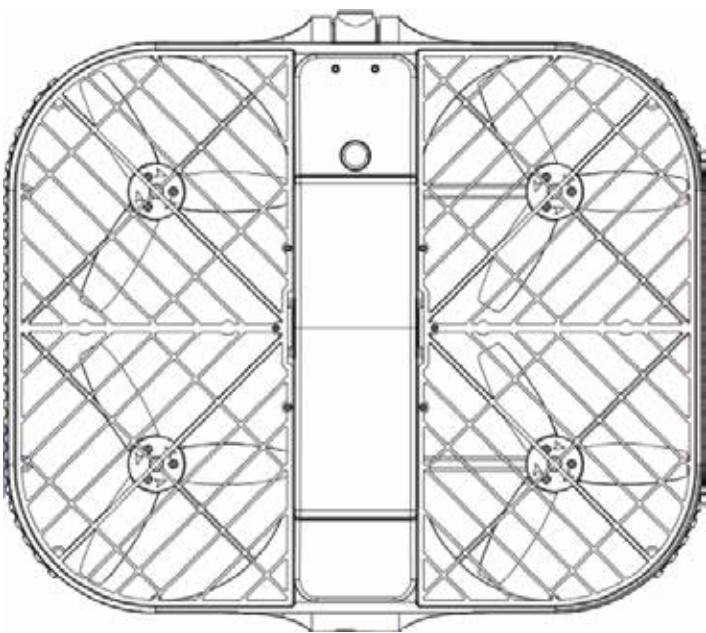

Shenzhen Revolution Spread Co., Ltd

LANKIYA Quick Start Guide V1.0



Please read this quick guide carefully before using it

1

- 1: Wifi signal indication

2:TF cards

3:Battery level

4:Settings

5:Hidden interface

6:Drag and Drop position

7:One touch rising

8:One touch falling

9:Real-time recording

10:Still Cam

11:Continuous mode

12:360 degree continuous mode

13:Rise
- 14:Fall

15:Left-turn

16: Right-turn

17: Camera

18: Browse

19: Hide mode

20: Video

21: Shutter / Video

22: Foced-landing

23: Video

24: Shutter / Video

25: Foced-landing

4.Environmental requirements

Drone have certain requirements for the environment, observing the surrounding environment, to meet the basic requirements, and then begin to use, the following is the requirements of general:

1) Outdoor environment:

- Due to without the GPS in Lankiya, so it unable to get the precise location, just depend on the barometer and ultrasonic integrated set high, the optical flow sensor to the auxiliary positioning, so has the certain requirements to the environment. Please pay attention to the following:
- Choose open, flat terrain, good vision, site flight, flight to ensure that a certain distance away from the crowd
 - Do not fly near strong interference sites such as the roof of tall buildings or high voltage signal towers.
 - Control flight height and distance is within 10 meters. Do not fly the aircraft within areas such as airport, no-fly zone. Observe local laws and regulations.
 - Do not use the aircraft in severe weather conditions: snow, rain, smog, wind speeds exceeding 5m/s, etc.
 - At altitudes above 6000 meters or below 10 degrees Celsius, the performance of drone and batteries may be affected by environmental factors. Please fly carefully.

2) Indoor inviroment:

4

Thank you for choosing
Shenzhen Chi-technology self-timer UAV!

Please read this manual carefully before using the unit for the first time.
And to be retained for future reference. Thank you!

1.Battery charging

Lankiya equipped with capacity of 1500mAh 3S lithium battery, the standard voltage 11.1V. Please charge the battery with Lankiya special charger and special adapter, and can charge two batteries at the same time. In charge status, The red charger indicator is always on.If the indicator turns green, means the battery is charged, power off and battery removed. Plug in the adapter. If there is no battery or the battery isn't in the right way, the charger is in standby mode and the red light is flashing.

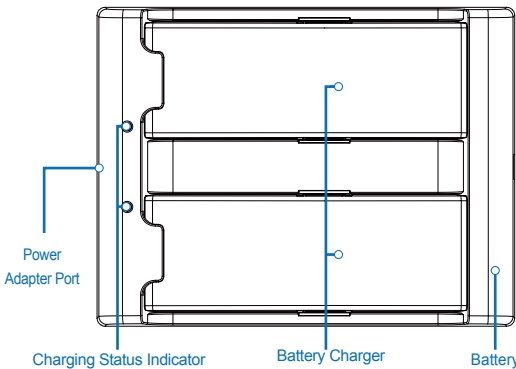

Warm prompt

The red and green light flash alternately means the battery is out of order. Please cut off the power supply and unplug the battery immediately. Suggest to fly in the room temperature. With low temperature, the performance of the lithium battery will be seriously affected, thus shortening the flight time. For low temperature use, please preheat the battery to about 20 degrees before taking off.

2

The drone uses auxiliary optical flow and ultrasonic modules to assist positioning. The auxiliary positioning system uses a height range of 0.7 meters to 2.5 meters. The performance of the system is affected by the drone flying speed, brightness and texture of the surface which the drone is flying over.Please use the auxiliary positioning system carefully in the following situations:

- A strongly reflective surface of an object, if a smooth floor.
- Surface of water and solid objects, such as smooth tabletop.
- A dark, especially bright environment, such as a dark room.
- An object surface, such as a staircase, that slopes more than 30 degrees.
- Other conditions that may affect ultrasound and optical flow location, such as the dance hall.

5.Drone Preparation

Check the drone to ensure that the drone around the upper and lower protective cover, no foreign body, the pulp leaves intact, if found pulp defects, deformation, please replace in time. The TF card inserted into TF card slot (maximum support 32G memory card), and install the vehicle battery.

6.On/Off

As shown, the power button is located at the head of the drone.

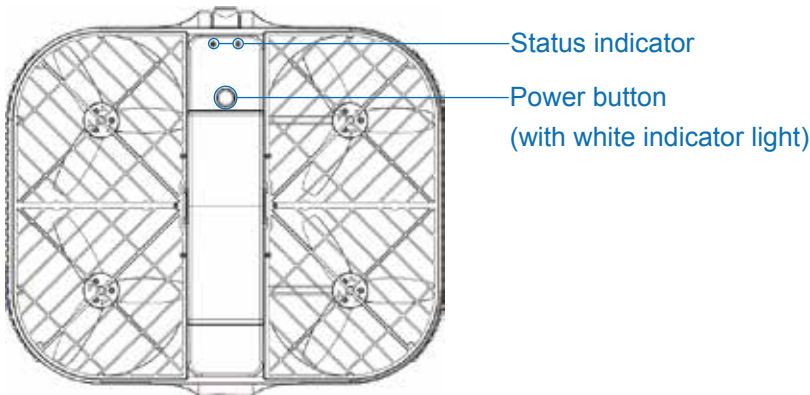

Press the power button for 3 seconds, the power button on the white lights began to flash slowly, the drone began to self, takes about 5 seconds to self, if the test by white light into light. The drone will issue a "beep" interval two tone,

5

2.Download and install APP

Scan two-dimensional code on the packaging of the two-dimensional code or below, under the merge to install the latest Revospread Lankiya APP.You can also have access to "Shenzhen Revolution Spread Co. , Ltd" website (www.revospread.com) or download in App Store.



iOS
App Store Download



Android
App store Download

3. Revospread Lankiya APP introduction

Revospread Lankiya is a specifical APP just for Lankiya. Users can view the flight pictures and the flight status information in real-time through APP. Also can use APP for flight operations, camera settings, photography, video and other operations.

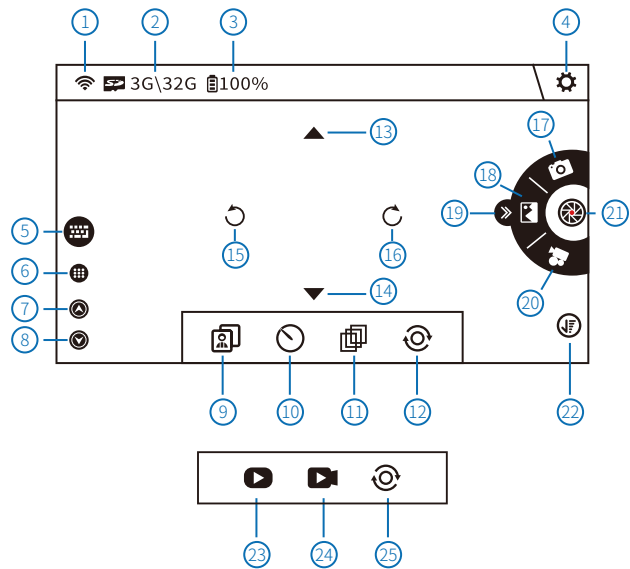

3

said the drone was ready, can fly; if failed the white light into the flash, the need to find the reasons, if the battery is low, please replace the batteries. The drone has three states: shutdown state (drone completely off), standby (drone powered by camera, self image transmission function is turned on), running state (motor starts rotating, automatic hovering). Through the power switch three states: in the off state long press the power button for 3 seconds, the drone enters the standby mode, in the standby mode, press the power button for 2 seconds, the drone into the working state, under the working state, short press the power button for 2 seconds, the drone enters the standby mode, in the standby state or flight next, long press the power button for 5 seconds, the drone entered the shutdown state.

7.Replace batteries

Put the drone flat, with the thumb and index finger in the middle of the battery pinch button position, pull up the battery. Take out the new battery and point it to the battery connection terminal (at the end of the drone) and press down the battery until the battery is caught in the middle of the drone.

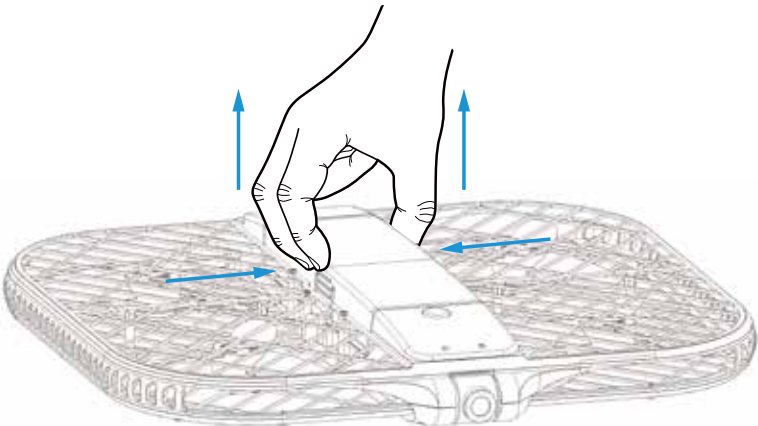

6

To prevent the battery from falling during flight, make sure the battery is in place.
Be sure to change the battery in the case of shutdown, pulling the bat tery in standby mode will cause damage to the drone.
When the low voltage alarm prompt, please land in time to replace the new battery.
If you do not use for a long time, or in transit, please unplug the battery, to avoid excessive battery.

8.Connecting drone and mobile equipment

After launching the drone, select the Lankiya network corresponding to the WI-FI in the settings option for the mobile device, and the default Wi-Fi name is (Revospread_Lankiya_xxxxxx, password 12345678). Run APP after successful connection.
Lankiya uses the Wi-Fi tran mission mode, and the graphics quality and control distance vary slightly due to differences in the Wi-Fi modules built into different brands of handsets.

9.Calibrating the Compass

In a case, perform sensor calibration:
• First flight.
• Flying in a new location or in a location that is different from the last flight.
• A drift occurs when the aircraft is hovering.
Method: set the icon in general, select " drone calibration settings" option in figure, respectively in order to choose the "acceleration","electronic compass","gyroscope" option, to complete the corresponding operation APP tips and requirements.

10.flight and control

As shown below, the Lankiya drone is flat down. If the drone is in standby mode (the white indicator lamp is always on), press the power button briefly. If the drone is in shutdown, the operation will follow the above boot process.

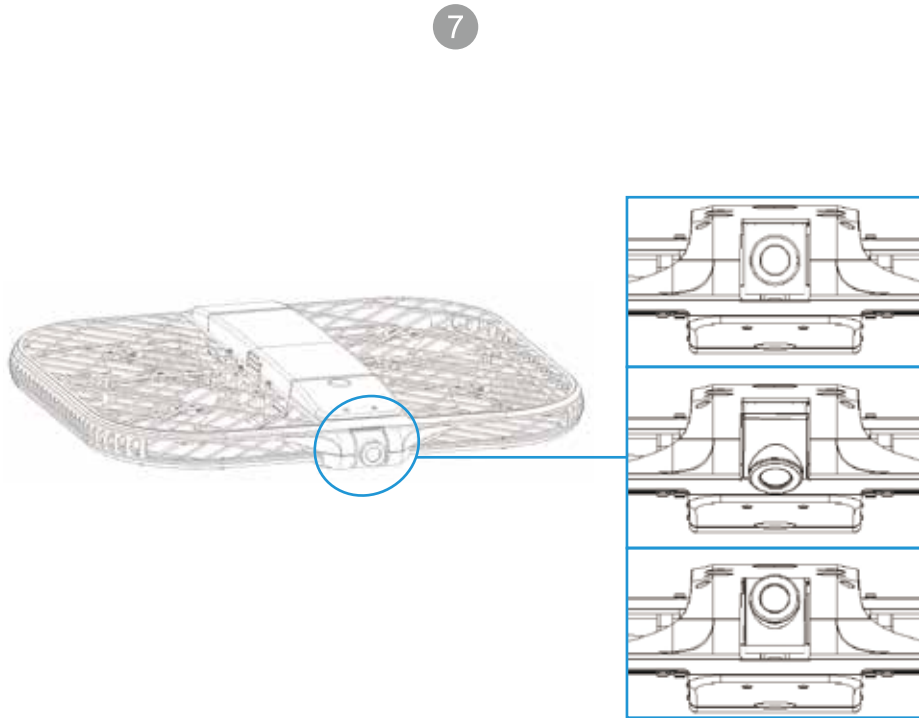

11.Photo and video

Take photos: take photos in time, take photos in time, take photos continuously, take pictures at 360 degrees. According to need to choose, choose a good press camera shutter button to start the camera, the drone will have light tips, photos after the photos are automatically downloaded to the local mobile phone, you can preview the picture video preview button.
Video: divided into short and long video and 360 degree video three modes of 360 degree, a short video recording 10 seconds; long video is no time limit; 360 degree video: drone rotated 360 degrees at the same time, open the video, stop rotating ring. PresPress the shutter button to start the recording, and there will be an indicator light on the drone. Pres the shutter again to stop. After the video recording, you can preview the downloaded video via the " Browse " button, and edit and save the video through the video editing function.

12.Retrieve/Land Lankiya

First, through " Fly downwards " or " One button down " button, will adjust drone to the appropriate height; then the figure from drone in flight, and a short press the power button or the drone is rotated by 90 degree, the propeller rotation stops, aircraft enter standby state.

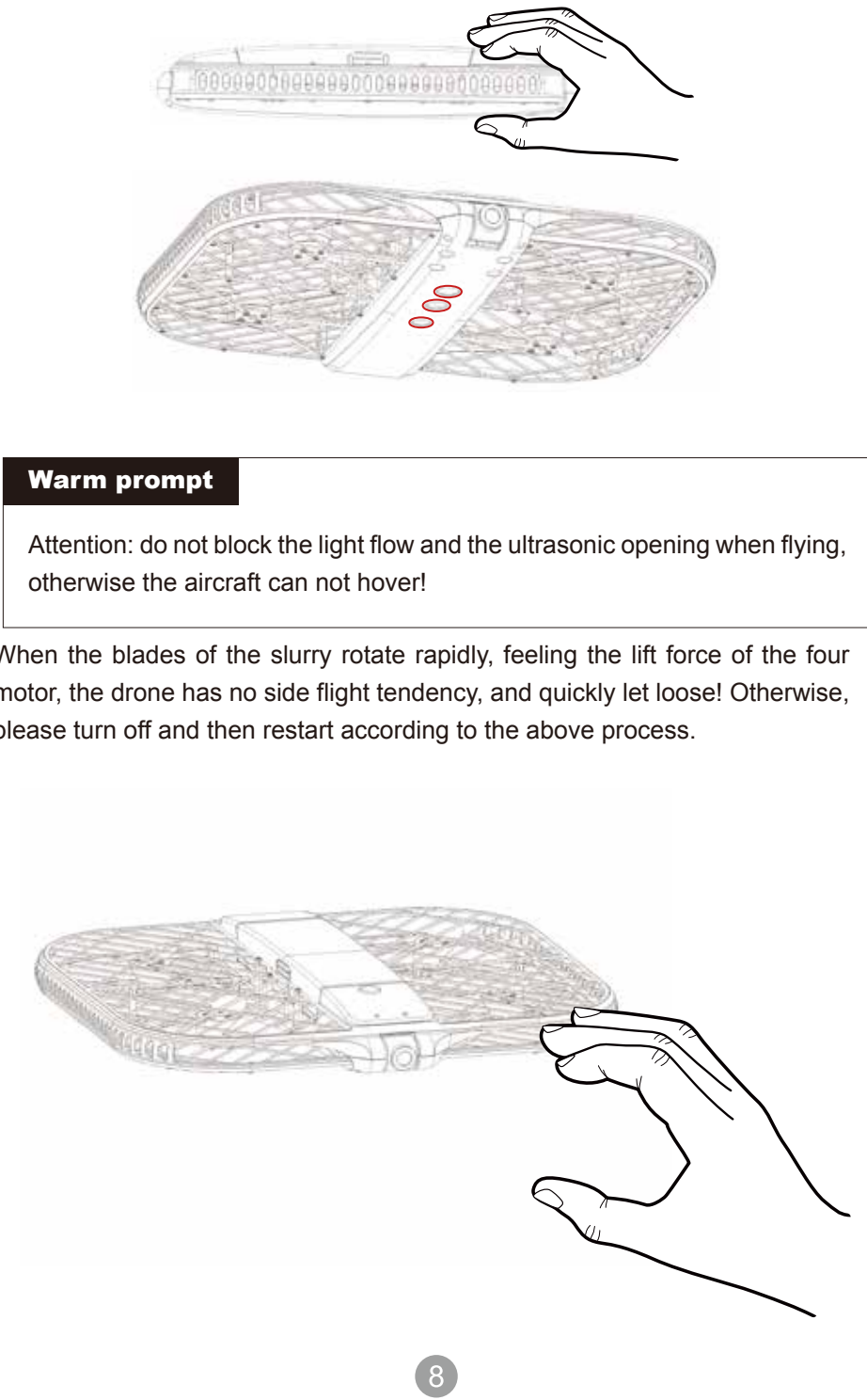

Warm prompt

Attention: do not block the light flow and the ultrasonic opening when flying, otherwise the aircraft can not hover!

When the blades of the slurry rotate rapidly, feeling the lift force of the four motor, the drone has no side flight tendency, and quickly let loose! Otherwise, please turn off and then restart according to the above process.

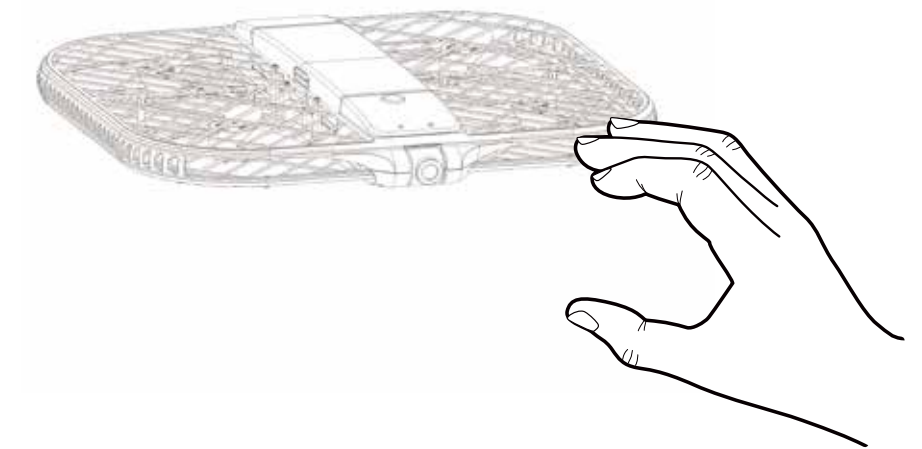

If you are determined to no longer use the drone, or need to replace the battery, please press the power button again until the white power indicator goes out and the drone goes into shutdown. If an emergency occurs during flight, such as a serious drift, or is about to encounter obstacles. Objects, etc., can click the "Crash-land" button, and then click "confirm", the aircraft will automatically land on the ground randomly.

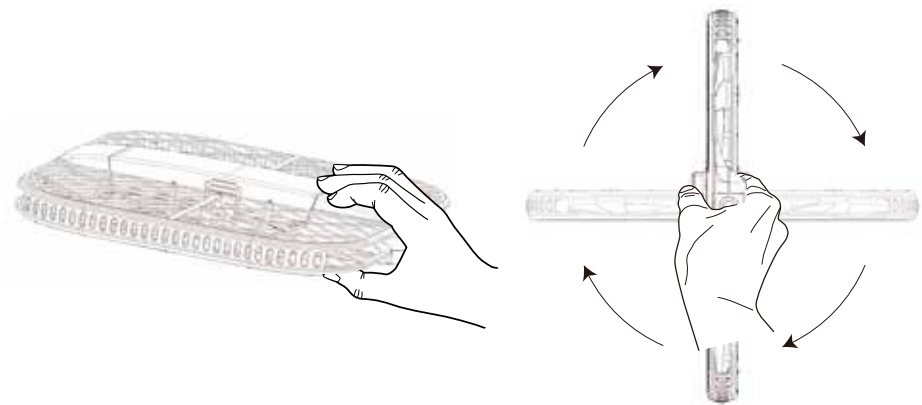

Warm prompt

matter on the carbon board. For more security, please refer to "Disclaimer" and "Lankiya user manual".

For more information, please refer to the Lankiya "User Manual".

Open the Revospread Lankiya APP

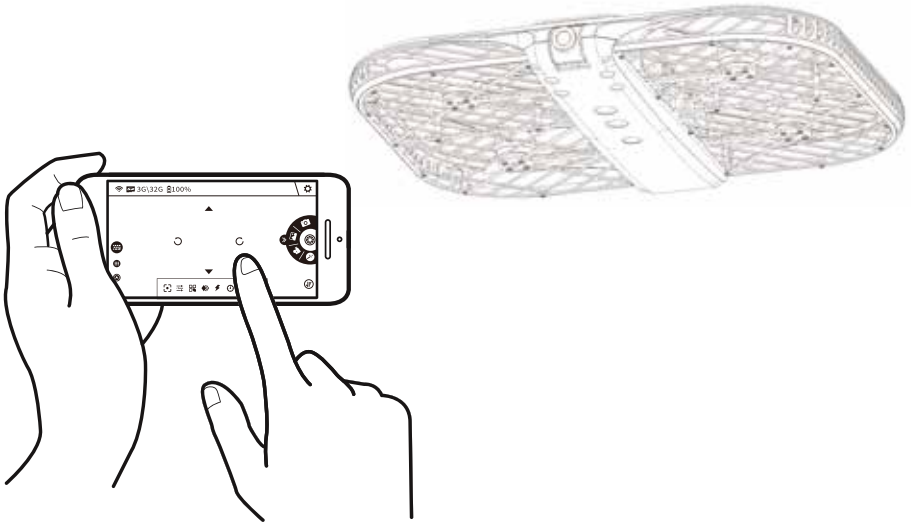

Height adjustment:
The rapid adjustment, under the APP on the main interface of " One button up " button, then the drone is automatically increased to a height of 1.8 meters; the random button becomes " One button down " function, click on the button, then the drone dropped to 1.2 meters from the ground height.
The height adjustment, increase the main interface, click the APP“Fly upwards, Fly downwards”button, then slow down the drone to rise or fall (per click the adjustment of about 20 cm); the direction of regulation, click the APP “Rotate to the right, Rotate to the right”button, spinning slowly to the left or right (random rotation about each point of time 10 degrees).
The camera angle regulating camera, 6 gear pitch angle: 0 degrees when the lens is on the front of the lens; upward push, followed by the elevation angle of 20 degrees and 40 degrees; the lens down, followed by depression -20 degrees, -40 degrees, -60 degrees , -80 degrees. Before flight, adjust the camera to the appropriate angle according to the shooting scene.



www.revospread.com
★This content is subject to change without prior notice.

Note:

*. This device complies with Part 15 of the FCC Rules. Operation is subject to the following two conditions: (1) This device may not cause harmful interference, and (2) This device must accept any interference received, including interference that may cause undesired operation.

Changes or modifications not expressly approved by the party responsible for compliance could void the user's authority to operate the equipment.

This equipment has been tested and found to comply with the limits for a Class B digital device, pursuant to part 15 of the FCC Rules. These limits are designed to provide reasonable protection against harmful interference in a residential installation. This equipment generates, uses and can radiate radio frequency energy and, if not installed and used in accordance with the instructions, may cause harmful interference to radio communications. However, there is no guarantee that interference will not occur in a particular installation. If this equipment does cause harmful interference to radio or television reception, which can be determined by turning the equipment off and on, the user is encouraged to try to correct the interference by one or more of the following measures:

- Reorient or relocate the receiving antenna.
- Increase the separation between the equipment and receiver.
- Connect the equipment into an outlet on a circuit different from that to which the receiver is connected.
- Consult the dealer or an experienced radio/TV technician for help.

RF Exposure: A distance of 20 cm shall be maintained between the antenna and users, and the transmitter may not be co-located with any other transmitter or antenna.