

Caster Board

Twistilk Electric



**Read and understand this entire manual before allowing
child to use this product!**

QUESTIONS OR COMMENTS?

CALL 800-306-3829

**NOTE: Manual illustrations are for demonstration purposes only.
Illustrations may not reflect exact appearance of actual product.
Specifications subject to change without notice.**

CONTENTS

Safety Warnings.....	1-2
Before You Begin	3
Assembly and Set-Up.....	4
Charging the Battery	5
Pre-Ride Checklist	5

Usage.....	6
Repair and Maintenance	7-10
Troubleshooting Guide	11
Twistilk Electric Parts.....	12
Warranty and Contact Information.....	13

SAFETY WARNINGS

⚠ WARNING: Riding a Twistilk Electric does present potential risks and caution is required. Like any riding product, a Twistilk Electric has inherent hazards associated with its use (for example, falling off or riding it into a hazardous situation). Like any riding product, Twistilk Electrics can and are intended to move and it is therefore, of course, possible to lose control or otherwise get into dangerous situations. Both children, and adults responsible for supervising them, must recognize that if such things occur, a rider can be seriously injured or die even when using safety equipment and other precautions. **RIDE AT YOUR OWN RISK AND USE COMMON SENSE.**

⚠ WARNING: PARENTAL AND ADULT RESPONSIBILITY AND SUPERVISION IS NECESSARY: Because products, like Twistilk Electrics, can and do present potential hazards plainly associated with their use, it is well recognized THE NEED FOR EXERCISE OF PARENTAL RESPONSIBILITY IN SELECTING RIDING PRODUCTS APPROPRIATE TO THE AGE OF A CHILD, OR PARENTAL SUPERVISION IN SITUATIONS IN WHICH CHILDREN OF VARIOUS AGES MAY HAVE ACCESS TO THE SAME RIDING PRODUCTS, IS IMPORTANT. Not every product is appropriate for every age or size of child, and different age recommendations are found within this category of product which are intended to reflect the nature of the hazards and the expected mental or physical ability, or both, of a child to cope with the hazards.

⚠ WARNING: NOT FOR RIDERS UNDER AGE 9 OR HEAVIER THAN 143 LB (65 KG). DO NOT EXCEED THE WEIGHT LIMIT OF 143 lbs (65 kg) – including backpacks and other items that might be carried. Exceeding the weight limit could injure the rider and damage the Twistilk Electric. Rider weight alone also does not necessarily mean a person's size is appropriate to fit or maintain control of the Twistilk Electric. Keep this product away from small children and remember that this product is intended for use only by persons who are, at a minimum, completely comfortable and competent while operating the product.

We recommends that children under the age of 9 not be permitted to use this product. This recommendation is based not just on age or weight or height; it reflects consideration of expected maturity and skills as well as physical size. The recommended rider age of 9 years or older is only an estimate and can be affected by the rider's size, weight, or skills – not every rider 9 years old or older will be suited to the product. Certainly, any rider unable to fit comfortably on the Twistilk Electric should not attempt to ride it, but a **parent's decision to allow his or her child to ride this product should be based on the child's maturity, skill, and ability to follow rules. We emphasize that adults are strongly advised not to disregard our recommendations or permit younger children to ride the Twistilk Electric.**

Keep this product away from small children and remember that it is intended for use only by persons who are, at a minimum, completely comfortable and competent while operating.

Persons with any mental or physical conditions that may make them susceptible to injury, impair their physical dexterity or mental capabilities to recognize, understand, and follow safety instructions and to be able to understand the hazards inherent in the use of any ride-on product, should not use or be permitted to use products inappropriate for their abilities. Persons with heart conditions, head, back or neck ailments (or prior surgeries to these areas of the body), or pregnant women, should be cautioned not to operate such products.

DO NOT EXCEED THE WEIGHT LIMIT OF 143 lb (65 kg). Rider weight does not necessarily mean a person's size is appropriate to fit or maintain control of the Twistilk Electric.

CHECK AND MAINTAIN PRODUCT CONDITIONS

Before use, check to confirm that covers and guards are in place and in serviceable condition. Check that the wheels are free of flat spots from wear. The product should be maintained and repaired in accordance with the manufacturer's specifications, using only the manufacturer's authorized replacement parts, and should not be modified from the manufacturer's original design and configuration.

ACCEPTABLE RIDING PRACTICES AND CONDITIONS
Always check and obey any local laws or regulations which may affect the locations where the Twistilk Electric may be used. Keep safely away from cars and motor vehicle traffic at all times. Only use where allowed and with caution.

Do not activate the remote unless you are on the Twistilk Electric and in a safe, outdoor environment suitable for riding.

The normal powered top speed of this product will be approximately 10 mph (16 km/h), which can be affected by conditions, such as rider weight, inclines and battery charge level. Avoid excessive speeds that can be associated with downhill rides.

Ride defensively. Watch out for potential obstacles that could catch your wheel or force you to swerve suddenly or lose control. Be careful to avoid pedestrians, skaters, skateboards, scooters, bikes, children or animals who may enter your path, and respect the rights and property of others.

The Twistilk Electric is intended for use on flat, dry surfaces, such as pavement or level ground, without loose debris, such as sand, leaves, rocks or gravel. Wet, slick, bumpy, uneven or rough surfaces may impair traction and contribute to possible accidents. Do not ride your product in mud, ice, puddles or water. Watch out for potential obstacles that could catch your wheel or force you to swerve suddenly or lose control. Avoid sharp bumps, drainage grates, and sudden surface changes.

Do not attempt or do stunts or tricks. The Twistilk Electric is not made to withstand abuse from misuse, such as jumping, curb grinding or any other type of stunts. Racing, stunt riding, or other maneuvers also enhance risk of loss of control, or may cause uncontrolled rider actions or reactions.

Never allow more than one person at a time to ride the product.
Do not ride at night or when visibility is limited.

Never use near steps or swimming pools.

Do not allow hands, feet, hair, body parts, clothing, or similar articles to come in contact with moving parts or wheels while the motor is engaged.

Do not touch electric motor when in use or immediately after riding. Never use headphones or a cell phone to talk or text when riding. Never hitch a ride with a vehicle.

Do not ride your product in wet or icy weather and never immerse in water, as the electrical and drive components could be damaged by water or create other possibly unsafe conditions. Never risk damaging surfaces, such as carpet or flooring, by use of a Twistilk Electric indoors.

SAFETY WARNINGS

PROPER RIDING ATTIRE

Always wear proper protective equipment, such as an approved safety helmet (with chin strap securely buckled), elbow pads, kneepads and wrist guards. A helmet may be legally required by local law or regulation in your area. A long-sleeved shirt, long pants, and gloves are recommended. Always wear athletic shoes (lace-up shoes with rubber soles) and keep shoelaces tied and out of the way of the wheels and motor. Never ride barefooted or in sandals.

USING THE CHARGER

The charger supplied with the product should be regularly examined for damage to the cord, plug, enclosure and other parts. In the event of such damage, the product must not be charged until the charger has been repaired or replaced.

Use only with the recommended charger

Use caution when charging.

The charger is not a toy. Charger should be operated by an adult.

Do not operate charger near flammable materials.

Unplug charger and disconnect from product when not in use.

Always disconnect from the charger prior to wiping down and cleaning your product with damp cloth.

FAILURE TO USE COMMON SENSE AND HEED THE ABOVE WARNINGS FURTHER INCREASES RISK OF SERIOUS INJURY. USE

AT YOUR OWN RISK AND WITH APPROPRIATE AND SERIOUS ATTENTION TO SAFE OPERATION. USE CAUTION.

BEFORE YOU BEGIN

Remove contents from box. Remove the separators that protect the components from damage during shipping. Inspect the contents of the box for scratches, or dents that may have occurred during shipping. Because the Twistilk Electric was 99% assembled and packed at the factory, there should not be any problems, even if the box has a few scars or dents.

MAKE SURE POWER SWITCH IS TURNED "OFF" BEFORE CONDUCTING ANY ASSEMBLY OR MAINTENANCE PROCEDURES.

■ Estimated Assembly and Set-Up Time

Allow up to 5 minutes for assembly, not including initial charge time.

Allow up to 8 hours for charge (**see page 5 for charging information**).

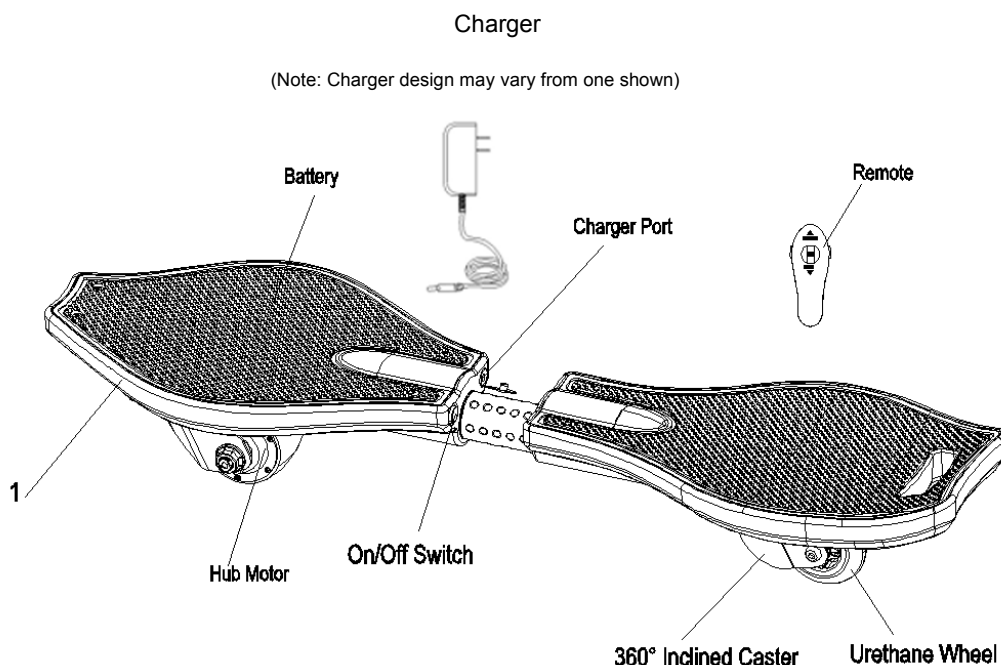

⚠ WARNING:

DO NOT USE non-authorized PRODUCTS WITH YOUR TWISTILK ELECTRIC. The Twistilk Electric has been built to certain design specifications. The original equipment supplied at the time of sale was selected on the basis of its compatibility with the frame and all other parts. Certain aftermarket products may not be compatible and will void the warranty. For any support, please contact our customer service

Note: Twistilk Electric must be moving at least 3 mph (5 km/h) while holding the lever on the remote in the "GO" position for motor to engage.

Product ID Locations:

(See locations to the left)

1. Underneath Product
2. Charger
3. UPC Side of Box (Not Shown)

Box Contents:

- Twistilk Electric
- Remote
- Two (2) AAA Batteries
- Charger
- Owner's Manual

ASSEMBLY AND SET-UP

■ Installing Remote Batteries

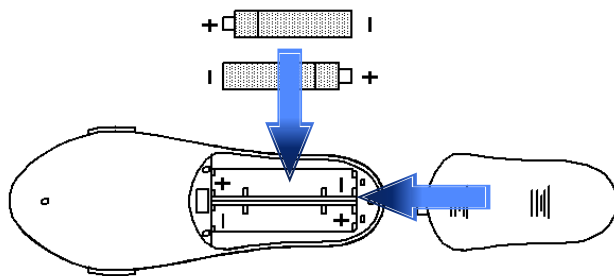

1 Loosen Phillip screw on battery cover and remove cover.

2 Install two (2) AAA batteries.

3 Re-attach battery cover and securely tighten in place with screw.

■ Remote Pairing Confirmation

Note: Your remote should have been paired with your Twistilk Electric at the factory.

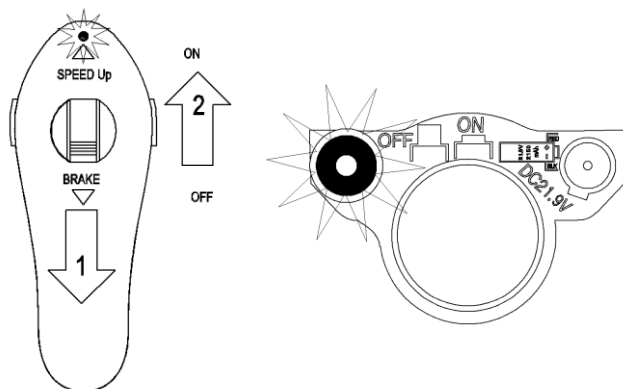

1 Turning the speed switch to BRAKE position and keep pressing it at BRAKE position, and then turn on the power switch; the remote will be flashing red that means the remote is searching the board to pair.

2 While the remote flashing red; Keep Pressing on the power button of the board, after about 2 seconds, the power button start to flashing as well (green light); that means the board is ready to pair the remote.

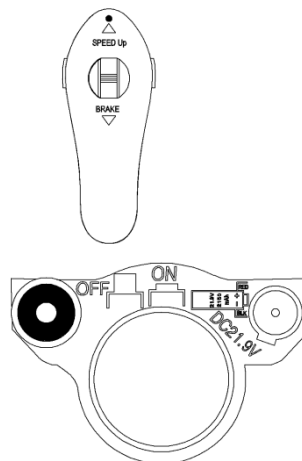

3 After both the remote and board flashing for 2 seconds, the remote will become solid red, and the board will become solid green.

That means is was paired successfully.

*** NOTICE: The speed switch has to be turned to BRAKE position before turning power on. Otherwise, it cannot be entering the paring mode

CHARGING THE BATTERY

Your Twistilk Electric may not have a fully charged battery; therefore you must charge the battery prior to use. Be sure to charge the battery in a clean, dry location away from direct sunlight, flames or sparks.

- Initial charge time: 7 hours.
- Recharge time: up to 5 hours, even if the light turns green. Recommended maximum charging time is 24 hours.
- Always charge the battery immediately after riding.
- Fully charge battery before storing for extended periods of time.
- Unplug charger from the wall outlet when not in use.
- Failure to recharge battery periodically may result in a battery that will not accept a charge.
- Make sure the power button is turned **OFF** when product is not in use. If the power button is left on for an extended period of time, the battery may reach a stage at which it will no longer hold a charge.
- Run time: Up to 40 minutes of continuous ride time. Run time may vary depending on riding conditions, rider weight, climate, and/or proper maintenance.
- Constant starting and stopping may shorten ride time.
- Battery life can vary depending on proper maintenance and usage of the product.
- Do not charge at or below 32°F (0°C).

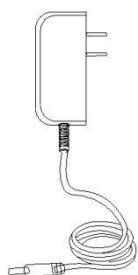

Charger
(Note: Charger design may vary from one shown)

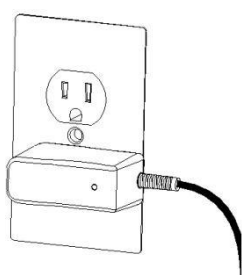

1 Plug the charger plug into wall outlet. The light on the charger should be green.

Note: If green light (LED) does not turn on, try a different outlet.

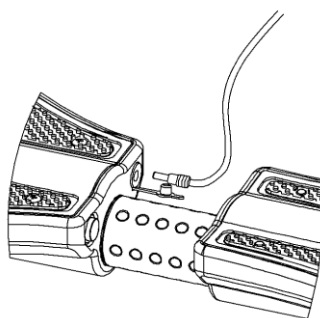

2 Note: Make sure power button is in the **OFF** position. Plug the charger into the charger port. The light on the charger should turn red during charging. The light will turn green again when charging is complete.

! WARNING: Use **ONLY** with the recommended charger.

Batteries are only to be charged under adult supervision. The charger is not a toy. Always disconnect the charger before wiping down and/or cleaning the Twistilk Electric with a damp cloth.

The charger supplied with the Twistilk Electric should be regularly examined for damage to the cord, plug, enclosure and other parts. In the event of such damage, the Twistilk Electric must not be charged until it has been repaired or replaced.

Chargers have built-in overcharge protection to prevent battery from being overcharged.

Wall outlet - Green (stand by)

Wall outlet and product
- Red (charging)

Wall outlet and product
- Green (charged)

Note: Continue charging product even if light turns green prior to 5 hours.

! WARNING: Battery charge can deplete over time. Periodically recharge battery when not in use.

PRE-RIDE CHECKLIST

Wheels

Periodically inspect the wheels for excessive wear.

Frame

Check for cracks or broken connections. Although broken frames are rare, it is possible for an aggressive rider to run into a curb or object and wreck, crack or break a frame. Get in the habit of inspecting your product on a regular basis.

Hardware/Loose Parts

Before every ride, check all parts, such as nuts, bolts, fasteners, etc., to ensure they are secure and assembled correctly. There should not be any unusual rattles or sounds from loose parts or broken components. If the product is damaged, do not ride.

Reference "Safety Warnings" on pages 1 and 2 of this manual.

Safety Gear

Always wear proper protective gear, such as an approved safety helmet. Elbow pads, kneepads and wrist guards are recommended. Always wear athletic shoes (lace-up shoes with rubber soles) and keep shoelaces tied and out of the way of the wheels, motor and drive system. **NEVER RIDE BAREFOOTED OR IN SANDALS.**

Laws and Regulations

Always check and obey any local laws or regulations.

Insurance

Do not assume that your existing insurance policies necessarily provide coverage for product use. Check with your insurance company for information regarding insurance.

USAGE

■ How to Ride

Do not activate the remote unless you are on the Twistilk Electric and in a safe, outdoor environment suitable for riding. Turn power button to the "ON" position for both the Twistilk Electric and the remote.

Place one foot on the front deck plate and with the other foot kick the ground to give it a starting speed, turn the speed switch to speed up then the motor will be engaged.

The Twistilk has two adjustable speed/acceleration ranges. You can switch the button to upper position or lower position to change the speed range.

-Lower position-Low speed

The maximum speed of the low speed range is approximately 9km/h.

Recommended for beginners and anyone who wants a slower, more controlled speed.

-Upper position-Fast speed

The maximum speed of the low speed range is approximately 15km/h.

Recommended for only the most experienced riders offers acceleration in direct response to speeding switch pressure. Sudden speeding switch pushing might result in immediate acceleration full direct control, so be careful.

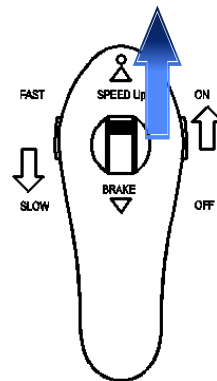
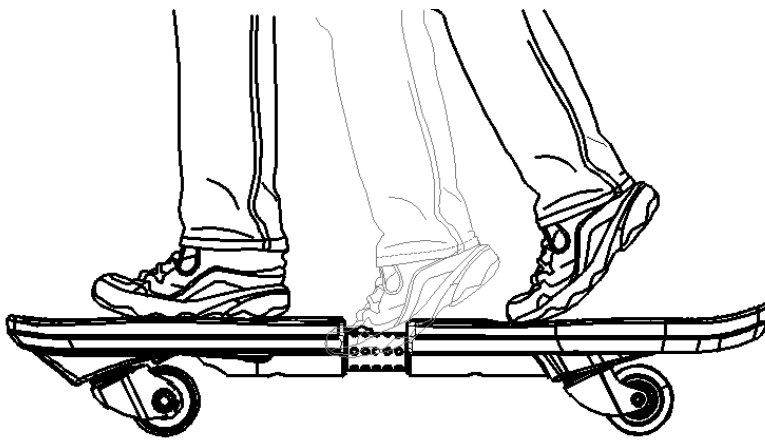

Note: The Twistilk no need starting speed before motor engaged. But in order to better balancing the board, it is recommended to kick the ground to give a starting speed before motor engaged.

Note: As an additional safety feature, the Twistilk Electric is designed to cut power to the motor when the lever on the remote is in the "STOP" or neutral position.

■ How to Stop

The Twistilk Electric, like regular skateboards does not have a conventional "brake", however the Twistilk Electric can coast to a stop or can use "dynamic motor braking" to slow more quickly.

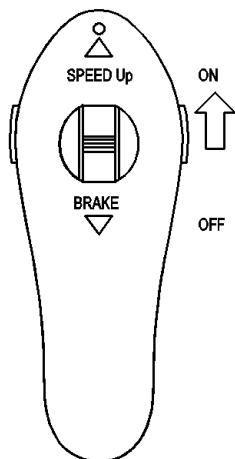

1 While riding, release the remote lever and it will return to the "NEUTRAL" position. The product "STOP" will slow to a stop with motor resistance.

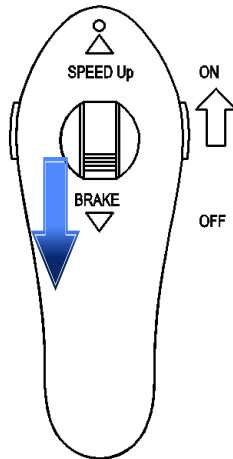

2 To slow more rapidly to a stop, move the remote lever down to the position and hold. This will engage dynamic motor braking and the product will slow down more quickly.

Note: Practice riding only in wide open areas clear from curbs, parking blocks and other obstacles. Impacting the wheels against any hard surface can damage the wheels. Wheels are not covered under the limited warranty.

Note: Stepping off the product also works to stop. Releasing the remote lever will cut power to the motor.

Need Help? Please call 800-306-3829 or send e-mails to Sales@caesarhardware.com for replacement parts or technical support.

Before beginning repair or maintenance:

- Read the instructions
- Turn the power button OFF
- Disconnect charger
- Exercise caution around exposed parts
- Contact Twistilk Customer Service if unsure about any repair or maintenance

■ Rear Caster Wheel Replacement

Tools Required: Two (2) 5 mm Allen Wrenches

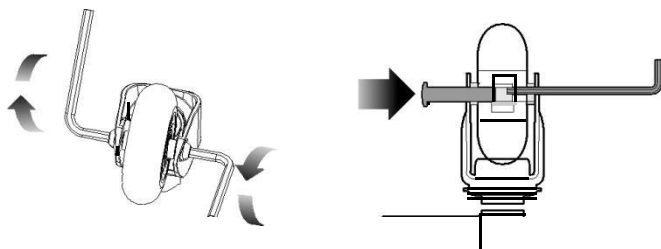

1 Turn product over. Using two (2) 5 mm Allen wrenches, loosen coupling bolt and remove wheel from caster.

2 Insert replacement wheel into caster.

Note: Make sure all three (3) spacers are aligned with the holes in the bearings before inserting the coupling bolt. Secure tightly into place.

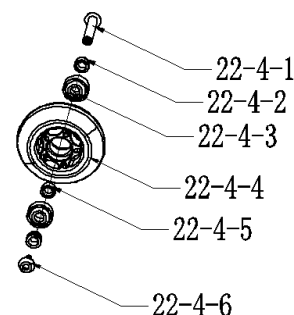

Wheel

- 4-1 & 4-6 Coupling Bolt
- 4-2 Spacer (x2)
- 4-3 Bearing (x2)
- 4-4 wheel
- 4-5 Spacer

■ Caster Replacement

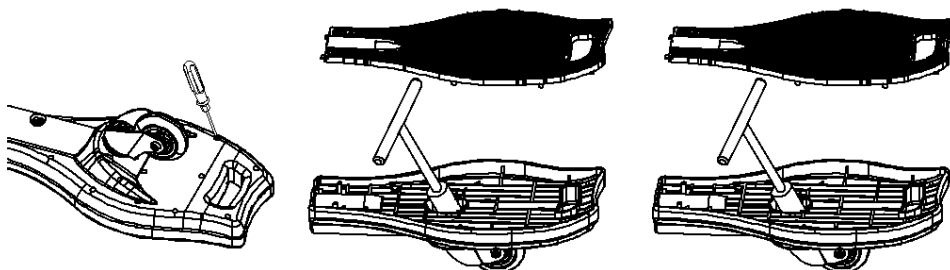

1 Remove wheel from caster (refer to step 1 above). Remove the six (6) Phillip screws attaching the deck plate to the platform.

2 Turn product over. Using a 24 mm socket wrench, loosen the nut on the caster and remove caster.

3 Insert replacement caster. Secure in place with nut removed in step 2.

Re-attach wheel to caster. (Refer to step 2 above.)

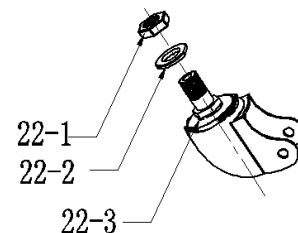

Caster

- 22-1 Lock nut
- 22-2 Spring Washer
- 22-3 Flat Washer

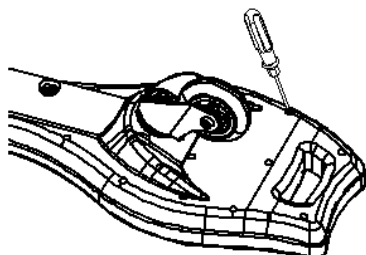

4 Re-attach the deck plate to the platform with the six (6) Phillip screws removed in step 1.

REPAIR AND MAINTENANCE

■ Front Wheel/Hub Motor Replacement

Tools Required: Phillips Screwdriver and Two (2) 17mm Wrenches

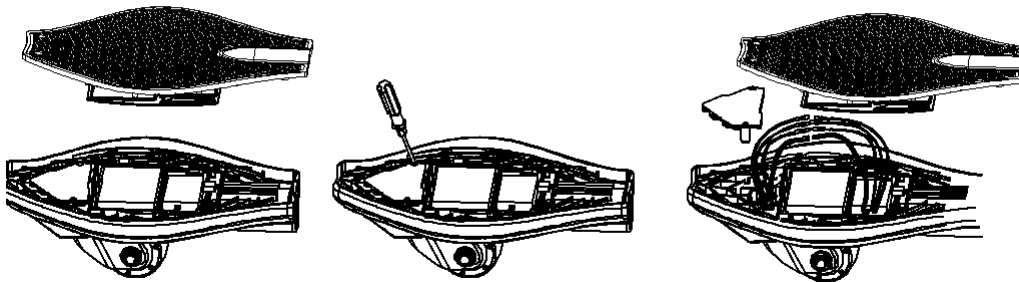

1 Turn product over. Loosen the four (4) Phillip screws on the rear platform cover and remove cover.

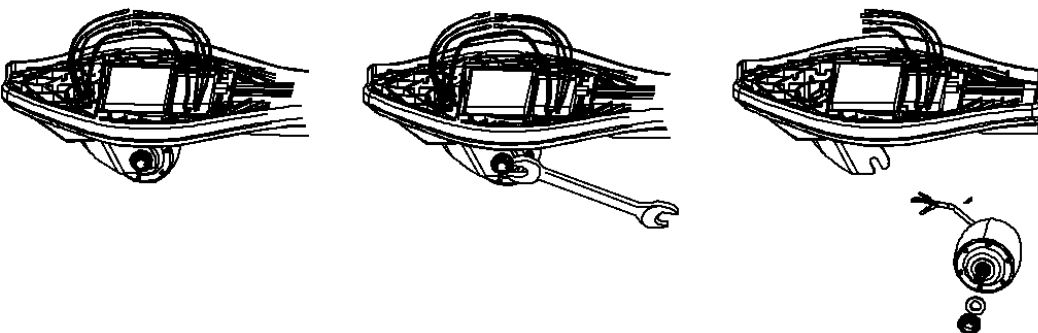

2 Disconnect the motor connector from the control module, using a thin needle to disconnect the motor wire pin from the wire plug.

3 Using a 17 mm wrench, loosen the outside locknut . Use a 17mm wrench to prevent the other side locknut from turning. Pull out the motor wire from the bearing, Remove the hub motor

4 Install the replacement wheel/hubmotor by reversing steps 1-4

Note: Front wheel/hub motor hardware sequence

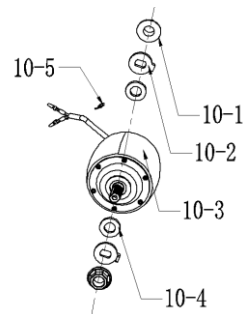

Right Side

10-1 Flange Nut
10-2 Washer with hook
10-5 Zip tie

Left Side

10-3 Wheel
10-4 Flat washer

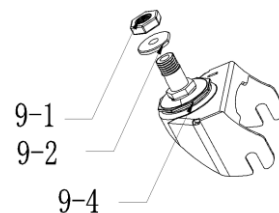

Caster

9-1 Lock nut
9-2 Spring Washer
9-4 Flat Washer

REPAIR AND MAINTENANCE

■ Remote Battery Replacement

Tool Required: NON

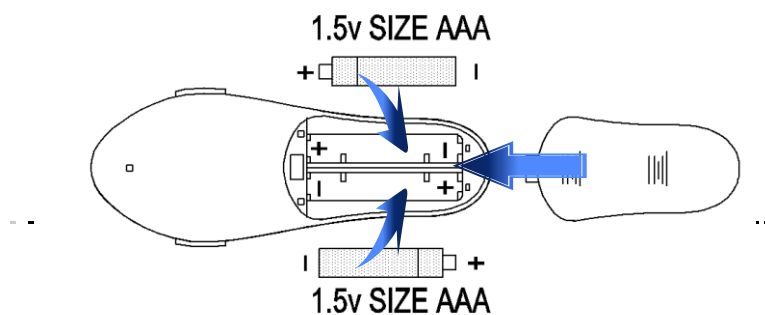

1 Loosen Phillips screw on battery cover and remove cover. Remove old batteries and properly dispose.

2 Install two (2) AAA replacement batteries.

3 Re-attach battery cover and securely tighten in place with screw.

Note: AAA batteries are not covered under the limited warranty.

■ Product Battery Replacement

Tool Required: Phillips Screwdriver

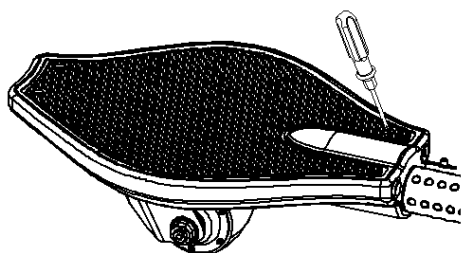

1 Turn product over. Loosen the Phillips screw on the battery cover and remove cover.

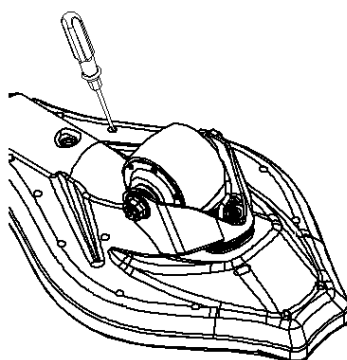

2 Disconnect the battery connector from the control module and carefully remove the battery from product.

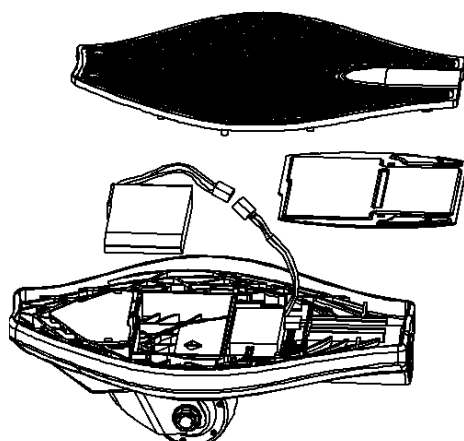

3 Install replacement battery. Re-connect the battery connector to the control module.

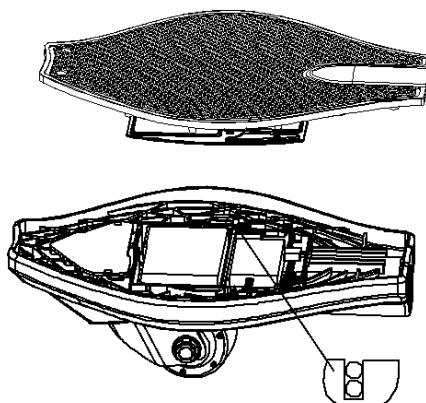

4 Re-attach battery cover and securely tighten in place with screw.

⚠ WARNING:

- Contains a lithium-ion battery pack - adult attention for changing and disposal.
- Battery should only be replaced by an adult.
- Dispose of batteries properly. See Page 10 – Battery Care and Disposal.
- Battery pack should not be disassembled, crushed, punctured, opened or otherwise mutilated.

REPAIR AND MAINTENANCE

■ Battery Care and Disposal

Do not store in freezing or below freezing temperatures. To properly maintain your battery and ensure maximum battery life, carefully read the "Charging the Battery" section on page 6 of this owner's manual.

Battery pack should not be disassembled, crushed, punctured, opened or otherwise mutilated.



CONTAINS LITHIUM ION BATTERY PACK. BATTERIES MUST BE RECYCLED.

Disposal: Your Twistilk Electric uses a lithium ion battery pack which must be recycled or disposed of in an environmentally safe manner. Do not dispose of a battery pack in a fire. The battery pack may explode or leak.

Do not dispose of a battery pack in your regular household trash. The incineration, land filling or mixing of batteries with household trash is prohibited by law in most areas. Return exhausted batteries to a federal or state approved lithium-ion battery recycler.

■ Charger

The charger supplied with the Twistilk Electric should be regularly examined for damage to the cord, plug, enclosure and other parts and in the event of such damage, the product must not be charged until it has been repaired or replaced.

Use ONLY with the recommended charger.

■ Wheels

Wheels and drive system are subject to normal wear and tear. It is the responsibility of the user to periodically inspect wheels for excess wear and replace hub motor as required.

■ Replacement Parts & repair centers

Please call 800-306-3829 or send e-mails to Sales@caesarhardware.com for replacement parts or technical support.

⚠ WARNING: If a battery leak develops, avoid contact with the leaking solution and place the damaged battery in a plastic bag. Refer to the disposal instructions at left. If solution comes into contact with skin, wash with soap and water immediately, neutralize with lemon juice, vinegar or other mild acid, and contact a physician. If solution comes in contact with eyes, flush immediately with water and contact a physician.

Recycling Lithium-Ion Batteries:

Lithium-ion batteries are recyclable. You can help preserve our environment by returning your used rechargeable batteries to the collection and recycling location nearest you.

For more information regarding recycling of rechargeable batteries, call toll free 1-800-822-8837, or visit <http://www.call2recycle.org>

Caution: Do not handle damaged or leaking lithium-ion batteries.

TROUBLESHOOTING GUIDE

*Product(s) should be turned **OFF** and fully charged prior to doing any Troubleshooting.

NOTE: All troubleshooting steps should be performed by an adult only.

Problem	Possible Cause	Solution
Does not work out of the box		
	Product not paired with remote	Refer to page 4 for pairing information.
No longer works	No lights on charger	Check power to wall outlet and/or try a different outlet.
	Undercharged battery	Check lights on charger: Plugged into wall - Green Plugged into wall & unit - Red (charging) Plugged into wall & unit - Green (charging complete) No lights/Blinking lights - Replace Charger
	Battery will not hold a charge	Turn product over. Turn the power switch on the remote and product to the ON position. Move the lever on the remote to the GO position and hold, If motor engages - replace battery.
Short run time/runs slow	Riders weight	Do not exceed 143 lb (65 kg) maximum weight limit.
	Riding conditions	Use only on flat, dry surfaces. Avoid inclines and areas with heavy debris.
	Battery not fully charged	Charge product - refer to page 6 for charging information.
	Old/damaged battery	Replace battery. Charge battery at least once a month when not in use.

For more troubleshooting tips, Please call 800-306-3829 or send e-mails to Sales@caesarhardware.com

TWISTILK ELECTRIC PARTS

Call us or e-mail us for more information on spare part availability. (Specifications subject to change without notice.)

1	Phillip screw	9	Front Caster	17	Torsion Bar Cover
2	Deck Plate (Front)	10	Front Wheel/ Hub Motor	18	Torsion Bar
3	Tapping screw	11	Iron plate	19	Socket cap screw
4	Platform Cover	12	Control Module	20	Deck Plate (Rear)
5	Battery	13	Charger Port	21	Platform (Rear)
6	Platform (Front)	14	On/Off Button	22	Rear Caster
7	Nut	15	Steel tube	23	Remote
8	Tapping screw	16	Plastic sleeve	24	Charger (Not Shown)

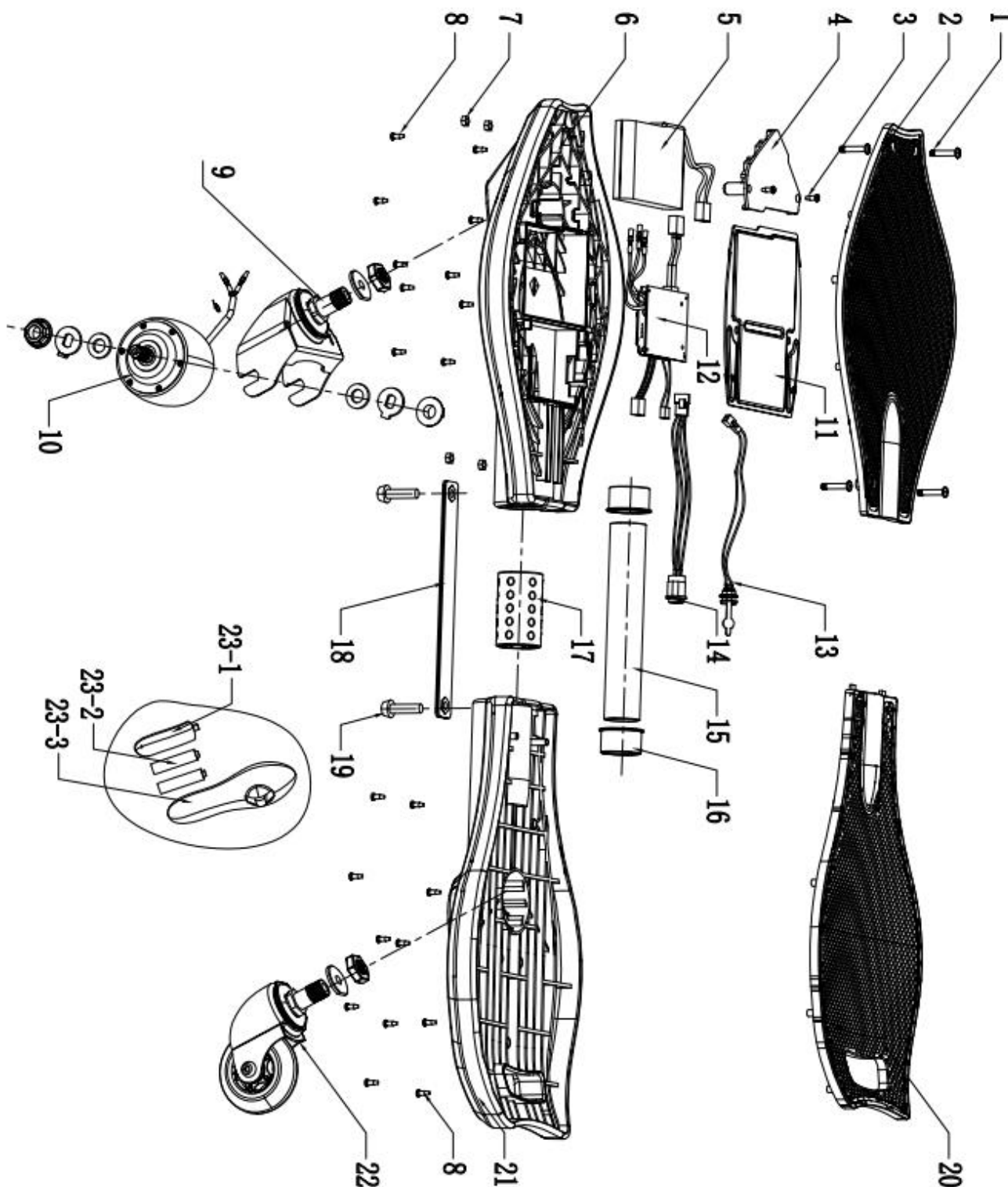

Need Help? Please call 800-306-3829 or send e-mails to Sales@caesarhardware.com for replacement parts or technical support.

FCC COMPLIANCE

This device complies with Part 15 of the FCC Rules. Operation is subject to the following two conditions:

- (1) This device may not cause harmful interference, and
- (2) this device must accept any interference received, including interference that may cause undesired operation.

Note: This equipment has been tested and found to comply with the limits for a Class B digital device, pursuant to part 15 of the FCC Rules. These limits are designed to provide reasonable protection against harmful interference in a residential installation. This equipment generates, uses and can radiate radio frequency energy and, if not installed and used in accordance with the instructions, may cause harmful interference to radio communications. However, there is no guarantee that interference will not occur in a particular installation. If this equipment does cause harmful interference to radio or television reception, which can be determined by turning the equipment off and on, the user is encouraged to try to correct the interference by one or more of the following measures:

- Reorient or relocate the receiving antenna.
- Increase the separation between the equipment and receiver.
- Connect the equipment into an outlet on a circuit different from that to which the receiver is connected.
- Consult the dealer or an experienced radio/TV technician for help.

⚠ WARNING: Changes or modifications to this product not expressly approved by us, could void the user's authority to operate the equipment.

WARRANTY

Limited Warranty

The manufacturer warrants this product to be free of manufacturing defects for a period of 90 days from date of purchase. This Limited Warranty does not cover normal wear and tear, wheel, or any damage, failure or loss caused by improper assembly, maintenance, storage or use of the Twistilk Electric.

This Limited Warranty will be void if the product is ever:

- used in a manner other than for recreation or transportation;
- modified in any way;
- rented.

The manufacturer is not liable for incidental or consequential loss or damage due directly or indirectly to the use of this product.

We does not offer an extended warranty. If you have purchased an extended warranty, it must be honored by the store at which it was purchased.

For your records, save your original sales receipt with this manual and write the serial number below.

CUSTOMER SERVICE CONTACT INFORMATION

Need Help? Please call 800-306-3829 or send e-mails to Sales@caesarhardware.com

NOTICE: INSURANCE

YOUR INSURANCE POLICIES MAY NOT PROVIDE COVERAGE FOR ACCIDENTS INVOLVING THE USE OF THIS PRODUCT. TO DETERMINE IF COVERAGE IS PROVIDED, YOU SHOULD CONTACT YOUR INSURANCE COMPANY OR AGENT.