

AIRCRAFT LED INDICATORS

The aircraft LED indicators are located under each motor and at the rear of the aircraft. The LED indicates the current state of the aircraft. See diagrams below for indications.

INITIALIZING / WAITING FOR RC SIGNAL

(Front: **Red**, Rear : **Red** / **Green** / **Yellow** alternating fast blinking LED)

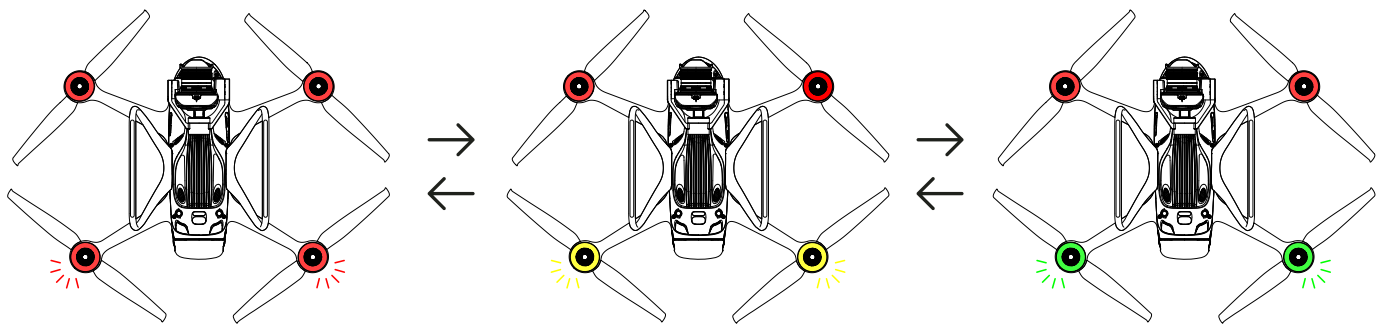

READY TO FLY (ALTITUDE / POSITION / SPORT MODE)

ALTITUDE MODE

(Front: **Red**, Rear: **Yellow**)

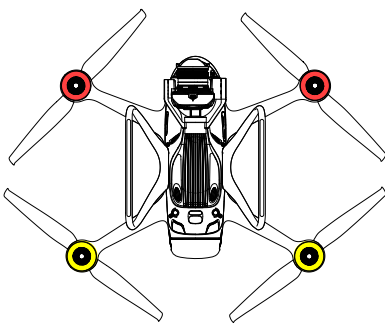

POSITION MODE

(Front: **Red**, Rear: **Blue**)

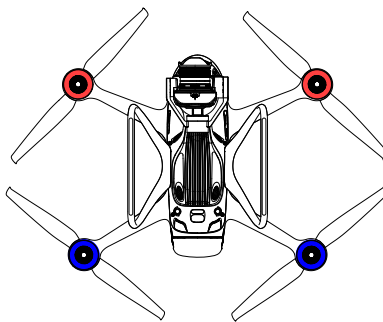

SPORT MODE

(Front: **Red**, Rear: **Purple**)

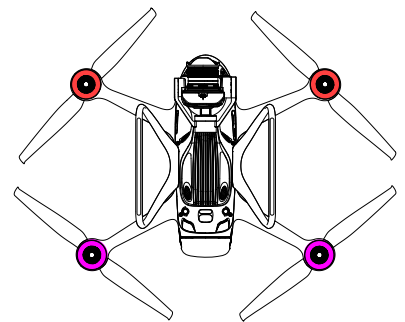

You can customize the front LED lights in different flight modes under the following path: DRONE SETTINGS > AIRCRAFT > LED LIGHTS

LANDING MODE

(Front: Red, Rear : Yellow / Blue)

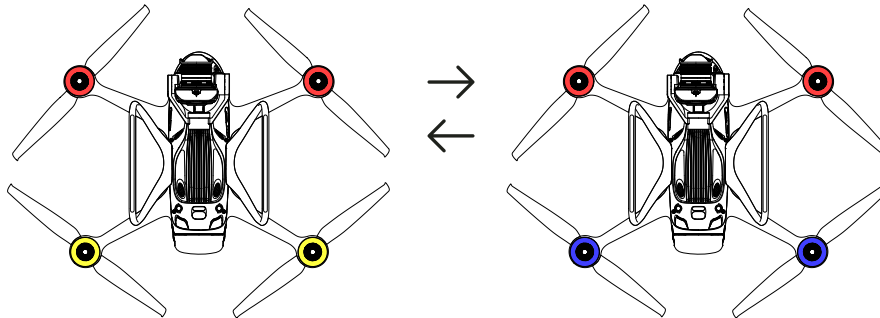

Make sure to pay attention to your landing environment when this mode is activated.

UNSUCCESSFUL ARM

(Front: Red, Rear : Red - fast blinking 3 times)

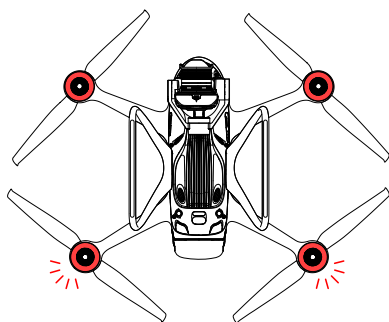

ERROR/MALFUNCTION

(Front: Red, Rear : Red - fast blinking continuously)

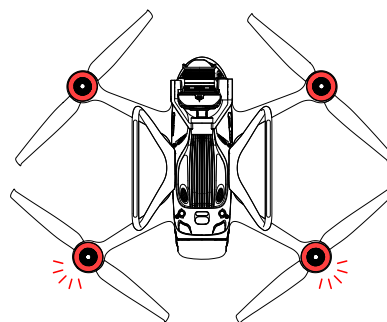

When encountered in midflight, please land the aircraft immediately.



Contact XDynamics Supports.

ENSURE CORRECT PROPELLER ALIGNMENT

The propellers need to be mounted with the correct CW (clockwise) and CCW (counter-clockwise) configurations. Two propellers are marked with white rings and two propellers have no markings. Mount the propellers with the white rings to the motors with a white ring on top. Please follow the steps on the following page to ensure all propellers are securely in place.

SEE DIAGRAM FOR ATTACHING AND DETACHING THE PROPELLERS

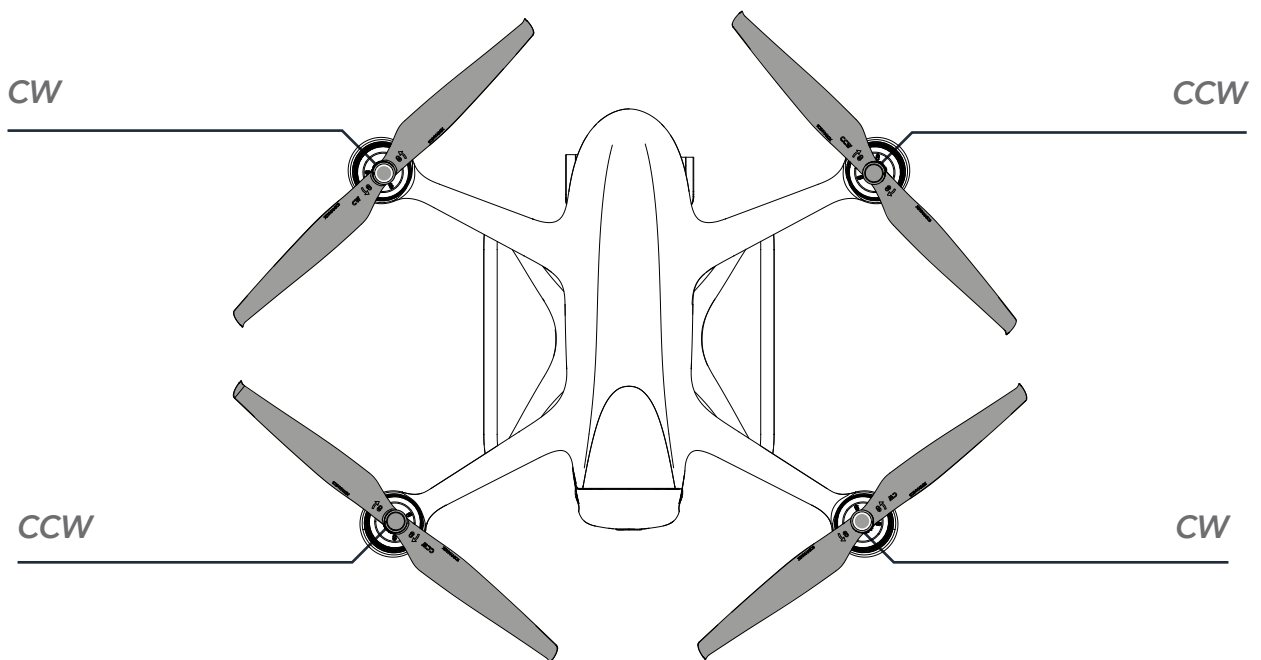

- Ensure that both CW props with white circle markings match motors with white circle markings.
- Ensure that both CCW props with no circle markings match motors with no circle markings.
- Place the propeller on the motor with the red dot in-line with the white lock, apply a downward force, then twist in the direction of the arrow until the red dot is lined up with the red lock. Release and the propeller should spring up slightly and lock in place.

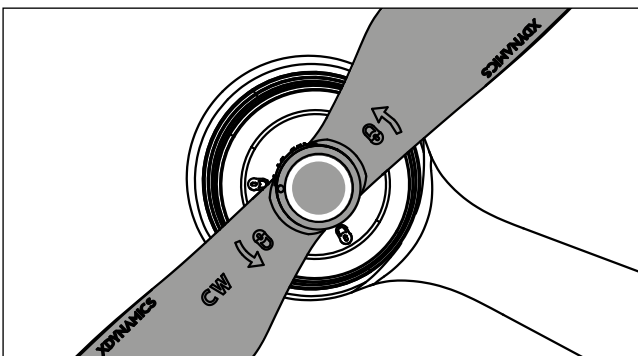

CW Props

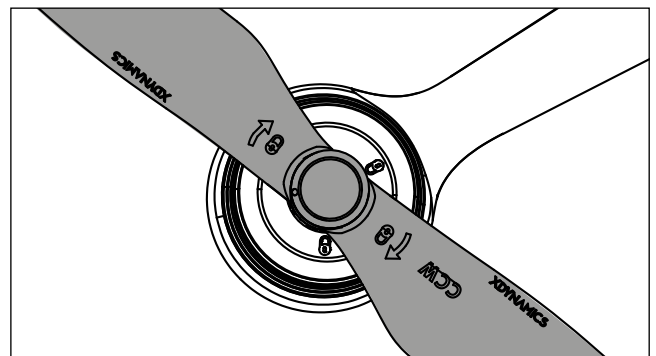

CCW Props

ATTACHING AND DETACHING THE PROPELLERS

The EVOLVE 2 aircraft employs a sturdily constructed attach and detach propeller system. With a quick half turn installation, the aircraft can be ready to fly within minutes of pulling it out of the pack. To detach the propellers, follow the steps below in reverse. Before installing the props, please make sure that the pre-flight check list is complete.

SEE DIAGRAM FOR ATTACHING AND DETACHING THE PROPELLERS

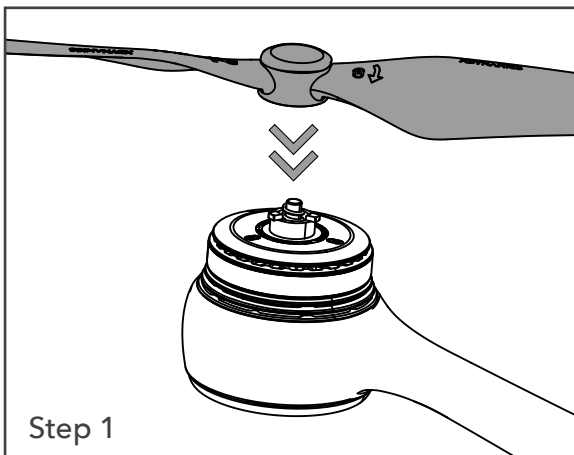

Step 1 - Ensure that the CW / CCW direction of the propeller is aligned with the direction of the motor.

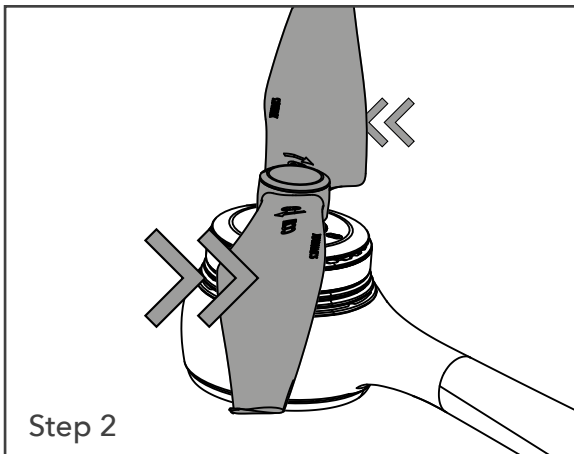

Step 2 - Place the propeller on top of the motor, apply a downward force. Hold the motor still and twist the propeller in the direction of the arrows shown on its surface.

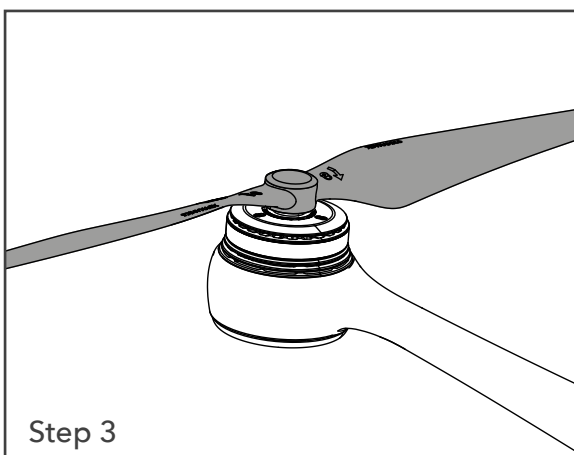

Step 3 - Continue twisting the propeller with downward force until the red dot on the propeller and the red lock on the motor are aligned. Once you release the downward force, the propeller should pop up and lock securely into place. Confirm it is secure by twisting the propeller left and right while holding the motor in place. The propeller should now be firmly secure.