



VT12W

User' Manual

P1

● Note

■ Before start using the product, please read the Operating Guide to enable optimum usage.

■ Warranty period is 1 year from date of purchase.

■ The property right of all parts in this product including fittings and relevant accessories belong to Virtual Trunk Pte. Ltd. (The “Company”), any unlawful imitation, reproduction, extract and/or translation is not permissible without the written consent and permission from the company.

■ This product involves constant upgrading and/or improvement, our company reserves the right to change the specifications of software and/or hardware mentioned in this operating guide without any prior notice. The product specifications and information mentioned in the operating guide are for reference only.

● Important Safety Instructions

■ To prevent possible hearing damage, do not listen at high volume levels for long periods.

■ Please use appointed battery in case of explosion risk, please dispose of lifeless battery under guidance. Recycle your phone



■ The WEEE logo appears on the product to indicate that this product must not be disposed off or dumped with your other household wastes. You are liable to dispose of all your electronic or electrical waste equipment by relocating over to the specified collection point for recycling, of such hazardous waste.



P2

● Check list

Check the packing box of this product for any signs of damage.

Unpack the content of the box. We recommend that you identify the items listed in the list below. If you find any item that are missing or Damaged, Please contact your dealer immediately.

Content

Accessories	Quantity
IP Walkie Talkie	1
Antenna	1
Lithium Battery(with Belt Clip)	1
Desktop Charger	1
Charging Plug	1
USB Data Cable	1
Lanyard	1
User Manual	1

P3

Attaching/Removing the SIM Card

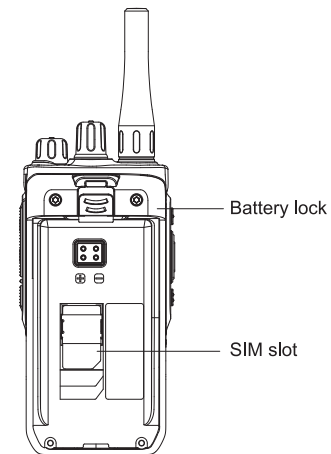

Insert the SIM Card into the SIM slot as shown in the picture.

To Remove the SIM card, push the SIM card out of the SIM slot shown.

P4

Attaching/Removing the Battery

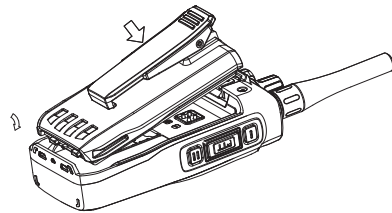

To install the battery fit in the battery to the battery compartment from the bottom of the battery. Press the top part of the battery towards the IP smart terminal until a click is heard. The battery is locked in place.

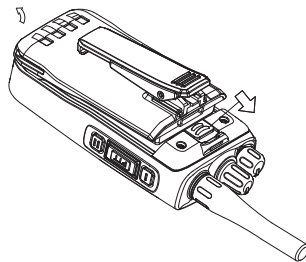

To remove the battery – power off the terminal, push the battery lock upwards subsequently pull the top part of the battery away from the IP smart terminal. Lift up the whole battery.

P5

Installing/Removing the Antenna

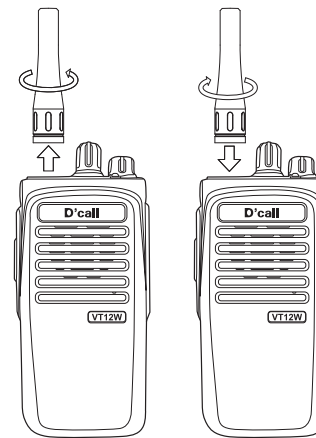

Align the treaded end of the antenna with the IP smart terminal's antenna socket then turn the antenna clockwise to fasten it.

Turn the antenna anti-clockwise until it is detached from the socket to remove it.

P6

Attaching and removing the belt clip

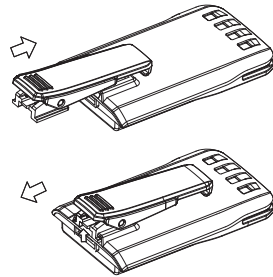

Align the grooves of the belt clip with those of the battery. Push the belt clip into the groove until it is latched on.

Installing Earphone/ USB Cable



Lift the audio accessory dust cover and insert the earphone or USB cable plug into the relevant socket.

USB functions: **Only for software upgrades**

P7

Charging the Battery

1)By Desktop Charger

Connect the Desktop Charger and the Power Adapter using the USB Data Cable. Blinking Red light on the desktop charger indicates battery charging in progress. Green light on the desktop charger indicates battery is fully charged.

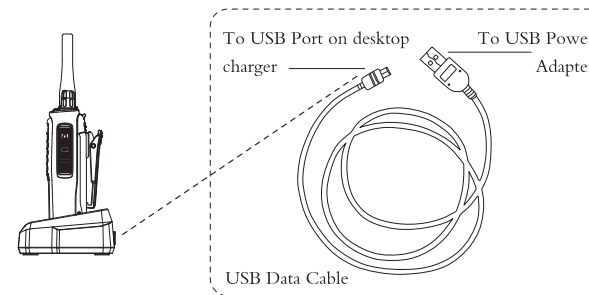

P8

2)By USB Data Cable

Connect the IP smart terminal and power adapter using the USB Data Cable.
Blinking Red light on the IP smart terminal indicates battery charging in progress.
Lights off indicates battery is fully charged.

WARNING: DO NOT USE THE ABOVE TWO CHARGING METHODS SIMULTANEOUSLY.

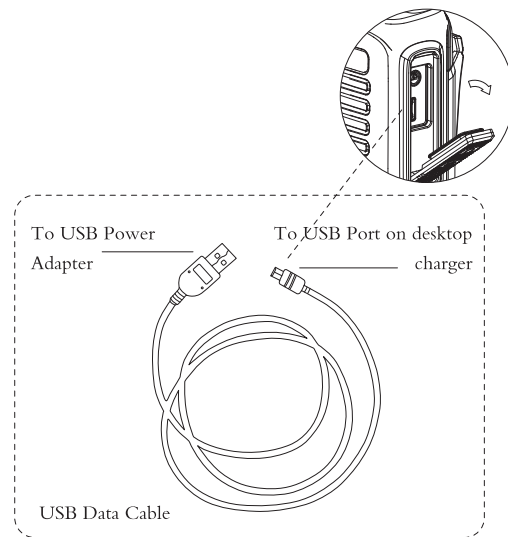

P9

Important:

Use only the approved D'Call designated charger.
Battery must be fully charged before first use.
Do not expose the battery to high temperature.
Do not dismantle the battery.

Get familiar with Device

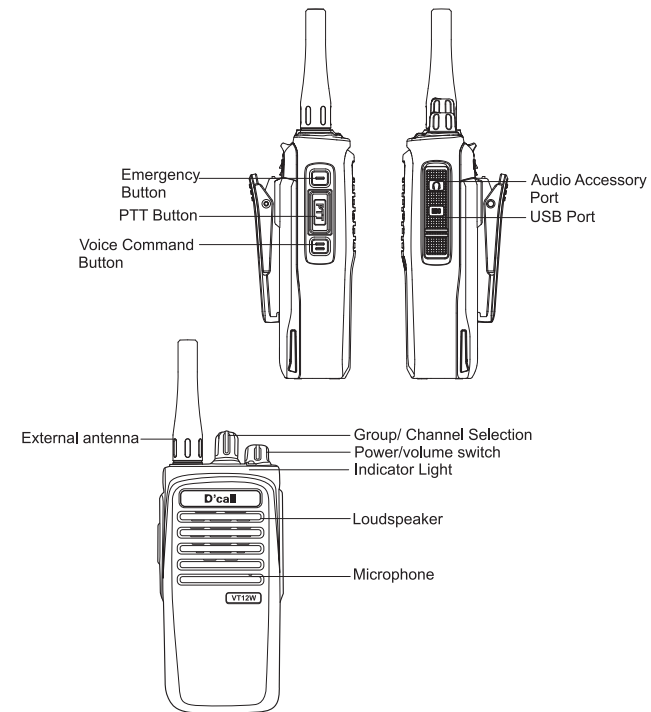

P10

- Power/volume switch

Turn the power / volume switch clockwise to turn on the IP smart terminal and /or increase the volume.

Turn the power / volume switch anti-clockwise to turn the decrease the volume and / or power off.

- LED indicator light

Operating state	Indication
USB Charging	Red (Blinking)
Network Search	Yellow (Steady)
No Network Service	Red (Steady)
Standby Mode	Green (Steady)
PTT	Green, (Steady)
PTT Receiving/ Queuing	Green (Blinking)
Emergency Initiation	Yellow (Blinking)
Emergency Call Ongoing	Yellow (Steady)
Private Call Initiation	Blue (Blinking)
Private Call Ongoing	Blue (Steady)
Low Battery	Yellow (Steady)
Hibernating	No Light

P11

Basic operation

The IP walkie talkie is base on the PoC(PTT over Cellular) technology,Voice is transfered by 2G/3G data channel.

PoC as below:

The PoC feature involves the use of a terminal device that provides a button or other facility to place PoC calls.

A PoC call consists of a series of talk bursts between two or more individuals that comprise a single conversation.

A PoC call is referred to as a one-to-one PoC call, when only two individuals participate in the PoC call. A PoC call is referred to as a one-to-many or a group PoC call,

when more than two individuals participate in the PoC call.

P12

1)Startup

Turn on the IP smart terminal.

You will hear the “Startup tone” follow by a voice announcement upon logging in.

When “Group No.” is announced, it indicates successful login.

2)Volume Adjustment

Turn the power/volume knob clockwise or anti clockwise to increase or decrease the volume.

3)Group / Channel Selection

Turn channel selection knob to change group. (The new group name will be announced)

4)Group Call

Press and hold the PTT button until you hear the permit tone.

You are now connected to the group and you may begin to talk to the group.

Release the PTT button to end the call and the IP smart terminal will be in the receiving mode.

5)Private Call

a)When there is an incoming “Private Call” , the caller’ s ID will be announced.

To answer, press and hold the PTT button.

To end the call short press the voice command button.

b)To make a private call press and hold the voice command button and say “call (ID number)” and release the voice command button.

6) Dynamic PTT

(a) When there is an incoming “Dynamic PTT” , the caller’ s ID will be announced.

To answer, press and hold the PTT button.

To end the call short press the voice command button.

(b) To make a Temporary PTT press and hold the voice command button and say “PTT (ID number)” and release the voice command button.

7)Emergency Call

Press and hold the Emergency button for 3 seconds and an emergency call will be made to the Console.

8)Other Voice Command

Time— “what time”

Firmware— “version”

Account Number— “Account number”

Signal Strength— “Signal”

Battery Power— “Power”

Troubleshooting

No.	Problem	Solution
1	Silent, no response	<ul style="list-style-type: none">● Battery may be flat. Replace or charge it.● Battery may not be installed properly, re-install battery.● Check if IP smart terminal is power on.● Check if any audio accessories are connected.● Check the volume level.
2	Unable to make/ receive calls	<ul style="list-style-type: none">● Check if you are in the same group.● Check if the network is connected.
3	Battery drained rapidly.	<ul style="list-style-type: none">● Turn off the power when not in use.

FCC NOTE:

This device complies with Part 15 of the FCC Rules.

Operation is subject to the following two conditions: (1) this device may not cause harmful interference, and (2) this device must accept any interference received, including interference that may cause undesired operation.

THE MANUFACTURER IS NOT RESPONSIBLE FOR ANY RADIO OR TV INTERFERENCE CAUSED BY UNAUTHORIZED MODIFICATIONS OR CHANGE TO THIS EQUIPMENT. SUCH MODIFICATIONS OR CHANGE COULD VOID THE USER'S AUTHORITY TO OPERATE THE EQUIPMENT.

This equipment has been tested and found to comply with the limits for a Class B digital device, pursuant to part 15 of the FCC Rules. These limits are designed to provide reasonable protection against harmful interference in a residential installation. This equipment generates, uses and can radiate radio frequency energy and, if not installed and used in accordance with the instructions, may cause harmful interference to radio communications. However, there is no guarantee that interference will not occur in a particular installation. If this equipment does cause harmful interference to radio or television reception, which can be determined by turning the equipment off and on, the user is encouraged to try to correct the interference by one or more of the following measures:

- Reorient or relocate the receiving antenna.
- Increase the separation between the equipment and receiver.
- Connect the equipment into an outlet on a circuit different from that to which the receiver is connected.
- Consult the dealer or an experienced radio/TV technician for help.

This device meets the government's requirements for exposure to radio waves. This device is designed and manufactured not to exceed the emission limits for exposure to radio frequency (RF) energy set by the Federal Communications Commission of the U.S. Government.

The exposure standard for wireless devices employs a unit of measurement known as the Specific Absorption Rate, or SAR. The SAR limit set by the FCC is 1.6 W/kg. *Tests for SAR are conducted using standard operating positions accepted by the FCC with the device transmitting at its highest certified power level in all tested frequency bands.

Although the SAR is determined at the highest certified power level, the actual SAR level of the device while operating can be well below the maximum value. This is because the device is designed to operate at multiple power levels so as to use only the power required to reach the network. In general, the closer you are to a wireless base station antenna, the lower the power output.

The highest SAR value for the device as reported to the FCC when tested for use at the face is 0.151W/kg and when worn on the body, as described in this user guide, is 0.051W/kg (Body-worn measurements differ among devices, depending upon available enhancements and FCC requirements.) While there may be differences between the SAR levels of various devices and at various positions, they all meet the government requirement. The FCC has granted an Equipment Authorization for this device with all reported SAR levels evaluated as in compliance with the FCC RF exposure guidelines. SAR information on this device is on file with the FCC and can be found under the Display Grant section of <http://www.fcc.gov/oet/fccid> after searching on FCC ID: 2AKDAVT12W.

For body worn operation, this device has been tested and meets the FCC RF exposure guidelines for use with an accessory that contains no metal and the positions the handset a minimum of 0 mm distance from the body

For hand-held operation, the minimum distance is 2.5 cm from the body or the face. Use of other enhancements may not ensure compliance with FCC RF exposure guidelines.