

Deako Smart Dimmer

Single Pole Smart Dimmer

Master Smart Dimmer

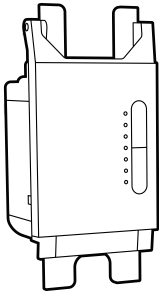



Remote Smart Dimmer

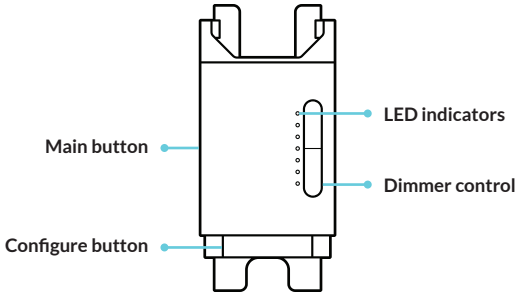

Get to know your Deako Switch



LED key

LED COLOR	WHAT IT MEANS
 Blinking green	Powering up
 Blinking purple	Linking mode
 Blinking blue	Pairing mode
 Blinking white	Pairing or Linking

LED COLOR	WHAT IT MEANS
○ Solid white	Pairing or Linking successful
● Blinking red	Error occurred, try again
● Solid red	Factory resetting

**How many switches
control this light?**



1 switch

If one switch controls this light,
CONTINUE TO PAGE 8

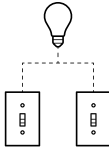

2+ switches

If two or more switches control
this light, **TURN TO PAGE 12**

Insert a switch

- 1** Align the **blue tab** on the backplate with the top of the switch

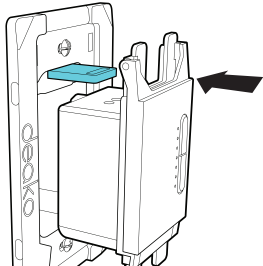

- 2** While **pressing the switch** inwards, push in the **blue tab**

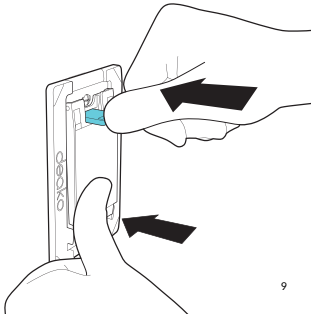

Installation complete!
Now let's get smart.

Pairing

Control your new smart switch by downloading the Deako App.



What you'll need



1x master dimmer

One master dimmer

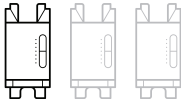

1+ remote dimmer

One remote dimmer for each
additional switch location

Switch types

Identify the switch type by looking at the **sticker** found on the back of your switch.

You will either have a **Master Smart Dimmer** or **Remote Smart Dimmer**.

If you have a different type of switch, go to support.deako.com for more information

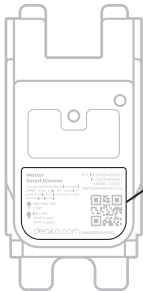

Master Smart Dimmer

For use with Deako Backplates model DS-BP series only. For control of permanently installed fixtures using dimmable bulbs only.



LED / MLV / ELV
150W



INC / HAL
300W (1-gang)
200W (2-gang+)

FCC ID: 2AK29-DS2011
IC: 22393-DS2011
MODEL: DS2011
DS-CD3M-WHMC-UCX



deako.com 9696669209165087

Remove existing dimmer

- 1** If there is a switch installed in the backplate you want to upgrade, start by **pulling the corner** of the faceplate

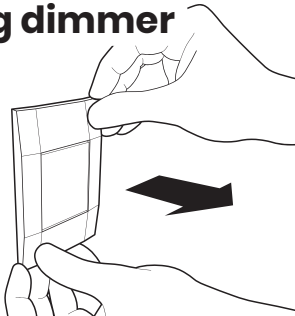

2 Pull the **blue tab** outwards to release the switch

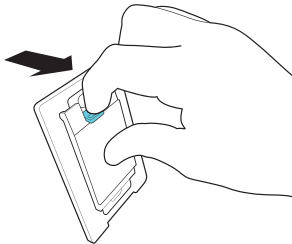

Insert Remote Dimmer

- 3** Locate the **powered backplate** in the circuit by inserting a **Remote Smart Dimmer** into a backplate in the circuit

Align the **blue tab** on the backplate with the top of the switch

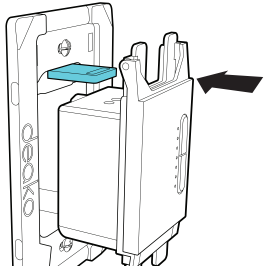

4 While **pressing the switch**
inwards, push in the **blue tab**

If the backplate is powered,
the switch will flash ● **green**

*If switch does not flash green, move to
the next location & repeat step 1*

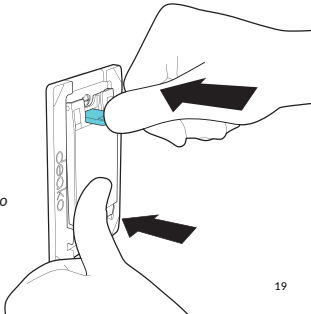

5

Wait until the switch stops flashing green, then **press & hold** the configure button until it flashes ● **purple**

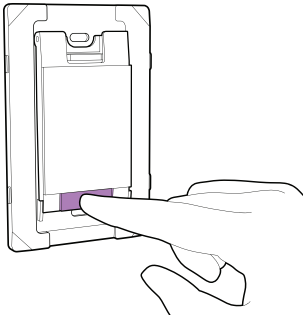

- 6** Move to the next powered backplate, then **repeat steps 1-5 for each switch in the circuit** until you get to the last switch

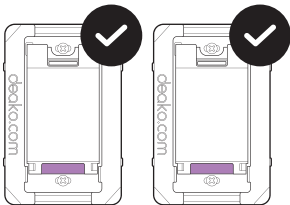

Insert Master switch

- 7** On the last switch in the circuit, insert the Master Smart Dimmer

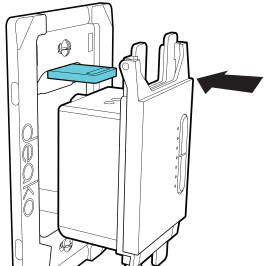

8 Wait until the switch stops flashing green, then **press & hold** the configure button until it flashes ● **purple**

Once all switches in the circuit are flashing ● **purple**, continue to step 9

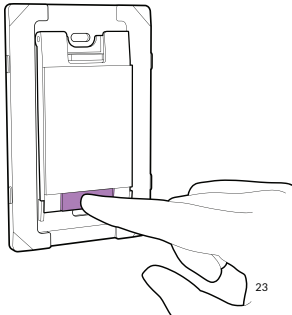

- 9** Once all switches in the circuit are flashing purple, **press & hold** the configure button on any switch until it flashes  **white**

Once the switches show solid white and turn off, linking is complete

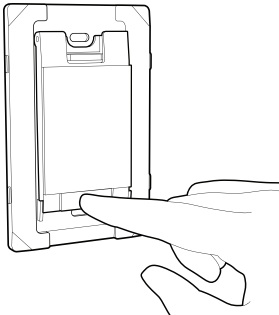

10 To test if they've been successfully linked, **press each switch** to confirm that they control the light

Now you're ready to pair your switches with the **Deako App**

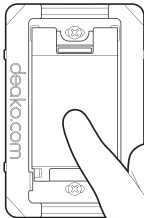

Troubleshooting

- Linking is **only required for 3-way and 4-way** wiring configurations
- If at any point a switch blinks red, **factory reset** it and try again
- To exit linking mode at any point, **press & hold the configure button for 10 seconds** to factory reset each switch before retrying
- If you have dead-end or other nontraditional wiring in your home, you can find wiring and setup instructions at **deako.com/wiring**

Factory reset

Press & hold the configure button for 10 seconds (the LED will be appear solid ● red).

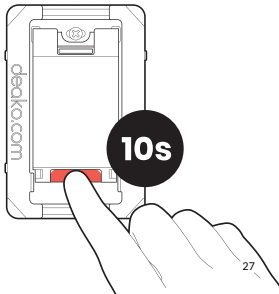

FCC Statement

This device complies with part 15 of the FCC Rules. Operation is subject to the following two conditions:

- (1) This device may not cause harmful interference, and
- (2) This device must accept any interference received, including interference that may cause undesired operation.

Any Changes or modifications not expressly approved by the party responsible for compliance could void the user's authority to operate the equipment.

Note: This equipment has been tested and found to comply with the limits for a Class B digital device, pursuant to part 15 of the FCC Rules. These limits are designed to provide reasonable protection against harmful interference in a residential installation. This equipment generates uses and can radiate radio frequency energy and, if not installed and used in accordance with the instructions, may cause harmful interference to radio communications. However, there is no guarantee that interference will not occur in a particular installation. If this equipment does cause harmful interference to radio or television reception, which can be determined by turning the equipment off and on, the user is encouraged to try to correct the interference by one or more of the following measures:

- ▶ -Reorient or relocate the receiving antenna.
- ▶ -Increase the separation between the equipment and receiver.
- ▶ -Connect the equipment into an outlet on a circuit different from that to which the receiver is connected.
- ▶ -Consult the dealer or an experienced radio/TV technician for help.

RF warning:

This equipment complies with FCC radiation exposure limits set forth for an uncontrolled environment. This equipment should be installed and operated with minimum distance 20cm between the radiator & your body.

IC Statement

-English: This device contains licence-exempt transmitter(s)/receiver(s) that comply with Innovation, Science and Economic Development Canada's licence-exempt RSS(s). Operation is subject to the following two conditions:

- (1) This device may not cause harmful interference, and
- (2) This device must accept any interference received, including interference that may cause undesired operation of the device.

The digital apparatus complies with Canadian CAN ICES-3 (B)/NMB-3(B)

This device must be installed and operated with a minimum distance of 20 cm between the radiator and user body.

-French: L'émetteur/récepteur exempt de licence contenu dans le présent appareil est conforme aux CNR d'Innovation, Sciences et Développement économique Canada applicables aux appareils radio exempts de licence. L'exploitation est autorisée aux deux conditions suivantes:

- (1) l'appareil ne doit pas produire de brouillage, et
 - (2) l'appareil doit accepter tout brouillage radioélectrique subi, même si le brouillage est susceptible d'en compromettre le fonctionnement.
- L'appareil numérique du CIEM conforme canadien peut -3 (b)/NMB -3(b).

Cet appareil est conforme à l'exemption des limites d'évaluation courante dans la section 2.5 du CNR - 102 et conformité avec RSS 102 de l'exposition aux RF, les utilisateurs peuvent obtenir des données canadiennes sur l'exposition aux champs RF et la conformité. This equipment complies with Canada radiation exposure limits set forth for an uncontrolled environment.

Cet équipement est conforme aux limites d'exposition aux rayonnements de la IC établies pour un environnement non contrôlé. Cet équipement doit être installé et fonctionner à au moins 20 cm de distance d'un radiateur ou de votre corps. Cet émetteur ne doit pas être co-localisé ou fonctionner en conjonction avec une autre antenne ou un autre émetteur.

Need help?

support.deako.com

1-844-673-3256

deako®