



1/General Information

- 1.1 Description
- 1.2 Specification

2/Hardware description

- 2.1 Front Panel
- 2.2 RJ45 Ethernet port
- 2.3 Micro USB Power supply port
- 2.4 Stand
- 2.5 Mounting holes

3/How to use

- Transmission Mode
- 3.1 Network setup
- 3.2 Display
- 3.3 Warning

4/Type Code

- 3.1 Network Setup

content

1/ General Information

1.1 Description

ECH-c1 series repeater is compatible to ECH-b1 series Tempatch Wireless Intelligent Thermometer. The repeater collects temperature data of Tempatch and transfers to cloud server via Ethernet or WLAN to achieve real-time remotely body temperature monitoring. Moreover, the repeater can display room temperature and relative humidity, human body temperature measured by Tempatch and send remind when the temperature is higher than the setting remind temperature.

ECH-c1 series repeater adopts Bluetooth® 4.0 technology and is compatible to ECH-b1 Tempatch. It can continuously collect and display real-time temperature data of Tempatch and proceed quick and effective body temperature measurement without disturbing the patients. When the body temperature collected is exceed setting remind temperature, users will receive remind.

1.2 Specification

1.2.1 - Main feature |

- Bluetooth® 4.0
- 10Mbps Ethernet
- DHCP service
- 802.11 b/g/n
- Local display, remind
- Room temperature and relative humidity display
- Cloud server for remote service
- Easy setup by APP

1.2.2 - Specificaion |

- Model: ECH-c1
- Size: 130mm X 93mm X 33mm
- Comply with IEEE 802.3 ethernet, IEEE 802.11/b/g/n
- Support DHCP, TCH/IP, HTTP protocol
- 2 LEDs for status, dual digital display
- Room temperature and relative humidity display. Temperature accuracy: 0.5 °C, RH accuracy: 5%
- Bluetooth® transfer distance: 10 meters
- Micro USB power supply
- Working condition: 0~40°C, 10~95%RH(No condensing)

2/ Hardware description

2.1 Front Panel

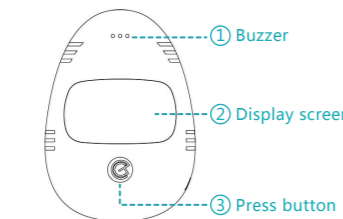

Buzzer

- Beep sound will be received when the setting remind temperature is reached.

LED Status and Digital Display

- Red LED (Power Indicator)
ON – Power supply OK
OFF – Power supply Fail
- Green LED (Network status Indication)
ON – Network Connection OK
OFF – No Network Connection
- Dual Digital Display (Digital Display)
No Tempatch connection: Display room temperature and relative humidity
With Tempatch connection: Display last two code of connected Tempatch on left digital tube, display body temperature of according Tempatch on right digital tube.

PressButton

- press the button to turn off the remind; if the temperature is continuously higher than the remind setting, beep sound will be received again after 30 minutes.

2.2 RJ45 Ethernet port

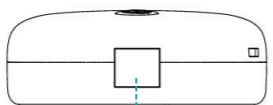

The port can connect hub, switch and router

2.3 Mini USB Power supply port

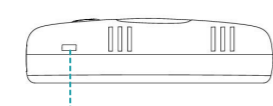

DC 5V power supply

2.4 Stand

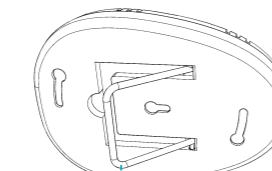

Make the repeater stand on the table

2.5 Mounting holes

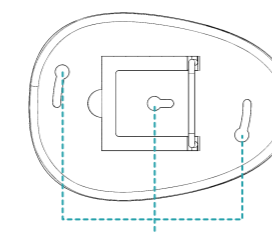

The hole in center is for wall-mounting, the other two are for ceiling-mounting

3/ How to use

Transmission Mode /

3.1 Network setup

(The repeater can connect to maximum 3 pieces of Tempatch™ in transmission mode.)

3.1.1 - Ethernet Network Setup

Step 1: Plug the cable into the Ethernet port.

Step 2: Connect 5V power supply to the repeater through USB cable, the red LED is on. Wait for the green LED turning on.

Step 3: (operated only at the first time of use) Open Tempatch APP, scan QR code on repeater and connect to the repeater. Enter the setup page of APP and bind the repeater.

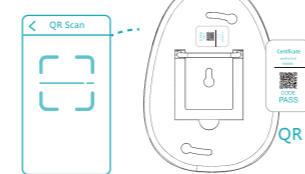

Step 4: Make sure Tempatch has been turned on and bound to the same account with the repeater.

Step 5: The repeater starts to collect temperature data and the display starts to update.

3.1.2 - WLAN Setup

Step 1: Connect 5V power supply to the repeater through USB cable.

Step 2: (operated only at the first time of use) Open Tempatch APP, scan QR code on the repeater and connect to the repeater. Enter the setup page of APP and bind the repeater.

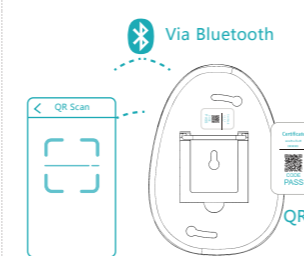

Step 3: (operated only at the first time of use or in the situation of WLAN setup changing) Enter the setup page of APP and bind the repeater, set WLAN connection profile, wait for the green LED turning on.

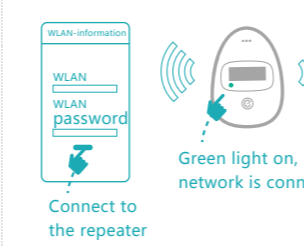

Step 4: Make sure Tempatch has been turned on and bound to the same account with the repeater.

3.2 Display

(only valid for the product type with display function)

3.2.1 - When no Tempatch is

connected to the repeater, the left digital tube displays room relative humidity, the right digital tube displays room temperature.

3.2.2 - When one Tempatch is connected to the repeater, the left digital tube displays the last two code of the connected Tempatch, the right digital tube displays the measured temperature of the connected Tempatch. If more than one Tempatch are connected to the repeater, the last two codes of them and the measured temperature will be displayed alternatively on the digital tubes.

3.3 Remind

3.3.1 - After the Tempatch has been connected to the repeater, if measured temperature is higher than 38°C, repeater will send beep sound, the code and temperature data of that Tempatch will be displayed continuously.

3.3.2 Press the “e” button to stop the remind and return to the normal display. If measured temperature of the Tempatch is still higher than 38°C after 30 minutes, the repeater will beep again.

3.2 Display

(only valid for the product type with display function)

3.1 Network Setup

Step 1: Plug the cable into the Ethernet port.

Step 2: Connect 5V power supply to the repeater through USB cable, the red LED is on, wait for the green LED turning on.

Step 3: Make sure Tempatch has been turned on.

Step 4: The repeater starts to collect temperature data.

3.1.2 - WLAN Setup

Step 1: Connect 5V power supply to the repeater through USB cable.

Step 2: (operated only at the first time of use) Open Tempatch APP, scan QR code on the repeater and connect to it. Enter the setup page of APP and bind the repeater.

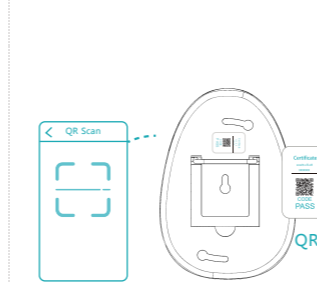

Broadcast Mode /

3.1 Network Setup

Step 1: Plug the cable into the Ethernet port.

Step 2: Connect 5V power supply to the repeater through USB cable, the red LED is on, wait for the green LED turning on.

Step 3: Make sure Tempatch has been turned on.

Step 4: The repeater starts to collect temperature data.

3.1.2 - WLAN Setup

Step 1: Connect 5V power supply to the repeater through USB cable.

Step 2: (operated only at the first time of use) Open Tempatch APP, scan QR code on the repeater and connect to it. Enter the setup page of APP and bind the repeater.

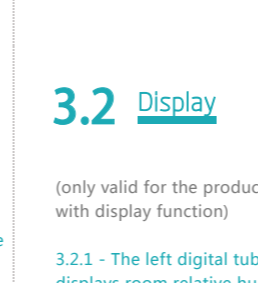

3.2 Display

(only valid for the product type with display function)

3.1 Network Setup

Step 1: Plug the cable into the Ethernet port.

Step 2: Connect 5V power supply to the repeater through USB cable, the red LED is on, wait for the green LED turning on.

Step 3: Make sure Tempatch has been turned on.

Step 4: The repeater starts to collect temperature data.

3.1.2 - WLAN Setup

Step 1: Connect 5V power supply to the repeater through USB cable.

Step 2: (operated only at the first time of use) Open Tempatch APP, scan QR code on the repeater and connect to it. Enter the setup page of APP and bind the repeater.

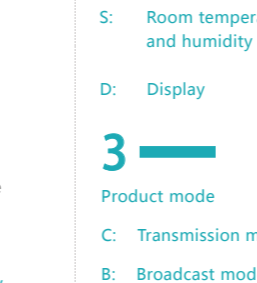

4/ Type Code

Type Code

ECH c1 series naming rules:



1. Product series name

2. Product functional characteristics

W: WLAN

L: Ethernet

S: Room temperature and humidity

D: Display

3. Product mode

C: Transmission mode

B: Broadcast mode



制造商 / 易适康连 (常州) 医疗器械有限公司
地址 / 中国江苏省常州市钟楼区邹区镇会灵西路65号
技术支持 E-mail / support@ech-med.com
技术支持电话 Telephone / +86 21 62096070
官网 Website / www.ech-med.com / www.ech-med.com.cn
ECH (Changzhou) Medical Instrument Co., Ltd.
No.65 West Huiling Road, Zouqu Town, Changzhou, Jiangsu Province, China



FCC Statement

Changes or modifications not expressly approved by the party responsible for compliance could void the user's authority to operate the equipment.

This device complies with Part 15 of the FCC Rules. Operation is subject to the following two conditions:

(1) this device may not cause harmful interference, and

(2) this device must accept any interference received, including interference that may cause undesired operation.

Note: This equipment has been tested and found to comply with the limits for a Class B digital device, pursuant to Part 15 of the FCC Rules. These limits are designed to provide reasonable protection against harmful interference in a residential installation. This equipment generates, uses, and can radiate radio frequency energy, and if not installed and used in accordance with the instructions, may cause harmful interference to radio communications. However, there is no guarantee that interference will not occur in a particular installation. If this equipment does cause harmful interference to radio or television reception, which can be determined by turning the equipment off and on, the user is encouraged to try to correct the interference by one or more of the following measures:

- Reorient or relocate the receiving antenna.
- Increase the separation between the equipment and receiver.
- Connect the equipment into an outlet on a circuit different from that to which the receiver is connected.
- Consult the dealer or an experienced radio/TV technician for help.

This equipment complies with FCC radiation exposure limits set forth for an uncontrolled environment. This equipment should be installed and operated with a minimum distance of 20cm between the radiator & your body. This transmitter must not be co-located or operating in conjunction with any other antenna or transmitter.

ECH Repeater User Manual