

102mm

65mm

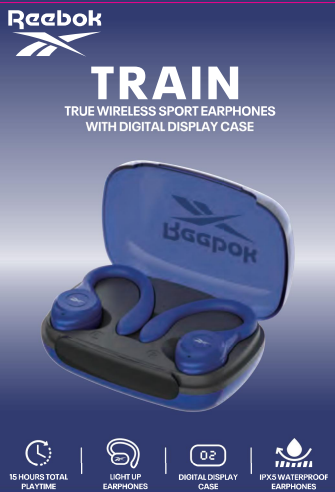

## SAFETY PRECAUTIONS

When using your earphones, basic safety precautions should always be followed, including:

1. READ ALL INSTRUCTIONS BEFORE USING YOUR EARPHONES.
2. Never expose your earphones to high temperatures, extreme cold, or high humidity. Do not submerge in water.
3. To avoid the risk of electric shock, never attempt to open or repair your earphones without the assistance of certified professionals.
4. Your earphones are not to be used by children or the infirm without suitable adult supervision.
5. Always press all buttons carefully. Do not marhandle your earphones.
6. Do not use your earphones at temperatures under 32°F (0°C) or over 104°F (40°C).
7. Do not drop your earphones, throw them, or subject them to strong impacts or physical trauma.
8. Contact the manufacturer for support if you detect any abnormalities when using your earphones. In addition, do not continue to use your earphones if you detect any smoke or fire.
9. Unplug your earphones when not in use for extended periods of time.
10. When plugged in, do not place your earphones on flammable materials such as rugs, carpets, or bedding.
11. Please recycle or dispose of your earphones properly according to your municipality's laws and rules. Contact local recycling facilities and/or the manufacturer for further information.
12. Clean your earphones and charging case using a soft cloth or paper towel. Do not use harsh chemicals when cleaning your earphones, and never submerge your earphones in water.

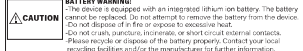

## INTRODUCTION

Thank you for purchasing the Reebok Train True Wireless Sport Earphones, item RBK1100. Sweatproof, built to work as hard as you do. To get the most out of your device, please read this user's manual thoroughly before use.

## PACKAGE CONTENTS

- True Wireless Sport Earphones with Earcaps
- Charging Case with Digital Display
- USB-C Charging Cable
- User's Manual with Warranty Information

## FEATURES

- 18 Hour Total Playtime
- 4.5 Hours Playtime per Charge\*
- Three Extra Charges in Case
- Light up Earphones
- Digital Display Case
- Around-the-Ear Sport Fit

\*Applicable at 50% of maximum volume. Results will lower with increased volume.

## SPECIFICATIONS

- Bluetooth Range: Up to 33 Feet (10 Meters)
- Bluetooth Version: V5.4
- Charging Case Battery Capacity: 3.7V/300mAh
- Earphones Battery Capacity: 213.7V/30mAh
- Earphones Charging Time: Approximately 1.5 hours
- Play Time: Approximately 4.5 hours
- Bluetooth Profiles Supported: HFP/A2DP/AVRCP
- Operating Frequency: 2.40 GHz-2.48 GHz
- RF Sensitivity: -92dBm
- Working Temperature Range: 0° - 40° C

## A CLOSER LOOK

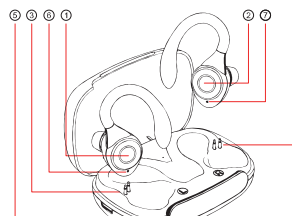

- ① ② Touch Sensor/Earphone Indicator Light
- ③ ④ Charging Pin
- ⑤ Battery Level
- ⑥ ⑦ Microphone

## CHARGING

### Charging the Case

Insert one end of the included USB-C charging cable into the charging port on your case.

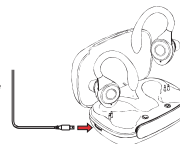

Insert the other end of the USB cable into a suitable USB charging adapter.

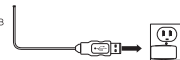

### Charging the Earphones

Place the earphones in the charging case to charge. Make sure the charging points make contact between the case and earphones.

Charging can take approximately 1.5 hours.

### Charging Status

The digits on the charging case's display screen will flash while the case charges and will display a solid '100' once the case is fully charged.

The earphone battery icons will flash while the earphones are charging inside the charging case. The right earphone battery icon will flash while the right earphone charges, and the left earphone battery icon will flash while the left earphone charges.

## POWERING ON/OFF

When first using your earphones, place them into the case. To turn the earphones ON, remove them from the case. To turn the earphones OFF, put them back into the case.

**Note:** It is recommended that the earphones be fully charged before use. If the earphones are out of the charging case, put them into the case and take out again to turn on.

↑ Turn ON



Plays a tone when powered.

↓ Turn OFF



Plays another tone when turned off.

OR



Press and hold the touch sensor on the earphones for five seconds to power OFF.

## BLUETOOTH PAIRING

When you remove your earphones from the case they will power ON and attempt to Sync together. While syncing, the indicator lights on the earphones will quickly flash white.

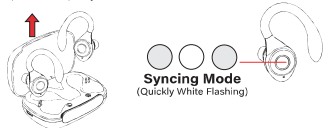

**Syncing Mode**  
(Quickly White Flashing)

After successfully syncing together, the indicator lights on the earphones will slowly flash white. The earphones will then enter pairing mode.



**Pairing Mode**  
(Slowly White Flashing)

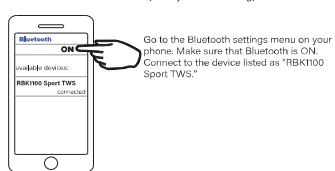

Go to the Bluetooth settings menu on your phone. Make sure that Bluetooth is ON. Connect to the device listed as "RBK1100 Sport TWS."

After connecting the earphones, their indicator lights will turn OFF.

## USING YOUR EARPHONES

**LEFT EARPHONE**  
Play/Pause: Double Press  
Previous Track: Press and Hold for 1 second  
Answer Call: Press  
Reject Call: Press and Hold for 2 seconds  
End Call: Press and Hold for 2 seconds  
Volume Down: Press  
Activating Phone Assistant: Triple Press

**Note:** While in a call use your connected device to control the call volume.

**RIGHT EARPHONE**  
Play/Pause: Double Press  
Next Track: Press and Hold for 1 second  
Answer Call: Press  
Reject Call: Press and Hold for 2 seconds  
End Call: Press and Hold for 2 seconds  
Volume Up: Press  
Activating Phone Assistant: Triple Press



To prevent possible hearing damage, do not listen at high volume levels for long periods. For your own safety, please be aware of your surroundings when using these earphones.

## MAINTENANCE AND CARE

1. Use a soft cloth or paper towel to clean your earphones and charging case. Never use any harsh chemicals or detergents for cleaning. Make sure your earphones are dry before charging.
2. When your earphones are unused, they should be stored in a cool, dry place.
3. Never tug or yank on a cable connected to your earphones or charging case. Connect and disconnect cables as carefully as possible.
4. Never expose your earphones to high temperatures or extreme cold.

## TROUBLESHOOTING

Problem	Cause	Solutions
Can't power on.	Earphones are low on battery or crashing.	Charge the earphones/press and hold the touch button for 5 seconds to restart.
No charging indication.	The earphones are not connected, or foreign objects are preventing the connection.	Adjust the earphone's position or wipe the charging points.
Automatically shuts down.	Earphones are low battery.	Charge the earphones.
The earphones have an echo.	The volume is too high, or the environment is too noisy.	Adjust the volume or change location.
The earphones are noisy.	Outside environment interference or too far away from your mobile phone.	Change position or move closer to the mobile phone.
The earphones are quiet.	Wearing earphones incorrectly or the volume is too low.	Adjust the earphones position or the mobile phone volume.
Signal connection is weak.	Outside environment interference or too far away from mobile phone.	Change to better environment or move closer to the mobile phone.
Earphones have no sound.	Pairing unsuccessful between L and R Earphones.	Put the earphones into the charging case and take out again to let them repair.

## FCC STATEMENT

Changes or modifications not expressly approved by the party responsible for compliance could void the user's authority to operate the equipment.

This device complies with Part 15 of the FCC Rules. Operation is subject to the following two conditions: (1) this device may not cause harmful interference, and (2) this device must accept any interference received, including interference that may cause undesired operation.

This equipment has been tested and found to comply with the limits for a Class B digital device, pursuant to Part 15 of the FCC Rules. These limits are designed to provide reasonable protection against harmful interference in a residential installation. This equipment generates, uses and can radiate radio frequency energy and, if not installed and used in accordance with the instructions, may cause harmful interference to radio communications. However, there is no guarantee that interference will not occur in a particular installation.

If this equipment does cause harmful interference to radio or television reception, which can be determined by turning the equipment off and on, the user is encouraged to try to correct the interference by one or more of the following measures:

- Reorient or relocate the receiving antenna.
- Increase the separation between the equipment and receiver.
- Connect the equipment into an outlet on a circuit different from that to which the receiver is connected.
- Consult the dealer or an experienced radio/TV technician for help.

Note: The Grantor is not responsible for any changes or modifications not expressly approved by the party responsible for compliance. Such modifications could void the user's authority to operate the equipment.

The device has been evaluated to meet general RF exposure requirement. This equipment complies with FCC's RF radiation exposure limits set forth for an uncontrolled environment. This device and its antenna(s) must not be co-located or conjunction with any other antenna or transmitter.

## CSI ONE YEAR WARRANTY

This warranty covers the original consumer purchaser only and is not transferable.

This warranty covers products that fail to function properly UNDER NORMAL USAGE due to defects in material or workmanship. Your product will be repaired or replaced at no charge for parts or labor for a period of one year.

### What Is Not Covered By Warranty

Damages or malfunctions not resulting from defects in material or workmanship and damages or malfunctions from other than normal use, including but limited to, repair by unauthorized parties, tampering, modification or accident.

**To Obtain Warranty Service and Troubleshooting Information:**  
Call 1-800-592-9541 for 24/7 support.

To receive Warranty service along with the name and address of an authorized product service center, the original consumer purchaser must contact us for problem determination and service procedures. Proof of purchase in the form of a bill of sale or receipted invoice, evidencing that the product is within the applicable Warranty period(s), MUST be presented in order to obtain the requested service. It is your responsibility to properly package and send any defective products along with a dated copy of proof of purchase, a written explanation of the problem, and a valid return address of the authorized service center at your expense. Do not include any other items or accessories with the defective product. Any products received by the authorized service center that are not covered by warranty will be returned unrepaid.



3024-101  
Edition 01/2027

© Reebok International Limited. All rights reserved. Reebok® and ZC® are trademarks of Reebok International Limited.

The Bluetooth® word mark and logo are registered trademarks owned by their proprietor and used under license by Reebok International Limited. All other marks contained herein are trademarks of Reebok International Limited.