

SEEKCY

SEEKCY

SEEKCY

【S2 series iBeacon】

Suzhou Seekcy Electronic Technology Co., Ltd.

NOTE: This equipment has been tested and found to comply with the limits for a Class B digital device, pursuant to part 15 of the FCC Rules. These limits are designed to provide reasonable protection against harmful interference in a residential installation. This equipment generates uses and can radiate radio frequency energy and, if not installed and used in accordance with the instructions, may cause harmful interference to radio communications. However, there is no guarantee that interference will not occur in a particular installation. If this equipment does cause harmful interference to radio or television reception, which can be determined by turning the equipment off and on, the user is encouraged to try to correct the interference by one or more of the following measures:

- Reorient or relocate the receiving antenna.
 - Increase the separation between the equipment and receiver.
 - Connect the equipment into an outlet on a circuit different from that to which the receiver is connected.
 - Consult the dealer or an experienced radio/TV technician for help
- Changes or modifications not expressly approved by the party responsible for compliance could void the user's authority to operate the equipment. This device complies with Part 15 of the FCC Rules. Operation is subject to the following two conditions:
- (1) this device may not cause harmful interference, and
 - (2) this device must accept any interference received, including interference that may cause undesired operation.

1. Equipment overview

S2U is a iBeacon product based on BLE 4.0. iBeacon is a Bluetooth radio technology, in accordance with the set frequency and power periodicity to send the Bluetooth radio content meets iBeacon protocol. After phone or other smart devices received near the iBeacon broadcast, to achieve the information push, accurate positioning and other functions.

S2U using the DIALOG company's main chip DA14580, fully supports BLE 4.0. Use CR2477 battery powered, battery can be replaced at any time.

S2U can be used at any time with the configuration APP, configuration ID, transmit power, emission interval and other important parameters. S2U has a perfect anti-tamper mechanisms to protect against unauthorized changes. Part of the APP interface diagram as shown in the figure below.

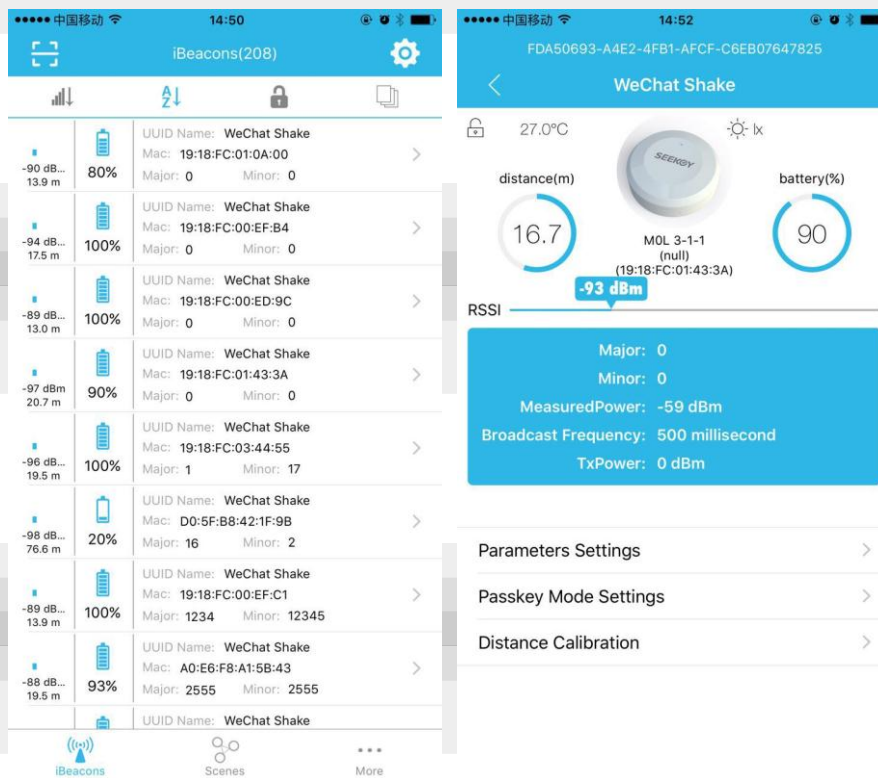

Figure 1: Schematic diagram of configuration tool APP

Users can obtain the following ways to configure APP:

1.Scan the below two-dimensional code download configuration tool;

2.Apple users can search for "seekcy" in the app store.



iOS

Android

2.Use of configuration tool APP

Scan Seekcy Beacon



Open Mobile' s Bluetooth

Make sure that the Bluetooth phone is turned on, to be able to scan and configure iBeacon.



Open Seekcy Beacon

Display the scanned of iBeacon information, including signal strength, remaining battery, ID information, UUID, Major, Minor and MAC address.

Configure one iBeacon

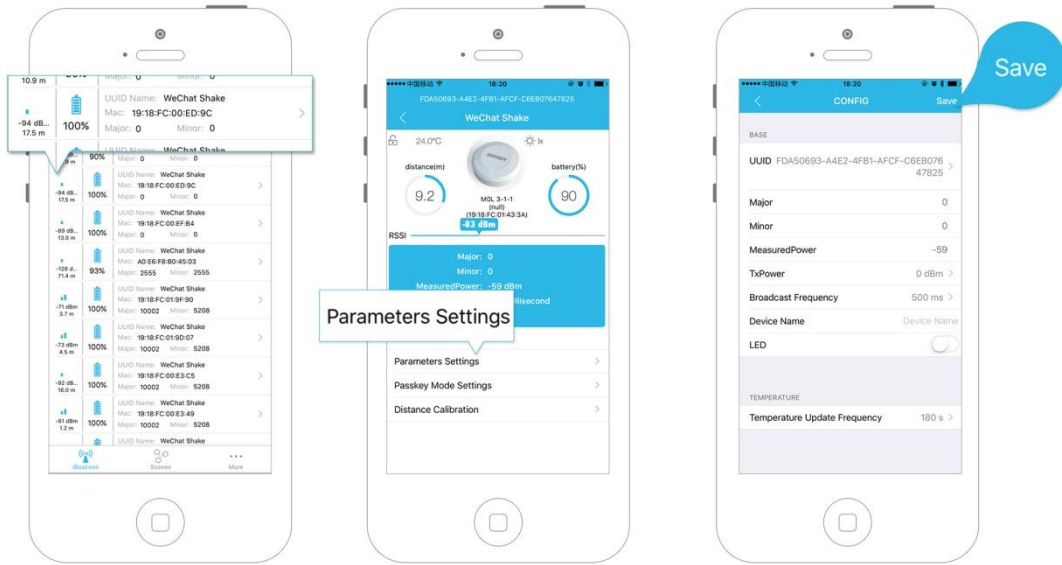

Select the device to be configured > Click Parameters settings > Save after writing the parameters

Batch Configuration Parameters

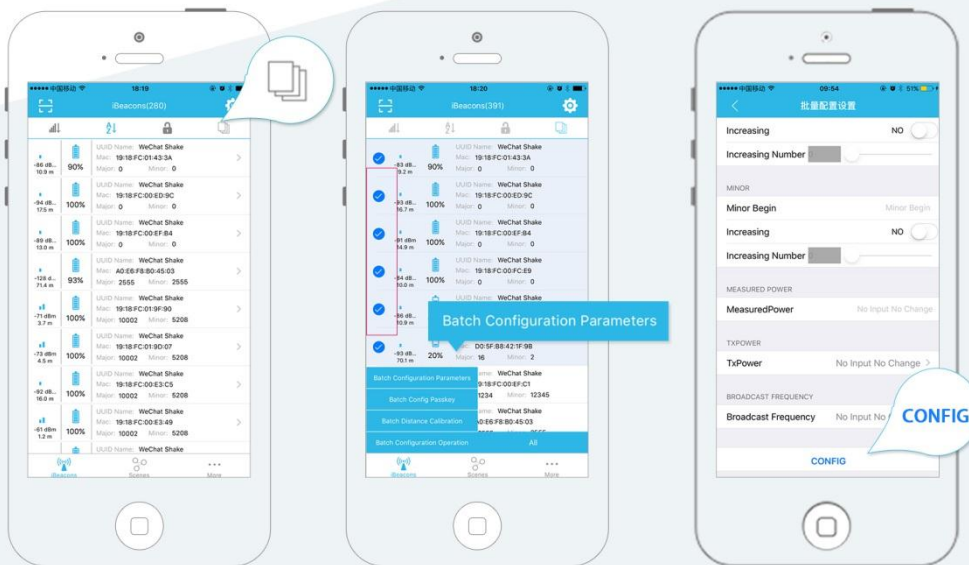

Click "Batch configuration parameters" icon > Select the device to be configured(or select ALL), then click "Batch configuration parameters" > Click "CONFIG" after setting parameters

 Set anti-tampering mode



Click Gear icon to configure iBeacon

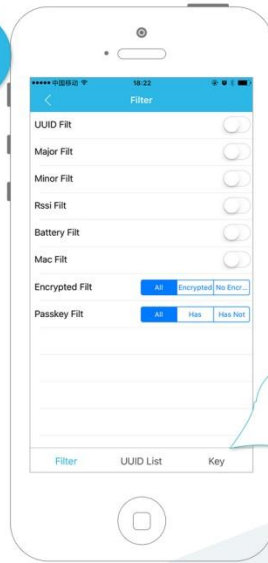

Click "key"



Enter the passkey and save

Step: Set APP Key

If you need to set the iBeacon in anti-tampering mode, you must set the APP Key for Configuration APP

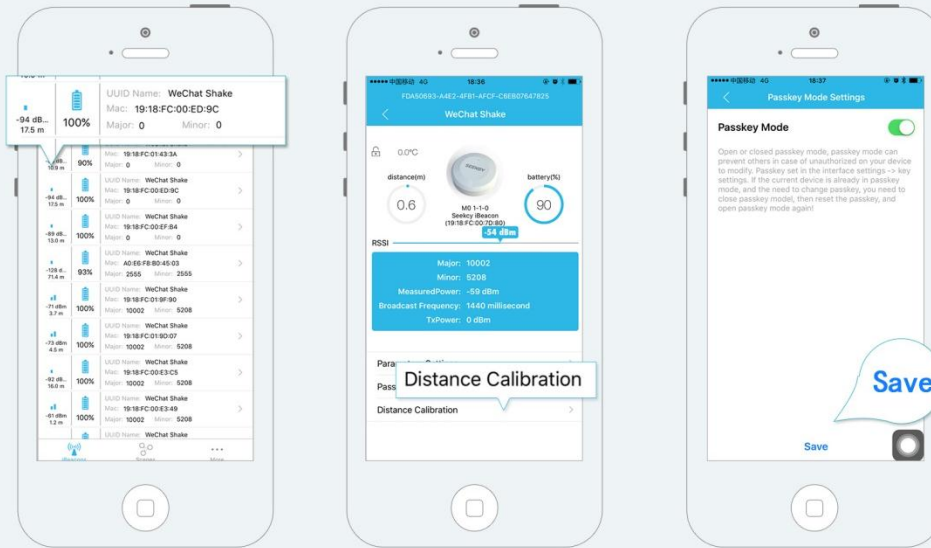

Click the device to be configured

Click "key"

Enter the passkey and save

Step 2: Set iBeacon to anti-tampering mode

If configuration APP has been set APP Key, it can set the non-tampering mode iBeacon to anti-tampering mode, then the iBeacon can only be modified by the APP which has been set the correct APP Key or restored to on-tampering mode.

Note: Using Batch Configuration Parameters can set multiple beacons to anti-tampering mode.

1. The basic parameters of the device

	S2U (Ultra-low-power version)
Chip	Dialog DA14580
Support Agreement	Bluetooth BLE 4.0, Apple's standard iBeacon protocol.
Battery	2500mAh two alkaline batteries

Program	
Transmit Power	0dBm ~ -20dBm
Coverage	The maximum can reach 80 meters.
Battery Life	6 years
Waterproof Level	IP63
Dimensions	Diameter 75mm, thickness 25mm.
Weight	72g
Applicable System	iOS7.0 and above, Android 4.3 and above.
Safety	Password protection, tamper resistant, anti rub use (optional).
Configure Phone APP	Support to modify the UUID, Major, Minor, broadcast interval, broadcasting power, set the tamper resistant keys, etc.
Other Properties	Provide secondary development SDK
Feature	Stylish compact design , signal stability, high endurance, save maintenance costs and high cost! Supporting powerful and easy to use configuration tool APP.

2. Packaging Information

Packaging Information	Industry inner box	Carton Industry
-----------------------	--------------------	-----------------

SEEK@Y Only to provide you with the best iBeacon products - Seekcy iBeacon

Quantity	30	150
Size	39*23*7cm	53*29*43cm
Net Weight	2.16kg	10.8kg

