

User Manual

Smart life Together with you

H30

Smart bracelet

Application Download

Before connecting, make sure your bracelet is powered on and your smartphone's Bluetooth is on.

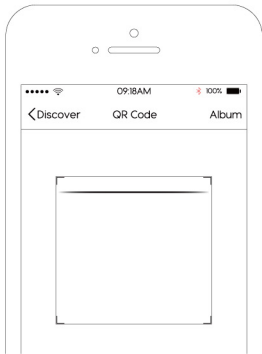

Application name is "DayDay band". Search "DayDay band" on the App Store or Google Play,or scan the QR code below:



Android



iOS

Wearing Position

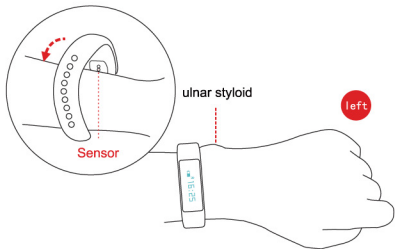

The best wearing position of bracelet is next to ulnar styloid, please put the sensor close to the skin,avoid moving.

ON/OFF

Touch the screen for more than three seconds,then the bracelet will be On withvibration and the screen will lit up. In the boot state,touch the screen for more than three seconds switch to the shutdown,select "off",long press will shutdown, select "on",long press will be back to the main interface.

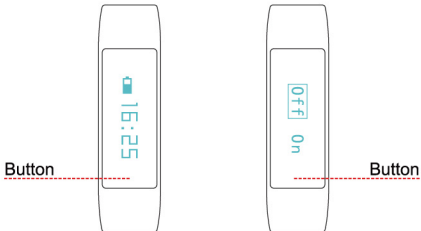

Usage of Device

Remark: First connection with the device,please make sure device connect to APP/APK and time and date automatically update. Open APP→Device→Slide→Binding When band and phone connect successfully,Immediately start to record and analyze your exercise and sleep data,show the data to APP;When disconnected,device can show time and sport data on the screen automatically,and can save data up to seven days.

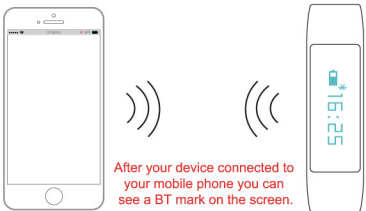

After your device connected to your mobile phone you can see a BT mark on the screen.

Heart Rate Test

When the display is switched to heart rate interface,long press touchscreen position,then the heart rate icon flashes,while heart LED is lit,It mean the start oftheheart rate test and about 30 seconds to obtain heartrate results, You can also connect the APP,and click the "Start" to test heart rate.

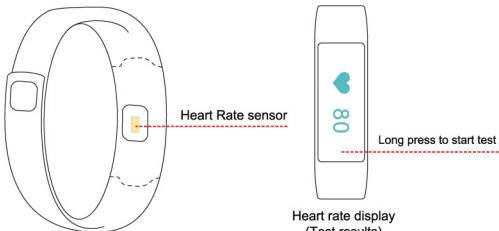

Tips:When test,please put the heart rate sensor to be close to the skin and to avoid the influence accuracy of external light.Heart rate test area should be kept clean,sweat or dirt can affect test results.

Main function

Standard Sports Function(steps,distance, calories)	Anti-lost reminder(phone out of range alerts)
Sleep detect(sleep time,sleep quality)	Smart alarm clock
Heart Rate Monitor	Sedentary remind(iOS fixed one hour)
Call notification	Shake photograph
Push message(You can add more)	Sport goal setting,Sports information sharing
Reset to the factory settings	Firmware Upgrade
when phone receive incoming call or message,device will vibrate.	

Tips for Android user:

- 1.Open intelligent unlock function:Automatic lock screen when the phone away from the band and automatic unlock when the phone close to the bracelets,but currently only supports some phone models.
- 2.When using the function of away from alarm,you need to allow the app display floating window;
- 3.When using the function of message reminder,you need to set the app allow to be run in background;
- 4.Suggest that app is added in the phone management for the "trust".

Charging

Please clip the device with the charging cable as shown in the figure 1, the charging part must aim to the pin as shown in the figure 2, and connect USB part to the related plug.

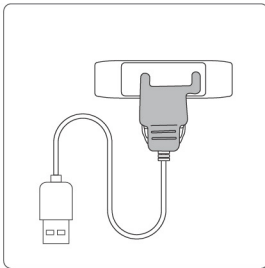

FIG. 1

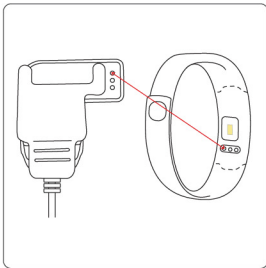

FIG. 2

Tips:

1. Please no wear the device when swimming or shower.
- 2.For reference only, it can not replace medical equipment.
- 3.Please test in the normal temperature, the most of skin test normal.
4. Connect the device when synchronized data.
- 5.Please charge the smart bracelet by original charger.
- 6.Don't exposure device in the over moisture,extremely hot or cold conditions in a long time.
- 7.If device doesn't work, please note clear the mobile memory or quit the App, andtry again.
8. Pedometer will work after connect the APP with device manually in the first time, no need operate later.
9. The device will vibrate when you connect the charger,with power higher than two grid;If lower than two grid,the bracelet will have no alert when connected charger.
- 10.When device is charging,Touchscreen will be in calibration automatically. Touchscreen will failure temperately,after 10 seconds it will be in normal operation.

Package Contents

Smart BraceletxCharger xEnglish Manual

Basic parameter:

Display: OLED display
Battery Type: Li-polymer battery
Standby Time: 15 days
Synchronization method: Bluetooth 4.0
Operating Temperature: -20℃-50℃

Facility Request:

Android OS: Smartphone which support Bluetooth 4.0 and installed with Android 4.3 or above, Wechat 6.0 or above.
Apple OS: All iPhone and iPad versions installed with iOS 8.0 or above, Wechat 6.0 or above.Equipment Requirements:

This device complies with part 15 of the FCC Rules. Operation is subject to the condition that this device does not cause harmful interference (1) this device may not cause harmful interference, and (2) this device must accept any interference received, including interference that may cause undesired operation. Changes or modifications not expressly approved by the party responsible for compliance could void the user's authority to operate the equipment.

NOTE: This equipment has been tested and found to comply with the limits for a Class B digital device, pursuant to Part 15 of the FCC Rules. These limits are designed to provide reasonable protection against harmful interference in a residential installation. This equipment generates, uses and can radiate radio frequency energy and, if not installed and used in accordance with the instructions, may cause harmful interference to radio communications. However, there is no guarantee that interference will not occur in a particular installation.

If this equipment does cause harmful interference to radio or television reception,

which can be determined by turning the equipment off and on, the user is encouraged to try to correct the interference by one or more of the following measures:

- Reorient or relocate the receiving antenna.
- Increase the separation between the equipment and receiver.
- Connect the equipment into an outlet on a circuit different from that to which the receiver is connected.
- Consult the dealer or an experienced radio/TV technician for help.

The device has been evaluated to meet general RF exposure requirement. The device can be used in portable exposure condition without restriction.

FCC ID:2AIOOH30