

1 Can I share with family and friends?

Yes, you can share your cameras with family and friends who will have access to view the camera and control your bulbs, plugs, and other devices. In the app, press the Profile button and click on the "Home Management" button, and you will be able to give or revoke sharing permissions. In order to share, the other user should already have downloaded the app and registered a new account.

The range of your home Wi-Fi is heavily dependent on your home router and the conditions of the room. Check with your router specifications for exact range data.

TuyaSmart app can control an unlimited amount of devices in an unlimited amount of locations. Your router may have a limit of how many devices can be connected to one router.

Thank you for purchasing Smart Camera. Get started using your new devices by downloading TuyaSmart, one convenient app that manages everything straight from your phone. Easily connect to your home Wi-Fi and control multiple devices from the touch of your fingertips

- Smart Camera x1
- USB Cable x1
- Adapter x1
- Screw Pack x1
- Mounting Plate x1
- User Manual x1

- Know your Wi-Fi network and password
- Make sure your mobile device is running iOS® 9 or higher or Android™ 4.1x or higher
- Make sure WiFi network is available, compatible with 2.4GHz/5GHz

← United States

Register

United States of America +1 >

Mobile number/e-mail address

STEP 1.
Enter your mobile phone
number or email address.

Enter verification code

STEP 2.
Enter the verification code
and create a password.

- Audio: Internal Speaker and Microphone
- Storage: supports up to 128G Micro SD card (not included)
- WiFi: IEEE 802.11 ac/b/g/n/a, support 2.4GHz/5GHz

This equipment complies with FCC radiation exposure limits set forth for an uncontrolled environment. This equipment should be installed and operated with minimum distance 20cm between the radiator & your body.

This equipment has been tested and found to comply with the limits for a Class B digital device, pursuant to Part 15 of the FCC Rules. These limits are designed to provide reasonable protection against harmful interference in a residential installation. This equipment generates, uses, and can radiate radio frequency energy and, if not installed and used in accordance with the instructions, may cause harmful interference to radio communications. However, there is no guarantee that interference will not occur in a particular installation. If interference is found, it may be corrected by one or more of the following measures, which can be determined by turning the equipment off and on, the user is encouraged to try to correct the interference by one or more of the following measures:

This device complies with Part 15 of the FCC Rules. Operation is subject to the following two conditions:

- (1) This device may not cause harmful interference.
- (2) This device must accept any interference received, including interference that may cause undesired operation.

- Open TuyaSmart APP, click "+" on the top right corner of the page "HOME", then select "Smart Camera".
- Make sure the indicator light on the device is flashing red quickly, then press "Next Step".

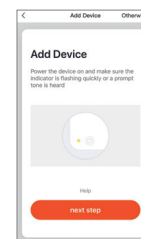

- Read the instruction about "Scan with the camera", click "Continue".

- Scan the QR Code on your phone with camera. Heard a prompt tone, click "Heard the beep".



- When the indicator light on the device turns from flashing red light to steady green light, the network configuration is complete.

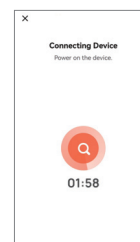

The other way to add device quickly based on the following steps:

- 1). Turn on your smartphone's bluetooth firstly;
- 2). Press "Add Device" icon in the TuyaSmart app, you'll see "Discovering Devices..." and "Add" prompts etc;
- 3). Press "Add" icon then enter your Wifi and password, click "Next" icon;
- 4). When the device is connected with your smartphone, click "Done";

*Please refer to the specific APP interface if there are any difference