

VERBERA

Convolution Reverb



User Manual

For Firmware V1.0.6

HOTONE
DESIGN INSPIRATION

※In the interest of product improvement, the specifications and/or the content of products (including but not limited to appearances, packaging design, manual content, accessories, size, parameters and display screen), are subject to change without prior notice. Please check with local supplier for exact offers. Specifications and features (including but not limited to appearances, colors and size) may vary by model owing to environmental factors, and all images are illustrative.

Contents

- Welcome 1**
- Safety Instructions 2**
 - Precautions 2
 - Definition of intended use 2
- Panel Introduction 11**
 - Front Panel Control 11
 - Connection Guide 13
- Suggested Setups 15**
 - Using with Other Pedals 15
 - Connecting to the FX Loop of Other Devices 16
- Controls in Depth 17**
 - Signal FLOW Overview 17
 - ALT/MENU..... 17
 - Parameter Toggle..... 17
 - MENU..... 18
 - About IR 19
 - Smart IR Sorting..... 19
 - About Preset 20
 - Preset Main Interface 20
 - Save and Rename 21
 - Footswitch Mode 22
- Clone Function 23**
- Expression and MIDI 26**
 - EXP Setting..... 26
 - MIDI Setting..... 28
 - MIDI CC Table..... 28
- Power Supply 29**
- Software Support 29**
- Factory IR List 30**
- Technical Specification 35**

Welcome

Thank you for purchasing a Hotone product.

Please read this manual carefully to get the most out of your Effects Processor (NC-200).

Please keep this manual in a safe place for further reference.

Safety Instructions

Precautions

PLEASE READ CAREFULLY BEFORE OPERATING THE DEVICE.

Please keep this manual in a safe place for future reference.

Please always follow the basic precautions listed below.

These precautions include, but are not limited to, the following:



Definition of intended use

Power supply & power cord (with ferrite bead in shipment)

Please check the voltage specification on the device or device power adaptor match your power supply network.

Please be sure to use the device just with an adequate power supply, such as original supplied power adaptor.

When using a 3rd party power adapter, please make sure the power adapter fits the device's power requirement. Use of an adapter other than that specified could damage the unit or cause malfunction and pose a safety hazard, such as incorrect polarity would cause the fire hazard.

Hotone will not be responsible for physical injury to you or others, or damage to the device or other property.

When disconnecting the adapter from an outlet, please always pull the connector itself. Pulling the cord will cause damage to the unit.

Make sure to separate the power adapter and store in a safe place.

Please remove the electric plug from the outlet when the device is not to be used for extended periods of time, or during electrical storms.

Please be sure to connect to an appropriate outlet with a protective grounding connection.

Do not open

This device contains no user-serviceable parts. Do not open the device or attempt to disassemble the internal parts or modify them in any way.

Opening the case may expose you to dangerous voltages, or other hazards.

Opening the casing or performing self-repairs on this device will result in the loss of the warranty eligibility for this device.

If it should appear to be malfunctioning, please discontinue use immediately and contact our service team.

Water warning

Do not expose the device to rain, use it near water or in damp or wet conditions, or place on it any containers (such as vases, bottles or glasses) containing liquids which might spill into any openings. If any liquid such as water seeps into the device, turn off the power immediately and unplug the power cord from the AC outlet.

Please never insert or remove an electric plug with wet hands.

Fire warning

Please do not place any burning items or open flames near the device, since they may cause a fire hazard.

Electromagnetic fields warning

Please avoid operating the device within significant electromagnetic fields. Failing to do so may result in noise, device malfunction, or even loss of data etc.

Hearing loss

Please avoid setting all volume levels to their maximum, specially with using headphones. Depending on the condition of the connected devices,

doing so may result in feedback that can cause hearing loss and damage the speakers or headphones.

Before connecting the device to other devices, please turn off the power for all devices. Also, before turning the power of all devices on or off, please make sure that all volume levels are set to the minimum. Failing to do so may result in hearing loss, electric shock, or device damage.

Location

Please keep away from children, or be accompanied by an adult. The following may cause choking hazard.

- Swallowing of small parts.
- Plastic covers and other packaging material.

While using, please do not cover the device with any cloth, or block any jack of the device.

The device and power supply will become warm with extended use.

Please avoid using the device in any of the following conditions that could cause malfunction:

- Extremely hot or cold places
- Sandy or dusty places
- Contact with corrosive gases or salt air
- Places with extreme vibrations

Before moving the device, please be sure to remove all connected cables, and power adaptor.

Depending on the material and temperature of the surface on which you place the device, its rubber feet may discolor or mar the surface.

Maintenance

Please remove the power plug from the AC outlet while cleaning the device.

Please use a soft cloth to clean the panels if they become dirty. If necessary, slightly moisten the cloth.

Never use cleansers, wax, or solvents such as paint thinner, benzene or alcohol.

Operation

Please do not apply excessive force to the knobs, switches, jacks, and other controls.

Please do not apply excessive force to the screen (if applicable) or casing, which may cause malfunction.

Please do not expose the unit to strong impact or drop it.

Please do not place foreign objects (liquid or solid) into the device.

Malfunction

If any of the following problems occur, immediately turn off the device and disconnect the electric plug from the outlet.

- The device is dropped or damaged.
- The power cord or plug becomes frayed or damaged.
- The power adaptor malfunction.
- Unusual smells or smoke are emitted.
- Some object has been dropped into the device.
- There is a sudden loss of sound during use of the device.
- Cracks or other visible damage appear on the device.
- The device has other obvious signs of malfunction (e.g. can not turn on, knobs can not work, volume is too low, etc.)

Then please contact our service team.

About disposal

While disposing of this product, please take them to applicable collection points, for proper treatment, in accordance with your national legislation.

Disposal of the packaging material

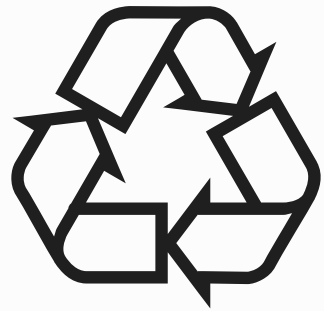

For the transport and protective packaging, environmentally friendly materials have been chosen that can be supplied to normal recycling.

Ensure that plastic bags, packaging, etc. are properly disposed of.

Please do not just dispose of these materials with your normal household waste, but make sure that they are collected for recycling.

Disposal of your old device

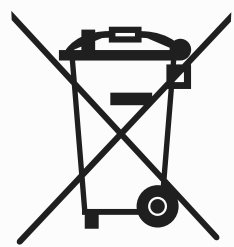

This symbol on the products, packaging, and/or accompanying documents means that used electrical and electronic products should not be mixed with general household waste.

By disposing of these products correctly, you will help to save valuable resources and prevent any potential negative effects on human health and the environment which could otherwise arise from inappropriate waste handling.

For more information about collection and recycling of old products, please contact your local municipality, your waste disposal service or the point of sale where you purchased the items.

This product is subject to the European Waste Electrical and Electronic Equipment Directive (WEEE Directive - Waste Electrical and Electronic Equipment) as amended from time to time version.

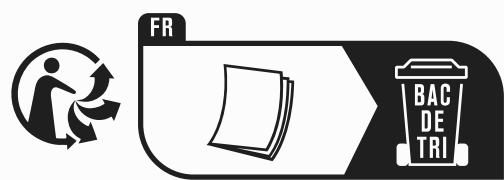

Observe the disposal note for documentation in France.

Disposal of batteries

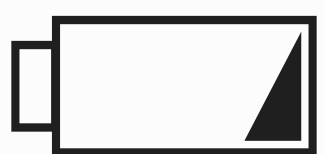

Batteries must not be discarded or incinerated, but disposed of in accordance with local hazardous waste disposal

regulations.

Service Contact

Please prepare information including the model name, serial number, specific symptoms related to the malfunction, your name, address and telephone number, etc.

You can contact the store where you bought the device, or contact Hotone support (service@hotoneaudio.com)

Please use this device according to the manual provided. Any other use, as well as use under other operating conditions, is considered improper use.

Hotone cannot be held responsible for damage caused by improper use or modifications to the device.

FCC Warning

This device complies with part 15 of the FCC Rules. Operation is subject to the following two conditions: (1) This device may not cause harmful interference, and (2) this device must accept any interference received, including interference that may cause undesired operation.

Any Changes or modifications not expressly approved by the party responsible for compliance could void the user's authority to operate the equipment.

This equipment has been tested and found to comply with the limits for a Class B digital device, pursuant to part 15 of the FCC Rules. These limits are designed to provide reasonable protection against harmful interference in a residential installation. This equipment generates uses and can radiate radio frequency energy and, if not installed and used in accordance with the instructions, may cause harmful interference to radio communications. However, there is no guarantee that interference will not occur in a particular installation. If this equipment does cause harmful interference to radio or television reception, which can be determined by turning the equipment off and on, the user is encouraged to try to correct the interference by one or more of the following measures:

- Reorient or relocate the receiving antenna.
- Increase the separation between the equipment and receiver.
- Connect the equipment into an outlet on a circuit different from that to which the receiver is connected.
- Consult the dealer or an experienced radio/TV technician for help.

portable:

FCC RF exposure statement:

The equipment complies with FCC radiation exposure limits set forth for an uncontrolled environment. This equipment should be installed and operated with minimum distance between 20cm the radiator your body.

IC Caution:

Radio Standards Specification RSS-Gen, issue 5

- English:

This device contains licence-exempt transmitter(s)/receiver(s) that comply with Innovation, Science and Economic Development Canada's licence-exempt RSS(s). Operation is subject to the following two conditions:

This device may not cause interference.

This device must accept any interference, including interference that may cause undesired operation of the device.

portable:

RF exposure statement:

The equipment complies with FCC radiation exposure limits set forth for an uncontrolled environment. This equipment should be installed and operated with minimum distance between 20cm the radiator your body.

- French:

Cet appareil contient des émetteurs / récepteurs exemptés de licence conformes aux RSS (RSS) d'Innovation, Sciences et Développement économique Canada. Le fonctionnement est soumis aux deux conditions suivantes:

Cet appareil ne doit pas causer d'interférences.

Cet appareil doit accepter toutes les interférences, y compris celles susceptibles de provoquer un fonctionnement indésirable de l'appareil.

portable:

Déclaration d'exposition RF:

L'équipement est conforme à la limite d'exposition aux radiations de la IC établie pour un environnement non contrôlé. Cet équipement doit être installé et utilisé avec une distance minimale de 20 cm entre le radiateur et votre corps.

CE isclaimers / Notices

EU-

This device in compliance with the essential requirements and other relevant provisions of Directive 2014/53/EU. All essential radio test suites have been carried out. This restriction will be applied to all Member States of European Union.

The device complies with RF specifications when the device used at 20cm form your body.

Declaration of Conformity

Hereby, Annex Products Pty Ltd declares that the product type NC-200 is in compliance with Directives 2014/53/EU & 2011/65/EU. The full text of the EU declaration of conformity is available at the following internet address:

<https://www.hotone.com/products/NeonGLow/Verbera>

UK isclaimers / Notices

UK-

The device is in compliance with the essential requirements and other relevant provisions of the UK Radio Equipment Regulations SI 2017:1206 (as amended).

The device complies with RF specifications when the device used at 20cm form your body.

Declaration of Conformity:

Hereby, Annex Products Pty Ltd declares that the product NC-200 is in compliance with the following Regulations: Radio Equipment Regulations 2017, Electrical Equipment (Safety) Regulations 2016 and The Restriction of the Use of Certain Hazardous Substances in Electrical and Electrical Equipment 2012. The Full test of the UK declaration of conformity is available at the following internet address:

<https://www.hotone.com/products/NeonGLow/Verbera>

Panel Introduction

Front Panel Control



1. DECAY

ALT-IR: Adjust convolution reverb (IR) Decay.

ALT-XR: Adjust Extra Reverb (XR) Decay.

2. ATK /PRE-DL

ALT-IR: Adjust convolution reverb (IR) Attack.

ALT-GLOBAL: Adjust the overall wet signal Pre-Delay.

3. TONE /MOD

ALT-GLOBAL: Adjust the brightness of the wet signal.

ALT-GLOBAL: Adjust the MOD depth of the wet signal.

4. PRESET

Rotate: Switch between stored presets.

Push: Save/Rename the current preset to the specified preset location.

Hold: Save the preset directly to the current location.

5. MIX

ALT-IR: Adjust the dry/wet mix of the convolution reverb.

ALT-XR: Adjust the dry/wet mix of the extra reverb (XR).

6. IR

Rotate: Switch between stored IRs.

Push: Sort all IRs sequentially according to different rules.

7. ALT/MENU

Push: Switch between two different functions of the knob. Each knob may have the following functions:

ALT-IR: Adjust the IR parameters.

ALT-XR: Adjust the extra reverb parameters.

ALT-GLOBAL: Adjust the overall wet signal parameters.

Hold: Enter the MENU interface.

8. CLONE

Hold: Enter the IR cloning process.

9. ALT+CLONE

Enter the EXP settings interface of the current preset.

10. ACTIVE +FREEZE

Switch stomp mode: Control Mode/Preset Mode

- Control Mode:

ACTIVE: Turn on/off the reverb.

FREEZE: Turn on/off the reverb freeze function.

- Preset Mode:

ACTIVE: Switch to the previous preset.

FREEZE: Switch to the next preset.

Connection Guide

Verbera can be used in both mono and stereo scenarios. By adjusting the input type settings, it is compatible with either mono or stereo input environments:

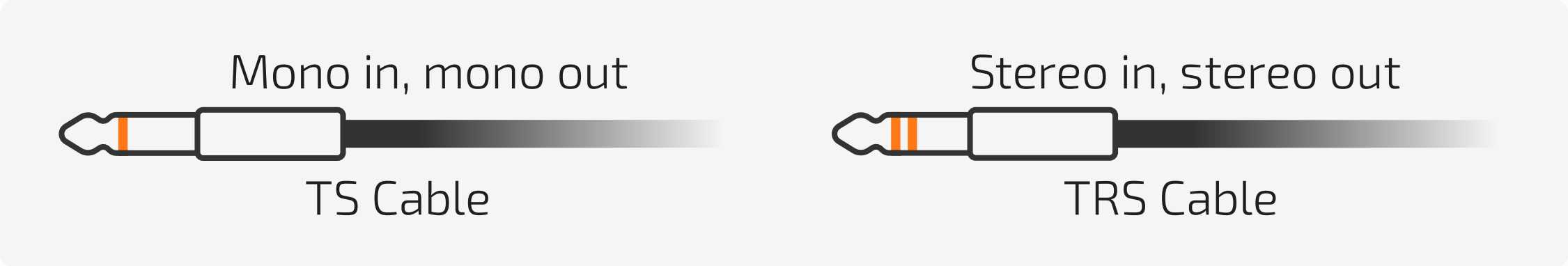

In a stereo input scenario, you may need a TRS to dual TS Y-cable:

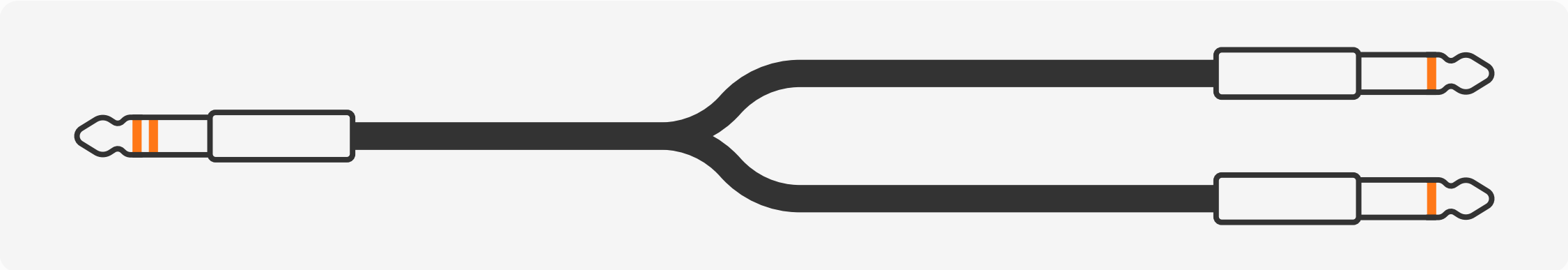

INPUT

In the MENU settings, select the input mode: Mono/Stereo/Auto (see section **MENU**).

Mono Input Scenario: Use a 1/4" TS cable to connect a mono instrument.

Stereo Input Scenario: Use a 1/4" TRS cable to connect a stereo instrument.

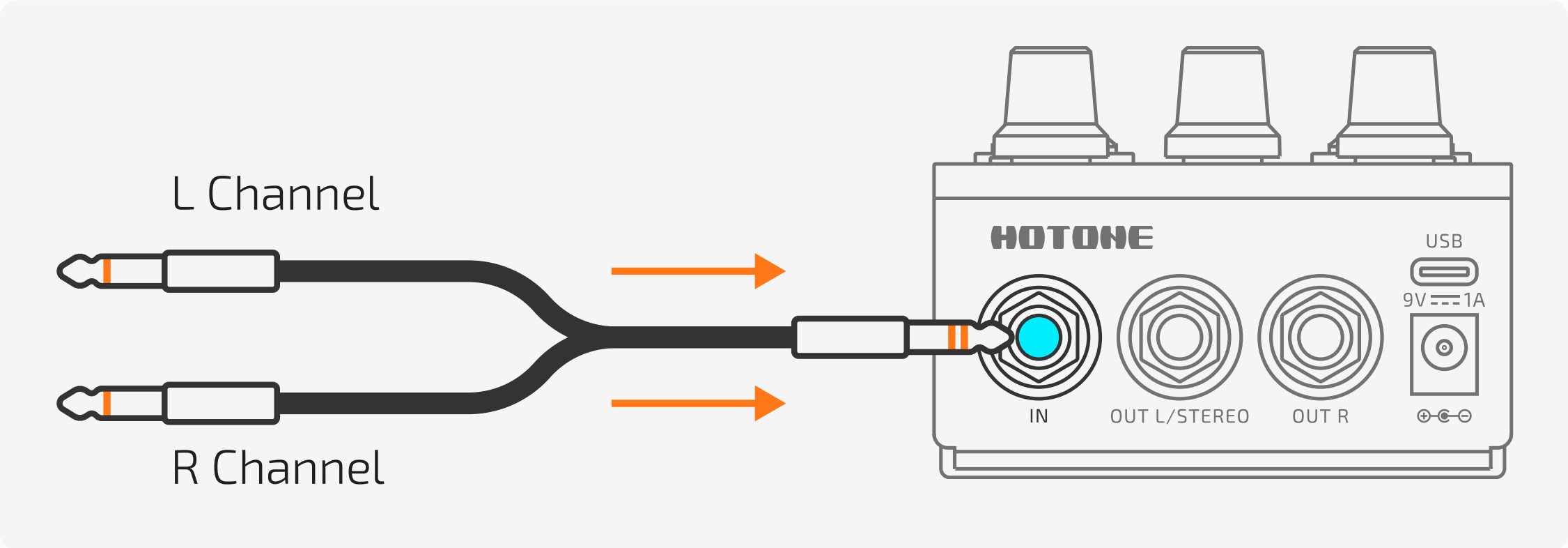

OUTPUT

Mono Output Scenario: Use a 1/4" TS audio cable to connect the OUT L/ STEREO channel to a mono input device.

Stereo Output Scenario:

- 1. Use a 1/4" TRS audio cable to connect the OUT L/STEREO channel to a stereo input device.

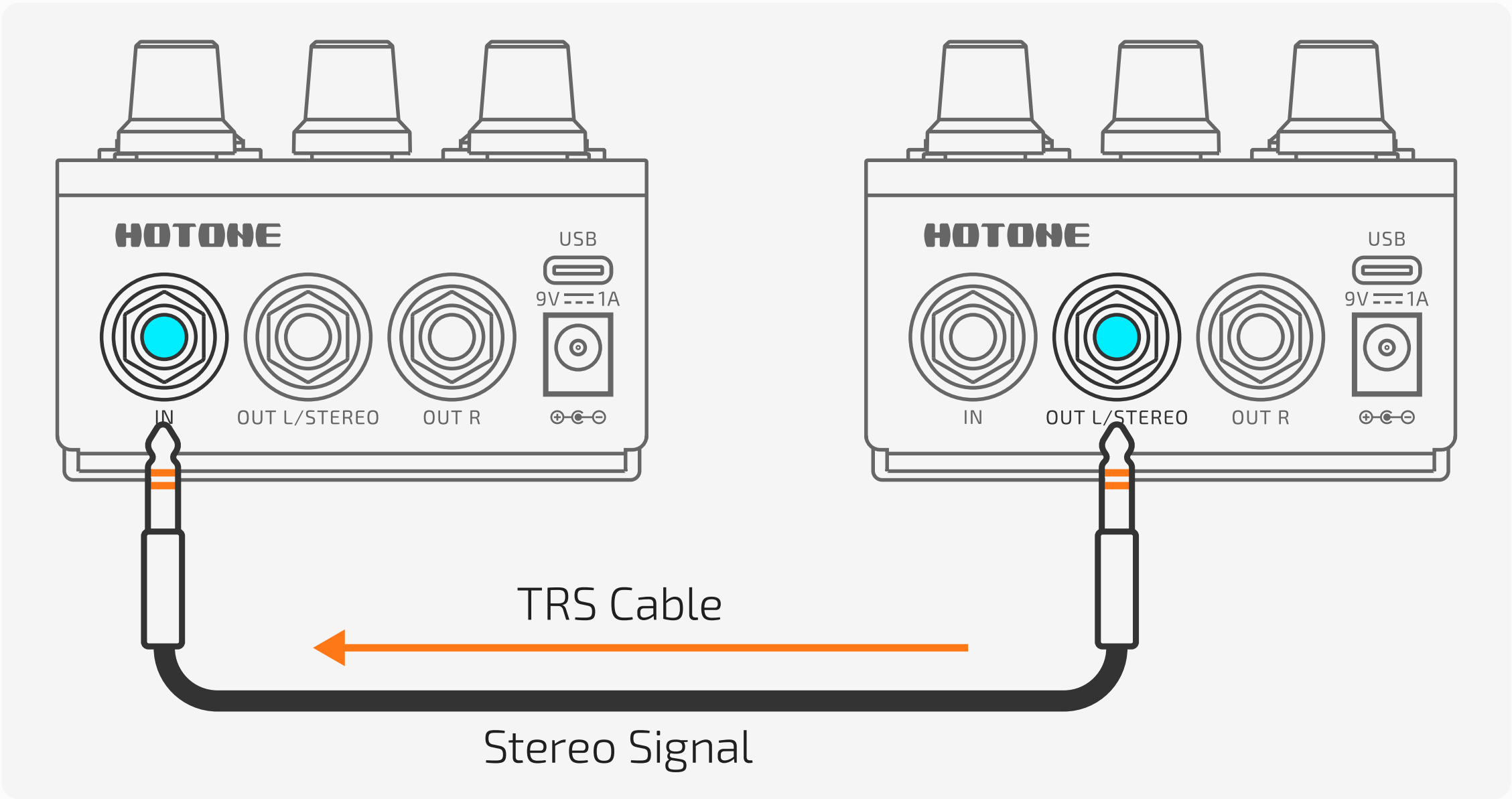

- 2. Use two 1/4" TS audio cables to connect the OUT L/STEREO and OUT R channels to a stereo input device.

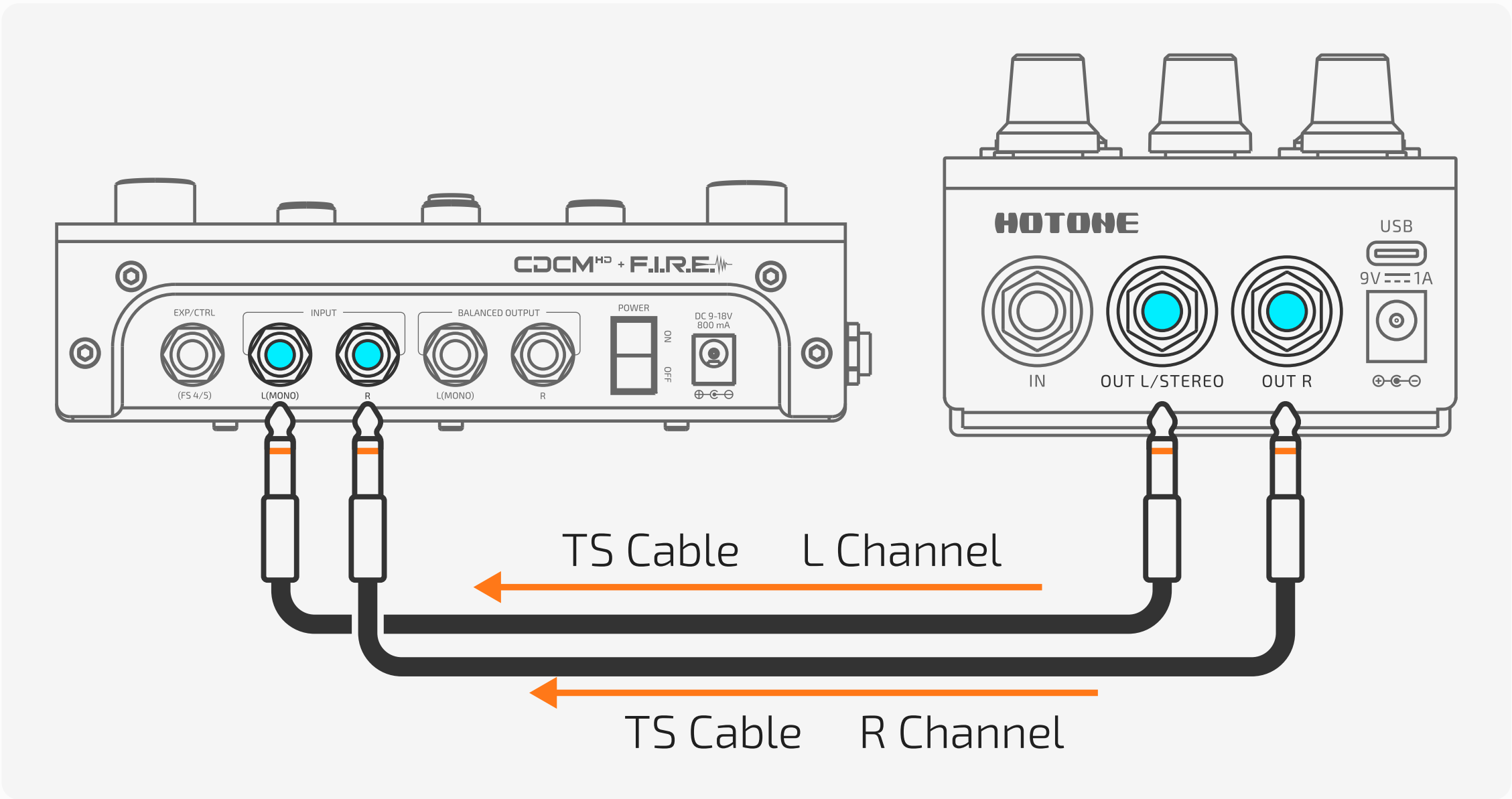

Suggested Setups

Using with Other Pedals

When using Verbera with other effect pedals, you can connect its output to an amp or a full-range system input, depending on your needs. If additional control is required, an external expression pedal or MIDI controller can be used.

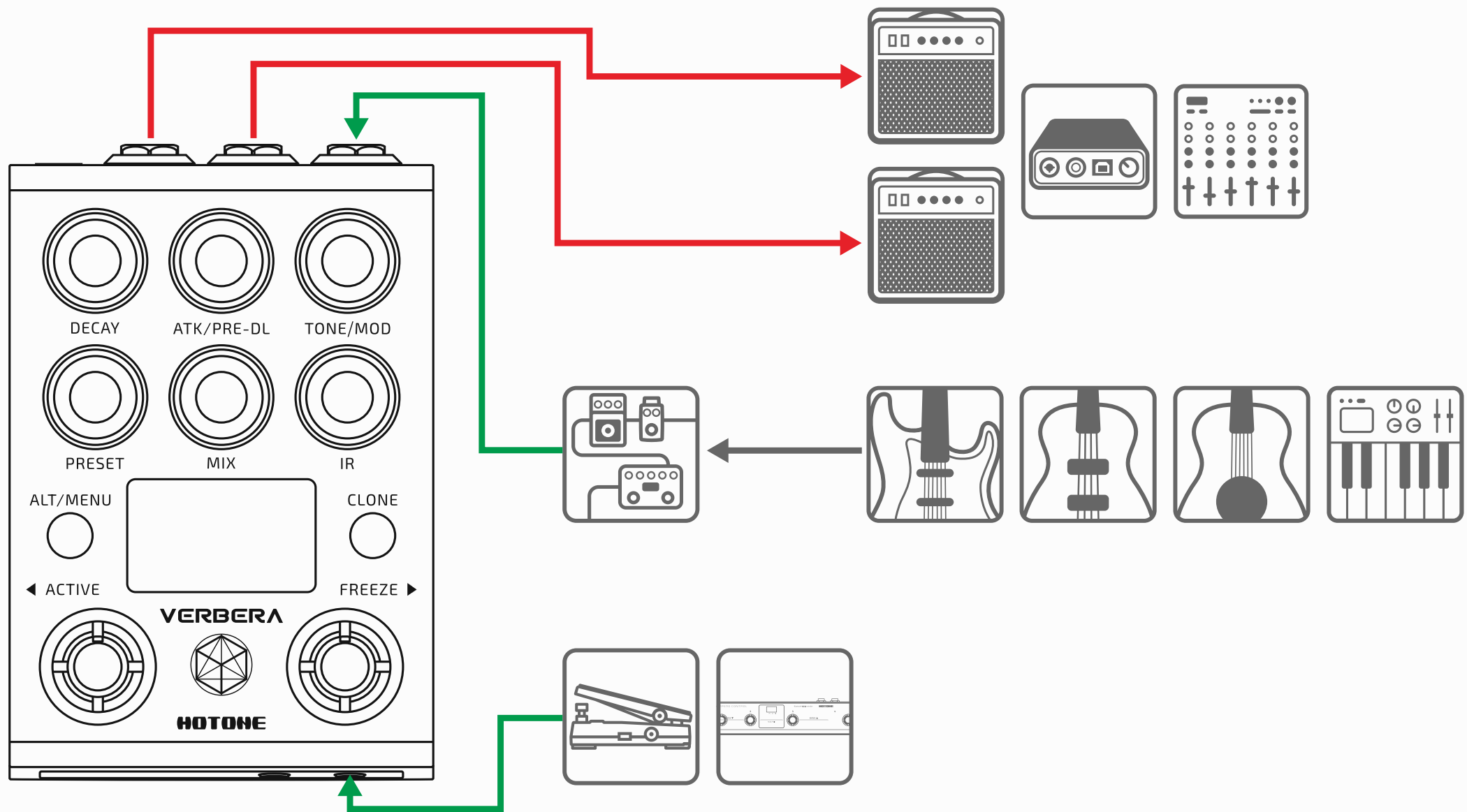

Connecting to the FX Loop of Other Devices

When using Verbera with other effect units or amp modelers that have an FX Loop, ensure that the device supports the appropriate channel configuration and use the corresponding audio cables for connection.

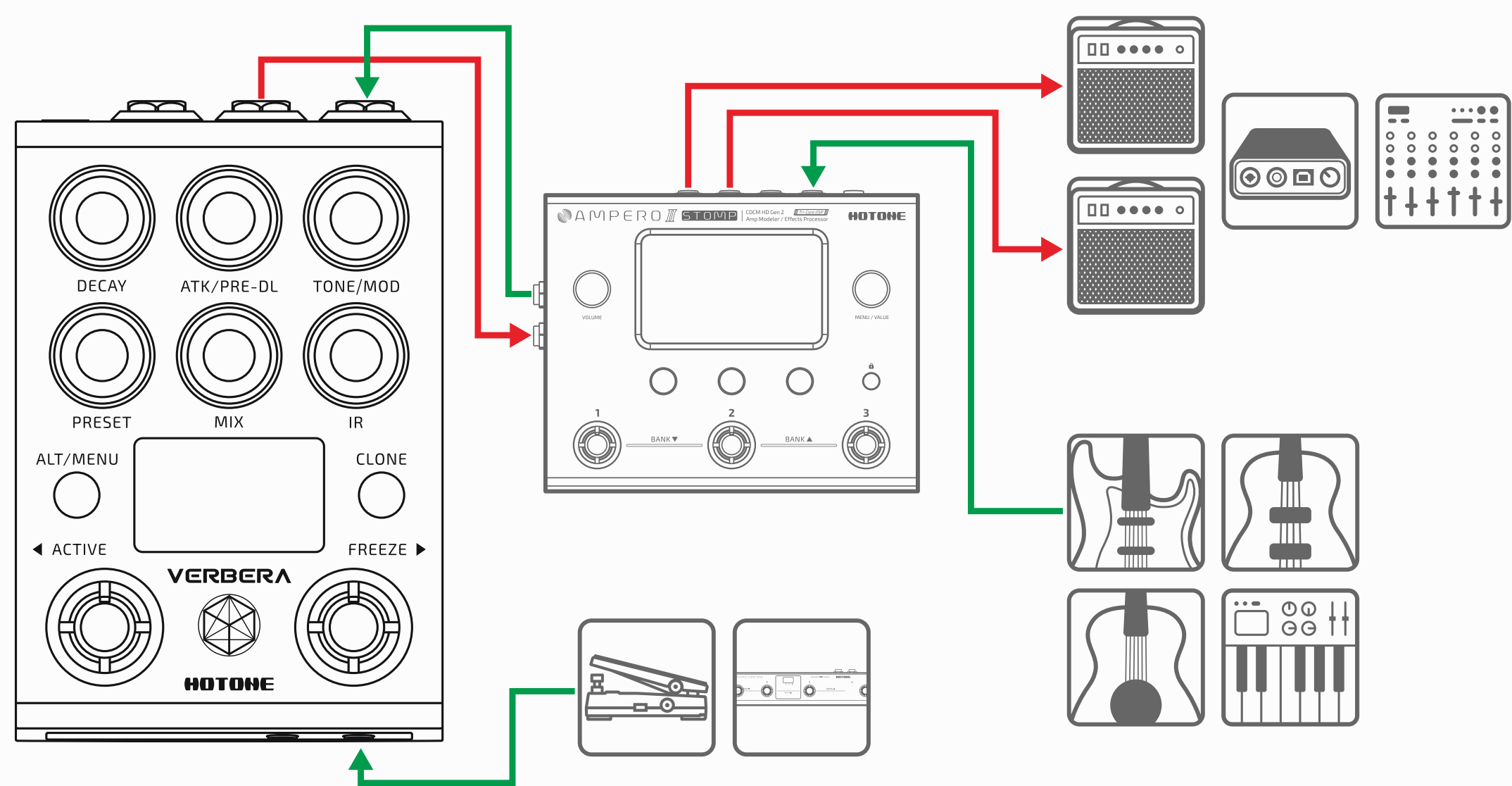

Controls in Depth

Signal Flow Overview

Verbera includes two types of reverb that work together: one is an IR-based convolution reverb designed to replicate the intricate reverb details of real spaces and equipment, while the other is a carefully crafted extra algorithmic reverb (XR). If you're aiming for an otherworldly sense of space, you can use it in combination with the IR reverb to create more layered and immersive virtual reverb tones, and you can also use the Freeze function in real-time to "freeze" the XR's tail. The Freeze sustain function is an independent feature of XR and can be controlled by adjusting the XR's MIX parameter to set the sustain volume. The instrument's dry signal is a pure analog thru design (Analog Dry Thru), ensuring the dynamic range and details of the original signal are fully preserved.

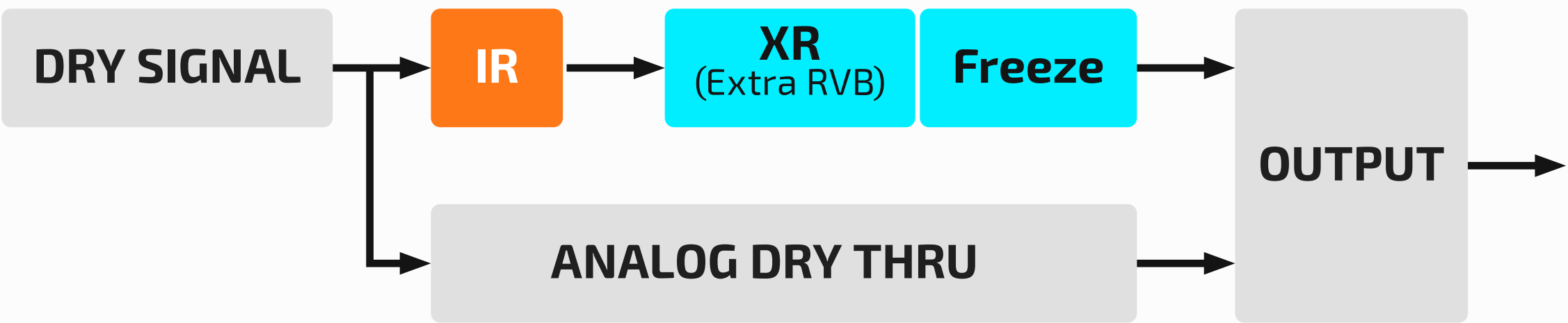

ALT/MENU

Parameter Toggle

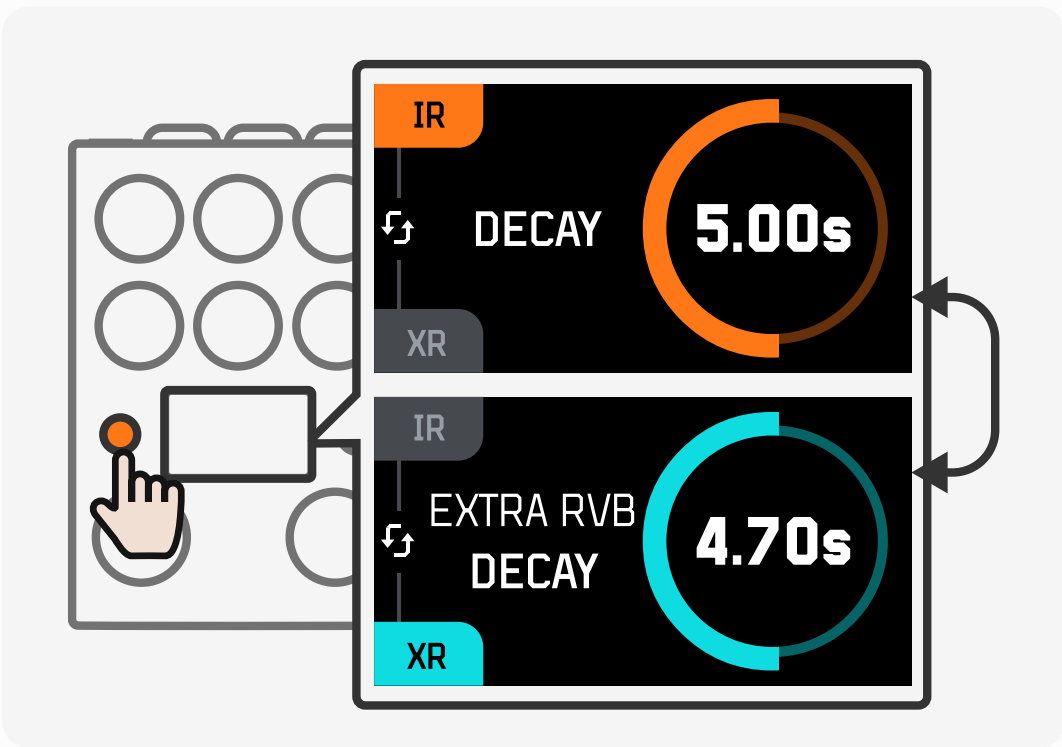

Pressing the ALT button allows the knob to toggle between two parameters. When the color of the knob's LED ring changes, it indicates that you've switched the control object of the knob. The screen will display the name of the currently adjusted parameter along with its specific value. Switching presets will not change the state of the ALT button.

MENU

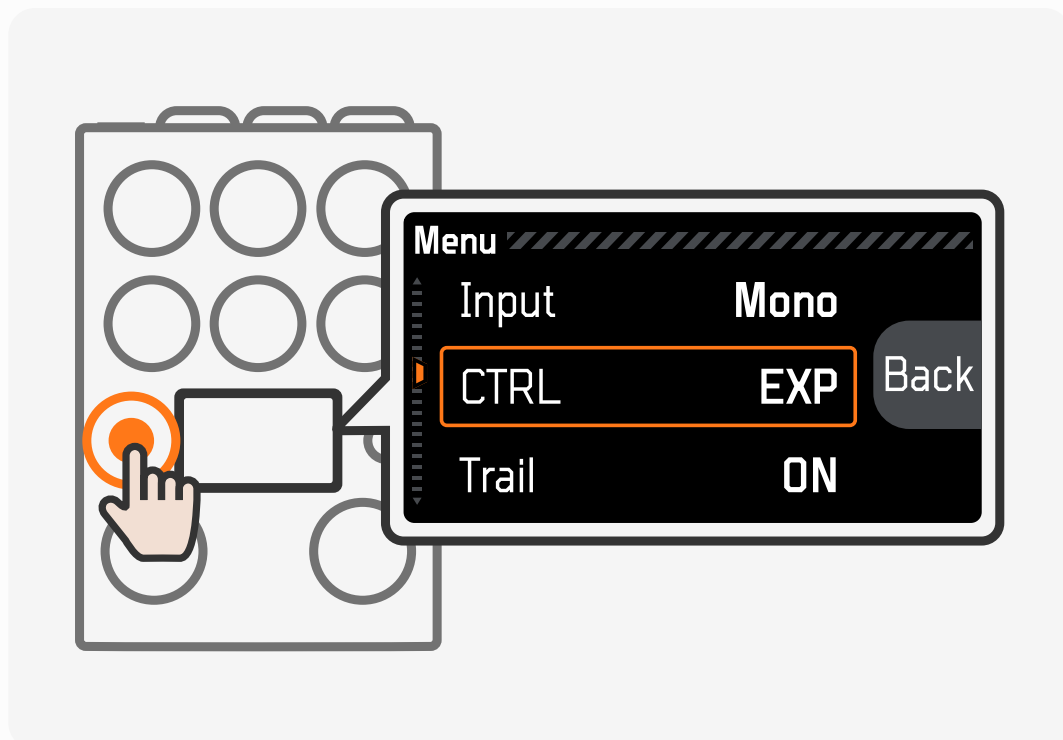

Press and hold the ALT button to open the MENU interface. Use the IR/Preset knob to navigate and press to select, allowing you to adjust global settings. Use the Clone button to save and exit.

- **Input:** Mono/Stereo/Auto — Choose the input mode as Mono or Stereo. Please use the appropriate audio cables for the corresponding input connection (refer to section **Connection Guide**).
- **CTRL:** MIDI/EXP — Select the control interface's working mode (for detailed usage, refer to Section **Expression and MIDI**).
- **Trail:** Enable/Disable the global Trail function. When Trail is enabled, the reverb tail will remain after the reverb effect is turned off until it naturally decays.
- **USB/TRS MIDI Channel:** Select the USB MIDI and TRS MIDI channel for the device. The default MIDI channel is Channel 1 (for MIDI-related functions, refer to Section **MIDI CC Table**).

You can view the current firmware version of the device in the About section.

About IR

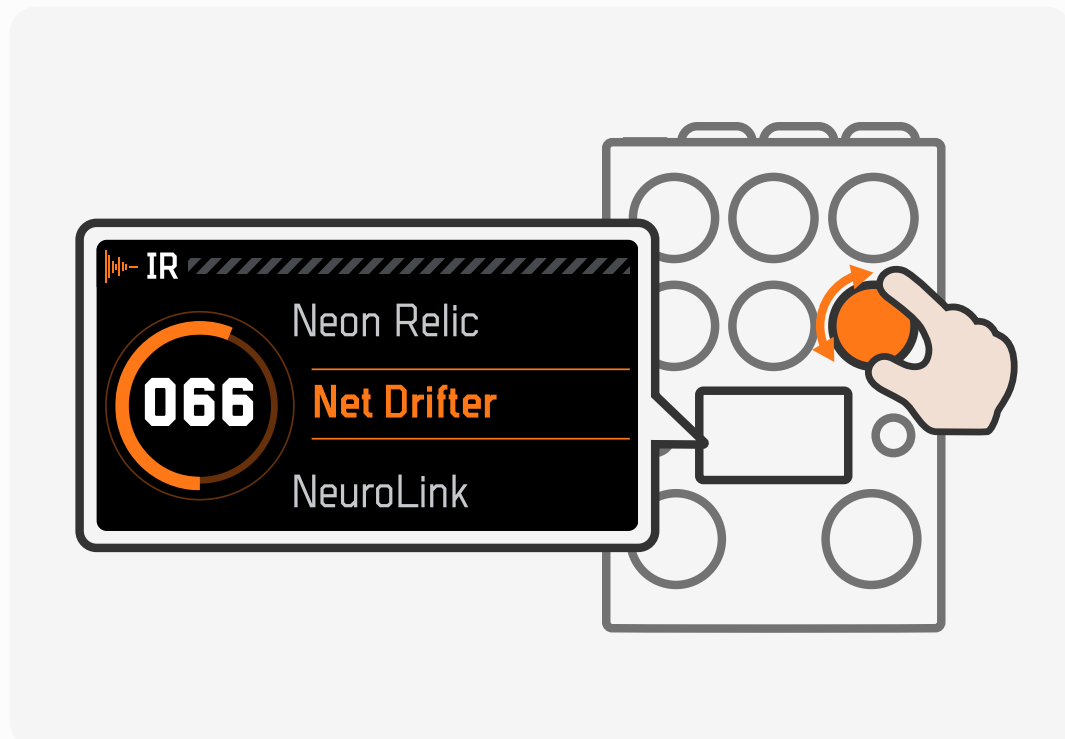

By rotating the IR knob, you can smoothly switch and preview IR reverb within any preset. Verbera comes with 120 factory-provided IRs, each uniquely sampled from around the world. These include iconic spaces such as European churches and aerospace facilities, as well as replicated IRs from classic

analog equipment, such as various classic spring reverb and plate reverb units. Additionally, some of the original IRs included are designed to open the door to new sonic possibilities.

Verbera allows you to store a vast number of IR files. You can import and export IRs using the accompanying software (refer to the software manual for details), or you can clone the sounds of other devices into IRs and store them in Verbera using the Clone function (see Section **Clone Function**). It can store up to 1024 IR files.

Smart IR Sorting

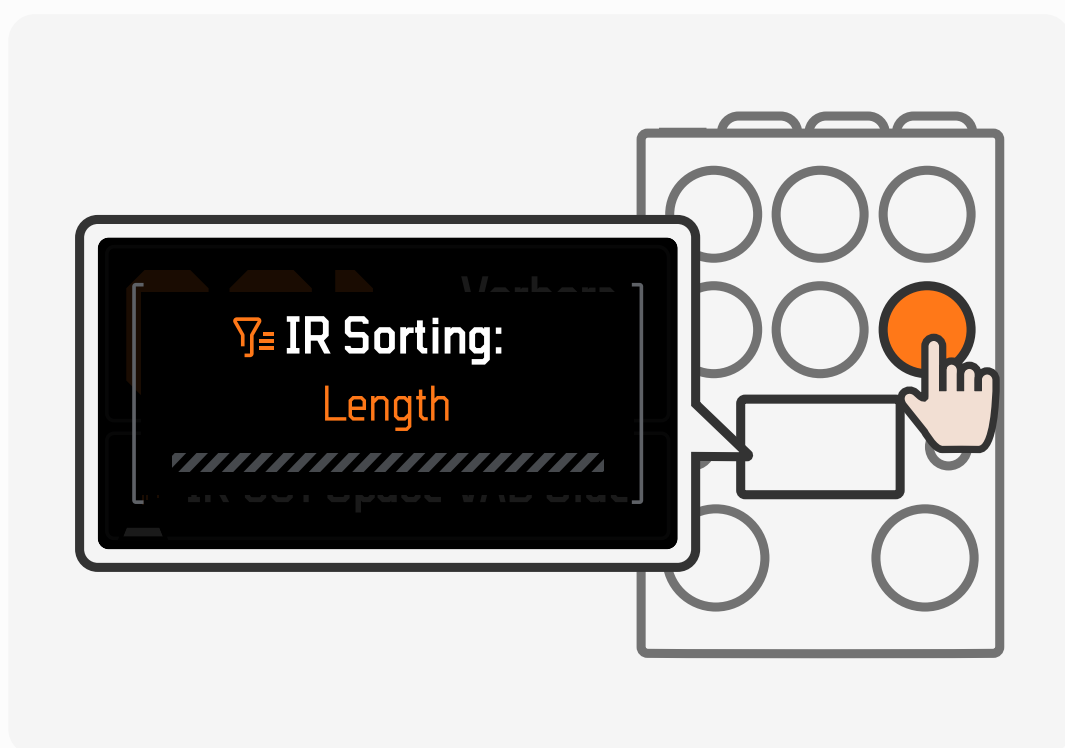

By pressing the IR knob, you can sort all IRs according to different criteria. Pressing the IR knob repeatedly will cycle through the following sorting options:

- **Name:** Sorted alphabetically.
- **Length:** Sorted from longest to shortest reverb decay.
- **Smooth:** Sorted by the smoothness of IR decay, from high to low.
- **Diffusion:** Sorted by the stereo spread of the IR, from high to low.
- **Brightness:** Sorted by the brightness level of the IR, from high to low.
- **Attack:** Sorted by the attack speed of the IR, from fast to slow.

Tip:

- 1. Selecting favorite (Fav) IRs in the Neon Collector software will place them at the top by default when sorting by name, making it easier to browse your favorite IRs.
- 2. When an IR used in a preset is deleted (via the companion software Neon Collector), Verbera will display a missing IR warning and automatically load the first IR in the list sorted by name.

About Preset

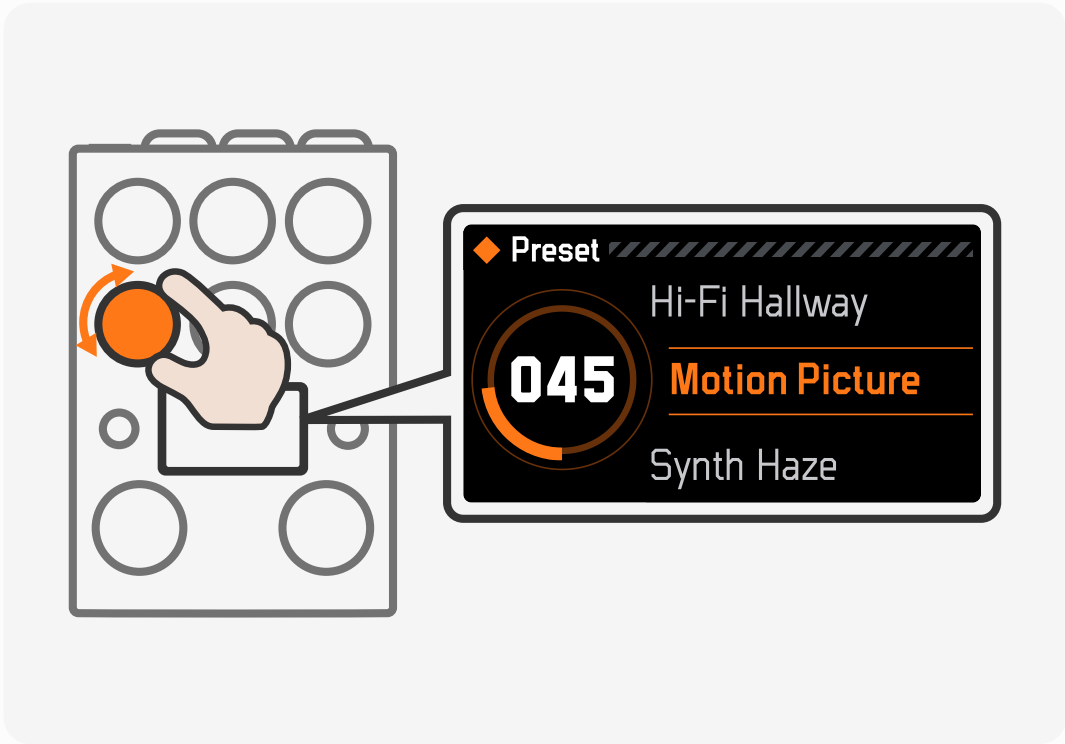

By rotating the **PRESET** knob, you can directly switch between presets on the device. It supports up to 200 preset slots, including 100 editable factory presets and 100 default presets. Each preset includes the following information:

- **Preset Name**
- **Preset Slot**
- **One IR file and its corresponding parameters**
- **An extra reverb (XR) and its corresponding parameters**
- **EXP settings for the preset**

Preset Main Interface



- 1. When the IR or parameters within a preset are changed, causing a modification in the preset information, a dot will appear here to indicate that the preset information has been altered.
- 2. This section displays the name of the IR used in the current preset and indicates its relative position in the current IR sorting order.

Save and Rename



Press the Preset knob to enter the preset save interface. Rotate to select the preset slot for saving. **Press and hold** the knob to save directly to the current slot.



Press the Preset knob to save a custom preset to the current slot or overwrite another preset, and enter the rename interface.

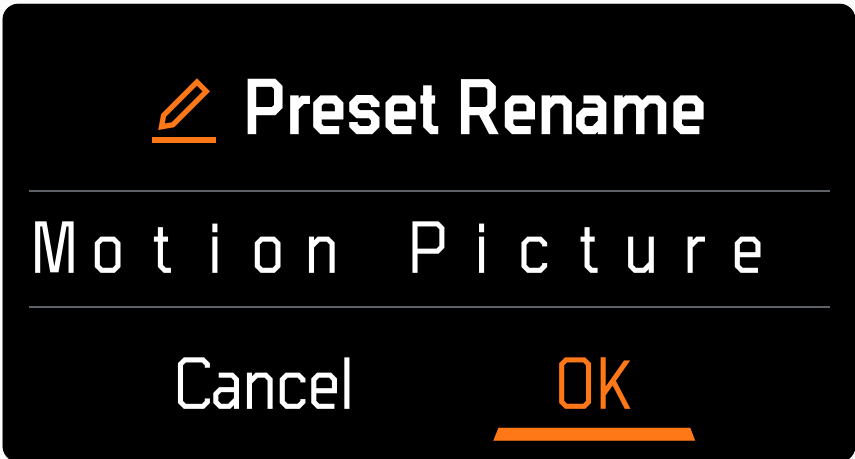

Use the CLONE or ALT button to save the current name or cancel the save. You can also use the Preset/ IR knob to select and rename the preset.

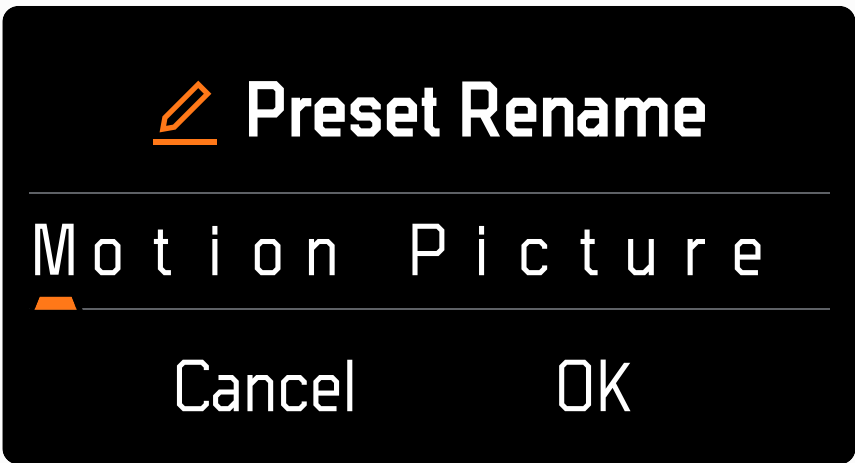

Rotate the Preset/ IR knob to select the position of each letter to be modified.



Press the knob to modify the selected letter.

Footswitch Mode

Verbera features two built-in footswitch modes, which can be switched at any time by pressing both ACTIVE and FREEZE simultaneously.

Switch to the previous preset.
The footswitch indicator will remain orange.



Switch to the next preset.
The footswitch indicator will remain orange.

Preset Mode

Activate/Deactivate reverb effect.
The orange footswitch indicator will light up or turn off accordingly.



Activate/Deactivate Freeze effect.
The blue footswitch indicator will light up or turn off accordingly.

Control Mode

Clone Function

Want to capture the reverb from other devices? Verbera's built-in IR cloning function allows you to clone the signature reverb from any device with input/output interfaces, saving them as IRs in your Verbera. These cloned IRs can then be freely adjusted just like any other IR.

What is Cloning, Anyway?

Cloning in the Verbera means it captures the “feel” or space of another reverb device — kind of like taking an audio snapshot of how it sounds. It's based on IR (Impulse Response) tech, so it works best with clean, simple reverb tones (not stuff with shimmer, modulation, or other funky effects). Make sure your other pedal is set to basic reverb before cloning.

► Step 1:

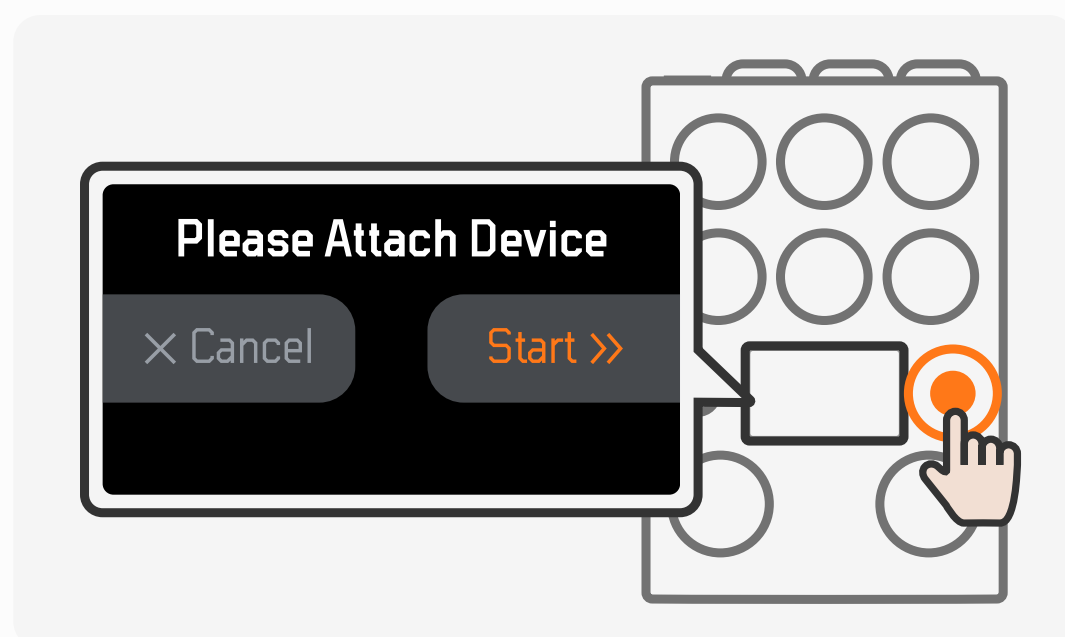

Before you plug anything in, press and hold the Clone button on your Verbera. This puts it into “Clone Prep Mode,” which stops nasty feedback or howling sounds from happening when you hook up other gear.

Do this before connecting any

cables.

► Step 2: Hook It All Up

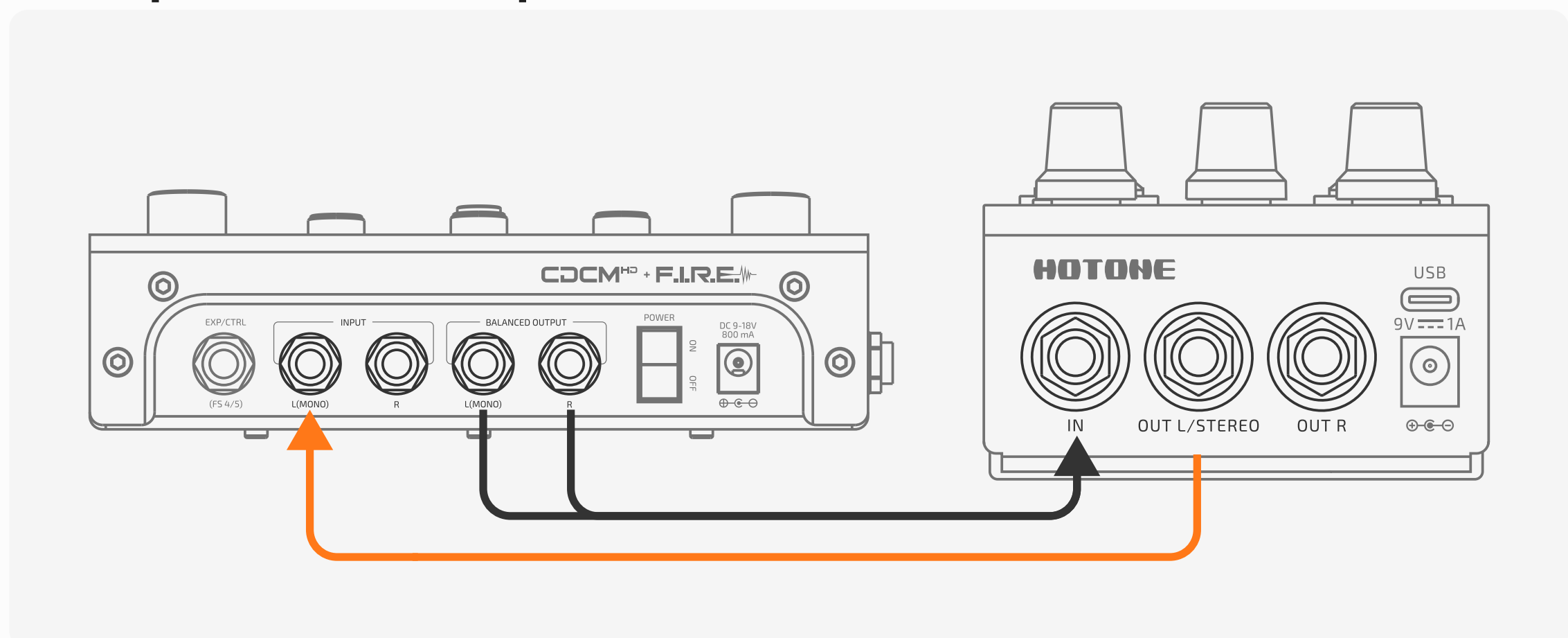

Verbera → Target Pedal

Use a TS (mono) cable to go from the Left Output of the Verbera to the Input of the pedal you want to clone.

Target Pedal → Verbera

Now take the output of your reverb pedal and connect it to the Input of the Verbera.

- For stereo pedals: Use a TRS-to-dual-TS splitter cable to send both Left and Right outputs into the Verbera.
- For mono pedals: A regular TS cable is fine.

► Step 3: Set Up Your Reverb Pedal

To get the cleanest clone:

Set your pedal to 100% wet (only reverb, no dry signal).

If your pedal doesn't have a full wet option, no worries — the Verbera will still capture it, but it'll include some dry tone too. Later on, you can tweak the Attack setting on the Verbera to reduce that if needed.

And again:

1. turn off modulation or shimmer on the reverb pedal — the Verbera doesn't clone those. You can always add modulation later using the Verbera's built-in Mod control.
2. The maximum reverb length that can be cloned: 20 seconds (mono) or 10 seconds (stereo).

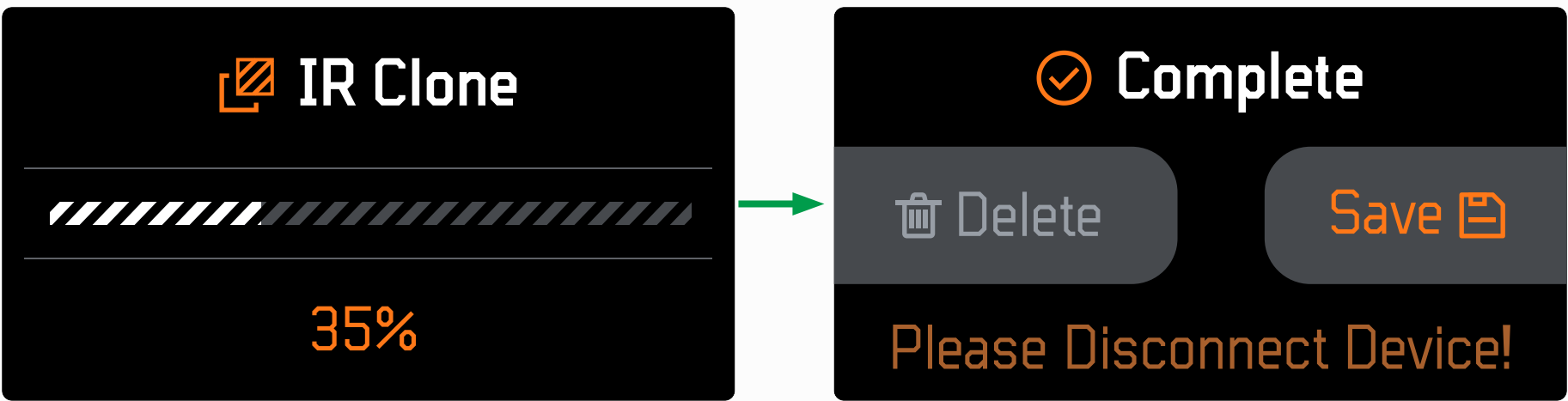

Once the device loop is connected, click Start to begin cloning. Wait for the progress bar to complete, then disconnect from the cloning device. You can now choose to save or delete the cloned IR.

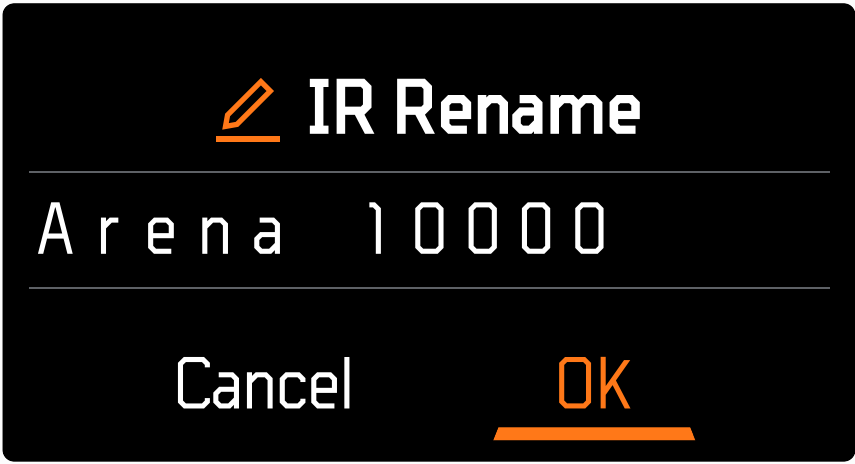

Verbera will intelligently analyze the characteristics of the cloned IR and automatically assign a name. Use the CLONE or ALT button to save the current name or cancel the save. You can also use the Preset/ IR knob to select and rename the IR.

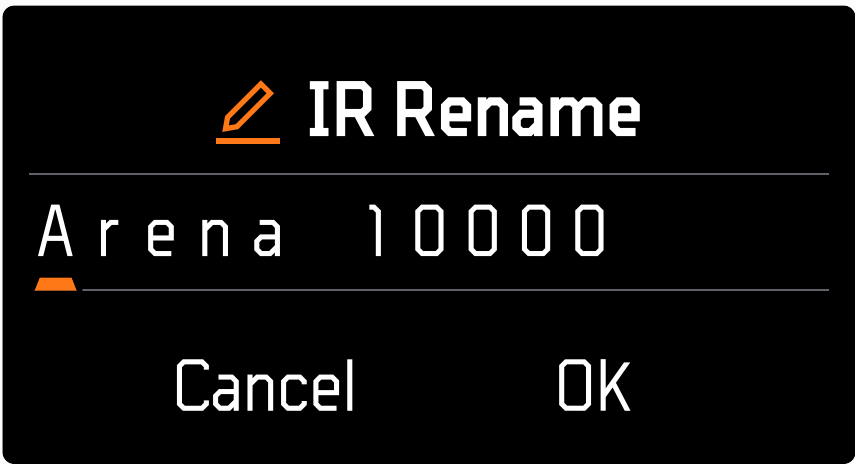

Rotate the Preset/ IR knob to select the position of each letter to be modified.



Press the knob to modify the selected letter.

For the Best Sound

To get your clone sounding exactly right, set your Verbera like this:

- Tone: 12 o'clock (Without additional tone shaping)
- Decay: Max (Ensuring a complete capture of the reverb decay)
- Mod / Attack / XR Mix / Predelay: All the way down (Parameters other than the cloned tone can be adjusted as needed.)

Expression and MIDI



1. MIDI THRU: Standard MIDI Thru interface, use a 1/8" TRS cable to output to other devices, forwarding the received MIDI data in real time.
2. MIDI IN/EXP: A compatible interface for both MIDI IN and EXP. In the MENU, you can switch the operation mode of the EXP/MIDI interface (see section **Menu**). Use a 1/8" TRS cable to connect MIDI devices or expression pedal.

EXP Setting

After switching to EXP mode, connect Verbera to an external expression pedal to enable real-time control of additional parameters.

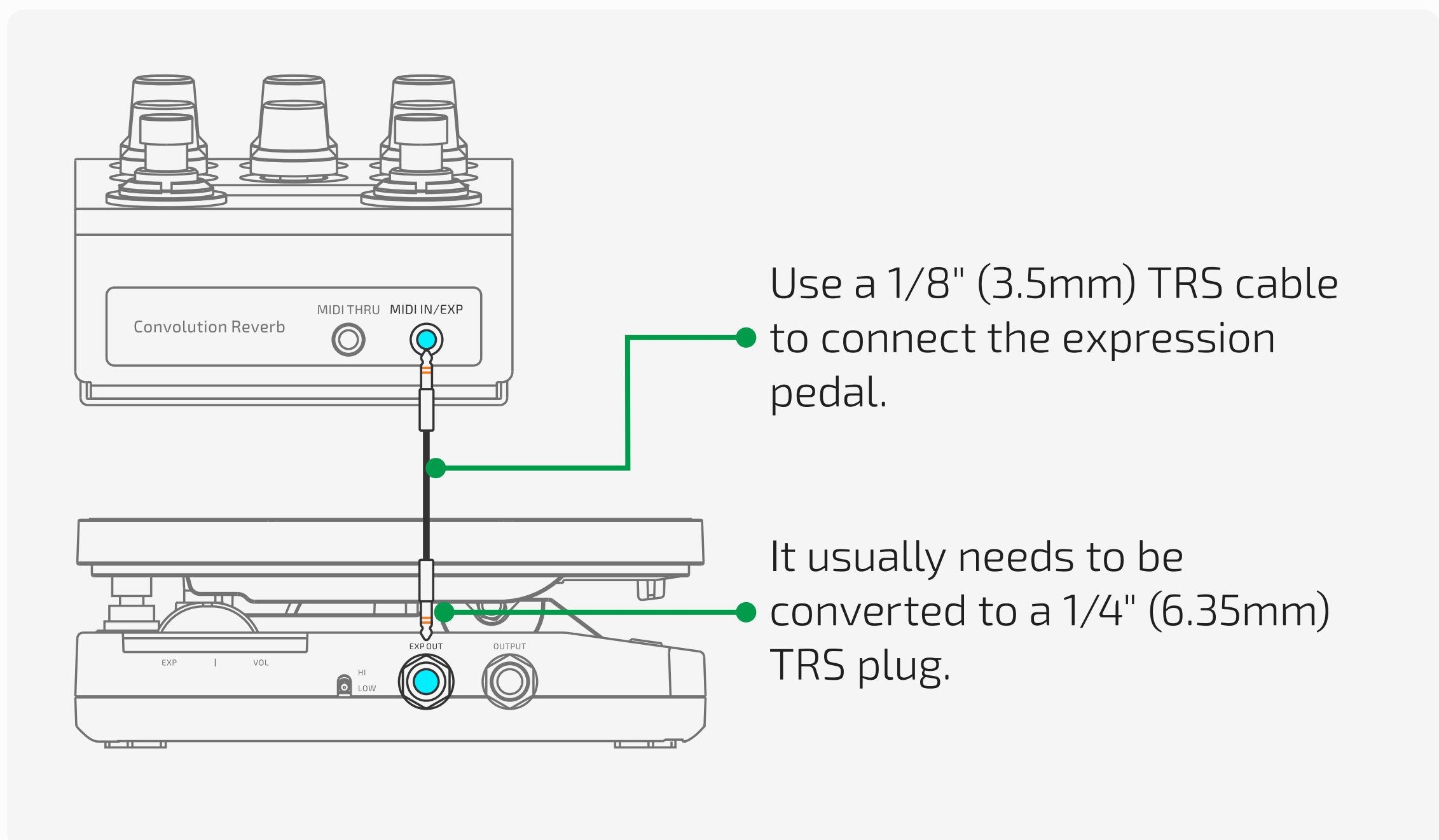

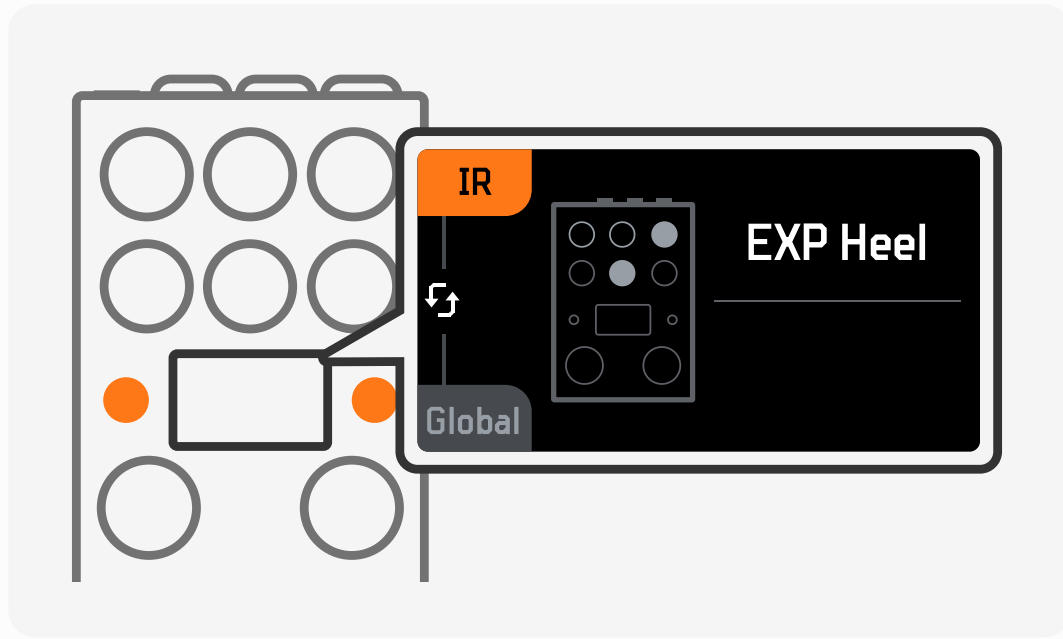

After connecting the pedal, press both the ALT and CLONE buttons simultaneously to enter the EXP settings interface for the current preset.



The screen will display EXP Heel, indicating the parameter settings for when the pedal is fully raised:

First, lift the pedal completely (or to the maximum position where you want the parameter to stop changing).

Rotate the desired parameter knob to set the corresponding value.

Press the CLONE button to switch to the EXP Heel/Toe settings interface.



The screen will display EXP Toe, indicating the parameter settings for when the pedal is fully pressed down:

First, press the pedal completely (or to the maximum position where you want the parameter to stop changing).

Rotate the desired parameter knob to set the corresponding value.

Once both EXP Heel and EXP Toe values are set for a parameter, the corresponding knob on the screen will light up, indicating that the parameter has been successfully configured.

During the setup, the ALT button's toggle function remains active. Once the settings are complete, press both the ALT and CLONE buttons simultaneously to exit the EXP settings interface.

Setting the EXP Heel and EXP Toe of a parameter to the same value can disable control over that parameter.

(If you wish to save the EXP settings to the current preset, you will need to manually save the preset information.)

MIDI Setting

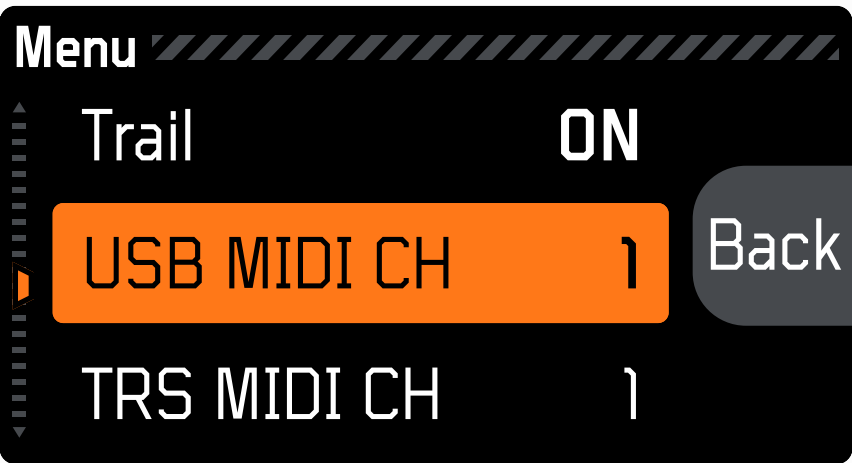

After switching the CTRL setting to MIDI mode, you can connect Verbera to other MIDI devices for additional control. In the MENU, you can set different MIDI channels for the device's USB and TRS interfaces (the default is MIDI Channel 1).

MIDI CC Table

MIDI Control: Variable Parameters		
CC#	Data (Range)	Parameter
1	0~10	Actions(See the table below)
2	0~127	IR Mix
3	0~127	IR Decay
4	0~127	IR Attack
5	0~127	XR Mix
6	0~127	XR Decay
7	0~127	Global Tone
8	0~127	Global Pre-delay
9	0~127	Global Mod Depth

MIDI Control: Actions(CC#1)	
Data	Parameter
0	IR on/off
1	XR on/off
2	IR&XR on/off (Bypass)
3	Freeze on/off
4	FS Mode change (Preset or Control)
5	Next preset
6	Previous preset
7	Next IR
8	Previous IR

Power Supply



To ensure the device fully performs its audio capabilities and functional parameters, please use the following two power supply methods:

1. It is recommended to use the factory 9V DC 1A power supply (center-negative).
2. The device is also compatible with USB power supply (5V 2A).

Software Support

The included software, Neon Collector, allows for preset and IR file management for Verbera. The software supports both Windows and macOS versions. After downloading and installing the appropriate version from the provided link, connect Verbera to the software via USB-C, and Neon Collector will automatically recognize the Verbera device. (www.hotone.com/support/3)

Bluetooth and Wi-Fi Connection Guide

After powering on the device, press and hold both the Freeze footswitch and the IR knob button simultaneously to enter Engineering Mode. Then, press the PRST knob button, and long-press the ALT button to access the Bluetooth and Wi-Fi connection interface.

At this point, you can press the ALT button to toggle Bluetooth on or off, and use the Clone button to toggle Wi-Fi on or off. The device will then automatically connect to the corresponding nearby Bluetooth or Wi-Fi network.

Factory IR List

No.	IR (Sort by Name)	Collection Source
1	1985 Hall	Factory Original IR
2	80 Foot Drain	Captured from a drain
3	Abyss Vibe	Factory Original IR
4	Arena 10000 1	Captured from a 1000-seat Arena
5	Arena 10000 2	Captured from a 1000-seat Arena
6	Arena 3800 1	Captured from a 3800-seat Arena
7	Arena 3800 2	Captured from a 3800-seat Arena
8	Arena 5000	Captured from a 5000-seat Arena
9	Art Exhibit	Captured from a exhibit room
10	Astral Shimmy	Factory Original IR
11	Atrium 54 Ft	Captured from a Atrium
12	Auditorium 400	Captured from a 400-seat auditorium
13	Auditorium 500	Captured from a 500-seat auditorium
14	Bed Room	Captured from a Nashville room
15	Belle Church	Captured from the Belle Church

No.	IR (Sort by Name)	Collection Source
16	Blooming	Factory Original IR
17	Break Beat 130	Factory Original IR
18	Brent Church	Captured from the Brent Church
19	Brent Heaven	Captured from the Brent Church
20	Bri Plate	Captured from the Brick Plate Reverb
21	Brit Spring	Captured from the Bandive Great British Spring
22	Carpet Tube	Captured from a carpet tube
23	Cathedral	Captured from a cathedral
24	Cave 1	Captured from a cave
25	Cave 2	Captured from a cave
26	Cloudy Tail	Factory Original IR
27	Concrete Room	Captured from a concrete cavern
28	Control Room	Captured from a controlling room
29	Cross Freq	Factory Original IR
30	Cryo Circuit	Factory Original IR
31	CTKCC Side	Captured from a Catholic Church
32	Cyber Wave	Factory Original IR
33	Dance Studio	Captured from a studio room
34	David's Church	Captured from the St David's Church
35	Destin Office	Captured from a office
36	Dome 50	Captured from a 50-feet Dome
37	Dome 50 Turf	Captured from a 50-feet Dome
38	Dream Hall	Factory Original IR
39	Echo Shift 1	Factory Original IR
40	Echo Shift 2	Factory Original IR
41	Echo Space	Factory Original IR

No.	IR (Sort by Name)	Collection Source
42	Echo String	Factory Original IR
43	Echoing Hall	Factory Original IR
44	Episco Church	Captured from a Episcopal Church
45	Ether Hallway	Factory Original IR
46	Fat Plate	Captured from the Lexicon 480L
47	Flat Land	Factory Original IR
48	Fort Hallway	Captured from the Fort Barr Hallway
49	Fort Outside	Captured from the Fort Barr Hallway
50	Future Impact	Factory Original IR
51	Garage 1	Captured from a parking garage
52	Garage 2	Captured from a parking garage
53	GMC Truck	Captured from a GMC Truck
54	Hallway Slap	Factory Original IR
55	Heavenly Space	Factory Original IR
56	Hudson Hall	Captured from the Hudson Hall
57	Illusion Echo	Factory Original IR
58	Ivy League Hall	Captured from the Ivy League Hall
59	Joseph Church	Captured from the St Joseph Church
60	Kaleidoscope	Factory Original IR
61	Lake Slapback 1	Captured from the State Park Tennessee
62	Lake Slapback 2	Captured from the State Park Tennessee
63	Leaf Bedroom	Captured from a Nashville room
64	Luth Church 1	Captured from the Luth Church
65	Luth Church 2	Captured from the Luth Church
66	Meeting Room	Captured from a conference room
67	Metal Surface	Factory Original IR
68	MetroSync	Factory Original IR

No.	IR (Sort by Name)	Collection Source
69	Multi Echo	Factory Original IR
70	Nash Aud Side	Captured from a Nashville auditorium
71	Neon Relic	Factory Original IR
72	Net Drifter	Factory Original IR
73	Neuro Link	Factory Original IR
74	Oil Can	Captured from the Gibson A-4RE Oil Can (Tel Ray)
75	Out Ambient 1	Captured from a open architectural complex
76	Out Ambient 2	Captured from a open architectural complex
77	Out Ambient 3	Captured from a open architectural complex
78	Out Ambient 4	Captured from a open architectural complex
79	Pan Gate	Factory Original IR
80	Peach Church	Captured from the Peach Church
81	Phantom Loop	Factory Original IR
82	Ping Pong Fun	Captured from the Peavey Dual DeltaFex Multi Effects processor
83	Plate Unit 140	Captured from the EMT 140
84	Prayer Room	Captured from a cathedral's prayer room
85	R-1 Spring	Captured from the Vesta-Fire RV-1
86	Regen Field	Factory Original IR
87	Reverse Echo	Factory Original IR
88	Rotary Records	Captured from the Rotary Records Main Studio Room
89	Shatter Pulse	Factory Original IR
90	Small Barn	Captured from a small barn
91	Small Orch Hall	Captured from a Orchestra Hall
92	Smooth Cloud	Factory Original IR

No.	IR (Sort by Name)	Collection Source
93	Space Facility 1	Captured from the Space Station Processing Facility
94	Space Facility 2	Captured from the Space Station Processing Facility
95	Space Facility 3	Captured from the Space Station Processing Facility
96	Space VAB Ctr	Captured from the Vehicle Assembly Building of a Space Center
97	Space VAB Frt	Captured from the Vehicle Assembly Building of a Space Center
98	Space VAB Rer	Captured from the Vehicle Assembly Building of a Space Center
99	Space VAB Sd	Captured from the Vehicle Assembly Building of a Space Center
100	Specter Echo	Factory Original IR
101	Speed Up	Factory Original IR
102	Spiral Descent	Factory Original IR
103	Spring 100	Captured from the Unicord Univerb
104	Spring 2600	Captured from the ARP 2600
105	Spring 636	Captured from the Soundgas Type 636 Grampian
106	Spring 844	Captured from the Olson RA-844
107	Spring Box 10	Captured from the Vintage Kay Model 710
108	Spring Plus	Captured from the Alamo Fiesta 2573
109	Spring Pro V	Captured from the Univox U3R Proverb
110	St Hen Bapt	Captured from the St Hen Baptistry
111	Synth Haze	Factory Original IR
112	Time Slip	Factory Original IR
113	Tunnel Flash	Factory Original IR

No.	IR (Sort by Name)	Collection Source
114	Underwater	Captured from a underwater
115	Warm Spring	Captured from the Orban 111-b
116	West Cylinder	Captured from the Middle School Nashville
117	Whiring In Rags	Factory Original IR
118	Whisper Room	Captured from a Nashville room
119	White Hole	Factory Original IR
120	Wils Hall 66 Ft	Captured from the Wils Hall

Technical Specification

Featrue	Specification
Input jack	1×6.35mm (1/4") TRS Jack
Output jack	2×6.35mm (1/4") TRS Jack
MIDI/EXP jack	2×3.5mm (1/8") TRS Jack
USB jack	USB 2.0 Type-C
Input impedance	1 Meg Ohm
Output impedance	1K Ohm
A/D&D/A	High-performance 32-bit
DSP	32-bit processing
SNR	115dB
Frequency response	±0.1dB, 20Hz~20kHz
Max input level	+13dBu
Bypass	Analog Dry Thru + Buffer
Power supply	9V DC, 1A (Center Negative)
Dimensions	125.5mm(L)×84mm(W)×62.5mm(H)
Weight	485g