

# Flyruit

## ITEM TAG

### User Guide

Contact us via [Flyruit@outlook.com](mailto:Flyruit@outlook.com)

#### Product & APP

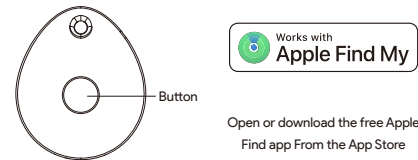

#### Specifications

Specification	Parameter
Model	FLY TAG
Bluetooth Version	Bluetooth 5.3
Frequency Band	2.402GHz ~ 2.480GHz
Bluetooth Protocol	BLE / Find My Network
Transmission Range	>130 feet (40m)
Control Method	Mechanical Button/Application
Power Supply	CR2032 Battery
Battery Average Life	10~12 months
Product Dimensions	36.5mm × 31mm × 8.6mm
Product Weight	7g
Operating Temperature	-5°C to +45°C
Sound Level	80 decibels (dB)

1

#### Quick Start

##### 1.Turn On Your FLY TAG

- Briefly press the button once, the FLY TAG will emit 4 short beeps and enter pairing mode.

##### 2.Pair with iPhone/iPad

- Open the "Find My" app on your Apple device.
- Keep the FLY TAG close to your iPhone/iPad
- Go to the "Items" → Tap "Add Item" / "+" → Select "Add Other Supported Item", you'll see FLY TAG, tap "Connect".
- Name your item, pick an emoji, and tap "Continue".
- Agree to link the item to your Apple ID, tap "Finish" to complete pairing.

##### 3.Play Sound

- Open "Find My" → "Items" → Select your "Item".
- Tap "Play Sound" to locate it with beeps.
- \*Note: If your FLY TAG is more than 130 feet (40m) away, the sound may not play.

##### 4.Locate your item

- Open "Find My" → "Items" → Select your "Item".
- Tap "Directions" to locate your item.
- \*The Find My network uses millions of Apple devices worldwide to securely and anonymously locate it. Nearby devices detect and share its location through iCloud - all encrypted for privacy.

##### 5.Remove Your Device

- Open "Find My" → "Items" → Select your "Item".
- Tap "Remove Item" at the page bottom.

2

- The FLY TAG will emit a Tone a and reset for new pairing.
- \*Note: When removing a FLY TAG, keep it next to your Apple device to ensure a stable connection.

#### 6. Factory Reset

- Remove item on "Find My" app.
- Briefly press the button 3 times and continue hold on the 4th press until you hear a long tone.
- The FLY TAG will reset to factory settings and is ready for new pairing.
- \*For returns/refunds: Factory reset your device and unpair it from FLYTAG to safeguard your personal data.

#### Button Functions

\*\*d= short beep, "d--" = long beep

Function	Action	FLY TAG Response
Power On	Briefly press the button once.	dddd
Working Mode	Briefly press the button once after powered on.	d
FMN Pairing Success	Add FLY TAG via the Find My app.	dd
Play Sound	Tap "Play Sound" in the Find My app.	d *12times
Power Off	Press and hold the button for 5 seconds.	ddd
Remove	Tap "Remove Item" in the Find My app.	tone
Factory Reset	Quick-press 3 times, then hold the 4th until a long beep sounds.	d--
Motion Detection	Automatically triggered after 3 days of separation.	Initial trigger: 2 beeps. Continuous motion: Beeps persist for 20 seconds. Resets after 6 hours.

3

#### FAQ

##### 1.Can I use FLY TAG with Android?

No, it only works with Apple devices via the Find My network.

##### 2.Why can't I see my FLY TAG's location?

Ensure it's within range of any Apple device. If offline, its last known location will display.

##### 3.How long does the battery last?

About 1 year. Low battery alerts will appear in Find My.

##### 4.Can I share my FLY TAG's location with family?

Yes! Simply go to Find My → select your Item → tap Share Item → Add Person and enter their Apple ID to share real-time location access.

##### 5.What if my FLY TAG is lost?

Enable Lost Mode in Find My to lock it and display a contact message.

##### 6.How do I replace the FLY TAG battery?

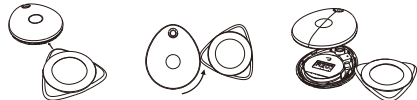

Use a thin flat object to separate the top and bottom halves by inserting it into the gap at the base.  
Insert a new CR2032 battery.  
Reassemble and restart the FLY TAG.

4

##### 7.When can my FLY TAG be located?

Your FLY TAG's location updates when it's out of your Bluetooth range (~130 ft/40m) but near any Apple device in the Find My network.

##### 8.How is my privacy protected?

End-to-end encryption: Only you (via your Apple ID) can see the item's location.

No data storage: Location history isn't stored on the tag or Apple devices that detect it.

Anonymous relays: Devices helping to locate your tag can't identify you or the tag.

##### 9.Why does my tag sometimes show "No Location Found"?

It's offline (no Apple devices nearby to relay its location).

Low battery (check Find My for alerts).

Disabled (e.g., factory reset by someone else).

##### 10.Does it work internationally?

Yes! The Find My network works worldwide wherever Apple devices are present.

#### Troubleshooting

##### 1.FLY TAG won't pair:

Ensure Bluetooth is on.  
Restart your iPhone and try again.  
Factory reset the FLY TAG and try again.

##### 2.No sound when playing sound:

Check distance (<130 ft).  
Confirm the tag isn't muffled (e.g., under thick fabric).

5

##### 3.Button unresponsive:

Check if it's powered off, power on again.

Check if it's low battery, check Find My for alerts.

Perform a factory reset (3 short presses + 1 long hold).

#### Warranty & Support

Your FLY TAG is covered by a 24-month warranty against manufacturing defects. Proof of purchase required.

##### How to Claim Warranty:

Contact our support team at [Flyruit@outlook.com](mailto:Flyruit@outlook.com) with:

Your purchase receipt

Product issue description

We'll respond within 24 hours with troubleshooting or replacement instructions.

\*For returns/refunds: Factory reset your device and unpair it from FLYTAG to safeguard your personal data.

#### Need Help?

For technical support or troubleshooting:

[Flyruit@outlook.com](mailto:Flyruit@outlook.com)

Respond within 24 hours



6

#### LEGAL

Use of the Works with Apple badge means that a product has been designed to work specifically with the technology identified in the badge and has been certified by the product manufacturer to meet Apple Find My network product specifications and requirements. Apple is not responsible for the operation of this device or use of this product or its compliance with safety and regulatory standards. Apple, Apple Find My, Apple Watch, Find My, iPhone, iPad, iPods, Mac, macOS and watchOS are trademarks of AppleInc., registered in the U.S. and other countries. iOS is a trademark or registered trademark of Cisco in the U.S. and other countries and is used under license.

**⚠ WARNING**

**INGESTION HAZARD:** This product contains a button cell or coin battery. DEATH or serious injury can occur if ingested. A swallowed button cell or coin battery can cause **Internal Chemical Burns** in as little as 2 hours. **KEEP** new and used batteries **OUT OF REACH OF CHILDREN**. Seek immediate medical attention if a battery is suspected to be swallowed or inserted inside any part of the body. Keep in original package until ready to use. Immediately dispose of used batteries and keep away from children. Do NOT dispose of batteries in household trash.

7

### FCC Statement

This device complies with part 15 of the FCC Rules. Operation is subject to the following two conditions:

- (1) This device may not cause harmful interference, and
- (2) this device must accept any interference received, including interference that may cause undesired operation.

This equipment has been tested and found to comply with the limits for a Class B digital device, pursuant to part 15 of the FCC Rules. These limits are designed to provide reasonable protection against harmful interference in a residential installation. This equipment generates, uses and can radiate radio frequency energy and, if not installed and used in accordance with the instructions, may cause harmful interference to radio communications. However, there is no guarantee that interference will not occur in a particular installation. If this equipment does cause harmful interference to radio or television reception, which can be determined by turning the equipment off and on, the user is encouraged to try to correct the interference by one or more of the following measures:

- Reorient or relocate the receiving antenna.
- Increase the separation between the equipment and receiver.
- Connect the equipment into an outlet on a circuit different from that to which the receiver is connected.
- Consult the dealer or an experienced radio/TV technician for help.

**FCC Caution:** Any changes or modifications not expressly approved by the party responsible for compliance could void the user's authority to operate the equipment. This transmitter must not be co-located or operating in conjunction with any other antenna or transmitter.

### RF Exposure Considerations

This device complies with FCC radiation exposure limits set forth for an uncontrolled environment. This equipment can be used as portable exposure without any restriction.