

# Contents

<b>Get Started .....</b>	<b>2</b>
Install SIM Card.....	2
Insert Micro SD card .....	2
Charge Mobile Phone .....	3
PC-Phone File Transfer .....	4
<b>Keys and Parts.....</b>	<b>5</b>
<b>Fingerprint .....</b>	<b>7</b>
<b>Lock and Unlock the Screen .....</b>	<b>9</b>
<b>Notification Panel .....</b>	<b>10</b>
<b>Arranging and Rearranging Widgets and Icons .....</b>	<b>11</b>
<b>Adding Folders on your Screen.....</b>	<b>12</b>
<b>Adjusting Brightness .....</b>	<b>13</b>
<b>Changing your Wallpaper.....</b>	<b>14</b>
<b>Make a Call .....</b>	<b>15</b>
<b>Call Log .....</b>	<b>16</b>
<b>Reject a Call by Sending a Busy Message.....</b>	<b>17</b>
<b>Add a Contact .....</b>	<b>17</b>
<b>Messaging.....</b>	<b>18</b>
Receiving a New Message .....	18
Editing SMS and MMS .....	18
Message conversations .....	18
<b>Browse the Web .....</b>	<b>19</b>
<b>Enjoy Music .....</b>	<b>20</b>
<b>Download Applications From Android Market .....</b>	<b>21</b>
<b>Manage Applications .....</b>	<b>22</b>
<b>Maintenance &amp; Safety .....</b>	<b>23</b>

## Get Started

### Install SIM Card

You must insert the SIM card before using the phone.

-> Steps:

1. Switch off the mobile phone.
2. Insert the SIM card correctly in the card slot(s) (See figure below)

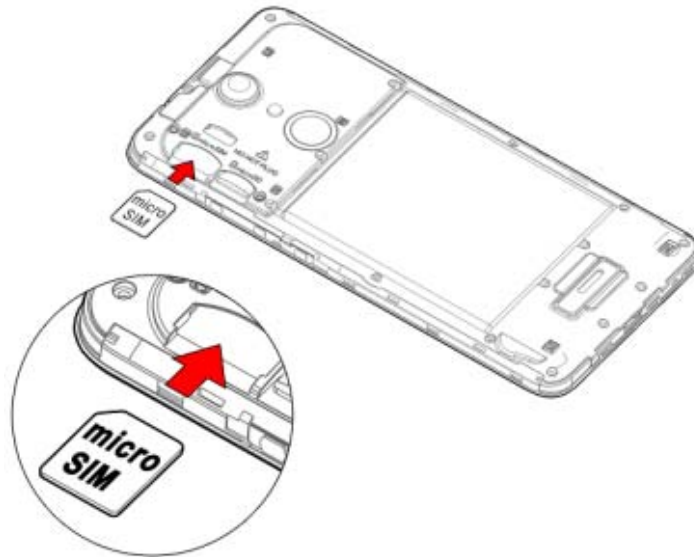

### Insert Micro SD card

The phone supports Micro SD card, which is a multimedia memory card used to multiply the memory of the device. Please follow the instructions as above mentioned.

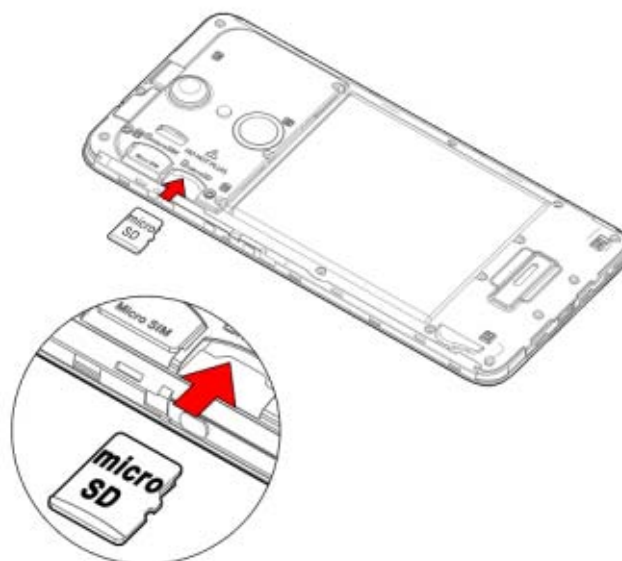

## Charge Mobile Phone

Your phone is powered by a rechargeable battery. If your phone comes up a message which notifies you that the battery power is too low, at that moment, please recharge the battery, if the charge is too low, it may shorten the life of the battery.

Connect the charger to a power outlet and the micro USB connector to the phone's USB port. The LED flashlight on the top of the phone is red. Once the phone has finished charging, the light turns green and you should unplug the charger.

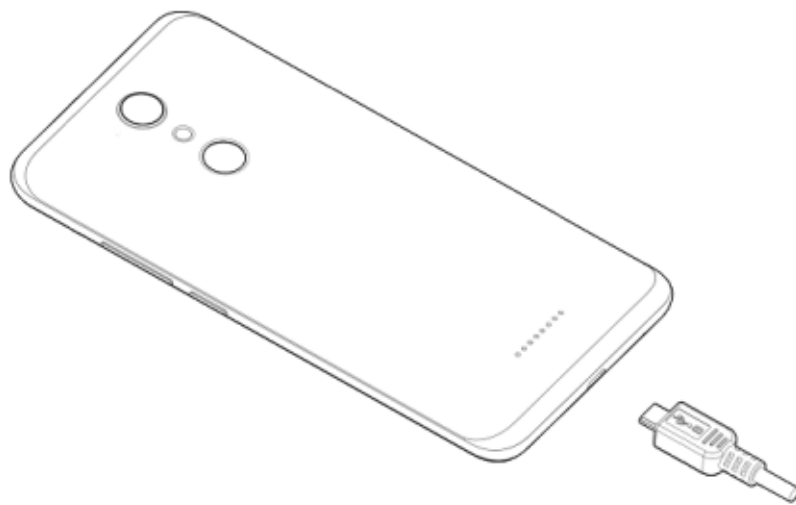

## PC-Phone File Transfer

Once the mobile phone is connected to a PC with USB, the PC will charge the mobile phone automatically. In such case, *USB computer connection* will appear on your screen.

1. Drag the notification panel down and tap *Use USB to Transfer files*.
2. Select *Transfer files*.
3. The device is recognized as a Removable Disk by the computer. Open the folder and transfer or copy files from your phone to PC and vice-versa.

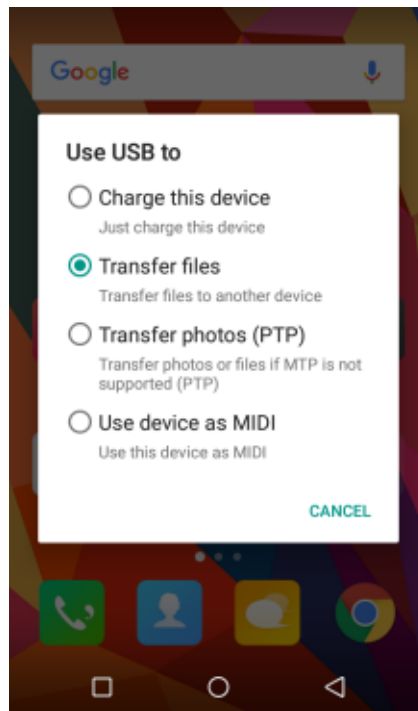

## Keys and Parts

The phone gives you marvelous feelings to experience on Camera, Video recorder, FM radio, Music and Sound recorder. Let you install various APPs, games, and more (supports APK format) by downloading from Android Market.



9

12

---

### 1. Volume

To adjust the ringer volume, adjust the

<b>Up/Down Key</b>	voice volume during a call and adjust media volume.
<b>2.Headset port</b>	To connect an earphone so you can listen to music or radio, etc.
<b>3.Receiver</b>	To hear the voice of the other side when calling.
<b>4.Front Camera</b>	Allow you to take pictures while facing the screen.
<b>5.Power Key</b>	Switch the phone on or off. Press and hold to open phone options menu.
<b>6. Return</b>	Go back to the previous screen; Close the on-screen keypad, a dialog box, an options menu, or the notification panel.
<b>7.Home Key</b>	Go to home screen; Press and hold to open a window showing you most recently used applications.
<b>8.Menu</b>	Switch to recently used applications.
<b>9. USB jack</b>	To connect charger or USB data cable for data exchange.
<b>10.Back Camera lens</b>	For taking photos.
<b>11.Flashlight</b>	To take photos in low-light conditions.
<b>12.Speaker</b>	To listen to music, and other sounds offered by your phone.
<b>13.Fingerprint key</b>	After you set fingerprint, you can use it to unlock the screen.

## Fingerprint

Fingerprint function includes four parts. First, after the screen is locked, users can use a particular fingerprint to unlock the screen. Second, when accessing the encrypted file or application, users can use a specific fingerprint to unlock personal information applications, files and so on. Third, when the phone is in the sleep or locked mode, touch on the fingerprint key more than 2 seconds to quickly open the specified application or make a call. Fourth, in the most part of the interface, user can touch fingerprint key to return to the previous page.

1. Enter Settings ->Fingerprint to enter fingerprint list and add fingerprint.
2. Enter fingerprint as the animation guides.
3. Click “Done”, you will find fingerprint list. You can add 5 fingerprints.
4. After you enter fingerprint successfully, you can name the fingerprint, or you can use the system name.
5. In the Fingerprint list menu, you can edit the fingerprint(s).
6. Back to main interface of fingerprint, separately set up theScreen lock, Files lock, Quick actions and Senor button.

- Screen lock: Before entering fingerprint, you must set up your backup screen lock method.and then you can choose Fingerprint +Pattern, Fingerprint +PIN, or Fingerprint +Password.
- Files lock: When you access to the function in the first time, you should set an unlock pattern and a secure question. And then follow up the guide to set up Privacy fingerprint.
- Quick actions: This function is bundling with other applications or phone call, and it can be used, only while the screen is locked.

- **Senor button:** Touch slightly on the fingerprint key, back to previous menu; in the sleep mode, press the key once, to wake up the phone; in unlock mode, press it once to return to the previous page.

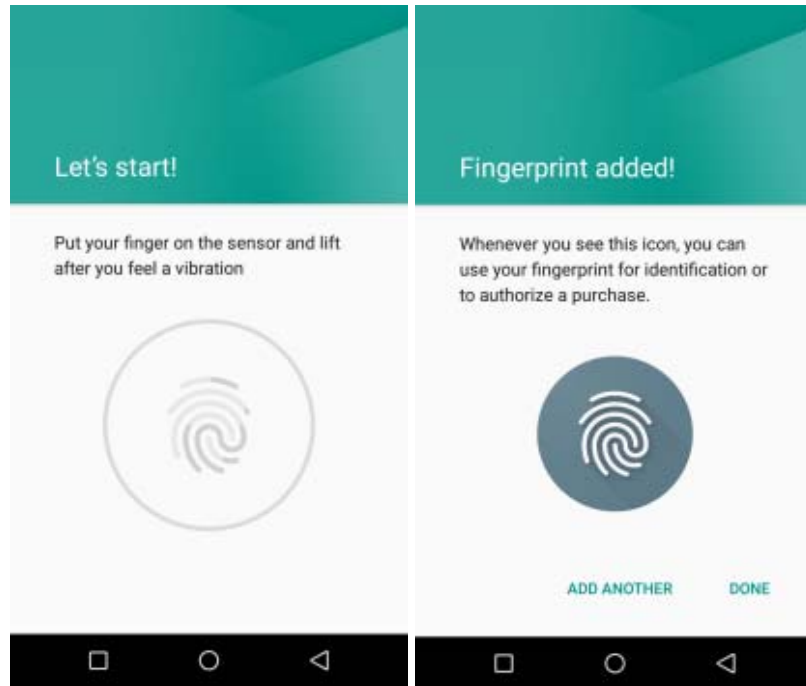



## Lock and Unlock the Screen

Press power button to enter Sleep mode and meanwhile the screen will be locked; press power button again to wake up and then drag the lock upward to unlock.



## Notification Panel

Notification icons on the status bar report the new arrival of messages, calendar events, alarm set and ongoing settings such as when call forwarding is on or the current call status. You can open the Notifications panel to open the message, reminder, or event notification and see the mobile operator's name. Even you can switch on Data connection, WLAN, Bluetooth, etc.

-> Opening the Notifications panel

Press and hold the status bar, slide your finger downward to open the Notifications panel.

If you have several notifications, you can scroll down the status bar to view more notifications.

-> Closing the Notifications panel

Do one operation of the following:

1. Press and hold the bottom bar of the Notifications panel, then slide your finger up the screen.
2. Press BACK or Home directly.

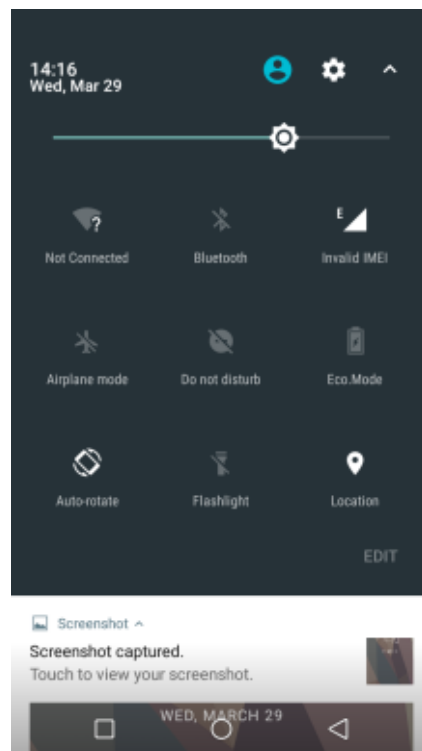

## Arranging and Rearranging Widgets and Icons

Rearrange the widgets and icons on your Home screen to give room for adding more items to the Home screen.

-> Press and hold the widget or icon you are desired to move.

The phone vibrates and you'll see this icon App info on the screen. Don't release your finger.

-> Drag the widget or icon to a new location on the screen. Pause at the left or right edge of the screen to drag the widget or icon onto another Home screen panel.

-> When the widget or icon is where you are desired to put it, release your finger. If you've released your finger but a message shows that there's no space to place the widget or icon, drag it right or left again to another Home screen panel.



## Adding Folders on your Screen

Use folders to group related applications and other shortcuts to keep your Home screen tidy and organized.

->*Adding folder on your screen*

Press and hold an application icon or a widget that you want to move. The phone then vibrates. Don't release your finger. Drag the application icon or widget and drop it on top of another application icon or widget. Then, simply tap the folder to open it so you can access the applications and widgets inside the folder.

->*Renaming a folder*

Tap the folder to open it, and enter a new folder name and then tap anywhere on the screen.

->*Deleting folder*

Drag out all the applications from the folder, then the folder will be deleted automatically.

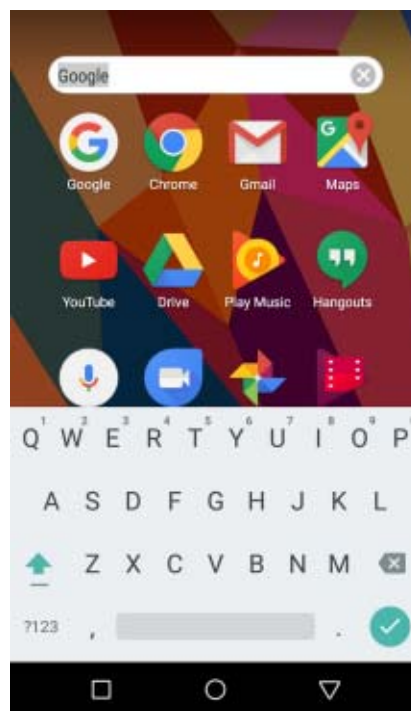

## Adjusting Brightness

Drag the notification panel down and adjust brightness. Or enter Settings->Display-> Brightness level, and adjust the brightness level here (by dragging the brightness slider to the left to decrease or to the right to increase the screen Brightness).

Note: Lower the brightness of the screen to prolong the battery life.

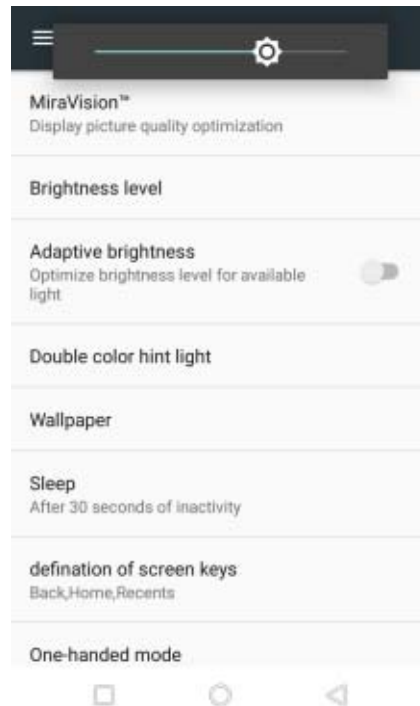

## Changing your Wallpaper

Personalizing your Home screen wallpaper with your favorite photo is a quick and easy way to change the feel of your phone and give it a fresh look. Browse the collection of wallpapers included in your phone by default or choose from photos that you have taken with the camera.

- > Press and hold the screen where there is space.
- > The screen will vibrate and an optional context.
- > Select the wallpaper you want and confirm to set it as wallpaper.

Or you can enter Settings->Display->Wallpaper, then will show an optional context.

- > Select the wallpaper you want and confirm to set it as wallpaper.

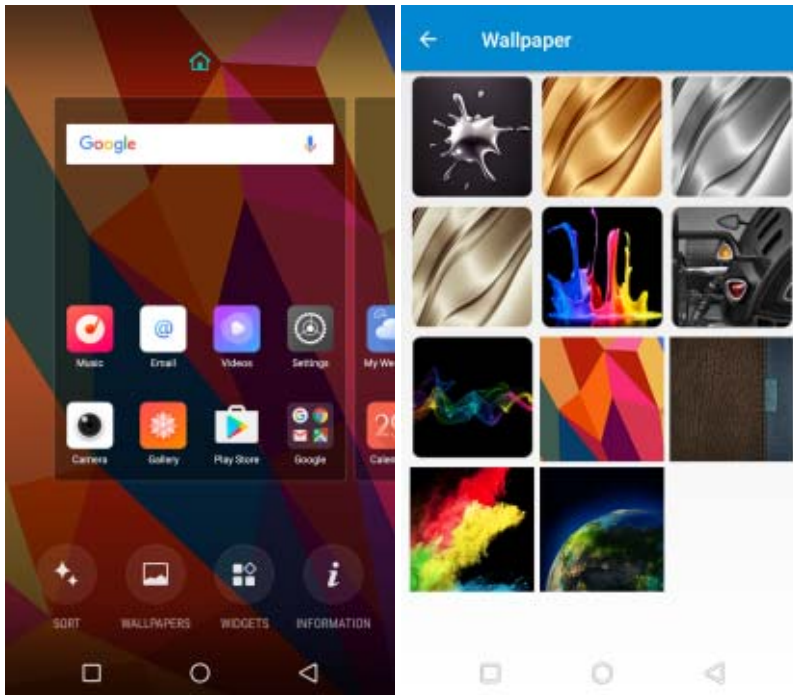

## Make a Call

On the start screen choose  and enter a complete phone number to make a call.

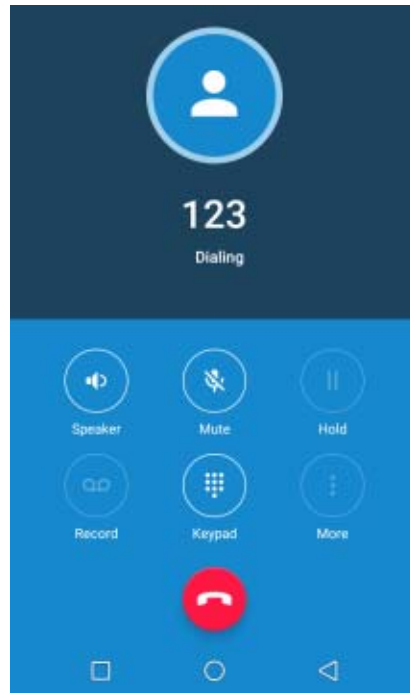

## Call Log

Enter Phone interface, then tap icon , and then access Call log. In call log options, you can Make calls, Create new contact and send message etc.

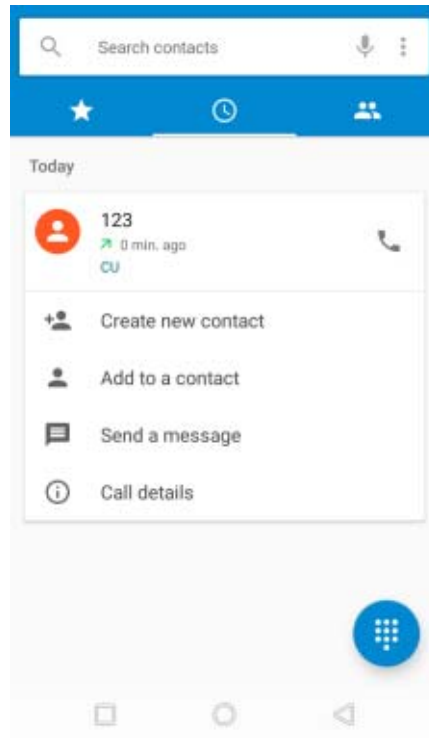



## Reject a Call by Sending a Busy Message

While there is an incoming call, you are inconvenient to accept the call, and then you can send a busy message for rejecting the call.

Drag the circle up to , some busy messages will show on the screen, short tap any of them to send out.

## Add a Contact

Tap  and enter Contacts and then add a contact (see figure below.)

Tap  to add a new contact to Phone or SIM card.

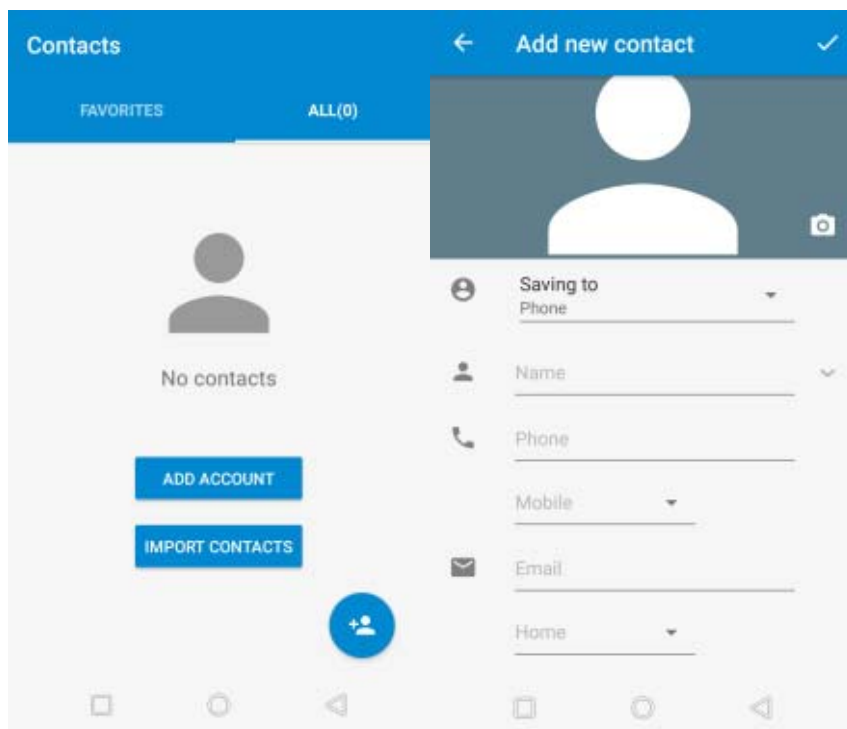

## Messaging

Enter Messaging, and then compose new message. You touch a text field where you want to enter text, to open the keyboard.

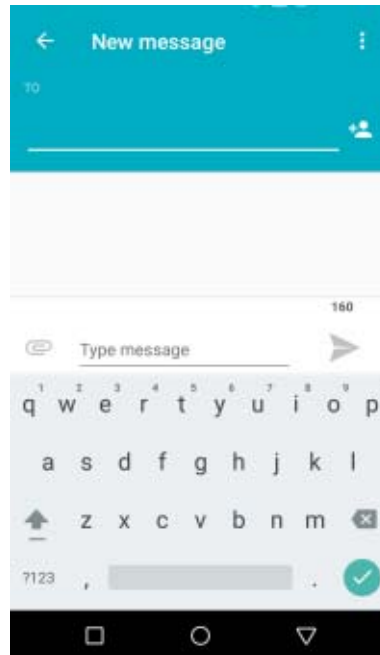

### Receiving a New Message

When there is a new message comes, a new message icon will appears in the notifications area of the status bar to notify you of a new text or multimedia message.

To open the message, press and hold the status bar, and then slide the status bar down to open the Notifications panel. Or go to Messaging, read the message directly.

### Editing SMS and MMS

-> When you are composing a new text message, you can select text for cutting or copying. Touch the text field or portion that contains text. You can select all contexts, copy, cut and paste. The selected text is highlighted in Blue.

-> A multimedia message may contain video, pictures, audio, sideshow, etc. Thus, when you are supposed to edit a MMS, you can just add videos, pictures and more to SMS and change to MMS.

### Message conversations

Text and multimedia messages that are sent to and received from acontact (or a number) are grouped into conversations or message threads in the All messages screen. Threaded SMS or MMS let you see exchanged messages (similar to a chat program) with a contact on the screen.

## Browse the Web

Open the browser; click the URL on the screen to search or tap website address.

The browser is fully optimized and comes with advanced features that let you enjoy Internet browsing on your phone. You must have an active data connection or Wi-Fi connection to access the Internet.

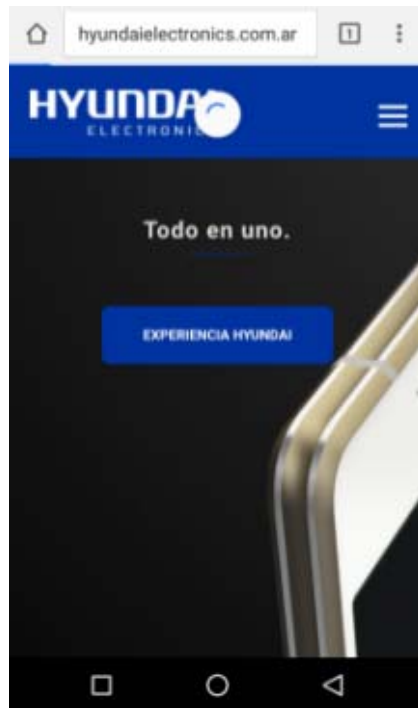

## Enjoy Music

When you copy music to your Micro SD card, the Music player searches the device for music files and builds a catalog of your music, based on information about each file that is stored in the file itself.

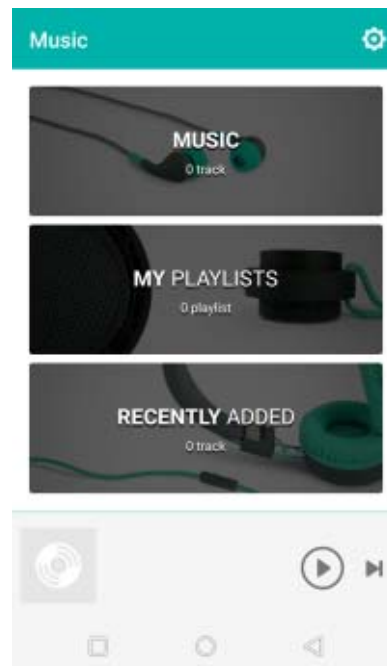

# Download Applications From Android Market

Add a Google account

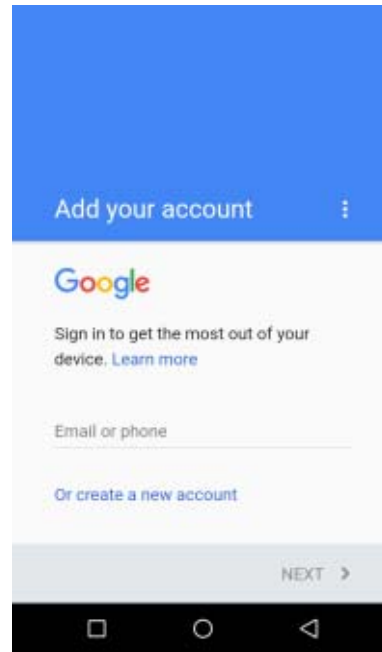

Enter Google Play™ store and download apps.



## Manage Applications

Enter Setting >Apps, then manage the applications. Tap any app to view the information of the applications, and you can also force the apps to stop or uninstall the apps.

To install Apps, you need switch on “Unknown sources” in Security settings.

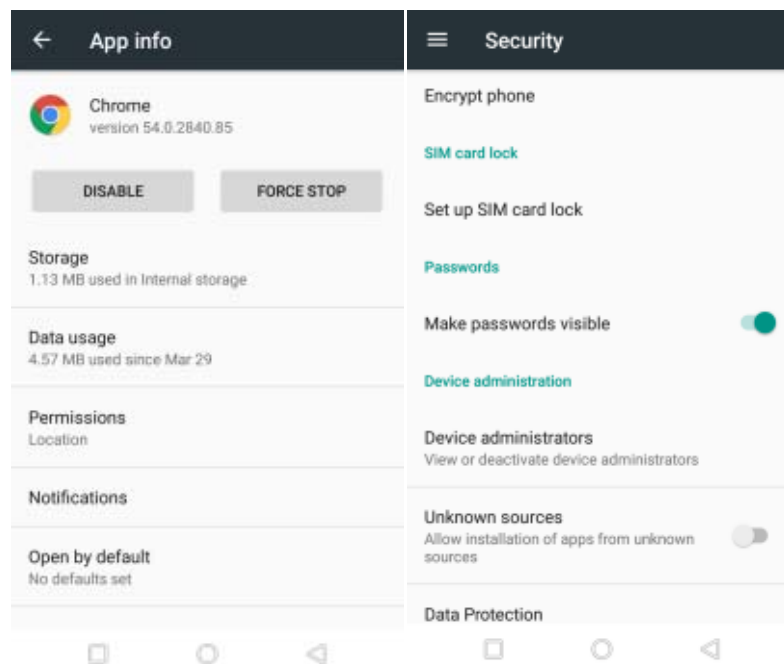

## Maintenance & Safety

Please read this safety information carefully so that you can use your phone in complete safety:

1. Children: Be very careful with children and your phone. A mobile phone contains a number of detachable parts. Exercise great care when children are in close proximity to the phone. The phone contains small parts that could be swallowed or cause choking. If your phone is equipped with a camera or lighting device, do not use it too near children or animals.

2. Hearing: Prolonged listening at full power using a lightweight headset or headphones can damage your hearing. Reduce the volume to the lowest possible level when listening to music or conversations. Avoid high volumes over extended periods.

3. Driving: Exercise care when driving. Driving requires maximum attention at all times in order to minimize the risk of accidents. Using a mobile phone can distract the user and result in an accident. You must fully comply with the local regulations and laws in force regarding the use of cell phones whilst driving. You are not allowed to use the phone whilst driving. A hands-free kit should not be regarded as an alternative solution.

Flying: Turn your phone off when flying. Remember to turn your phone off when you are in a plane (GSM+Bluetooth) as it may cause interference.

4. Hospitals: Turn your phone off near any medical devices. It is extremely dangerous to leave a phone switched on near medical devices as it may cause interference. You must observe any instructions or warnings in hospitals and treatment centers. Remember to turn your phone off in service stations. Do not use your device in a petrol station near fuel. It is dangerous to use your phone inside a professional garage.

5. Electronic implants and pacemakers: Users who wear a pacemaker or who are fitted with an electronic implant must hold the phone on the opposite side to their implant as a precaution when making a call. If you notice that your phone is causing interference with a pacemaker, switch it off immediately and contact the manufacturer of the pacemaker for advice on what action to take.

6. Fire hazard: Do not leave your device near heat sources such as radiators or cookers. Do not leave your phone charging near flammable materials as there is a real risk of fire.

7. Contact with liquid: Do not expose the phone to liquid or touch it with wet hands: any damage caused by water may be irreparable.

8. Use only HYUNDAI-approved accessories. The use of unauthorized accessories may damage your phone or cause a safety risk.

9. Do not destroy the batteries and chargers. Never use a battery

or charger that has been damaged. Keep batteries away from magnetic objects as the latter might cause short-circuit between the positive and negative terminals of your batteries and destroy the battery or phone permanently. As a general rule, you should not expose the batteries to very high or low temperatures (below 0°C or above 45°C). Differences in temperature may reduce battery autonomy and service life.

10. Shocks and impact: Handle and use your phone with the utmost care. Protect your phone: shocks and impact may damage it. Some parts of your phone are made from glass and might break if the phone is dropped or is subject to severe impact. Avoid dropping your phone. Do not touch the screen with sharp objects.

11. Electric shock: Do not try to dismantle your phone as there is a very real risk of electric shock.

12. Maintenance: If you want to clean your handset, use a dry cloth (do not use a solvent, such as benzene, or alcohol).

13. Recharge your phone in a well-ventilated area. Do not recharge your device when it is resting on a soft surface.

14. Damage to magnetic strips: Keep your phone away from credit cards as they may damage the data on the magnetic strips.

15. Do not use the mobile phone in the environment at too high or too low temperature, never expose the mobile phone under strong sunshine or too wet environment. The suitable temperature for the phone is -10°C to +45°C, the maximum charging temperature declared by the manufacturer is +40°C.

16. Due to the used enclosure material, the GSM mobile phone shall only be connected to a USB Interface of version 2.0 or higher. The connection to so called power USB is prohibited.

17. The power adapter is the disconnect device for this equipment. The socket-outlet shall be near the equipment and easily accessible.

### Warning

Specific Absorption Rate (SAR) information SAR tests are conducted using standard operating positions accepted by the FCC with the phone transmitting at its highest certified power level in all tested frequency bands, although the SAR is determined at the highest certified power level, the actual SAR level of the phone while operating can be well below the maximum value, in general, the closer you are to a wireless base station antenna, the lower the power output.

Before a new model phone is available for sale to the public, it must be tested and certified to the FCC that it does not exceed the exposure limit established by the FCC, Tests for each phone are performed in positions and locations (e.g. at the ear and worn on the body) as required by the FCC.



For body worn operation, this mobile phone has been tested and meets the FCC RF exposure guidelines when used with an accessory designated for this product or when used with an accessory that contains no metal and that positions the handset a minimum of 1.0cm from the body.

This device complies with part 15 of the FCC Rules. Operation is subject to the following two conditions: (1) This device may not cause harmful interference, and (2) this device must accept any interference received, including interference that may cause undesired operation. Any Changes or modifications not expressly approved by the party responsible for compliance could void the user's authority to operate the equipment.

Note: This equipment has been tested and found to comply with the limits for a Class B digital device, pursuant to part 15 of the FCC Rules. These limits are designed to provide reasonable protection against harmful interference in a residential installation. This equipment generates uses and can radiate radio frequency energy and, if not installed and used in accordance with the instructions, may cause harmful interference to radio communications. However, there is no guarantee that interference will not occur in a particular installation. If this equipment does cause harmful interference to radio or television reception, which can be determined by turning the equipment off and on, the user is encouraged to try to correct the interference by one or more of the following measures:

- Reorient or relocate the receiving antenna.
- Increase the separation between the equipment and receiver.
- Connect the equipment into an outlet on a circuit different from that to which the receiver is connected.
- Consult the dealer or an experienced radio/TV technician for help.