



Quick Starting Guide

How to use the Explorer X1

Please read this manual carefully before use the X1 player, and keep is safely.

Except this quick starting guide, a fully manual and a breif manual are also provided for you. You can get more details by reading them.



www.echoboxaudio.com

Content

Please check the packing list at first :

- ☐ Explorer X1 Player
- ☐ Leather Case
- ☐ Charging Dock
- ☐ USB Cable
- ☐ Quick Starting Manual
- ☐ SPDIF Adaptor (Cable)
- ☐ 1 Set Earphone

About the Operation System

- * The OS of X1 Player is Android 4.2
- * X1 Player should not use as an external digital audio decoder
- * More OS details please read the operation guide of Android system

Control Parts / Button

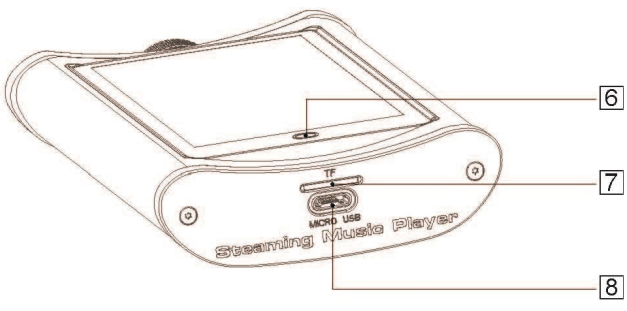
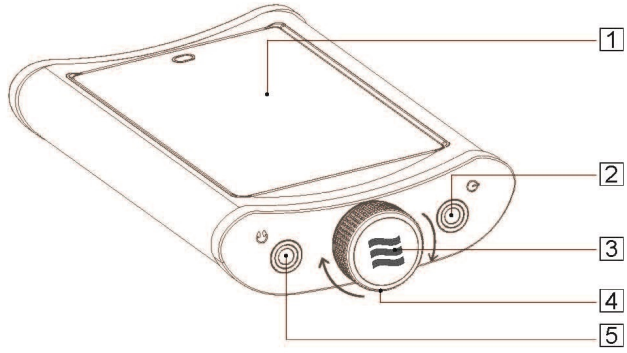

- 1 Screen : It is a touch-screen
* Touch/Click the icon, you can get a operation executed 行操作。
- 2 SPDIF Output : Digital signal output in Spdif format
- 3 Power Button
Click : Power on or Display on/off
Press and hold : Power off
- 4 Volume knob : you can adjust the Volume up and down
- 5 Earphone Jack
Plug the earphone correctly you will hear a click sound.
* Strange sound you will hear if the earphone is not plugged well.
- 6 Return Button
- 7 TF Card Socket
- 8 USB Port

About the Volume operation

Clockwise to Volume up
Anti-Clockwise to Volume down



The volume pricise is 1dB/step

Please turn the volume knob gentlyly when you first using X1 player.
* X1 will not release a warning sound when connecting to other equipment.

Note:

- X1 will restore the safe volume level if the volume is so high before you turn off it.

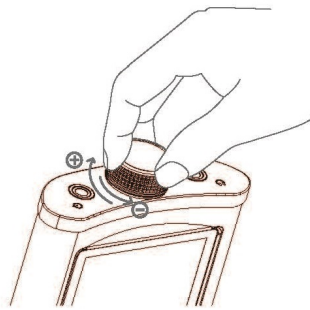

Set the Operation Language

1 Click the "Setup" icon to open the setup panel.



2 Slide to find the "Language" item

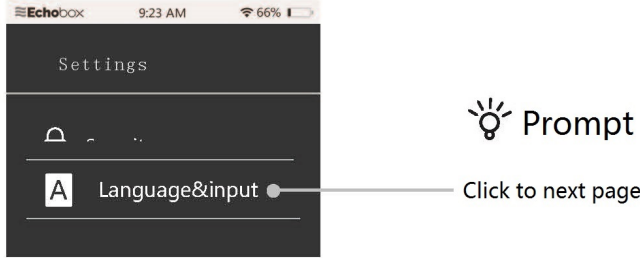

3 Choose "Language" item

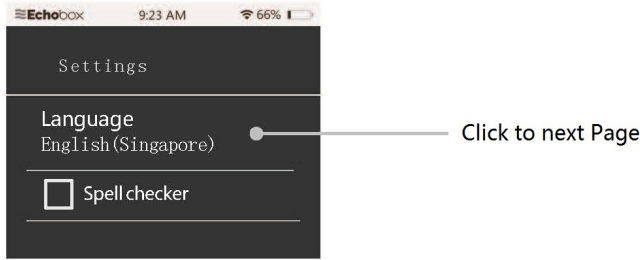

4 Choose a language and then start to use your X1 Player

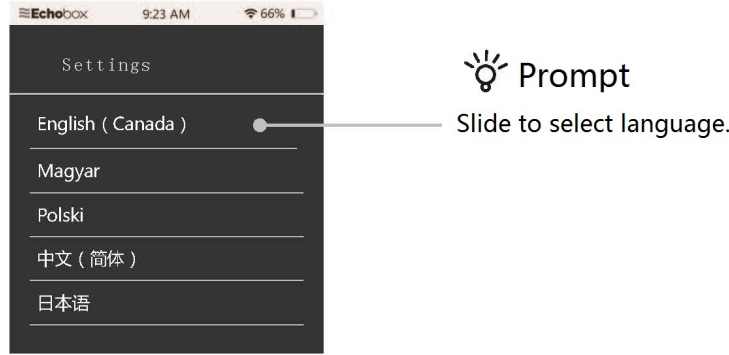

Wi-Fi Connection

1 Click the "Setup" icon to open the setup panel.



2 Turn on the Wi-Fi.

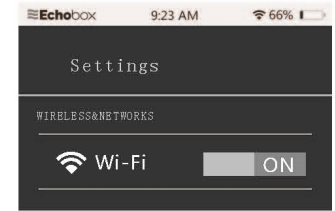

3 Choose your known Wi-Fi net.



4 Enter the password to get connection.



Power On/Off your Explorer X1

Please turn off your X1 when longtime non-using.

1 Press and Hold  to power on X1.

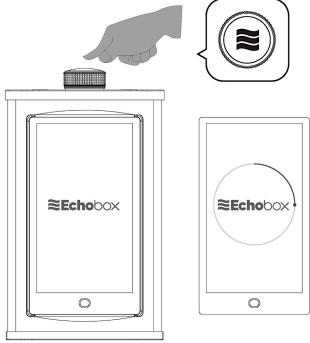

* It will take more time when you first power on X1.

2 Press and Hold  to power off X1.

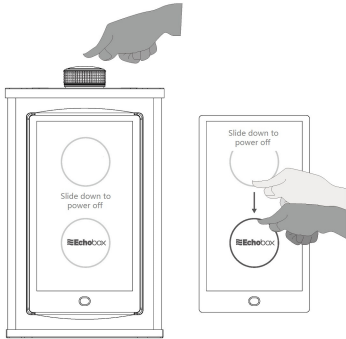

Screen Saving

The screen display will power-save when non-used for minutes.

Press the  button to turn on/off the screen display.

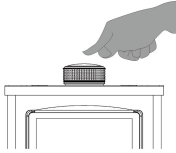

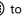
Slide  to left or right side to un-lock the screen.

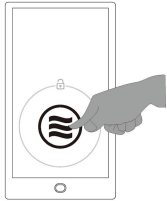

Main Screen

Click the icon to use X1 function.

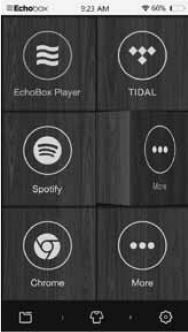

Slide to Left / Right side to switch the screen.

Use the Touch Screen

Normal gestures are supported by X1 touch screen.

Click

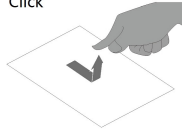

Press & Hold

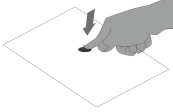

Slide

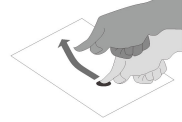

Drag & Drop



Stretch



Attention

Rated charging current: 800mA
Please do not try to change the built-in Li-on battery, contact us when you need do that.
Other micro-USB charger can be used for X1.

- About the earphone
- Please keep safe volume to protect your listening.
 - You may lost the ambience sound if use high volume, please do not listen to X1 when you need the ambience sound for safety.
 - Please mind not to disturb other people when you are using big headset and with loud sound.

Trouble Shooting

Please restart X1 when it works not normal. Even you can press and hold the power button long time to reset it.

FCC Information

This device complies with Part 15 of the FCC Rules. Operation is subject to the following two conditions:
1. This device may not cause harmful interference, and
2. This device must accept any interference received, including interference that may cause undesired operation.

Note: This equipment has been tested and found to comply with the limits for a Class B digital device, pursuant to part 15 of the FCC Rules. These limits are designed to provide reasonable protection against harmful interference in a residential installation. This equipment generates, uses and can radiate radio frequency energy and, if not installed and used in accordance with the instructions, may cause harmful interference to radio communications. However, there is no guarantee that interference will not occur in a particular installation. If this equipment does cause harmful interference to radio or television reception, which can be determined by turning the equipment off and on, the user is encouraged to try to correct the interference by one or more of the following measures:
—Reorient or relocate the receiving antenna.
—Increase the separation between the equipment and receiver.
—Connect the equipment into an outlet on a circuit different from that to which the receiver is connected.
—Consult the dealer or an experienced radio/TV technician for help.

Caution: Any changes or modifications not expressly approved by the party responsible for compliance could void the user's authority to operate this equipment.



Click to open playlist



Music Play Screen



Playlist Screen

-  Icon for loop play
-  Icon for volume set
-  Icon for music sharing